

From: Malcolm Tempest Ltd
Sent: 27 March 2019 12:33
To: Ailsa Teasdale
Subject: NYM/2018/0310/FL

Dear Mrs Teasdale

Thank you for your letter dated 5th March 2019 and further to our conversation we address the points you raised as follows:-

- Yes there is availability for additional parking and I have marked on the plan an additional 6 spaces at the lower level which can be gravel so be free draining. This could be accommodated within the site with landscaping as indicated.
- Our client has confirmed the following regarding the spa/salon/beauty facilities:- *I envisage having an indoor jacuzzi/hot tub exclusively for the guests. Also one treatment room where we will specialize in luxury foot massages aimed at the walkers. As we are on the Coast to Coast Route I feel this will be an excellent addition to be able to offer to our guests and to those staying next door at the Arncliffe; these guests will either be on foot or will already be parked elsewhere. The treatments will be carried out by myself on a booking basis so there will be no issues of extra spa staff parking requirements.*
- We would envisage about 11 tables and 44 seats in the Tearoom but it is unlikely that every seat would be taken at once.
- We discussed the additional photo montage and will aim to get that to you before the next Committee Meeting on 18th April.

We hope the above and attached will help for now.

Regards,

Malcolm Tempest

Malcolm Tempest Ltd
High Parks
Newton-le-Willows
Bedale, North Yorkshire DL8 1TP

General Notes

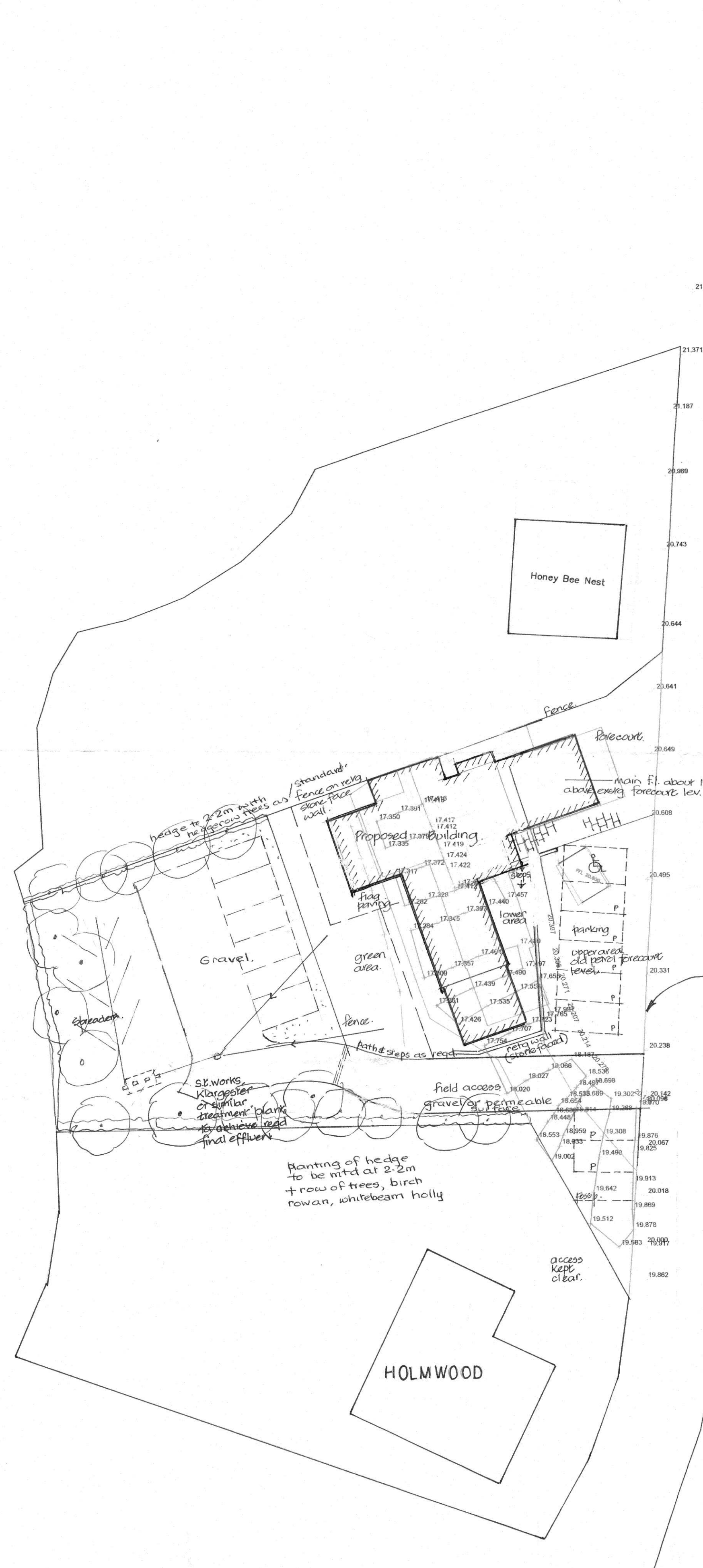

34.401
24.028 24.071
23.084 23.754
23.360 23.430
22.983 23.076
22.940
22.741
22.618 22.747
22.446
22.338 22.448
22.230
22.210
21.757 21.955
21.813
21.634 19.496
21.323
20.974 20.168
19.588
19.899
20.208
20.435
20.593
20.673
20.697
20.661
20.617
20.579

Levels are existing except as stated.
All tanks, etc removed & made good.
Any works to highway to NYCC reqts.
Proposed redevelopment of filling station

Proposed Site layout:
apx 1:250
June 2018.

Kerbline to be made good to NYCC requirements.

* foul drainage note.
Upper storeys and road frontage to discharge to public sewer as falls are available.

Lower and rear drains to go to ST. works in field.

Surface water to run to soakaway, min 5m from building or the beck.

C Amendments		March 19
A	Alterations	Sept 18
B	Amendments	Dec 18
No.	Revision/Issue	Date

Firm Name and Address

Project Name and Address
Honey Bee Nest
Glaisdale
North Yorks
YO21 2QL

Project	TOPO	Sheet	Dwg No.
Date	24.05.2018		8099/1/4
Scale	1:250		