

Produced 05 Apr 2019 from the Ordnance Survey MasterMap (Topography) Database and incorporating surveyed revision available at this date.

The representation of a road, track or path is no evidence of a right of way. The representation of features as lines is no evidence of a property boundary.

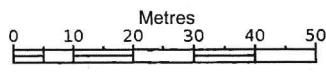

1:1250



Pear Trees House, Egton Bridge, Whitby
YO21 1UZ

Supplied by: **Stanfords 05 Apr 2019**
Licence: © Crown Copyright and
database rights 2019 OS100035409
Order Licence Reference: OI1313426
Centre coordinates: 480247 505264

X TREE

PROPOSED SHED AT PEAR TREES HOUSE

PLAN VIEW

FLOOR AREA 38.3 m²

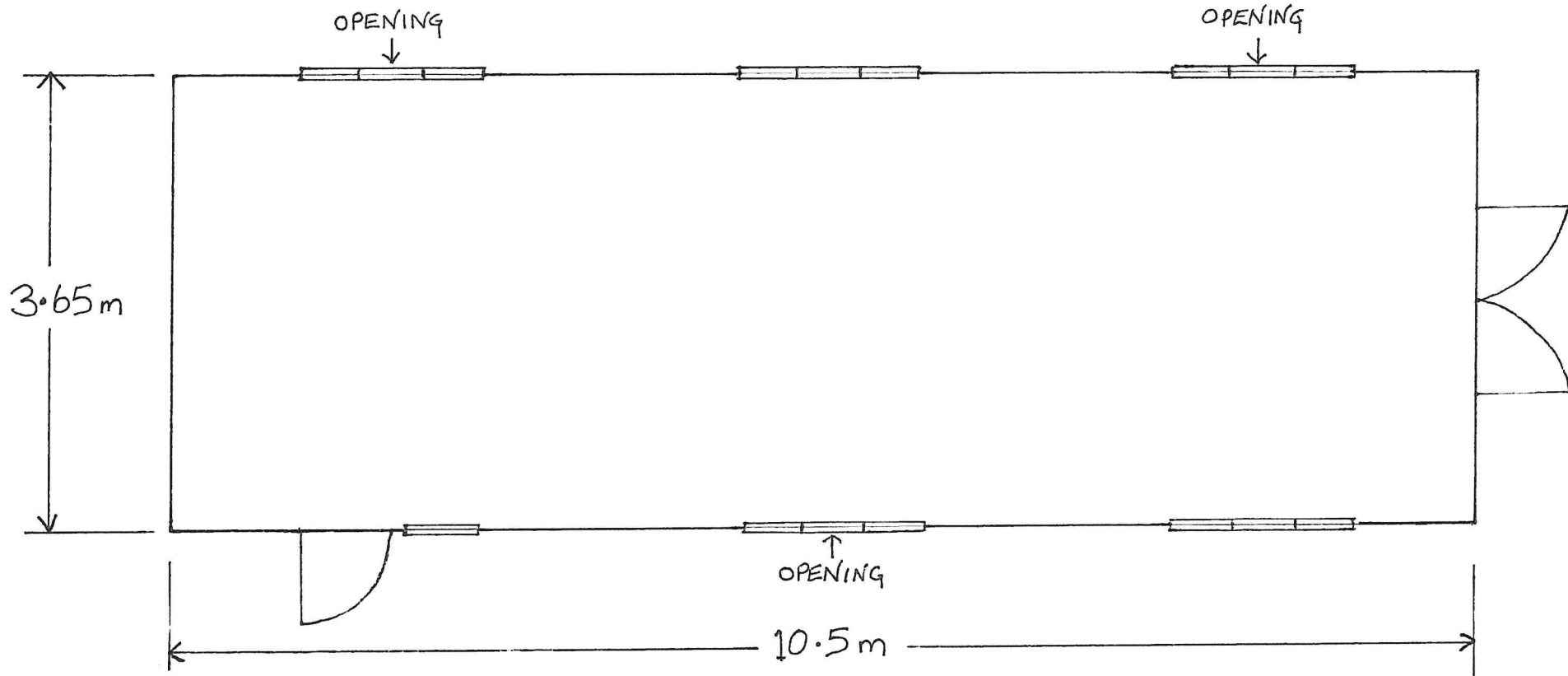

SCALE 1:50
PAPER SIZE A4

6 WINDOWS { 5 AT 1450mm X 660mm
WOOD FRAME, GLAZED { 1 AT 507mm X 660mm

PROPOSED SHED AT PEAR TREES HOUSE

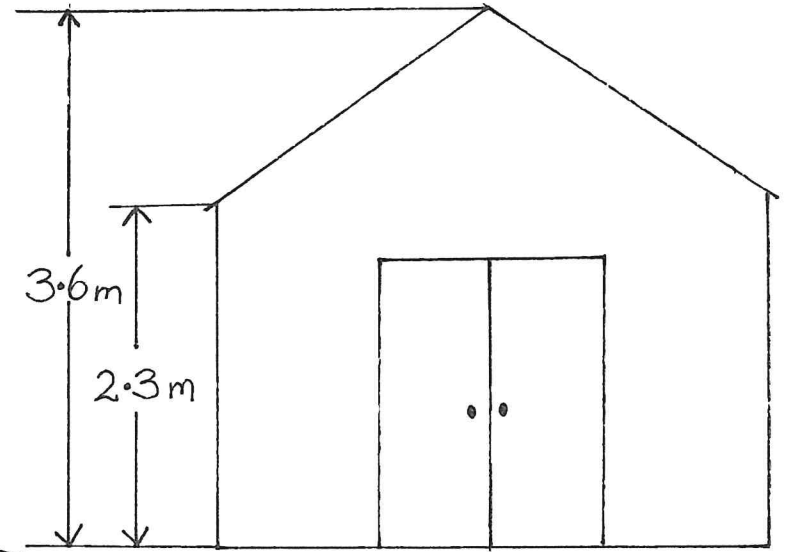

'ARCADIA' OLD ENGLISH
PANTILES

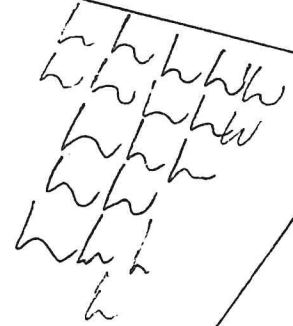
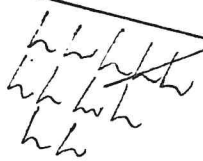

TANALISED SHIPLAP
MEDIUM BROWN

SCALE 1:50
PAPER SIZE A4

