

From:
To: [Planning](#)
Subject: COALYARD, Robin Hoods Bay.
Date: 25 April 2019 16:18:51
Attachments:

NYM/2019/0175/FL

Good Afternoon Mrs Saunders,
In response to Elspeth Ingleby's email to you, I submit my amended landscape plan (Landscape 2) taking into account her recommendations.

Kind regards,
John Peoples
Agent for Mr D Thompson.

- T1 Hazel (*Corylus avellana*)
- T2 Blackthorn (*Prunus spinosa*)
- T3 Hazel (*Corylus avellana*)
- T4 Maple, field (*Acer campestre*)
- T5 Elder (*Sambucus nigra*)
- T6 Holly (*Ilex aquifolium*)
- Hawthorn (*Crataegus Monogyna*)
- Honeysuckle (*Lonicera periclymenum*)
- Three plants dispersed.

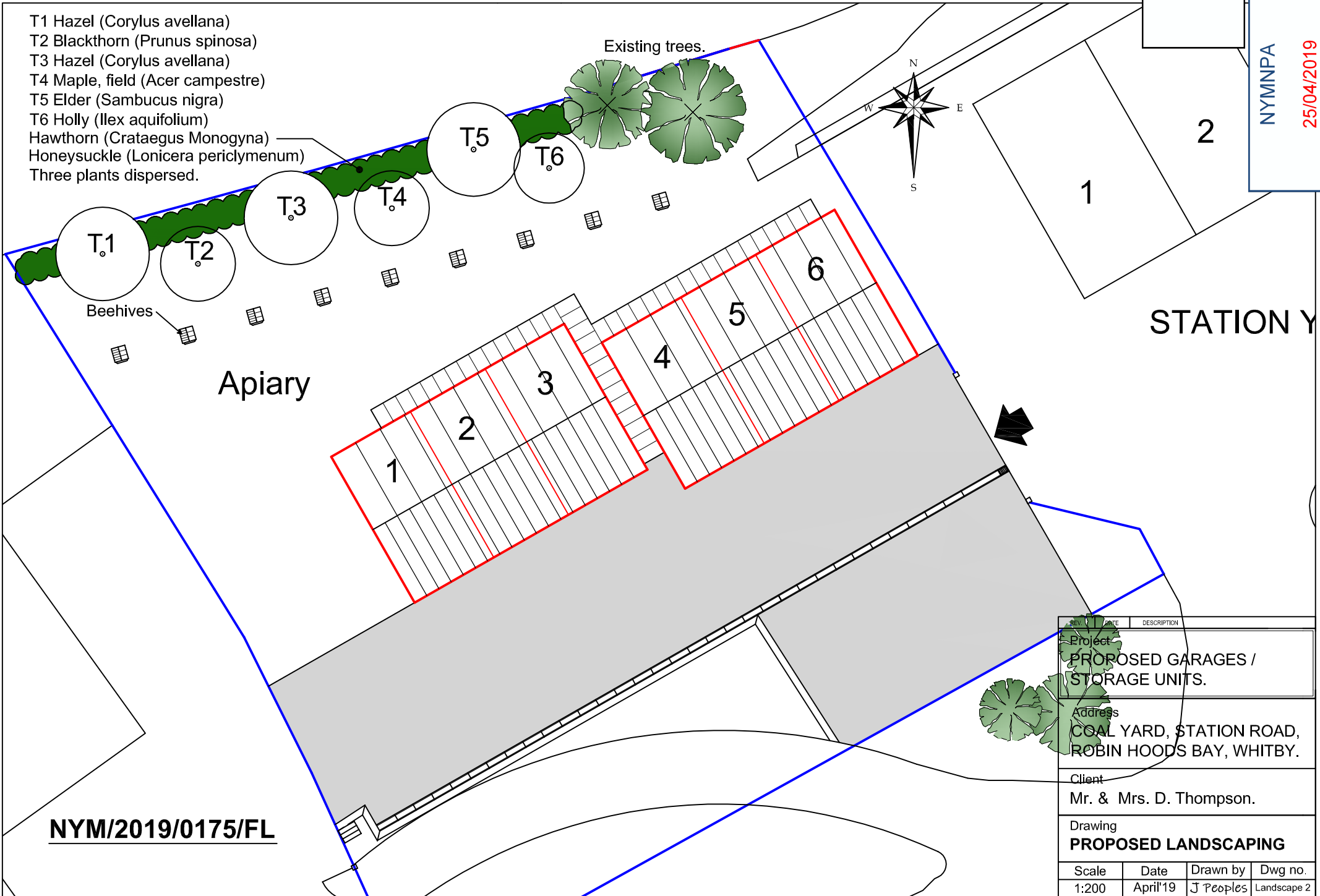

AMENDED

NYMNPA
 25/04/2019

2

1

STATION Y

Apiary

Beehives

Existing trees.

T5

T6

T3

T4

T1

T2

1

2

3

4

5

6

REV	DATE	DESCRIPTION
1		Project PROPOSED GARAGES / STORAGE UNITS.
Address COAL YARD, STATION ROAD, ROBIN HOODS BAY, WHITBY.		
Client Mr. & Mrs. D. Thompson.		
Drawing PROPOSED LANDSCAPING		
Scale	Date	Drawn by
1:200	April'19	J Peoples
		Dwg no.
		Landscape 2

NYM/2019/0175/FL