

Do not scale from this drawing.

SAFETY HEALTH AND ENVIRONMENTAL INFORMATION

IN ADDITION TO THE HAZARD/RISKS NORMALLY ASSOCIATED WITH THE TYPES OF WORK DETAILED ON THIS DRAWING, NOTE THE FOLLOWING RISKS AND INFORMATION.

RISKS LISTED HERE ARE NOT EXHAUSTIVE. REFER TO DESIGN ASSESSMENT FORM NO.

CONSTRUCTION

DEMOLITION

FOR INFORMATION RELATING TO USE, CLEANING AND MAINTENANCE SEE THE HEALTH AND SAFETY FILE

IT IS ASSUMED THAT ALL WORKS WILL BE CARRIED OUT BY A COMPETENT CONTRACTOR WORKING, WHERE APPROPRIATE, TO AN APPROVED METHOD STATEMENT.

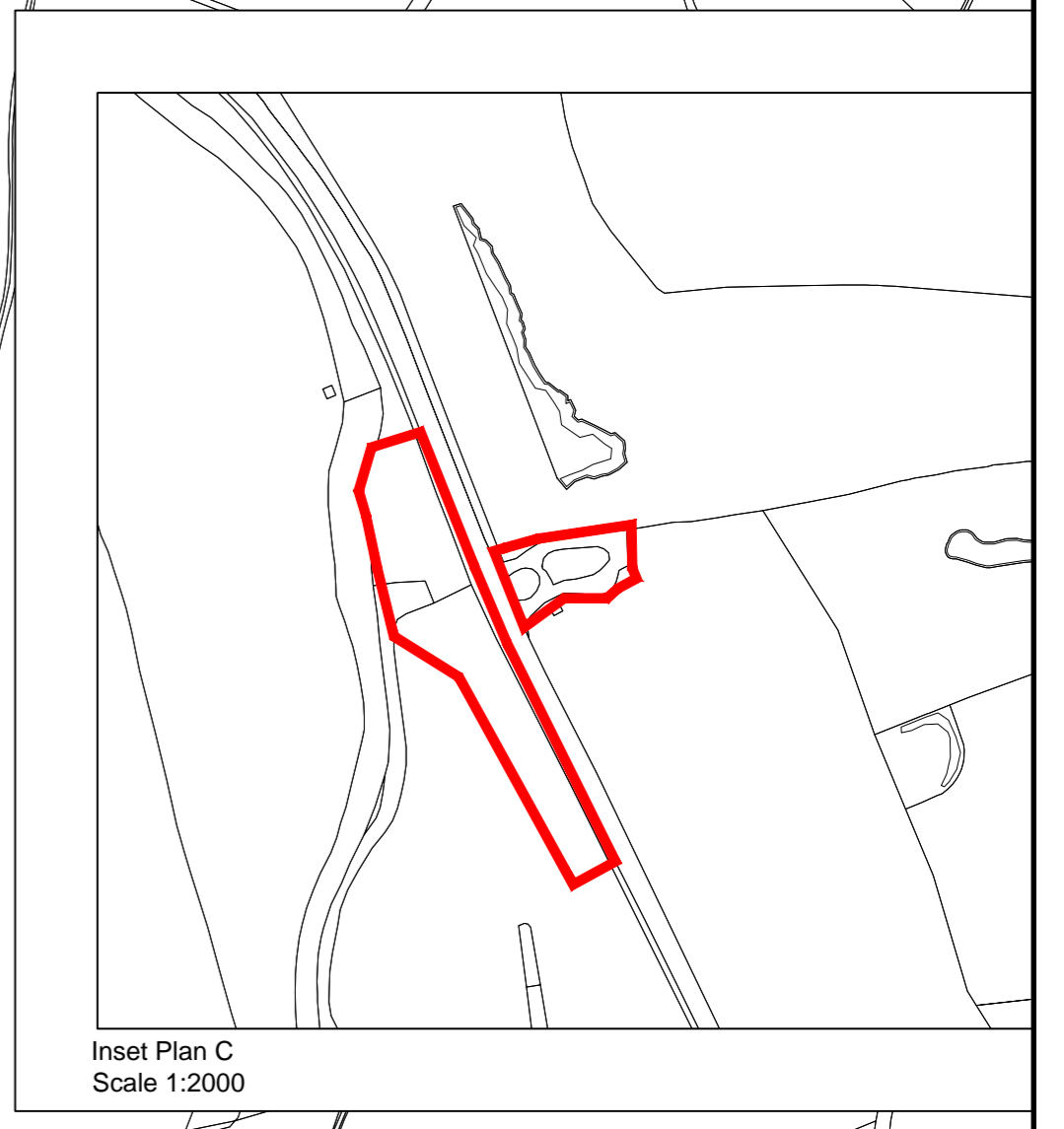
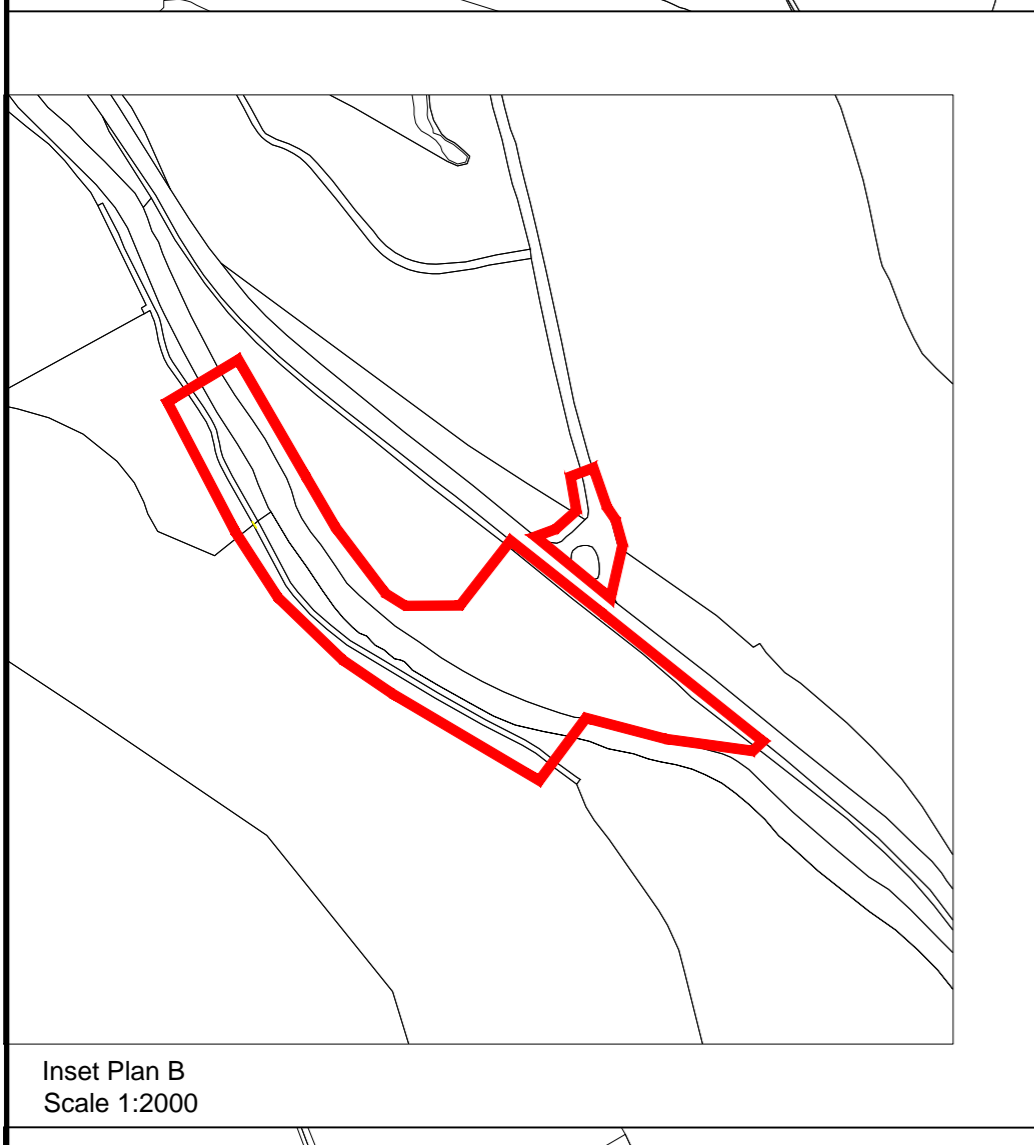
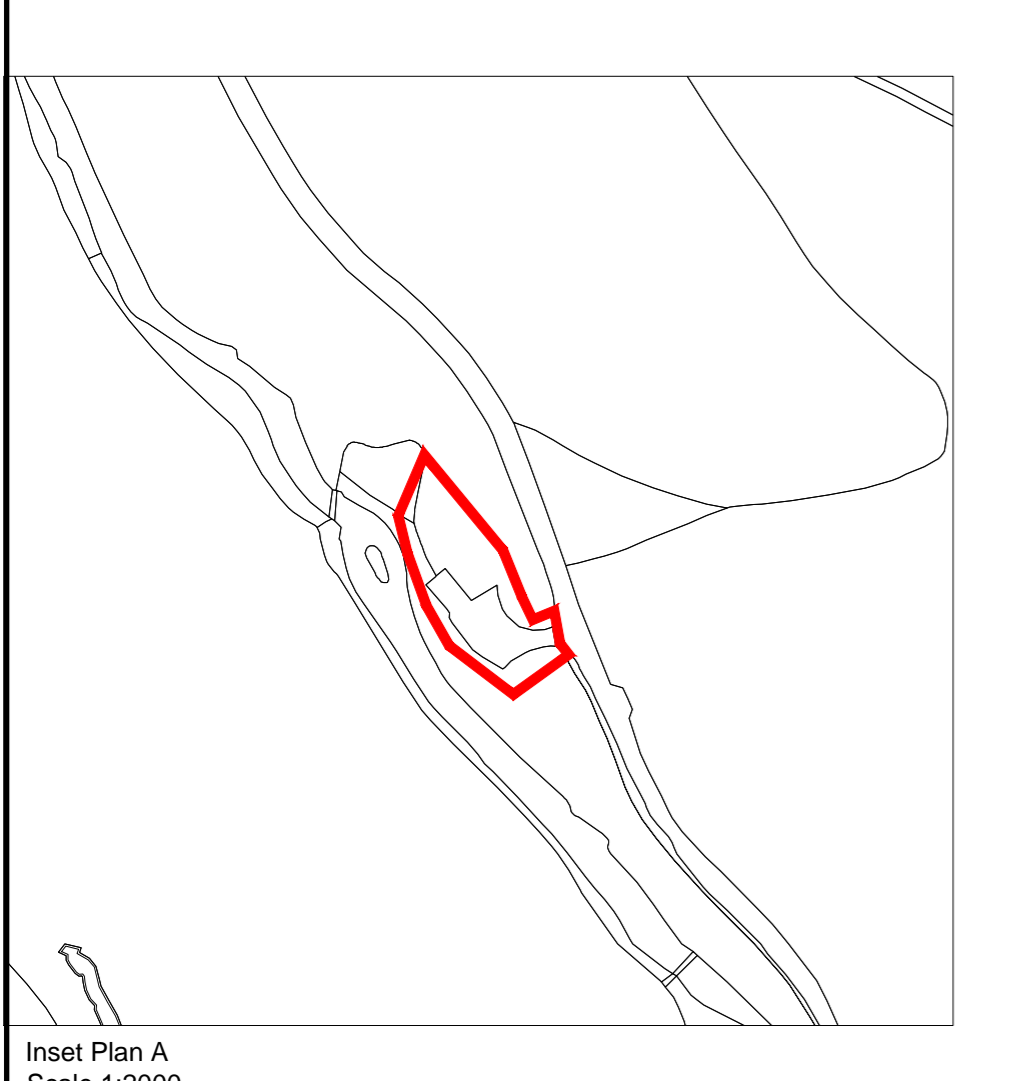

NYMNP					
20/06/2019					
Rev.	Date	Description	Drawn	Checked	Approved
B	12/06/19	ANNOTATIONS ADDED	NK	ER	ER
A	08/05/19	REVISED LAND OWNERSHIP BOUNDARY FOLLOWING CLIENT COMMENTS.	SDR	SWG	SWG

Notes:
Reproduced by permission of Ordnance Survey on behalf of HMSO.
© Crown copyright and database rights 2019 Ordnance Survey 100024267

Client: WHIRRY SCARBOROUGH ELEY BOROUGH OF SCARBOROUGH

Project Title: FORGE VALLEY

Drawing Title: SITE BOUNDARY PLAN

Key:
— Application Boundary
— Land Ownership Boundary

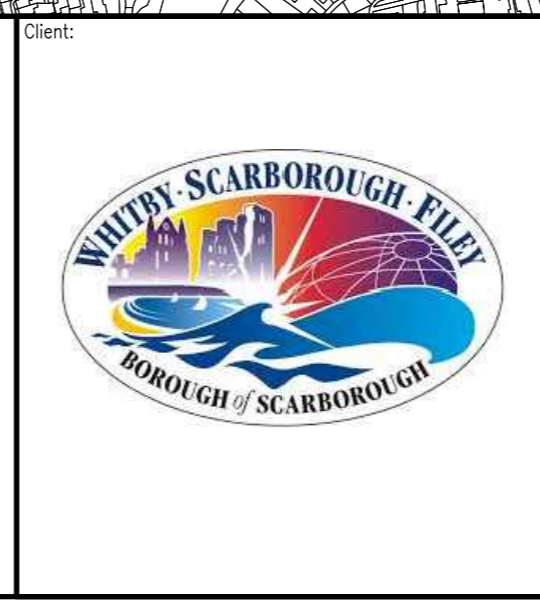

FAIRHURST		
<small>1 Amgrove Court, Barrack Road, Newcliffe-on-Tyne, NE4 6NR</small>		
Scale of A1: 1:5000	Status: Planning	
Drawn: SDR	Checked: SWG	Approved: SWG
Date: 19/03/19	Date: 21/03/19	Date: 21/03/19
Drawing No.: 128858/8001	Revision: B	

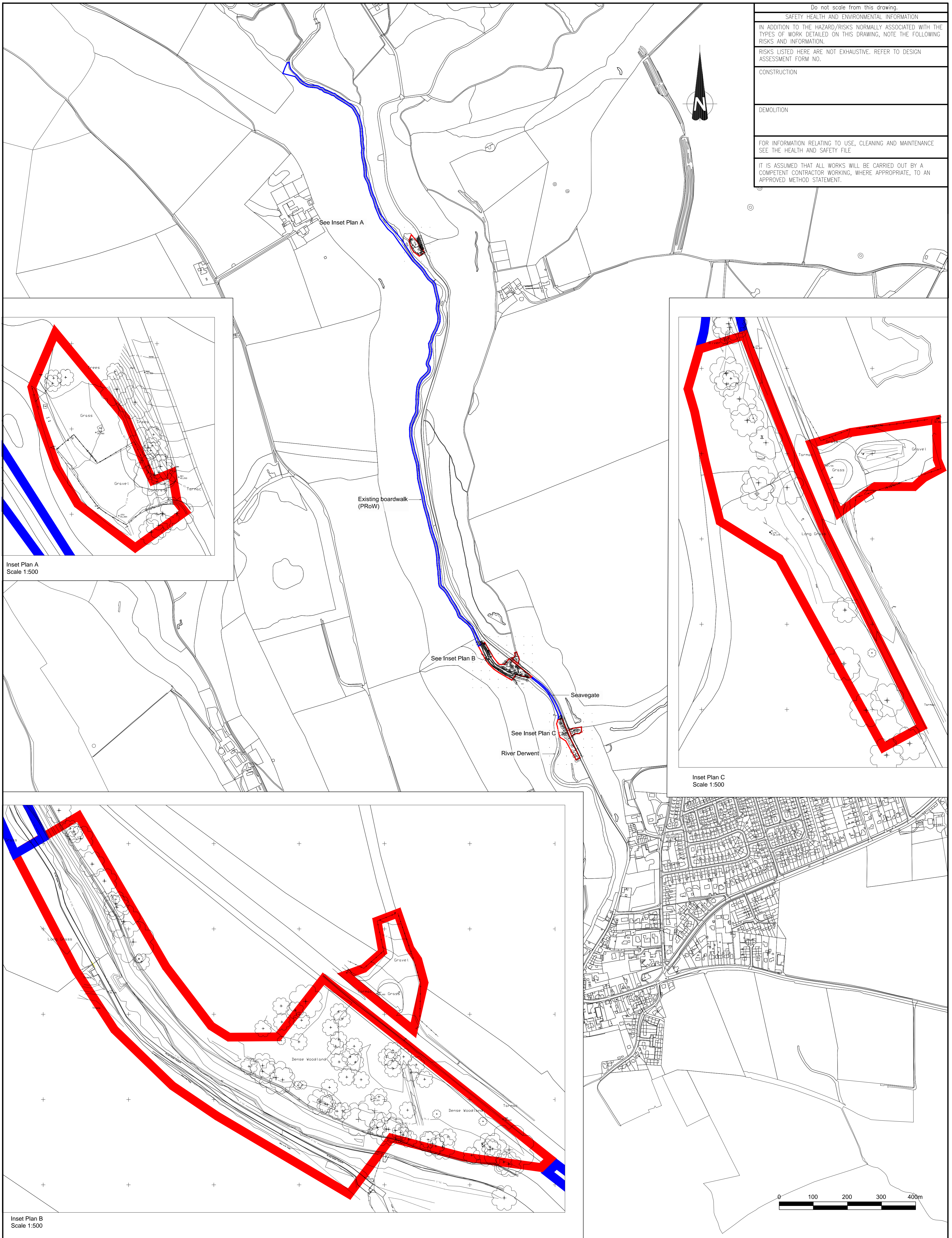

Do not scale from this drawing.

SAFETY HEALTH AND ENVIRONMENTAL INFORMATION

IN ADDITION TO THE HAZARD/RISKS NORMALLY ASSOCIATED WITH THE TYPES OF WORK DETAILED ON THIS DRAWING, NOTE THE FOLLOWING RISKS AND INFORMATION.

RISKS LISTED HERE ARE NOT EXHAUSTIVE. REFER TO DESIGN ASSESSMENT FORM NO.

CONSTRUCTION

DEMOLITION

FOR INFORMATION RELATING TO USE, CLEANING AND MAINTENANCE SEE THE HEALTH AND SAFETY FILE

IT IS ASSUMED THAT ALL WORKS WILL BE CARRIED OUT BY A COMPETENT CONTRACTOR WORKING, WHERE APPROPRIATE, TO AN APPROVED METHOD STATEMENT.



Inset Plan A
Scale 1:500



Inset Plan C
Scale 1:500



Inset Plan B
Scale 1:500

<p>NYMNPA</p> <p>20/06/2019</p>		
Rev.	Date	Description

Notes:
 Reproduced by permission of Ordnance Survey on behalf of HMSO.
 © Crown copyright and database rights 2019 Ordnance Survey
 100024267

Client:

Key

- Application Boundary
- Land Ownership Boundary



Project Title:
FORGE VALLEY

Drawing Title:
EXISTING SITE PLAN

FAIRHURST

1 Armgrove Court, Barrack Road,
 Middlesbrough, Tees Valley, Cumbria

Scale at A1: 1:5000	Status: Planning	
Drawn: NK	Checked: ER	Approved: ER
Date: 17/06/19	Date: 19/06/19	Date: 19/06/19
Drawing No.:	Revision:	
128858/8006		-

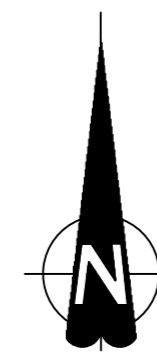

Do not scale from this drawing.

SAFETY HEALTH AND ENVIRONMENTAL INFORMATION

IN ADDITION TO THE HAZARD/RISKS NORMALLY ASSOCIATED WITH THE TYPES OF WORK DETAILED ON THIS DRAWING, NOTE THE FOLLOWING RISKS AND INFORMATION.

RISKS LISTED HERE ARE NOT EXHAUSTIVE. REFER TO DESIGN ASSESSMENT FORM NO.

CONSTRUCTION

DEMOLITION

FOR INFORMATION RELATING TO USE, CLEANING AND MAINTENANCE SEE THE HEALTH AND SAFETY FILE

IT IS ASSUMED THAT ALL WORKS WILL BE CARRIED OUT BY A COMPETENT CONTRACTOR WORKING, WHERE APPROPRIATE, TO AN APPROVED METHOD STATEMENT.

Key

Existing

- Grass / vegetation
- Trees to be retained (refer to Arboricultural Impact Assessment)
- Road

Proposed

- Car parking
- Footpath
- Logs to provide informal seating
- Native tree planting
- Reinstated verge
- Interpretation board

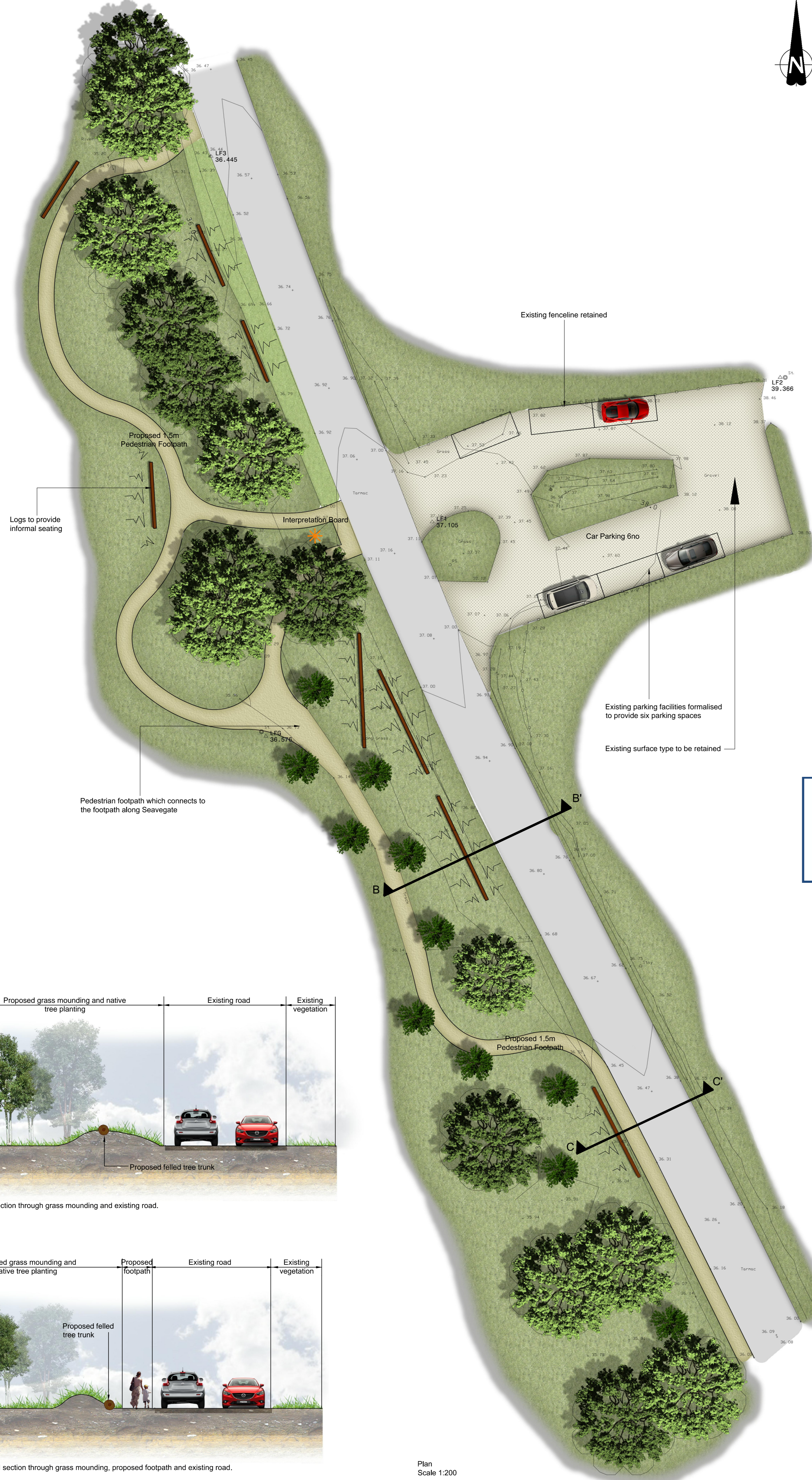

NYMNP

20/06/2019

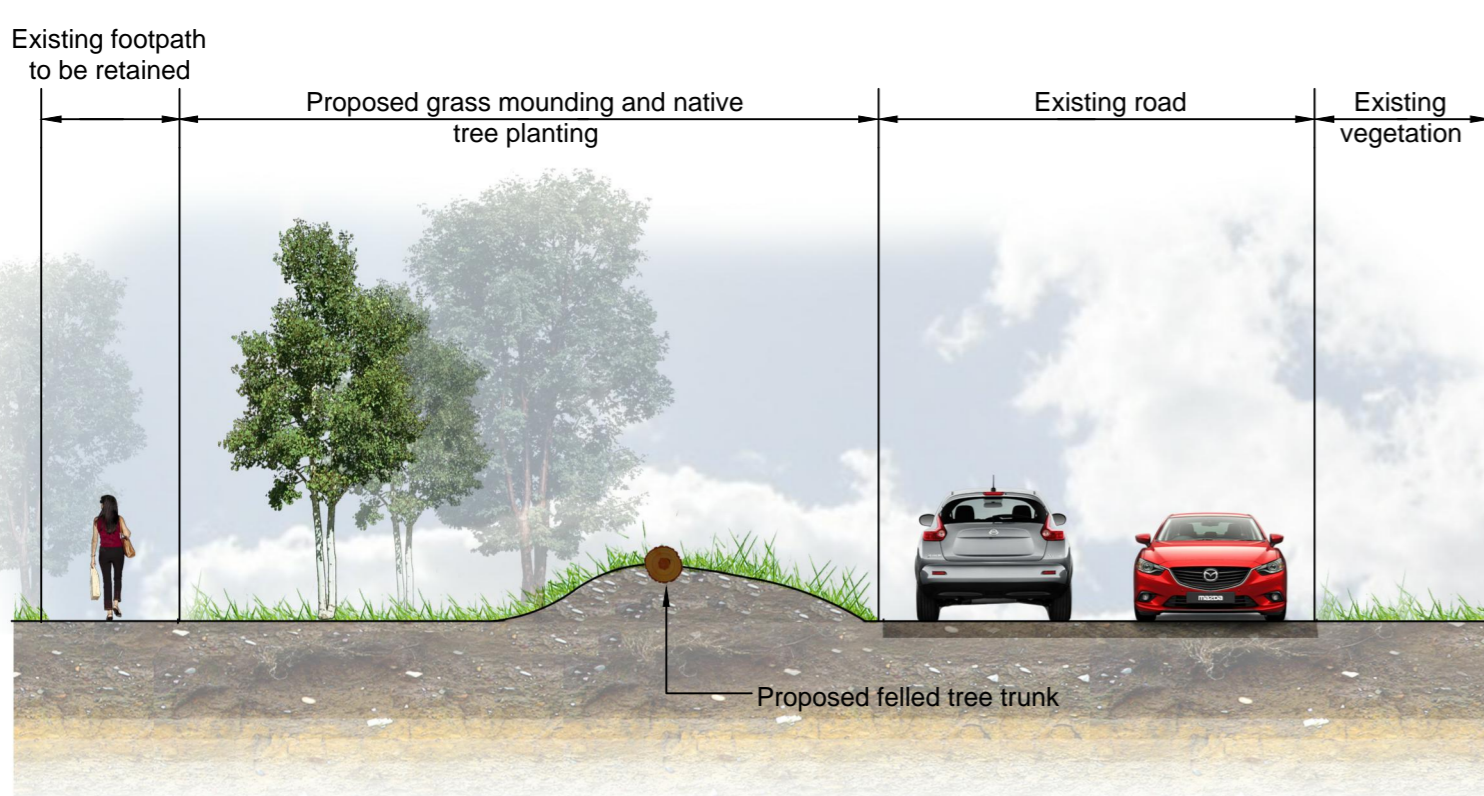

Section B-B' - Typical section through grass mounding and existing road.
Scale 1:100

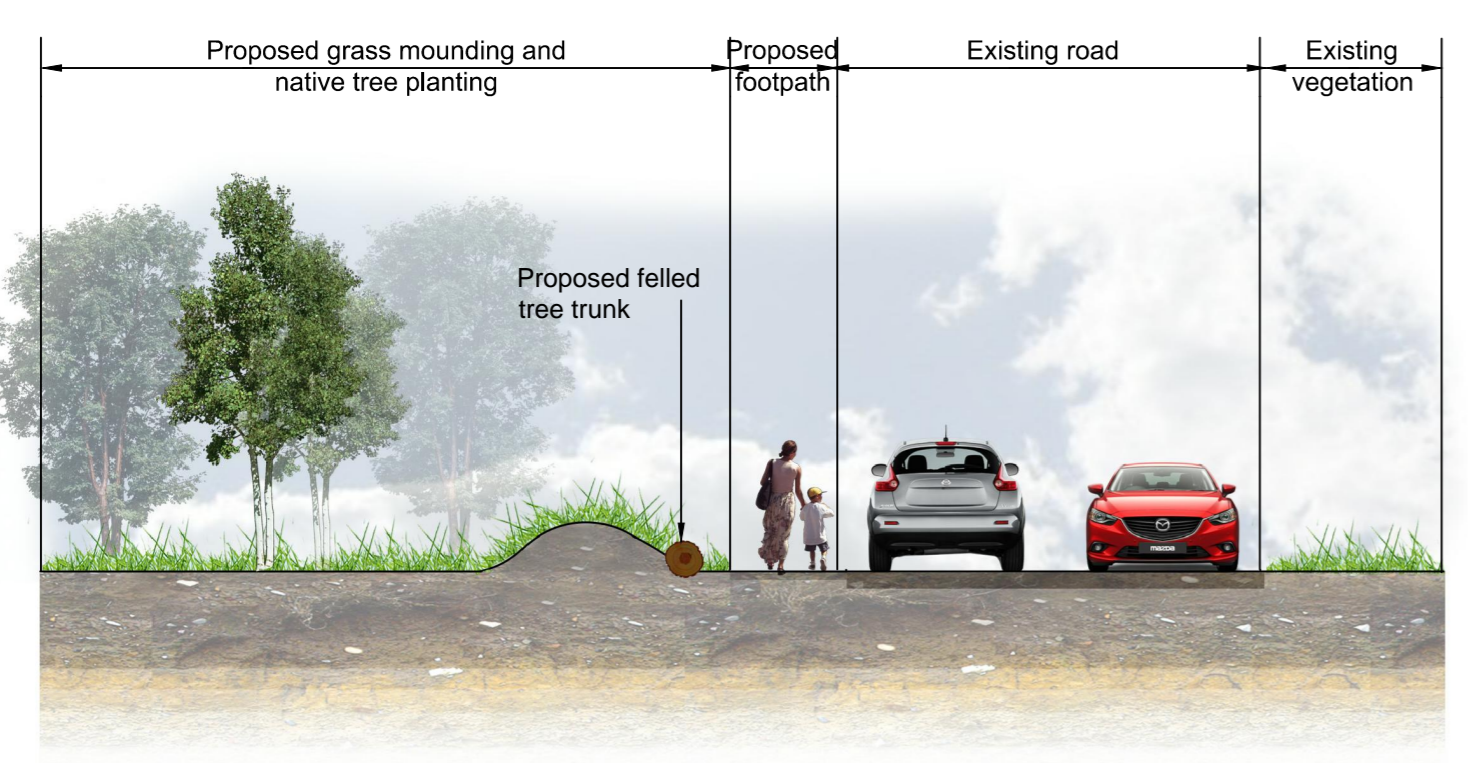

Section C-C' - Typical section through grass mounding, proposed footpath and existing road.
Scale 1:100

Plan
Scale 1:200



Rev.	Date	Description	Drawn	Checked	Approved
D	11/06/19	TITLE AMENDMENT	NK	ER	ER
C	06/06/19	REVISED FOLLOWING CLIENT COMMENTS	SDR	ER	ER
B	04/06/19	REVISED FOLLOWING PUBLIC CONSULTATION AND CLIENT COMMENTS	SDR	ER	ER
A	15/05/19	MINOR AMENDMENTS	SDR	SWG	SWG

Notes:
Drawing based on Landform Surveys Topographic Survey drawing E171C-001.
To be read in conjunction with EcoNorth Arboricultural Impact Assessment (12th June 2019)



Project Title:
FORGE VALLEY

Drawing Title:
EXISTING CAR PARK AND LANDSCAPE/ FOOTPATH ENHANCEMENT

FAIRHURST		
1 Arngrove Court, Barrack Road, Scarborough, North Yorkshire YO14 4DR		
Scale at A1: AS SHOWN	Status: Planning	
Drawn: SDR	Checked: SWG	Approved: SWG
Date: 24/04/19	Date: 15/05/19	Date: 15/05/19
Drawing No.: 128858/8005	Revision: D	

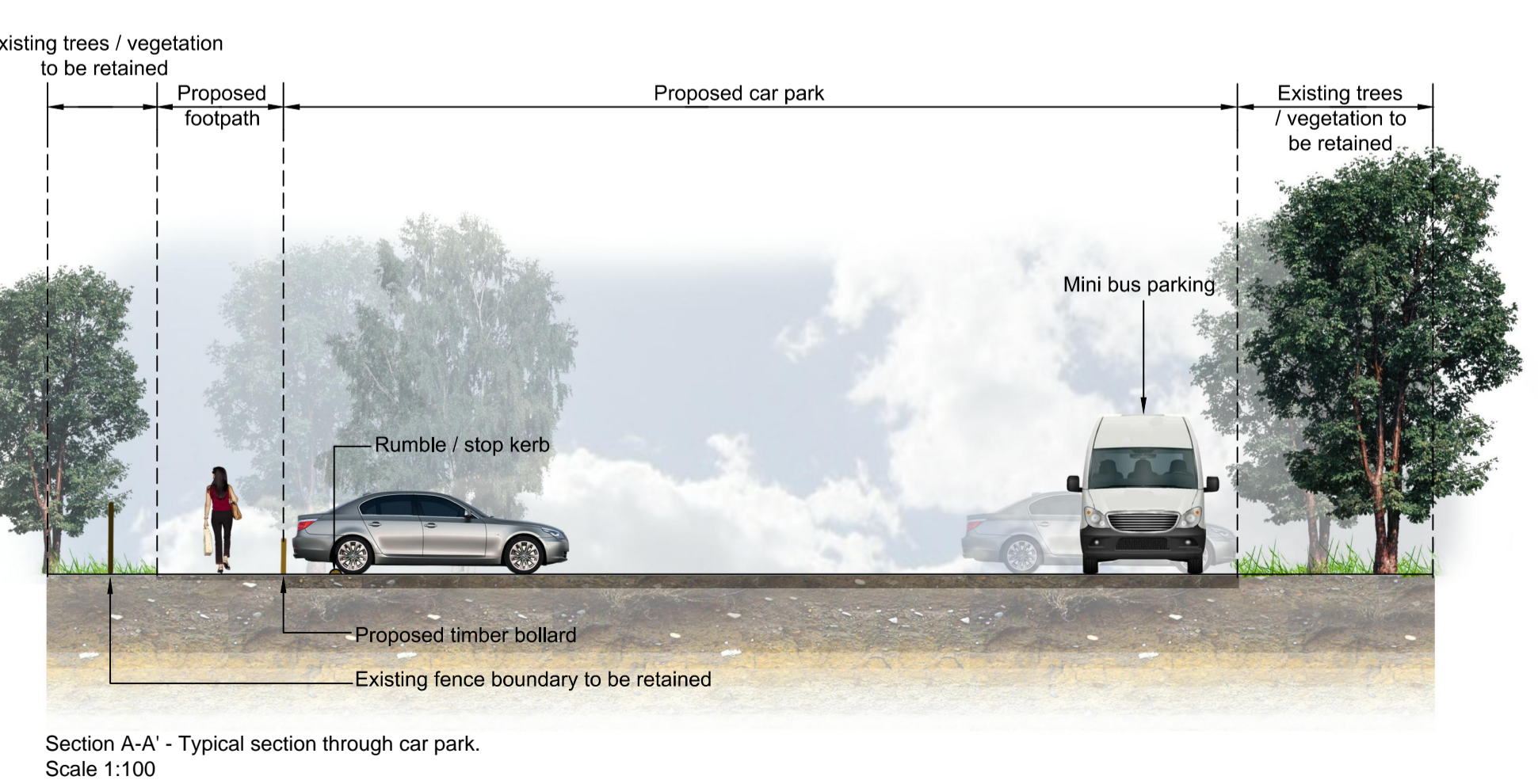
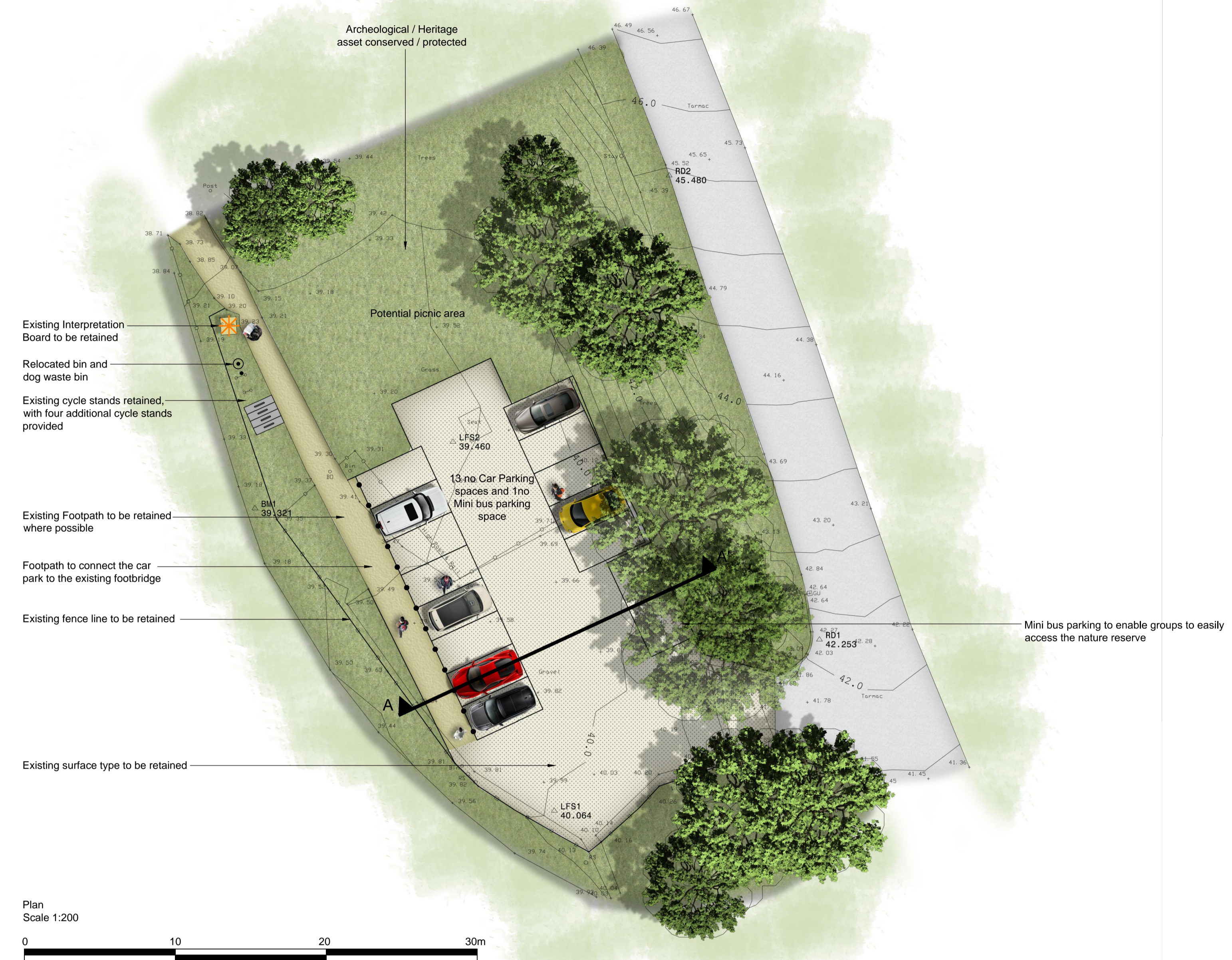
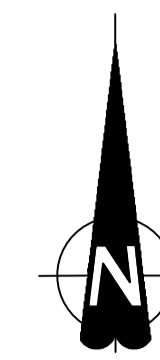

NYMNPA
 20/06/2019

Do not scale from this drawing.

SAFETY HEALTH AND ENVIRONMENTAL INFORMATION
IN ADDITION TO THE HAZARD/RISKS NORMALLY ASSOCIATED WITH THE TYPES OF WORK DETAILED ON THIS DRAWING, NOTE THE FOLLOWING RISKS AND INFORMATION.
RISKS LISTED HERE ARE NOT EXHAUSTIVE. REFER TO DESIGN ASSESSMENT FORM NO.
CONSTRUCTION
DEMOLITION
FOR INFORMATION RELATING TO USE, CLEANING AND MAINTENANCE SEE THE HEALTH AND SAFETY FILE
IT IS ASSUMED THAT ALL WORKS WILL BE CARRIED OUT BY A COMPETENT CONTRACTOR WORKING, WHERE APPROPRIATE, TO AN APPROVED METHOD STATEMENT.

Key	
Existing	
	Grass / vegetation
	Trees to be retained (refer to Arboricultural Impact Assessment)
	Road
	Footpath to be retained and made good
	Interpretation board to be retained
Proposed	
	Car park
	Relocated bin and dog waste bin
	Cycle stands
	Timber bollards

Notes:
 Drawing based on Landform Surveys Topographic Survey drawing E171A-001. To be read in conjunction with EcoNorth Arboricultural Impact Assessment (12th June 2019)

Rev.	Date	Description	Drawn	Chkd.	Appd.
B	18/04/19	REVISED FOLLOWING CLIENT COMMENTS.	SDR	ER	ER
A	19/06/19	REVISED FOLLOWING PUBLIC CONSULTATION AND CLIENT COMMENTS	SDR	ER	ER

FAIRHURST 1 Arngrove Court Borwick Road, Newcastle-upon-Tyne NE4 6DB	
---	--

Project Title:
FORGE VALLEY

Drawing Title:
CAR PARK – OLD MANS MOUTH

Scale of A1: AS SHOWN	Status: Planning
Drawn: SDR	Checked: SWG
Date: 24/04/19	Approved: SWG
Date: 15/05/19	Date: 15/05/19

Drawing No.: **128858/8003** Revision: **B**

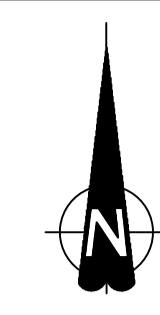

Do not scale from this drawing.

SAFETY HEALTH AND ENVIRONMENTAL INFORMATION

IN ADDITION TO THE HAZARD/RISKS NORMALLY ASSOCIATED WITH THE TYPES OF WORK DETAILED ON THIS DRAWING, NOTE THE FOLLOWING RISKS AND INFORMATION.

RISKS LISTED HERE ARE NOT EXHAUSTIVE. REFER TO DESIGN ASSESSMENT FORM NO.

CONSTRUCTION

DEMOLITION

FOR INFORMATION RELATING TO USE, CLEANING AND MAINTENANCE SEE THE HEALTH AND SAFETY FILE

IT IS ASSUMED THAT ALL WORKS WILL BE CARRIED OUT BY A COMPETENT CONTRACTOR WORKING, WHERE APPROPRIATE, TO AN APPROVED METHOD STATEMENT.

Key

Existing

- Grass / vegetation
- Trees to be retained (refer to Arboricultural Impact Assessment)
- Road
- Boardwalk to be replaced
- Fence
- River

Proposed

- Car park
- 2 No. bins (general waste and dog litter)
- Timber bollards
- Footpath
- Interpretation board
- Bridge
- Raised boardwalk
- Logs to provide formal seating
- Native tree planting

Notes:

Drawing based on Landform Surveys Topographic Survey drawing E171B-001. To be read in conjunction with EcoNorth Arboricultural Impact Assessment (12th June 2019)

Rev.	Date	Description	Drawn	Chkd.	Appd.
C	16/06/19	REVISED FOLLOWING CLIENT COMMENTS	SDR	ER	ER
B	14/06/19	REVISED FOLLOWING PUBLIC CONSULTATION AND CLIENT COMMENTS	SDR	ER	ER
A	15/05/19	MINOR AMENDMENT TO DETAIL AND CAR PARK.	SDR	SWG	SWG

FAIRHURST Client:

1 Arngrove Court
Borwick Road,
Newcastle-upon-Tyne
NE4 6DB

Project Title:

FORGE VALLEY

Drawing Title:

NEW BRIDGE CROSSING AND CAR PARKING

Scale of A1: 1:250	Status: Planning
Drawn: SDR	Checked: SWG
Date: 24/04/19	Approved: SWG
Date: 15/05/19	Date: 15/05/19

Drawing No.: **128858/8004** Revision: **C**



Location of 12m long 1.5m wide proposed footbridge. This will have a non-slip surface and will be designed to accommodate the load of a powered wheelchair

Logs to provide informal seating

Existing boardwalk to be replaced. This will have a non-slip surface and will be designed to accommodate the load of a powered wheelchair

Plan Scale 1:250

Footpath to connect the footbridge with the existing footpath along Seavegate

Existing trees / vegetation to be retained

Existing boardwalk to be replaced. This will have a non-slip surface and will be designed to accommodate the load of a powered wheelchair

12m long 1.5m wide proposed footbridge. This will have a non-slip surface and will be designed to accommodate the load of a powered wheelchair



Indicative bridge detail Scale: NTS

Proposed Interpretation Board
Logs to provide informal seating
Proposed raised boardwalk

NYMNPA
20/06/2019

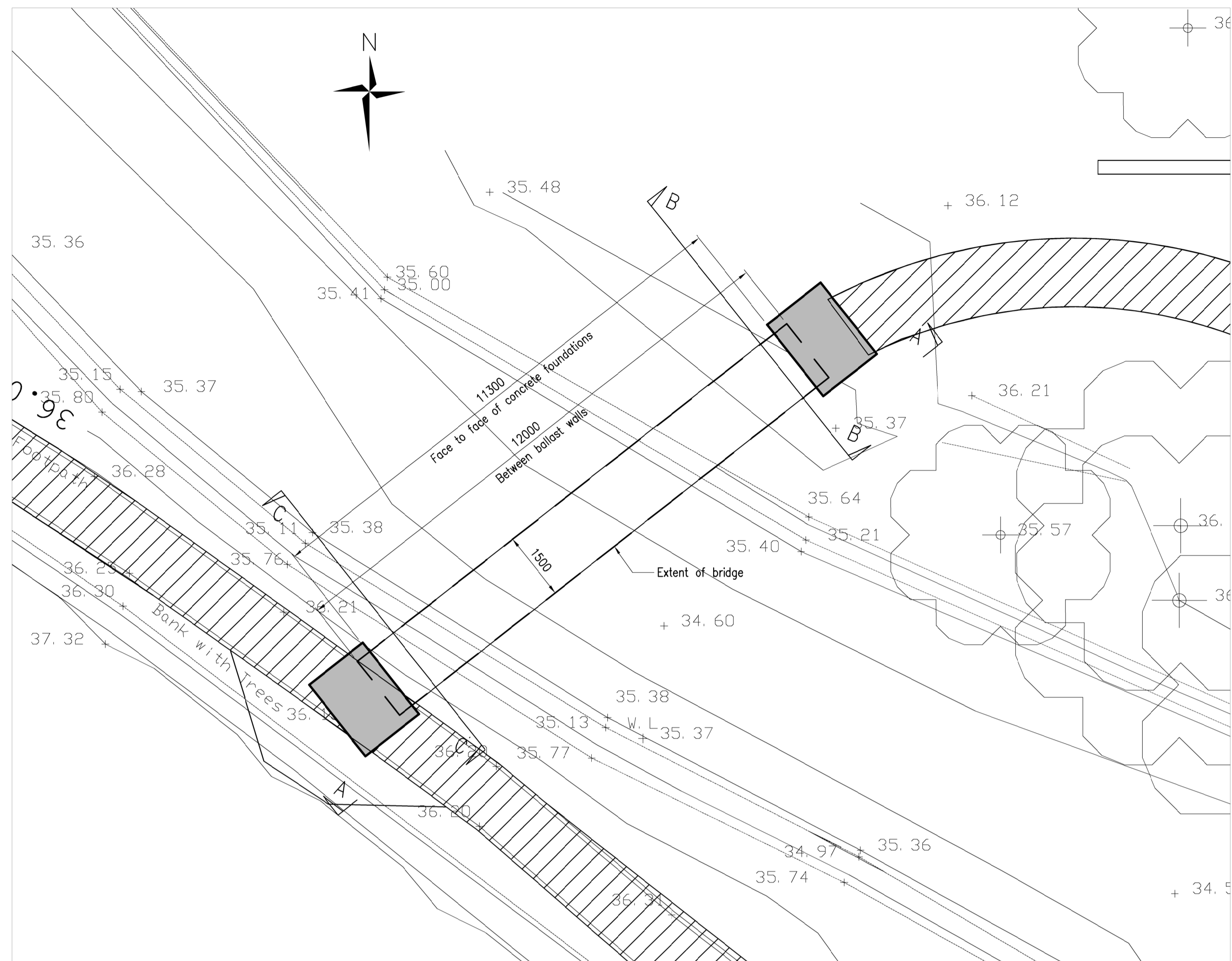

FOUNDATION PLAN
(1:75)

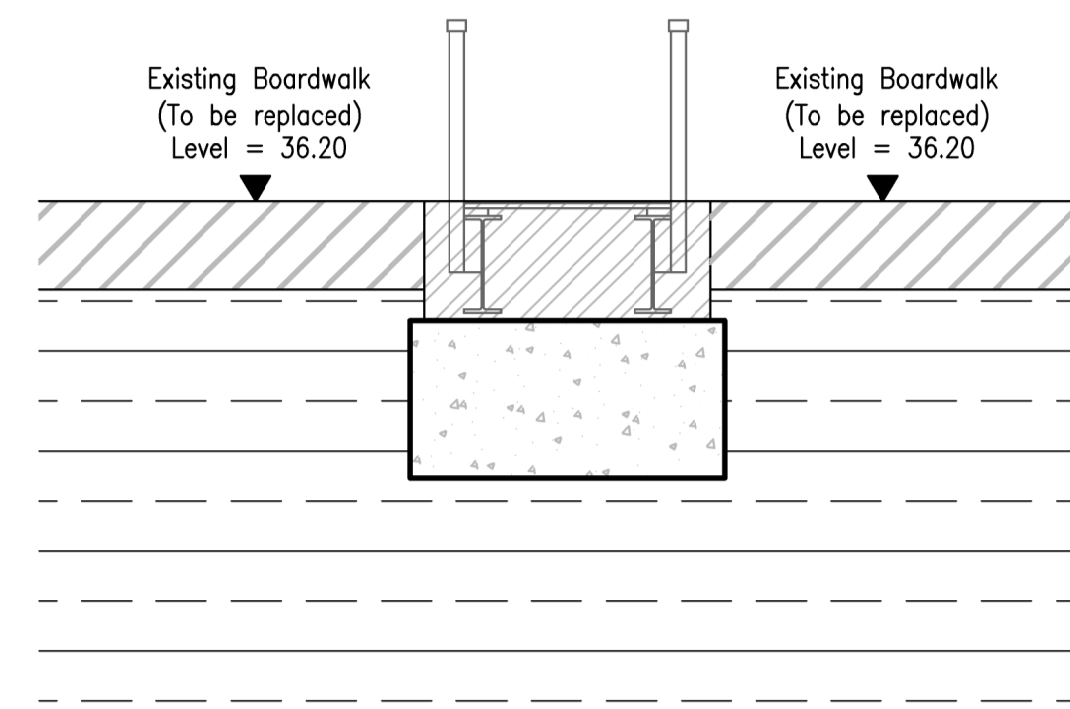

SECTIONAL ELEVATION C-C
(Scale 1:50)

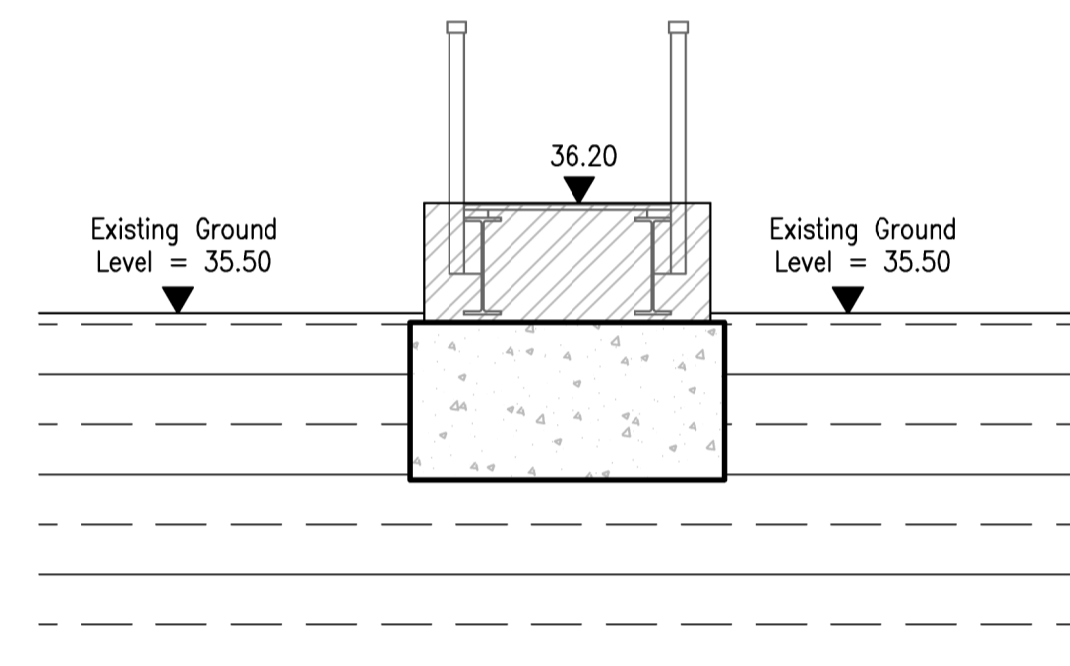

SECTIONAL ELEVATION B-B
(Scale 1:50)

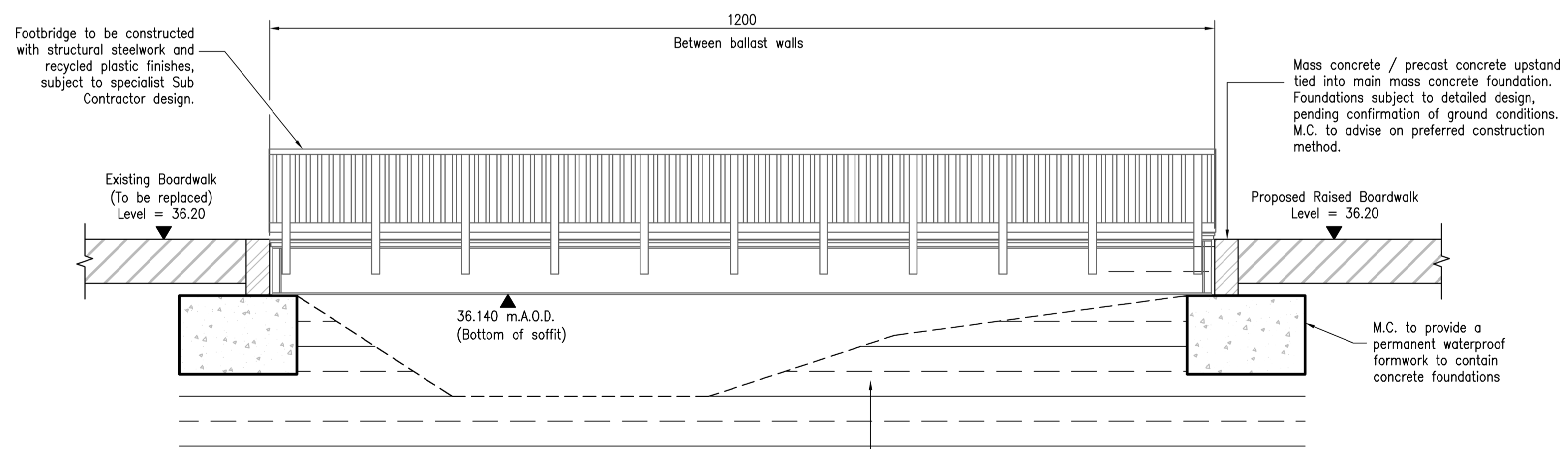

SECTION A-A
(Scale 1:50)

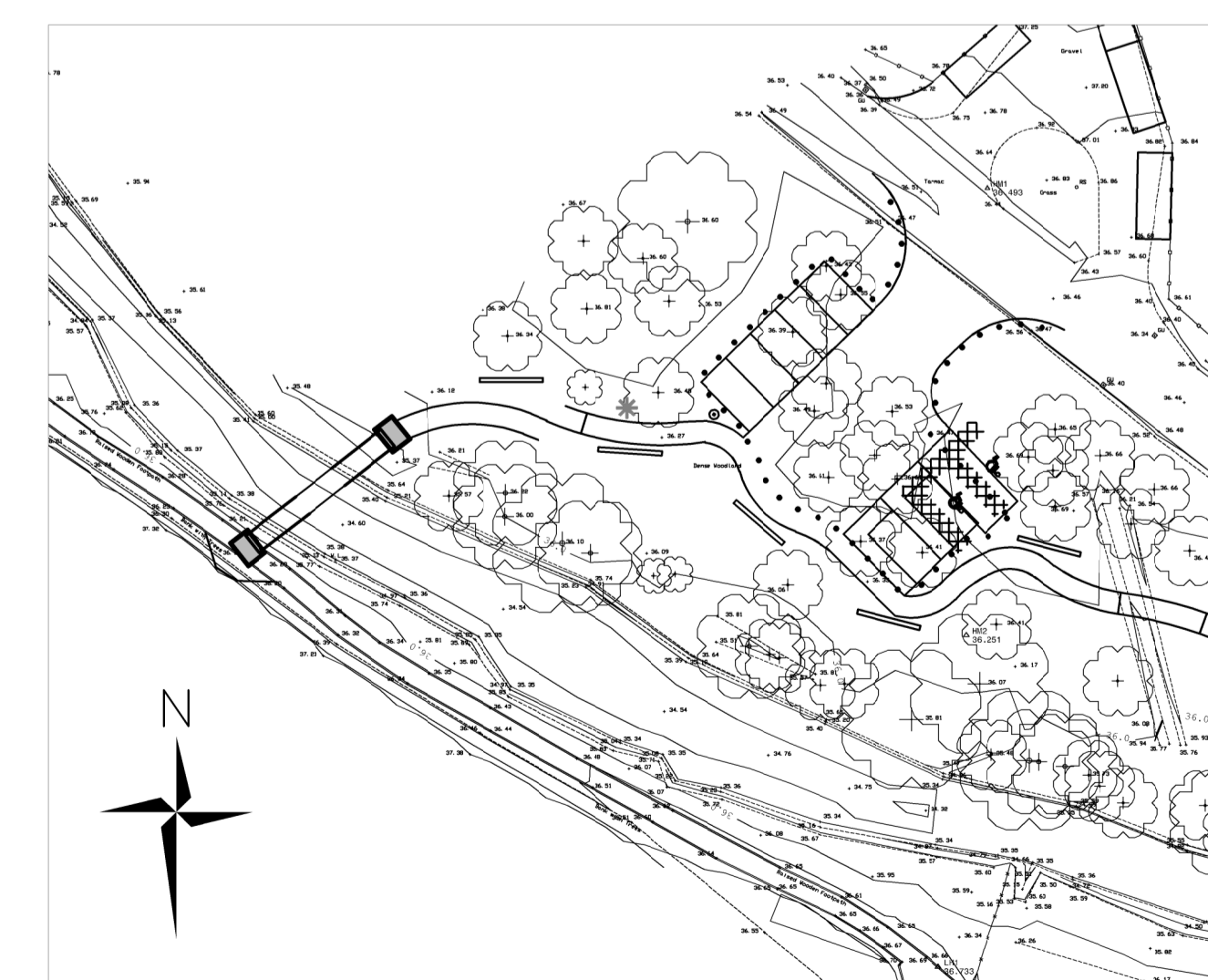

KEY PLAN
(1:500)

Do not scale from this drawing.

SAFETY HEALTH AND ENVIRONMENTAL INFORMATION

IN ADDITION TO THE HAZARD/RISKS NORMALLY ASSOCIATED WITH THE TYPES OF WORK DETAILED ON THIS DRAWING, NOTE THE FOLLOWING RISKS AND INFORMATION.

RISKS LISTED HERE ARE NOT EXHAUSTIVE. REFER TO DESIGN ASSESSMENT FORM NO.

CONSTRUCTION

DEMOLITION

FOR INFORMATION RELATING TO USE, CLEANING AND MAINTENANCE SEE THE HEALTH AND SAFETY FILE

IT IS ASSUMED THAT ALL WORKS WILL BE CARRIED OUT BY A COMPETENT CONTRACTOR WORKING, WHERE APPROPRIATE, TO AN APPROVED METHOD STATEMENT.

NYMNP
20/06/2019

Rev.	Date	Description	Drawn	Chkd	Appd.
<p>FAIRHURST Client:</p> <p>1 Arngrove Court Barrack Road, Newcastle-upon-Tyne NE4 6DB</p> <p>WHITBY SCARBOROUGH FILE BOROUGH OF SCARBOROUGH</p>					

Project Title:
FORGE VALLEY

Drawing Title:
**PROPOSED FOOTBRIDGE
PLAN & ELEVATION DETAILS**

Scale at A1:	Status:
AS SHOWN	Planning
Drawn: CDC	Checked: SC
Date: 18/06/19	Approved: JMM
Date: 19/06/19	Date: 19/06/19
Date: 19/06/19	Date: 19/06/19

Drawing No.: **128858/3000** Revision: -