

NYMNP

12/07/2019

From: Andy Rollinson
Sent: 12 July 2019 16:47
To: Maria Calderon
Cc: Hilary Saunders; Office
Subject: FW: Emailing: lighting detail Thirley Cotes Farm.

FYI

Andy

Rollinson Planning Consultancy Ltd

80 Main Street Menston Ilkley West Yorkshire LS29 6HS

Registered company number 6856004

-----Original Message-----

From: Office

Sent: 12 July 2019 16:43

To: Andy Rollinson

Peter Durbin

mark

Subject: Emailing: lighting detail Thirley Cotes Farm.

Hi Andy

External lighting detail as requested.

The light fittings are the ones that we have already used on the rest of the development and as the photograph.

Regards David.

Your message is ready to be sent with the following file or link attachments:

lighting detail

Note: To protect against computer viruses, email programs may prevent you from sending or receiving certain types of file attachments. Check your email security settings to determine how attachments are handled.

NYMNPA

12/07/2019

woodland for cottages

existing site treatment system

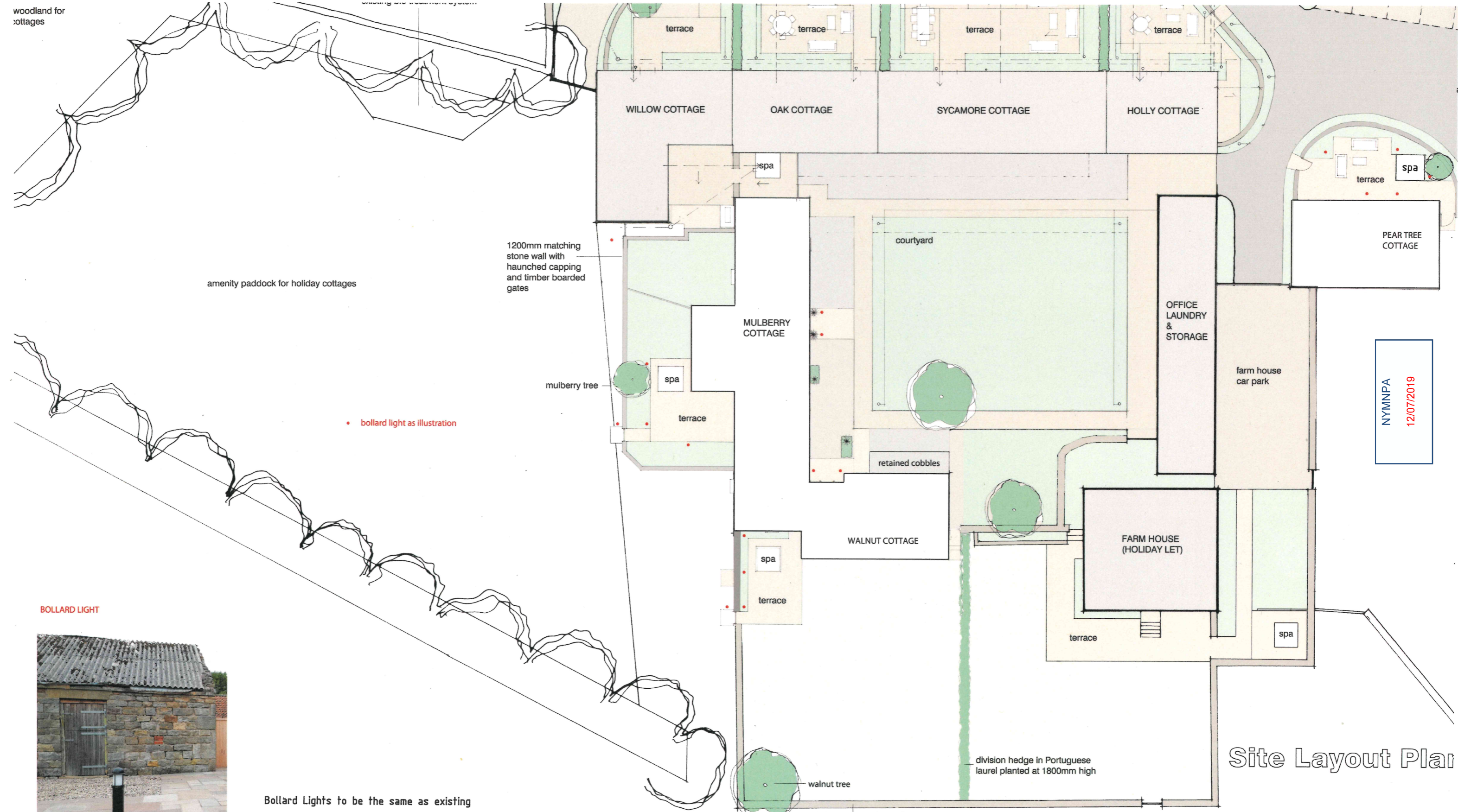

amenity paddock for holiday cottages

1200mm matching stone wall with haunched capping and timber boarded gates

mulberry tree

• bollard light as illustration

retained cobbles

division hedge in Portuguese laurel planted at 1800mm high

walnut tree

existing stone garden wall

NYMNP
12/07/2019

BOLLARD LIGHT

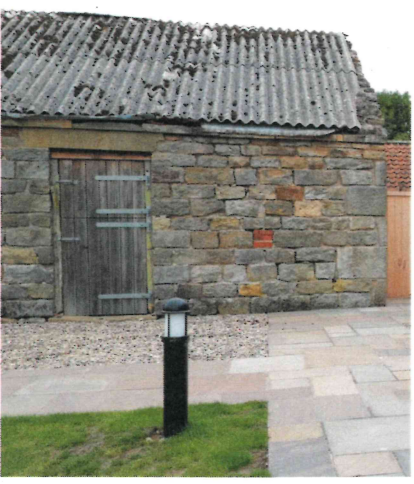

Bollard Lights to be the same as existing

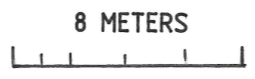

Site Layout Plan

External Lighting Layout
Thirley Cotes Farm.
12/7/19.