

**From:**  
**Sent:** 04 November 2019 14:02  
**To:** Ailsa Teasdale  
**Subject:** NYM2019/0480/FL The Willows, Low Newbiggin North Farm

**Ref: NYM/2019/0480/FL**

Dear Ailsa

Further to your recent e-mail please find attached a copy of our amended planning drawing no 6029G.19.08D for your approval. We added the missing roof light, on the plan to make five. The rear roof lights are 560 x 980, we have marked the en-suite window as obscure, don't really think the one over the stairs needs to be obscure. We confirm the five front roof lights are 780 x 1400.

Please substitute these in lieu of our drawings previously submitted to form part of our planning application.

Please note the red line is as previous applications and as submitted with our planning application to include garden curtilage already approved.

We look forward to receiving your support to these changes as agreed with our client at our meeting.

Should you require any further information please do not hesitate to contact me.

Kind Regards

Ursula Bradwell

*For and on behalf of*

**URSULA BRADWELL ARCHITECTS**

Church Hall

Newton Street

Whitby

North Yorkshire

YO21 1QX

Note: Do not scale. Only use figured dimensions.  
All discrepancies to be notified to this office.

# Proposed Alterations & Extensions, The Willows, Low Newbiggin, Aislaby, Whitby, North Yorks for Mr & Mrs I. Gates.



east elevation

NYMNP/PA  
04/11/2019

AMENDED

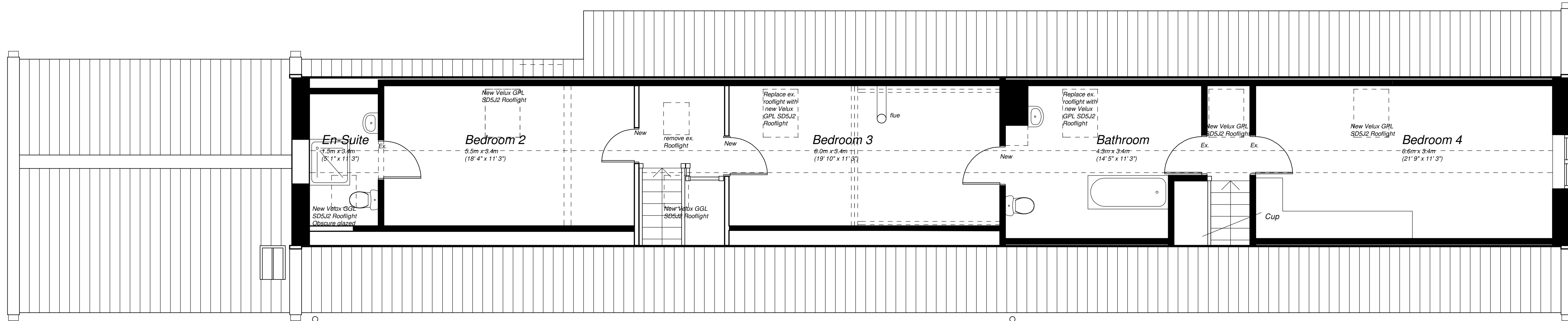

first floor plan

Rev D: Oct 19 - Roof Light Noted Rev C: Oct 19 - Extension Amended Rev B: Oct 19 - Extension Amended Rev A: Jun 19 - Client's Amendments		REVIS
<b>ub architects</b> Ursula Bradwell Architects Church Hall Newton Street Whitby North Yorks. YO21 1QX 6		 Architecture Registration Board
MR & MRS I. GATES		CLIENT
PROPOSED ALTERATIONS & EXTENSIONS		PROJECT
THE WILLOWS LOW NEWBIGGIN AISLABY WHITBY, NORTH YORKS.		ADDRESS
PROPOSED FIRST FLOOR PLAN & EAST ELEV'		DRAWING
1:50	SCALE	JUNE 2019 DATE
6029G.19.08D		DRAWING NO.
		Copyright Reserved

PLANNING DRAWING