

NYMNPA

03/02/2020

↓

---

**From:**

**Sent:** 02 February 2020 17:23

**To:** Jill Bastow

**Subject:** RE: ADDITIONAL INFO/AMENDED PLAN TO ACTION - Shepherds Hut, Hawnby - 19/0744/FL

Dear Jill

Thank you for your email confirming the Authority wish to take the application to Members on 27 February 2020.

The applicant is happy with the LPAs strategy and I am pleased to attach the revised plan showing the car parking at the Hawnby Inn with a blue line as per your request.

Should you require anything further from us please do not hesitate to contact me.

Kind regards

*Cheryl*

Cheryl Ward Planning  
MSc MRTPI

Chartered Town Planner

MSc MRTPI



www.cherylwardplanning.co.uk

Cheryl **Ward**  
Planning



This email and any files transmitted with it are confidential and intended solely for the use of the individual or entity to whom they are addressed. If you have received this email in error please contact



Before printing, think about the environment

NYMNP

03/02/2020

**From:** Jill Bastow <j.bastow@northyorkmoors.org.uk>

**Sent:** 31 January 2020 14:09

**To:** i

**Subject:** FW: ADDITIONAL INFO/AMENDED PLAN TO ACTION - Shepherds Hut, Hawnby - 19/0744/FL

Dear Cheryl

Thank you for the additional information you have submitted in respect of the above application. After further consideration and discussion with the Director of Planning I can advise that we propose to report the application to the next available Planning Committee meeting on 27 February 2020 with a recommendation of approval. The Director of Planning is of the opinion that as the proposal would be contrary to the currently adopted Development Policy 16 he is unable to grant planning permission under delegated powers but given that it would comply with the thrust of the emerging Local Plan he would support a recommendation of approval for Members to consider.

In the meantime I would be grateful if you could ensure that the proposed car parking at the Hawnby Inn is included in the blue line of additional land in the estate's ownership so that it can be suitably tied to any forthcoming planning permission.

Regards,

**Jill Bastow**

Senior Planning Officer

*My normal working hours are : 9am-5pm Tuesday & Wednesday; 9.15am-12.15pm Thursday;*

*9.45am-2.15pm Friday*

North York Moors National Park Authority

Old Vicarage

Bondgate

Helmsley

YO62 5BP

☎: 01439 772700

🌐: [www.northyorkmoors.org.uk](http://www.northyorkmoors.org.uk)

---

**From:**  
**Sent:** 20 January 2020 09:18  
**To:** Jill Bastow  
**Cc:** Planning; Chris France  
**Subject:** Shepherds Hut, Hawnby - 19/0744/FL

Dear Jill

We are grateful to have the opportunity to submit further information in relation to the above scheme. Please find further correspondence comprising:

- Letter and supporting information.
- Amended site plan with landscaping and lighting.
- Photographic schedule.
- Photographic examples of other similar development in the NY Moors.

It is hoped that the above provides some clarification for the purposes of your recent correspondence and with respect to the issues raised. Should you require further information please don't hesitate to contact me and we will do all that we can to assist.

Kind regards

*Cheryl Ward*

Cheryl Ward Planning  
MSc MRTPI



Chartered Town Planner  
MSc MRTPI



 [www.cherylwardplanning.co.uk](http://www.cherylwardplanning.co.uk)

Cheryl **Ward**  
Planning



This email and any files transmitted with it are confidential and intended solely for the use of the individual or entity to whom they are addressed. If you have received this email in error please contact

printing, think about the environment

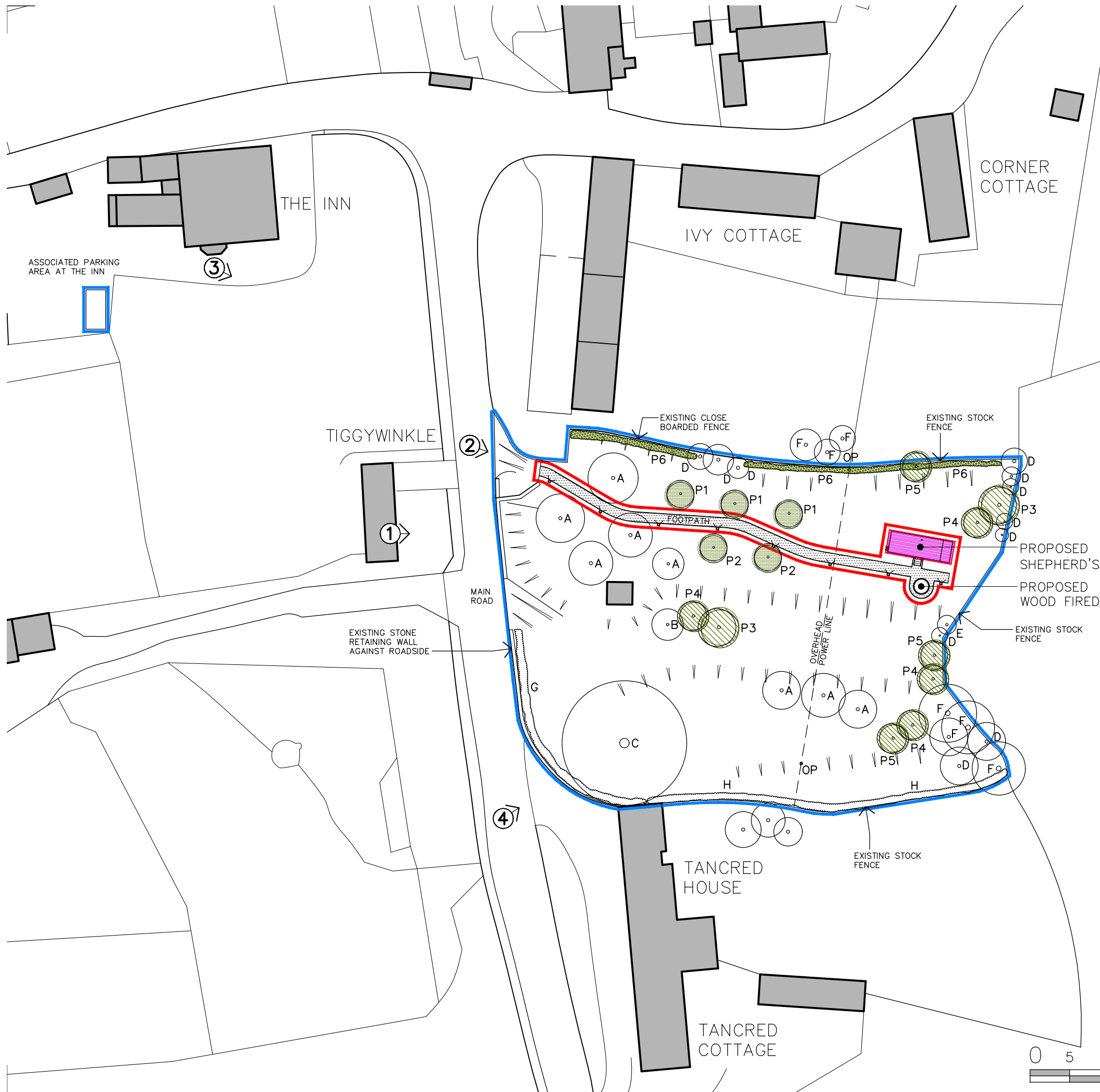

**EXISTING TREES & HEDGES**

- EXISTING TREES ON SITE:
- A APPLE
  - B ELDER
  - C BEECH
  - D HOLLY
  - E CHERRY
  - F MIXED CONIFER

- EXISTING HEDGEROWS ON SITE:
- G HAWTHORN HEDGE (ESTABLISHED)
  - H HAWTHORN HEDGE (RECENTLY PLANTED)

**PROPOSED TREES & HEDGES**

- PROPOSED ORCHARD TREES (PLANTED AS MATURE SPECIMENS FROM WYKEHAM MATURE PLANTS):
- P1 CRAB APPLE 'Malus evereste'
  - P2 VICTORIA PLUM 'Prunus domestica 'Victoria''

- PROPOSED WOOD PASTURE TREES (PLANTED AS MATURE SPECIMENS FROM WYKEHAM MATURE PLANTS):
- P3 ENGLISH OAK 'Quercus robur'
  - P4 SMALL LEAVED LIME GREENSPIRE 'Tilia cordata 'Greenspire''
  - P5 ROWAN (MOUNTAIN ASH) 'Sorbus aucuparia'

- PROPOSED HEDGEROWS ON SITE:
- 60% HAWTHORN
  - 15% HAZEL
  - 10% BLACKTHORN
  - 10% GUELDER ROSE
  - 5% HOLLY
- 60cm PLANTS IN TWO STAGGERED ROWS, 6 PLANTS TOTAL PER METRE OF HEDGEROW

**OTHER LANDSCAPING MATERIALS**

- LIMESTONE SHINGLE FOOTPATH WITH TIMBER BOARD EDGING
- OAK BOLLARD WITH INTEGRAL, LED, WARM WHITE PATHWAY LIGHTING

**PLAN KEY**

- ① PHOTOGRAPH POINT REFERRED TO IN ADDITIONAL DOCUMENT: "EXISTING SITE PHOTOS"
- OP OVERHEAD POWER LINE & POLE
- ||| EXISTING EMBANKMENT

GENERAL NOTES:  
 THIS DRAWING IS THE COPYRIGHT OF THE ARCHITECT. DO NOT SCALE AND REFER ONLY TO FIGURED DIMENSIONS. CONTRACTOR TO VERIFY ALL CONDITIONS AND DIMENSIONS BY ON SITE INSPECTION. NOTIFY ARCHITECT IMMEDIATELY OF ANY DISCREPANCIES. THESE DRAWINGS ARE TO BE READ IN CONJUNCTION WITH THE MECHANICAL CONSULTANTS STRUCTURAL ENGINEERS DRAWINGS AND THE TENDER DOCUMENTS.

AMENDED

NYMNPA  
 03/02/2020

REV A - 02-02-20  
 BLUE OUTLINE ADDED TO ALLOCATED PARKING AREA TO IDENTIFY APPLICANT OWNERSHIP

**rogerson** LIMITED  
 The Old Post Office  
 Stonegrave  
 North Yorkshire  
 YO62 4LJ

PROJECT  
 PROPOSED SHEPHERD'S HUT  
 LAND NORTH OF TANCREC HOUSE  
 HAWNBY

DRAWING  
 PROPOSED SITE PLAN

SCALE 1:500 @ A3  
 DATE JAN 2020  
 DRAWING NO. MEX/HUT/SP.100  
 REVISION A

