

**SITE LOCATION**  
(Scale 1:50000)

Ordnance Survey map extract based upon Landranger map series with the permission of the controller of Her Majesty's Stationery Office  
Mono Consultants Limited licence No. ES100017753  
Crown copyright.

**NYMNP**  
25/03/2020

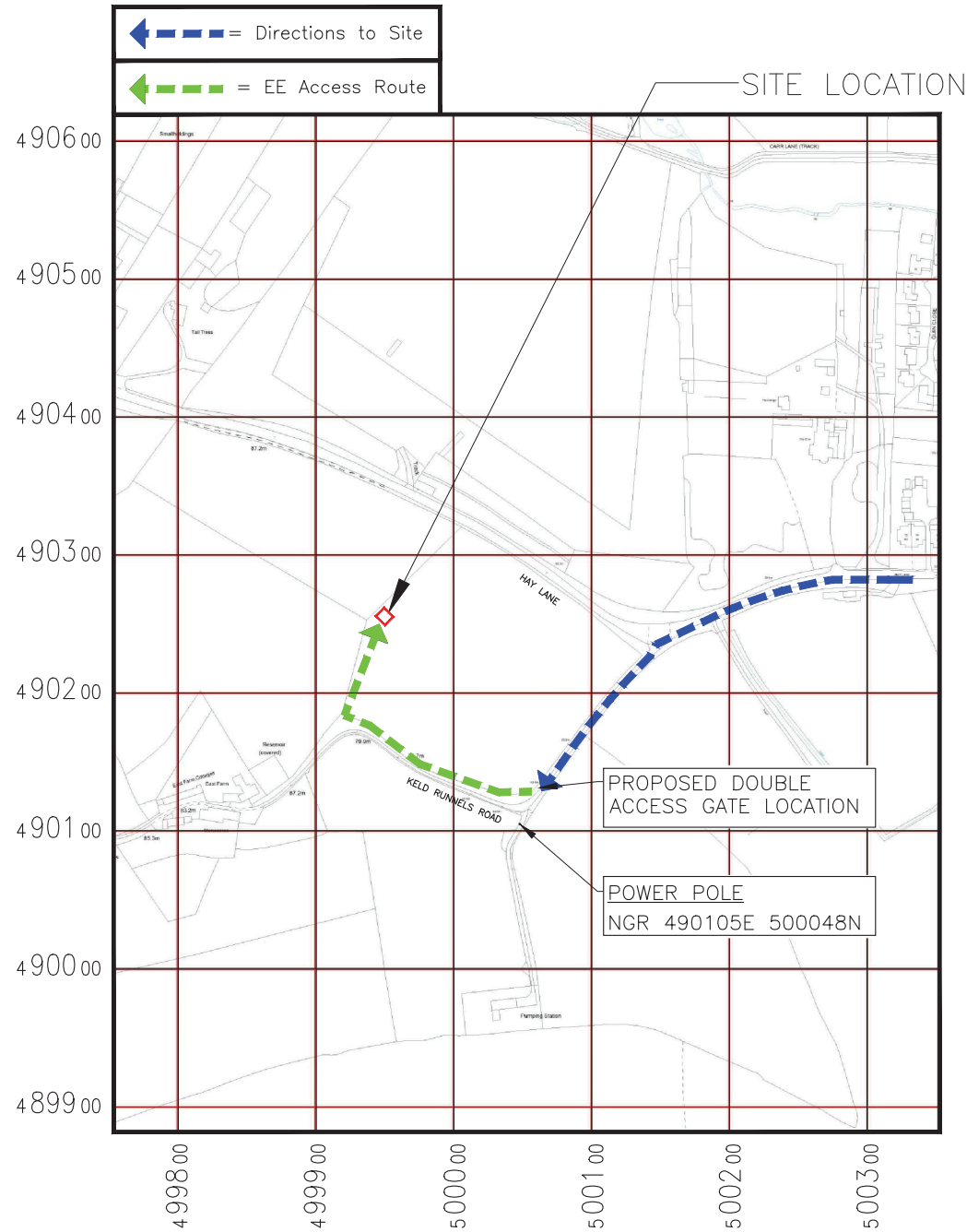

**DETAILED SITE LOCATION**  
(Scale 1:5000)

Based upon Ordnance Survey map extract with the permission of the Controller of Her Majesty's Stationery Office.  
Crown copyright.  
Mono Consultants Limited licence No. ES100017753  
Promap licence No. A152065A0001

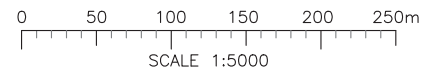

**SITE PHOTOGRAPH**

ACCESS NOTES:

FROM SCALBY CENTRE, FOLLOW A171 SCALBY ROAD THROUGH VILLALOW CHURCH HILL (NAGS HEAD INN ON LHS). FOLLOW ROAD ONTO HAY LANE, FOLLOW HAY LANE FOR APPROX 1/2 MILE (PAST WORDSWORTH CLOSE. TAKE 1ST LEFT, FOLLOW THIS ROAD UNTIL YOU COME TO 1ST BEND. THERE IS A GATE ON THE RHS, THAT IS THE FIELD, SITE AT THE TOP LEFT OF THE FIELD – PARKING AT SIDE OF ROAD. PROPOSED 6.0m WIDE DOUBLE ACCESS GATES TO BE INSTALLED BEFORE BEND AND PERMANENT 198m LONG x 3.0m WIDE GRAVEL HARDSTANDING TRACK FROM NEW ACCESS GATES TO SITE COMPOUND.

CONSTRUCTION ACCESS:

CONSTRUCTION ACCESS FROM PROPOSED 6.0m WIDE DOUBLE ACCESS GATES TO BE INSTALLED BEFORE BEND AND PERMANENT 198m LONG x 3.0m WIDE GRAVEL HARDSTANDING TRACK FROM NEW ACCESS GATES TO SITE COMPOUND.

MAINTENANCE ACCESS TO FOLLOW SAME ROUTE

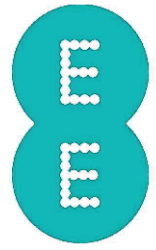

CROWN COPYRIGHT RESERVED. MAPS REPRODUCED WITH THE PERMISSION OF THE CONTROLLER OF HM'S STATIONERY OFFICE.

ALL DIMENSIONS IN mm UNLESS OTHERWISE STATED. THIS DRAWING TO BE READ IN CONJUNCTION WITH OTHER RELEVANT DRAWINGS.

N.G.R E: 499950 N: 490260

**UPGRADE REFERENCES**

–	–	–
---	---	---

DOES THE SITE DESIGN CONFORM TO RD10414	YES	NO
	✓	

IF 'NO' DETAIL THE EXCEPTIONS BELOW:

- 
- 

**ICNIRP DETAILS - RD10102/GSDD008**

ACCESS CLASSIFICATION	CONTROLLED
DESIGN CLASSIFICATION	PUBLIC

**DRAWING IN ACCORDANCE WITH:**

NOMINATION REVISION	03
NOMINATION DATE	05.12.2019

B	NOM Form Updated	SS	RW	20.03.20
A	Issued for Approval	BJ	RW	26.11.19
REV	MODIFICATION	BY	CH	DATE

**mono** #  
MONO CONSULTANTS LIMITED  
Culzean House,  
36 Renfield Street  
Glasgow,  
G2 1LU

EE REF.	79693	SITE REF.	ESN40229
---------	-------	-----------	----------

Cell Name	IEA Opt Letter
KELD RUNNELS ROAD	A

**Site Address / Contact Details**

FIELD TO NORTH OF KELD RUNNELS ROAD  
SCALBY NABS  
SUFFIELD  
SCARBOROUGH  
NORTH YORKSHIRE, YO13 0SJ

Drawing Title: SITE LOCATION MAPS

Purpose of issue: **PLANNING**

Drawing Number: ESN40229/101

Scale:	Page Size:	Drawn:	Date:	Issue:
As Shown	A3	BJ	26.11.19	
Checked:	Date:	Approved:	Date:	
RW	26.11.19	AKB	26.11.19	B

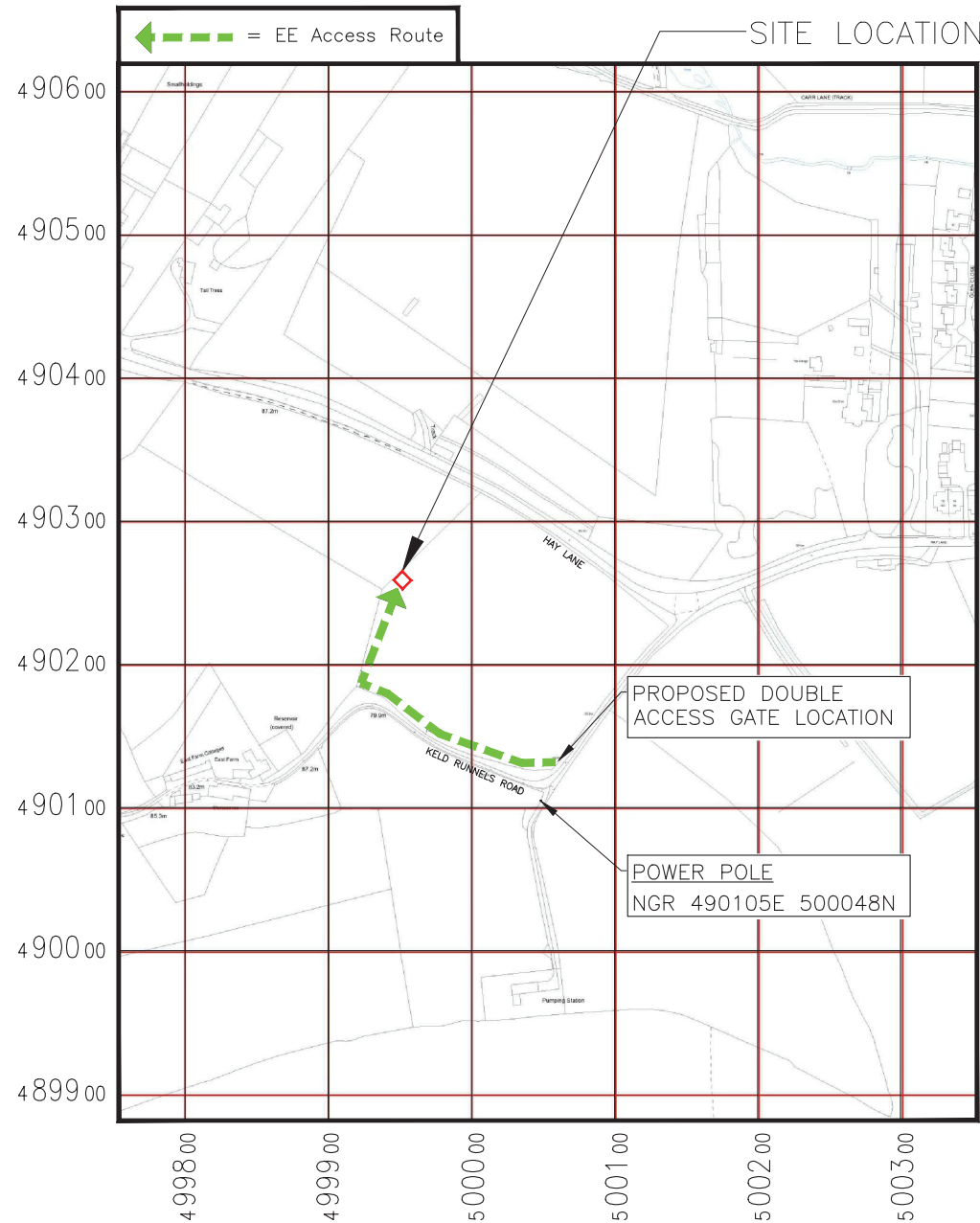
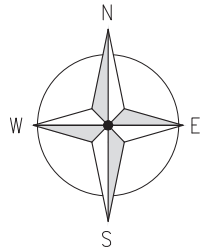

ACCESS ROUTE  
(1:5000)

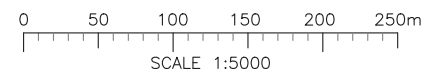

ACCESS NOTES:

FROM SCALBY CENTRE, FOLLOW A171 SCALBY ROAD THROUGH VILLALOW CHURCH HILL (NAGS HEAD INN ON LHS). FOLLOW ROAD ONTO HAY LANE, FOLLOW HAY LANE FOR APPROX 1/2 MILE (PAST WORDSWORTH CLOSE. TAKE 1ST LEFT, FOLLOW THIS ROAD UNTIL YOU COME TO 1ST BEND. THERE IS A GATE ON THE RHS, THAT IS THE FIELD, SITE AT THE TOP LEFT OF THE FIELD – PARKING AT SIDE OF ROAD. PROPOSED 6.0m WIDE DOUBLE ACCESS GATES TO BE INSTALLED BEFORE BEND AND PERMANENT 198m LONG x 3.0m WIDE GRAVEL HARDSTANDING TRACK FROM NEW ACCESS GATES TO SITE COMPOUND.

CONSTRUCTION ACCESS:

CONSTRUCTION ACCESS FROM PROPOSED 6.0m WIDE DOUBLE ACCESS GATES TO BE INSTALLED BEFORE BEND AND PERMANENT 198m LONG x 3.0m WIDE GRAVEL HARDSTANDING TRACK FROM NEW ACCESS GATES TO SITE COMPOUND.

MAINTENANCE ACCESS TO FOLLOW SAME ROUTE

NYMNPA

25/03/2020

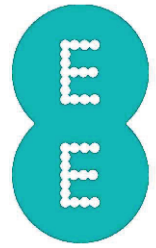

CROWN COPYRIGHT RESERVED. MAPS REPRODUCED WITH THE PERMISSION OF THE CONTROLLER OF HM's STATIONERY OFFICE.

ALL DIMENSIONS IN mm UNLESS OTHERWISE STATED. THIS DRAWING TO BE READ IN CONJUNCTION WITH OTHER RELEVANT DRAWINGS.

N.G.R E: 499950 N: 490260

UPGRADE REFERENCES

–	–	–
–	–	–
–	–	–

DOES THE SITE DESIGN CONFORM TO RD10414	YES	NO
	✓	

IF 'NO' DETAIL THE EXCEPTIONS BELOW:

- 
- 

ICNIRP DETAILS - RD10102/GSDD008

ACCESS CLASSIFICATION	CONTROLLED
DESIGN CLASSIFICATION	PUBLIC

DRAWING IN ACCORDANCE WITH:

NOMINATION REVISION	03
NOMINATION DATE	05.12.2019

B	NOM Form Updated	SS	RW	20.03.20
A	Issued for Approval	BJ	RW	26.11.19
REV	MODIFICATION	BY	CH	DATE

**mono** #  
MONO CONSULTANTS LIMITED  
Culzean House,  
36 Renfield Street  
Glasgow,  
G2 1LU

EE REF.	79693	SITE REF.	ESN40229
---------	-------	-----------	----------

<b>Cell Name</b>	<b>IEA Opt Letter</b>
KELD RUNNELS ROAD	A

**Site Address / Contact Details**  
FIELD TO NORTH OF KELD RUNNELS ROAD  
SCALBY NABS  
SUFFIELD  
SCARBOROUGH  
NORTH YORKSHIRE, YO13 0SJ

Drawing Title: ACCESS ROUTE

Purpose of issue: **PLANNING**

Drawing Number: ESN40229/102

Scale: As Shown	Page Size: A3	Drawn: BJ	Date: 26.11.19	Issue: B
Checked: RW	Date: 26.11.19	Approved: AKB	Date: 26.11.19	

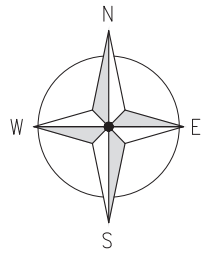

NYMNP  
25/03/2020

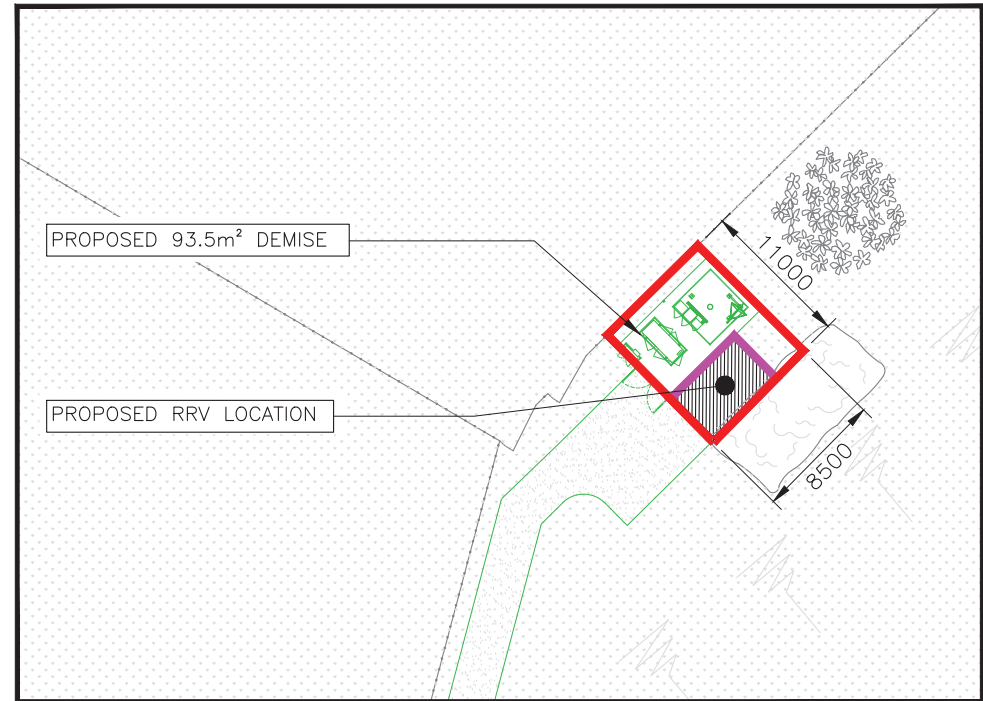
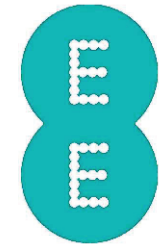

LEASE DEMISE PLAN  
(1:500)  
SCALE 1:500

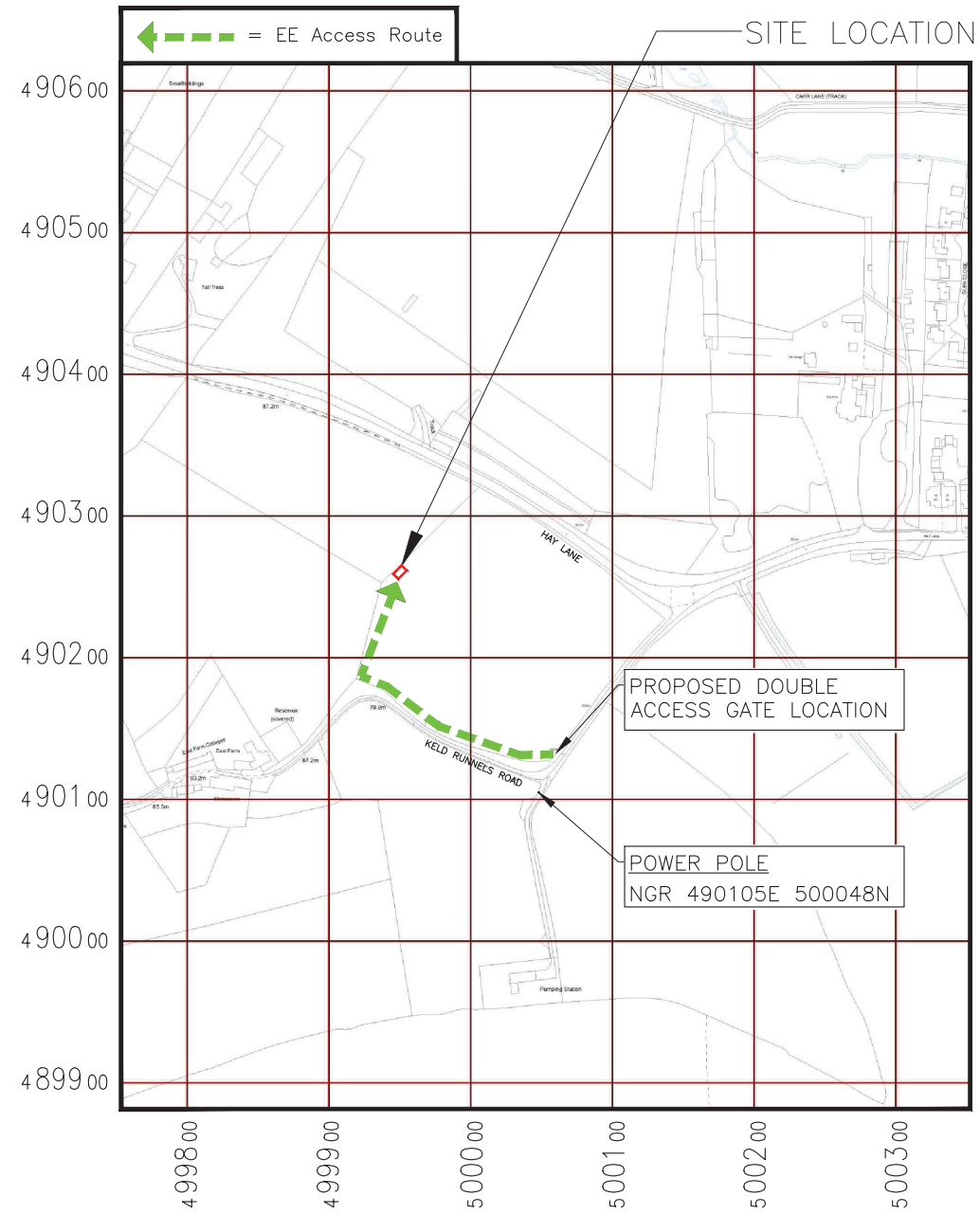

DETAILED SITE LOCATION  
(Scale 1:5000)  
Based upon Ordnance Survey map extract with the permission of the Controller of Her Majesty's Stationery Office. Crown copyright.  
Mono Consultants Limited licence No. ES100017753  
Promap licence No. A152065A0001  
SCALE 1:5000

CROWN COPYRIGHT RESERVED. MAPS REPRODUCED WITH THE PERMISSION OF THE CONTROLLER OF HM'S STATIONERY OFFICE.

ALL DIMENSIONS IN mm UNLESS OTHERWISE STATED. THIS DRAWING TO BE READ IN CONJUNCTION WITH OTHER RELEVANT DRAWINGS.

N.G.R E: 499950 N: 490260

UPGRADE REFERENCES		
-	-	-

DOES THE SITE DESIGN CONFORM TO RD10414	YES	NO
	✓	

IF 'NO' DETAIL THE EXCEPTIONS BELOW:  
1.  
2.

ICNIRP DETAILS - RD10102/GSDD008	
ACCESS CLASSIFICATION	CONTROLLED
DESIGN CLASSIFICATION	PUBLIC

DRAWING IN ACCORDANCE WITH:	
NOMINATION REVISION	03
NOMINATION DATE	05.12.2019

C	NOM Form Updated	SS	RW	20.03.20
B	Demise Amended	RP	RW	03.01.20
A	Issued for Approval	BJ	RW	26.11.19
REV	MODIFICATION	BY	CH	DATE

**mono** #  
MONO CONSULTANTS LIMITED  
Culzean House,  
36 Renfield Street  
Glasgow,  
G2 1LU

EE REF.	79693	SITE REF.	ESN40229
---------	-------	-----------	----------

Cell Name	KELD RUNNELS ROAD	IEA Opt Letter	A
-----------	-------------------	----------------	---

**Site Address / Contact Details**  
FIELD TO NORTH OF KELD RUNNELS ROAD  
SCALBY NABS  
SUFFIELD  
SCARBOROUGH  
NORTH YORKSHIRE, YO13 0SJ

Drawing Title: LEASE DEMISE LAYOUT

Purpose of issue: **PLANNING**

Drawing Number: ESN40229/103

Scale:	Page Size:	Drawn:	Date:	Issue:
As Shown	A3	BJ	26.11.19	C
Checked:	Date:	Approved:	Date:	
RW	26.11.19	AKB	26.11.19	

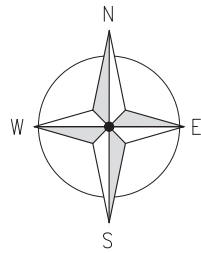

GRASS FIELD

**NOTES:**

- PROPOSED SIZE AND LOCATION OF THE STRUCTURE FOUNDATION IS SUBJECT TO CONFIRMATION, UPON COMPLETION OF STAS SEARCH, GEOTECHNICAL SURVEY AND FOUNDATION DESIGN.
- BOXED TEXT INDICATES PROPOSED WORKS
- SOP OF POLE: NGR: E499949 N490261

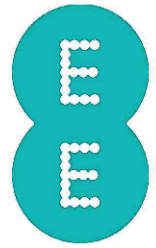

CROWN COPYRIGHT RESERVED. MAPS REPRODUCED WITH THE PERMISSION OF THE CONTROLLER OF HM'S STATIONERY OFFICE.

ALL DIMENSIONS IN mm UNLESS OTHERWISE STATED. THIS DRAWING TO BE READ IN CONJUNCTION WITH OTHER RELEVANT DRAWINGS.

N.G.R | E: 499950 N: 490260

**UPGRADE REFERENCES**

-	-	-
-	-	-
-	-	-

DOES THE SITE DESIGN CONFORM TO RD10414	YES	NO
	✓	

IF 'NO' DETAIL THE EXCEPTIONS BELOW:

- 1.
- 2.

**ICNIRP DETAILS - RD10102/GSDD008**

ACCESS CLASSIFICATION	CONTROLLED
DESIGN CLASSIFICATION	PUBLIC

**DRAWING IN ACCORDANCE WITH:**

NOMINATION REVISION	03
NOMINATION DATE	05.12.2019

B	NOM Form Updated	SS	RW	20.03.20
A	Issued for Approval	BJ	RW	26.11.19
REV	MODIFICATION	BY	CH	DATE

**mono** #  
 MONO CONSULTANTS LIMITED  
 Culzean House,  
 36 Renfield Street  
 Glasgow,  
 G2 1LU

EE REF.	79693	SITE REF.	ESN40229
---------	-------	-----------	----------

Cell Name	IEA Opt Letter
KELD RUNNELS ROAD	A

**Site Address / Contact Details**  
 FIELD TO NORTH OF KELD RUNNELS ROAD  
 SCALBY NABS  
 SUFFIELD  
 SCARBOROUGH  
 NORTH YORKSHIRE, YO13 0SJ

Drawing Title: PROPOSED SITE PLAN

Purpose of issue: **PLANNING**

Drawing Number: ESN40229/104

Scale:	Page Size:	Drawn:	Date:	Issue:
As Shown	A3	BJ	26.11.19	B
Checked:	Date:	Approved:	Date:	
RW	26.11.19	AKB	26.11.19	

EXISTING 1.2m HIGH POST & WIRE FENCE

PROPOSED 15.97m HIGH HUTCHINSON ENG. ALPHA 8 POLE ON NEW 3.6x3.6m<sup>2</sup> RC FOUNDATION. POLE TO BE FINISHED GREEN (RAL 6009)

PROPOSED 1No. GANTRY POLE & 300mm WIDE VERTICAL CABLE LADDER

PROPOSED 150mm WIDE SURFACE MOUNTED TRAY

PROPOSED M35 CABINET, FURO CABINET (LOCKABLE) AND VIPER CABINET ON RCCONCRETE TOWER FOUNDATION TO BE FINISHED GREEN (RAL 6009)

PROPOSED CONTROLLIS PRIME POWER GENERATOR ON NEW 3100x1500mm CONCRETE BASE

PROPOSED METER CABINET WITHIN FENCELINE, TO BE FINISHED GREEN (RAL 6009), ON NEW CONCRETE BASE C/W AMF PANEL & MANUAL CHANGEOVER SWITCH

EXISTING 3.6m WIDE GATE

PROPOSED ø100mm INCOMING COMMS DUCT

PROPOSED ø75mm INCOMING POWER DUCT

EXISTING 3.4m WIDE GATE

PROPOSED 3.0m WIDE, 198.0m LONG GRAVEL TRACKWAY FOR ACCESS TO BE INSTALLED C/W TURNING AREA IN FRONT OF COMPOUND

PROPOSED INFILL OF 1.2m HIGH STOCKPROOF FENCE, EITHER END OF COMPOUND

PROPOSED SATELLITE BACKHAUL DISH ON NEW SUPPORT POLE FIXED TO RC CONCRETE TOWER BASE. SATELLITE BACKHAUL DISH AND SUPPORT STEELWORK TO BE FINISHED GREEN (RAL 6009).

PROPOSED 1.2m HIGH STOCKPROOF FENCE C/W 3.0m WIDE ACCESS GATES

PROPOSED MEWP/RRV LOCATION

MANURE PILE - TO BE REMOVED BY FARM

**NYMNP**

25/03/2020

ELEVATION (DRG. No. 106)

**PROPOSED SITE PLAN**

(1:100)



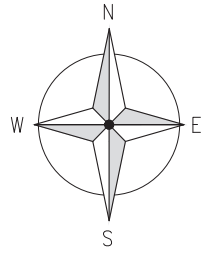

GRASS FIELD

- NOTES:
- PROPOSED SIZE AND LOCATION OF THE STRUCTURE FOUNDATION IS SUBJECT TO CONFIRMATION, UPON COMPLETION OF STAS SEARCH, GEOTECHNICAL SURVEY AND FOUNDATION DESIGN.
  - BOXED TEXT INDICATES PROPOSED WORKS
  - SOP OF POLE: NGR: E499949 N490261

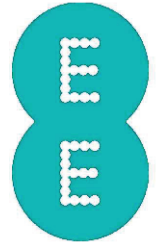

CROWN COPYRIGHT RESERVED. MAPS REPRODUCED WITH THE PERMISSION OF THE CONTROLLER OF HM'S STATIONERY OFFICE.

ALL DIMENSIONS IN mm UNLESS OTHERWISE STATED. THIS DRAWING TO BE READ IN CONJUNCTION WITH OTHER RELEVANT DRAWINGS.

N.G.R | E: 499950 N: 490260

UPGRADE REFERENCES

-	-	-
-	-	-
-	-	-

DOES THE SITE DESIGN CONFORM TO RD10414	YES	NO
	✓	

IF 'NO' DETAIL THE EXCEPTIONS BELOW:

- 1.
- 2.

ICNIRP DETAILS - RD10102/GSDD008

ACCESS CLASSIFICATION	CONTROLLED
DESIGN CLASSIFICATION	PUBLIC

DRAWING IN ACCORDANCE WITH:

NOMINATION REVISION	03
NOMINATION DATE	05.12.2019

B	NOM Form Updated	SS	RW	20.03.20
A	Issued for Approval	BJ	RW	26.11.19
REV	MODIFICATION	BY	CH	DATE

**mono** #  
 MONO CONSULTANTS LIMITED  
 Culzean House,  
 36 Renfield Street  
 Glasgow,  
 G2 1LU

EE REF.	79693	SITE REF.	ESN40229
---------	-------	-----------	----------

Cell Name	IEA Opt Letter
KELD RUNNELS ROAD	A

**Site Address / Contact Details**  
 FIELD TO NORTH OF KELD RUNNELS ROAD  
 SCALBY NABS  
 SUFFIELD  
 SCARBOROUGH  
 NORTH YORKSHIRE, YO13 0SJ

Drawing Title:  
 PROPOSED SITE ACCESS PLAN

Purpose of issue:  
 PLANNING

Drawing Number:  
 ESN40229/105

Scale:	Page Size:	Drawn:	Date:	Issue:
As Shown	A3	BJ	26.11.19	B
Checked:	Date:	Approved:	Date:	
RW	26.11.19	AKB	26.11.19	

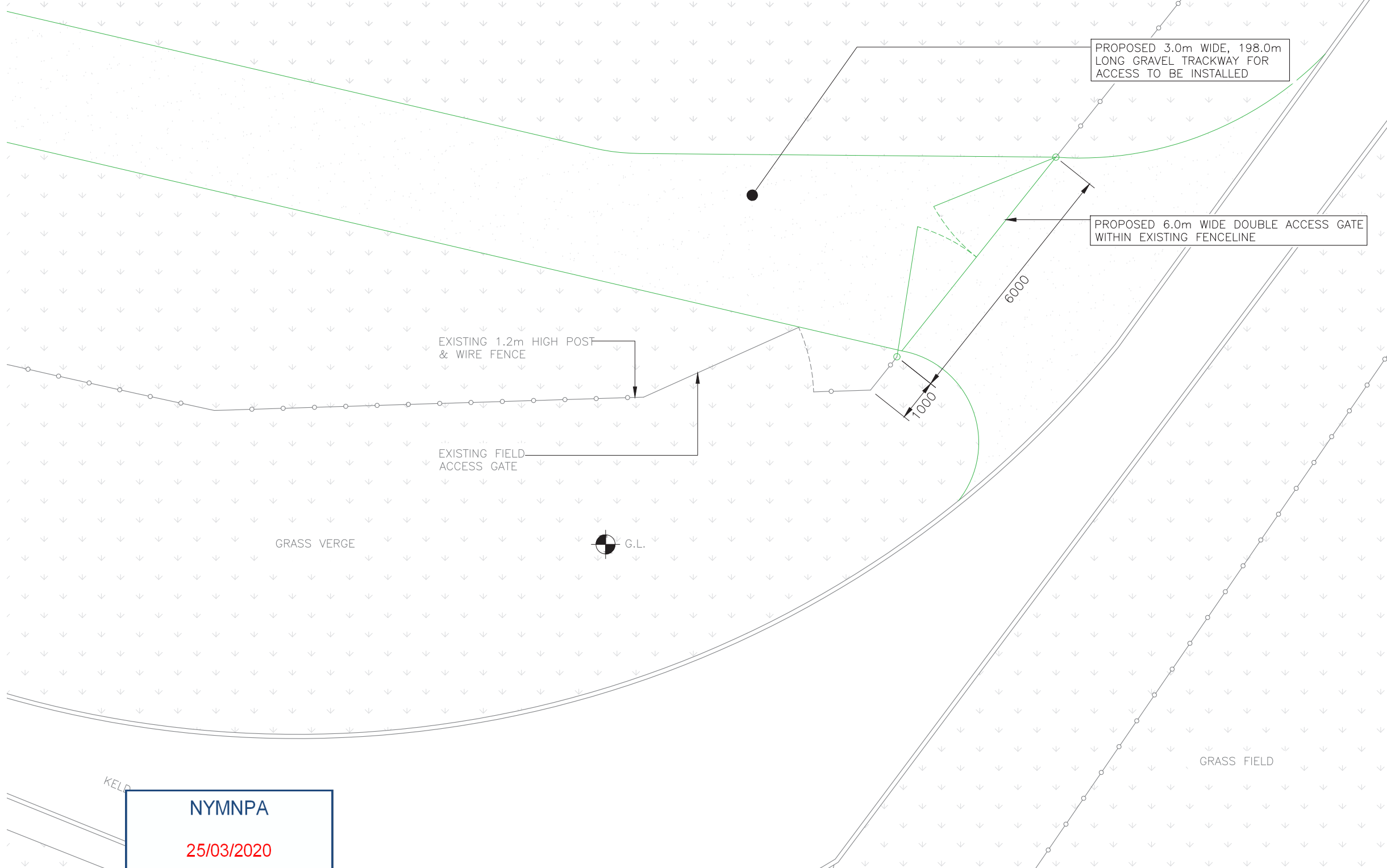

EXISTING 1.2m HIGH POST & WIRE FENCE

EXISTING FIELD ACCESS GATE

GRASS VERGE

G.L.

GRASS FIELD

**NYMNP**  
 25/03/2020

PROPOSED SITE ACCESS PLAN

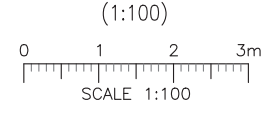

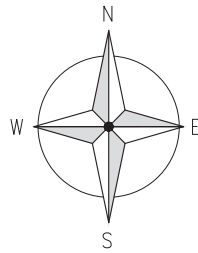

NYMNP  
25/03/2020

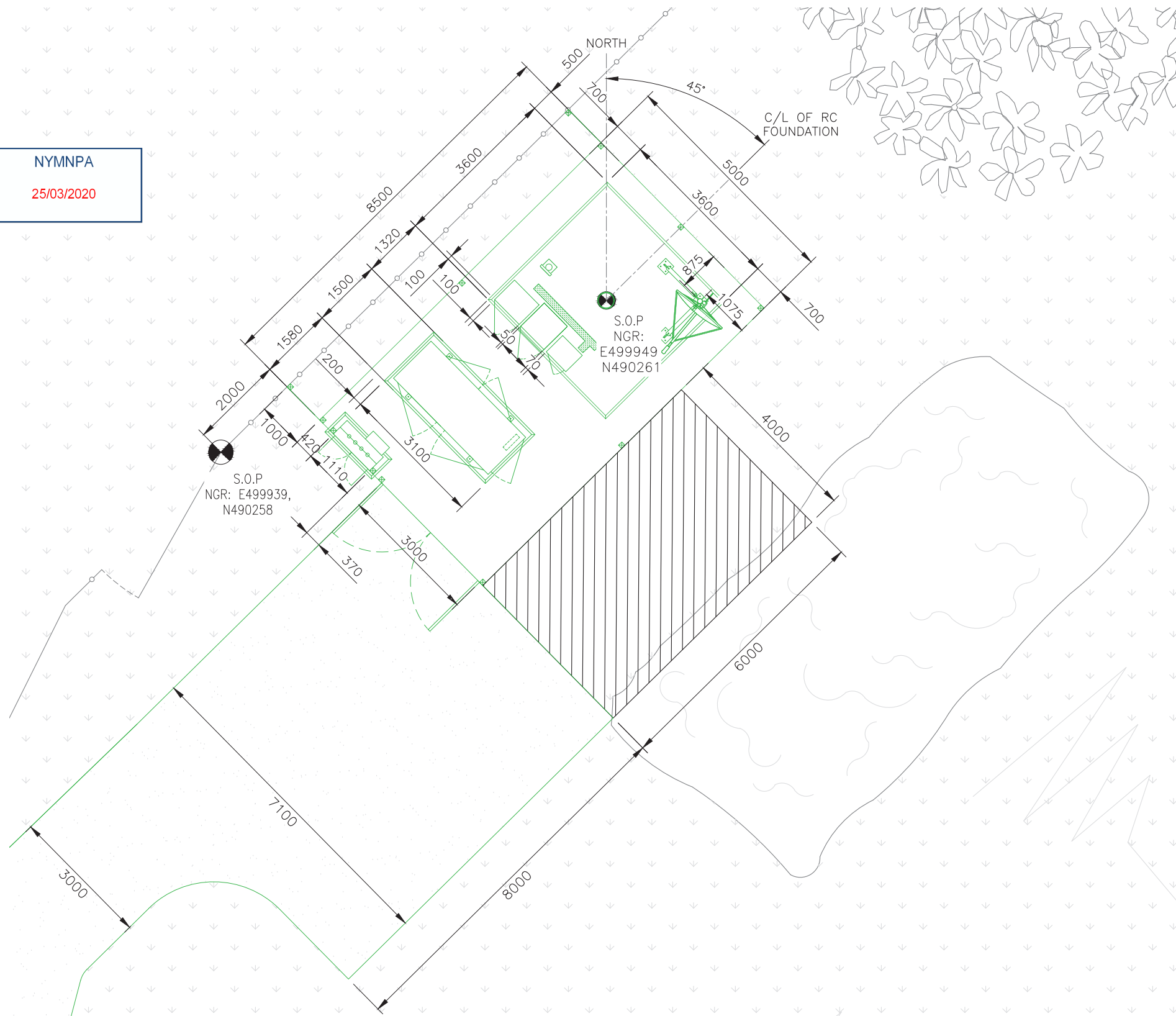

PROPOSED EQUIPMENT SETTING OUT PLAN

(1:100)

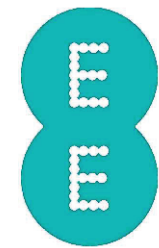

CROWN COPYRIGHT RESERVED. MAPS REPRODUCED WITH THE PERMISSION OF THE CONTROLLER OF HM'S STATIONERY OFFICE.

ALL DIMENSIONS IN mm UNLESS OTHERWISE STATED. THIS DRAWING TO BE READ IN CONJUNCTION WITH OTHER RELEVANT DRAWINGS.

N.G.R E: 499950 N: 490260

UPGRADE REFERENCES

-	-	-
-	-	-
-	-	-

DOES THE SITE DESIGN CONFORM TO RD10414	YES	NO
	✓	

IF 'NO' DETAIL THE EXCEPTIONS BELOW:

- 
- 

ICNIRP DETAILS - RD10102/GSDD008

ACCESS CLASSIFICATION	CONTROLLED
DESIGN CLASSIFICATION	PUBLIC

DRAWING IN ACCORDANCE WITH:

NOMINATION REVISION	03
NOMINATION DATE	05.12.2019

B	NOM Form Updated	SS	RW	20.03.20
A	Issued for Approval	BJ	RW	26.11.19
REV	MODIFICATION	BY	CH	DATE

**mono** #  
MONO CONSULTANTS LIMITED  
Culzean House,  
36 Renfield Street  
Glasgow,  
G2 1LU

EE REF.	79693	SITE REF.	ESN40229
---------	-------	-----------	----------

Cell Name	IEA Opt Letter
KELD RUNNELS ROAD	A

**Site Address / Contact Details**  
FIELD TO NORTH OF KELD RUNNELS ROAD  
SCALBY NABS  
SUFFIELD  
SCARBOROUGH  
NORTH YORKSHIRE, YO13 0SJ

Drawing Title:  
PROPOSED EQUIPMENT SETTING OUT PLAN

Purpose of issue:  
**PLANNING**

Drawing Number:  
ESN40229/106

Scale:	Page Size:	Drawn:	Date:	Issue:
As Shown	A3	BJ	26.11.19	B
Checked:	Date:	Approved:	Date:	
RW	26.11.19	AKB	26.11.19	

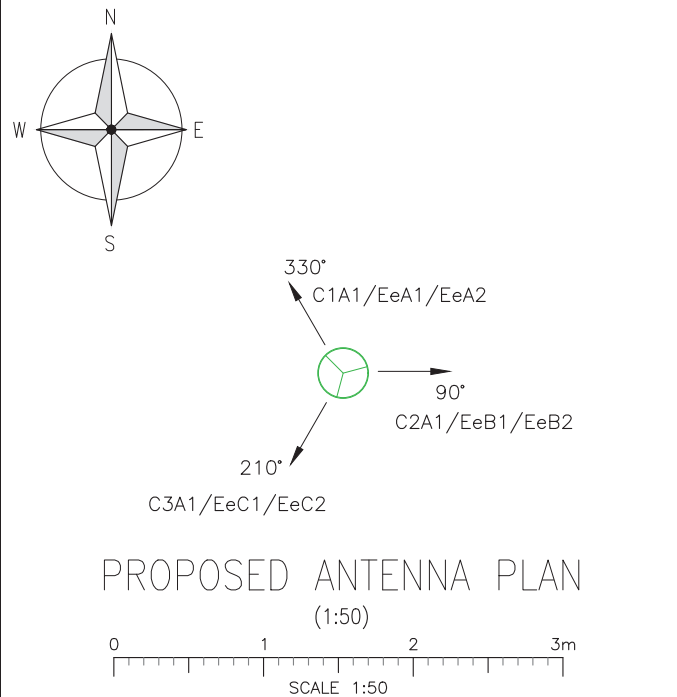

- NOTES:
- PROPOSED SIZE AND LOCATION OF THE STRUCTURE FOUNDATION IS SUBJECT TO CONFIRMATION, UPON COMPLETION OF STAS SEARCH, GEOTECHNICAL SURVEY AND FOUNDATION DESIGN.
  - BOXED TEXT INDICATES PROPOSED WORKS
  - SOP OF POLE: NGR: E499949 N490261



CROWN COPYRIGHT RESERVED. MAPS REPRODUCED WITH THE PERMISSION OF THE CONTROLLER OF HM'S STATIONERY OFFICE.

ALL DIMENSIONS IN mm UNLESS OTHERWISE STATED. THIS DRAWING TO BE READ IN CONJUNCTION WITH OTHER RELEVANT DRAWINGS.

N.G.R | E: 499950 N: 490260

**UPGRADE REFERENCES**

-	-	-
-	-	-
-	-	-

DOES THE SITE DESIGN CONFORM TO RD10414

YES	NO
✓	

IF 'NO' DETAIL THE EXCEPTIONS BELOW:

- 
- 

**ICNIRP DETAILS - RD10102/GSDD008**

ACCESS CLASSIFICATION	CONTROLLED
DESIGN CLASSIFICATION	PUBLIC

**DRAWING IN ACCORDANCE WITH:**

NOMINATION REVISION	03
NOMINATION DATE	05.12.2019

B	NOM Form Updated	SS	RW	20.03.20
A	Issued for Approval	BJ	RW	26.11.19
REV	MODIFICATION	BY	CH	DATE

**mono** #

MONO CONSULTANTS LIMITED  
Culzean House,  
36 Renfield Street  
Glasgow,  
G2 1111

EE REF.	79693	SITE REF.	ESN40229
---------	-------	-----------	----------

Cell Name	KELD RUNNELS ROAD	IEA Opt Letter	A
-----------	-------------------	----------------	---

**Site Address / Contact Details**

FIELD TO NORTH OF KELD RUNNELS ROAD  
SCALBY NABS  
SUFFIELD  
SCARBOROUGH  
NORTH YORKSHIRE, YO13 0SJ

Drawing Title:  
PROPOSED SITE ELEVATION & ANTENNA PLAN

Purpose of issue:  
**PLANNING**

Drawing Number:  
ESN40229/107

Scale:	Page Size:	Drawn:	Date:	Issue:
As Shown	A3	BJ	26.11.19	B
Checked:	Date:	Approved:	Date:	
RW	26.11.19	AKB	26.11.19	

PROPOSED TRISECTOR ANTENNA WITHIN SHROUD

PROPOSED 2No. 300ø TRANSMISSION DISHES FIXED TO POLE

PROPOSED 3No. 1800/2100 MHA'S MOUNTED AT TOP OF POLE & 3No. 800 MHA'S MOUNTED AT BOTTOM OF POLE

PROPOSED 15.97m HIGH HUTCHINSON ENG. ALPHA 8 POLE ON NEW 3.6x3.6m<sup>2</sup> RC CONCRETE FOUNDATION. POLE TO BE FINISHED GREEN (RAL 6009)

PROPOSED CONTROLLIS PRIME POWER GENERATOR ON NEW 3100x1500mm CONCRETE BASE

PROPOSED METER CABINET WITHIN FENCELINE, TO BE FINISHED GREEN (RAL 6009), ON NEW CONCRETE BASE C/W AMF PANEL & MANUAL CHANGEOVER SWITCH

EXISTING 1.2m HIGH POST & WIRE FENCE

EXISTING 3.6m WIDE GATE

MANURE PILE - TO BE REMOVED BY FARM

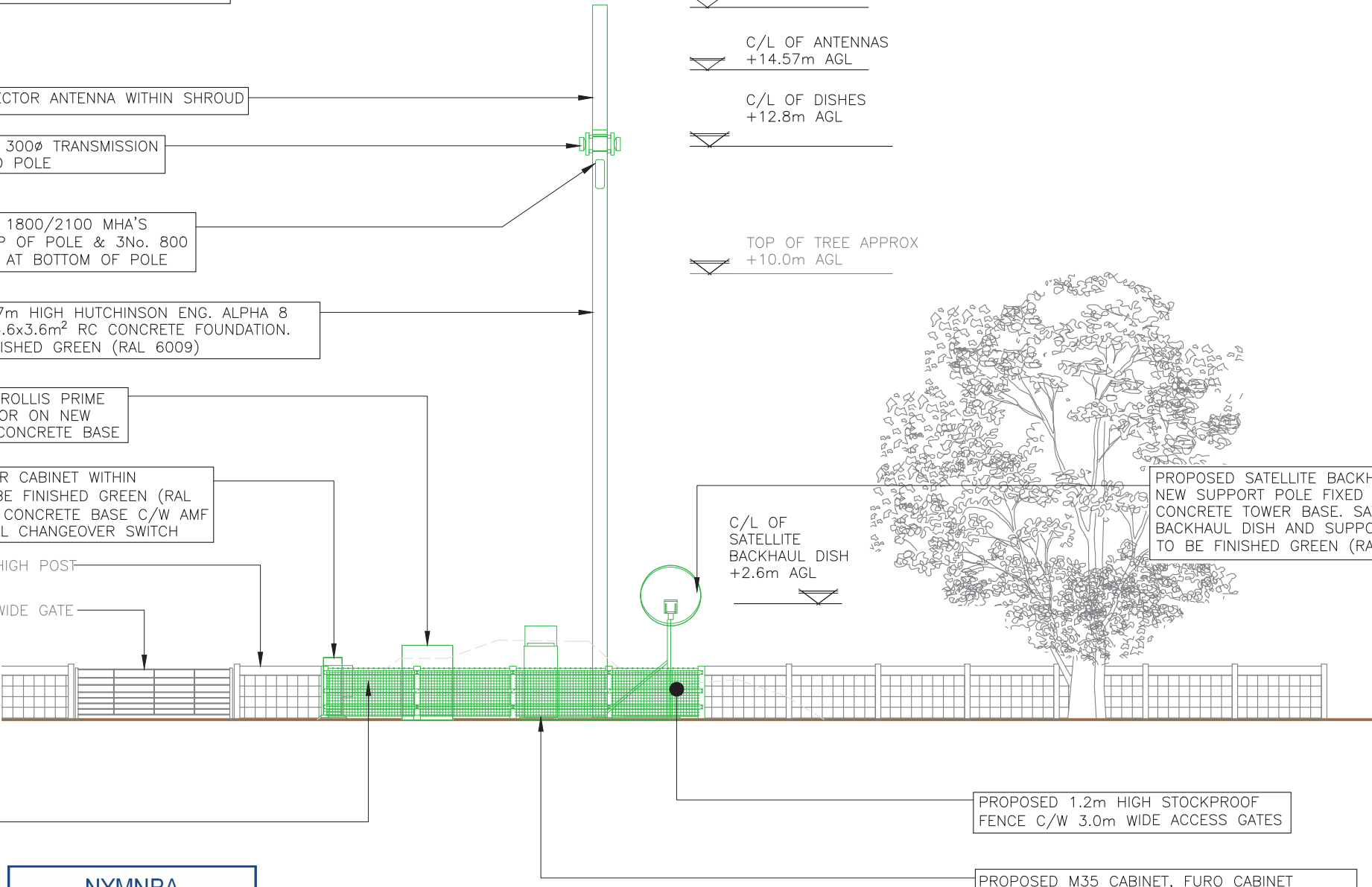

TOP OF ANTENNAS  
+15.97m AGL

C/L OF ANTENNAS  
+14.57m AGL

C/L OF DISHES  
+12.8m AGL

TOP OF TREE APPROX  
+10.0m AGL

C/L OF SATELLITE BACKHAUL DISH  
+2.6m AGL

GROUND LEVEL

**NYMNPA**

25/03/2020

**PROPOSED SOUTH EAST ELEVATION**

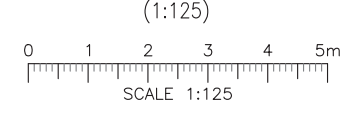

PROPOSED 1.2m HIGH STOCKPROOF FENCE C/W 3.0m WIDE ACCESS GATES

PROPOSED M35 CABINET, FURO CABINET (LOCKABLE) AND VIPER CABINET ON RC CONCRETE TOWER FOUNDATION TO BE FINISHED GREEN (RAL 6009)

PROPOSED SATELLITE BACKHAUL DISH ON NEW SUPPORT POLE FIXED TO RC CONCRETE TOWER BASE. SATELLITE BACKHAUL DISH AND SUPPORT STEELWORK TO BE FINISHED GREEN (RAL 6009)

NOTES:  
 • BOXED TEXT INDICATES PROPOSED WORKS

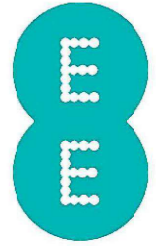

CROWN COPYRIGHT RESERVED. MAPS REPRODUCED WITH THE PERMISSION OF THE CONTROLLER OF HM's STATIONERY OFFICE.

ALL DIMENSIONS IN mm UNLESS OTHERWISE STATED. THIS DRAWING TO BE READ IN CONJUNCTION WITH OTHER RELEVANT DRAWINGS.

N.G.R | E: 499950 | N: 490260

UPGRADE REFERENCES

-	-	-

DOES THE SITE DESIGN CONFORM TO RD10414	YES	NO
	✓	

IF 'NO' DETAIL THE EXCEPTIONS BELOW:  
 1.  
 2.

ICNIRP DETAILS - RD10102/GSDD008

ACCESS CLASSIFICATION	CONTROLLED
DESIGN CLASSIFICATION	PUBLIC

DRAWING IN ACCORDANCE WITH:

NOMINATION REVISION	03
NOMINATION DATE	05.12.2019

A	Issued for Approval	SS	RW	20.03.20
REV	MODIFICATION	BY	CH	DATE

**mono** #  
 MONO CONSULTANTS LIMITED  
 Culzean House,  
 36 Renfield Street  
 Glasgow,  
 G2 1LU

EE REF.	79693	SITE REF.	ESN40229
---------	-------	-----------	----------

Cell Name	IEA Opt Letter
KELD RUNNELS ROAD	A

**Site Address / Contact Details**  
 FIELD TO NORTH OF KELD RUNNELS ROAD  
 SCALBY NABS  
 SUFFIELD  
 SCARBOROUGH  
 NORTH YORKSHIRE, YO13 0SJ

Drawing Title:  
 PROPOSED ACCESS GATE ELEVATION

Purpose of issue:  
 PLANNING

Drawing Number:  
 ESN40229/113

Scale: As Shown	Page Size: A3	Drawn: SS	Date: 20.03.20	Issue: A
Checked: RW	Date: 20.03.20	Approved: AKB	Date: 20.03.20	

NYMNPA  
 24/03/2020

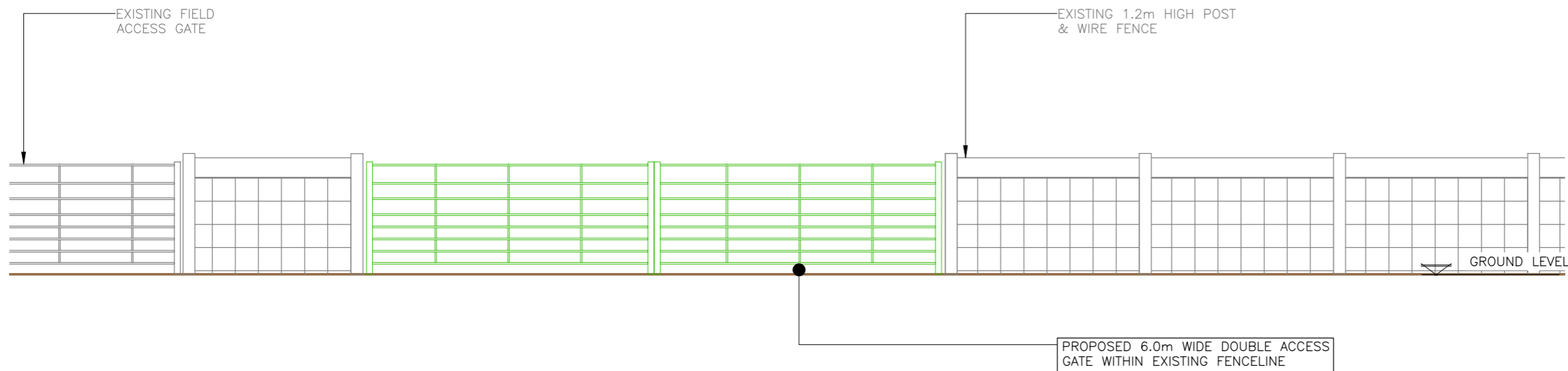

PROPOSED ACCESS GATE ELEVATION  
 (1:50)

