

NYMNP

10/07/2020

From: david pickering
Sent: 10 July 2020 07:58
To: Planning
Subject: Re: NYM/2020/0437/AGRP

Hello Helen, I hope you received the email and photo sent from my phone yesterday regarding the site notice I can't take photos with this computer.

I have drawn the plans and filled in the forms you requested, scanned them and will attempt to enclose them here.

please let me know if it hasn't worked

regards David

APPLICATION NUMBER
NYM/2020/0437/AGRP FOR STORAGE SHED HAY STRAW FARM MACHINERY

NYMNPA

10/07/2020

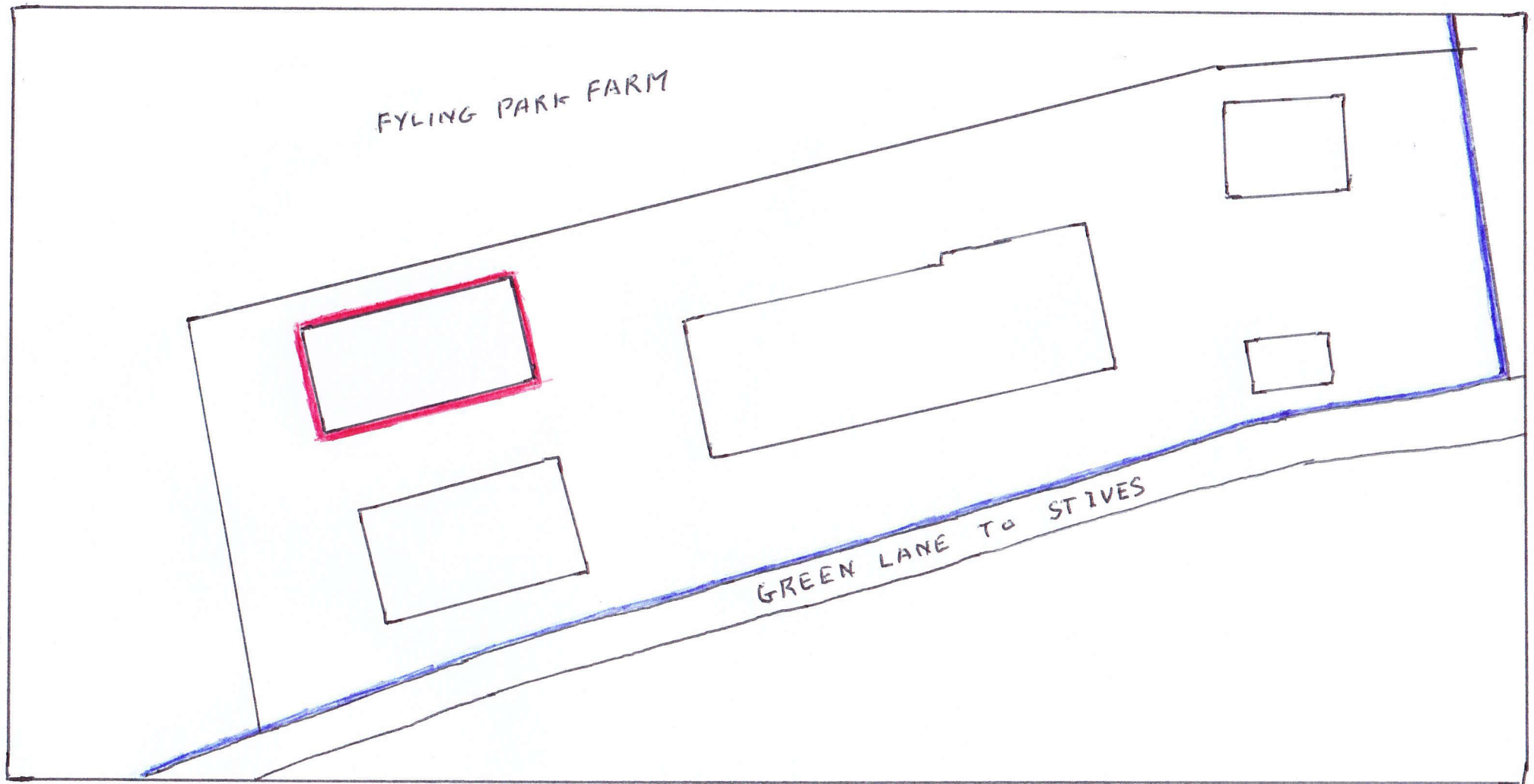

THE 25.9 HECTARE FARM IS IN A RING FENCE
FARMSTEAD IS IN THE SOUTH EAST CORNER
ALL THE LAND IS OWNED BY US

SCALE 1:500

SITE PLAN

↑
NORTH

PROPOSED BUILDING

1.5 M LOWER THAN EXISTING HAY SHED

NYM/2020/0437/AGRP
FLOOR PLAN

SCALE 1:100

EXISTING HAY SHED



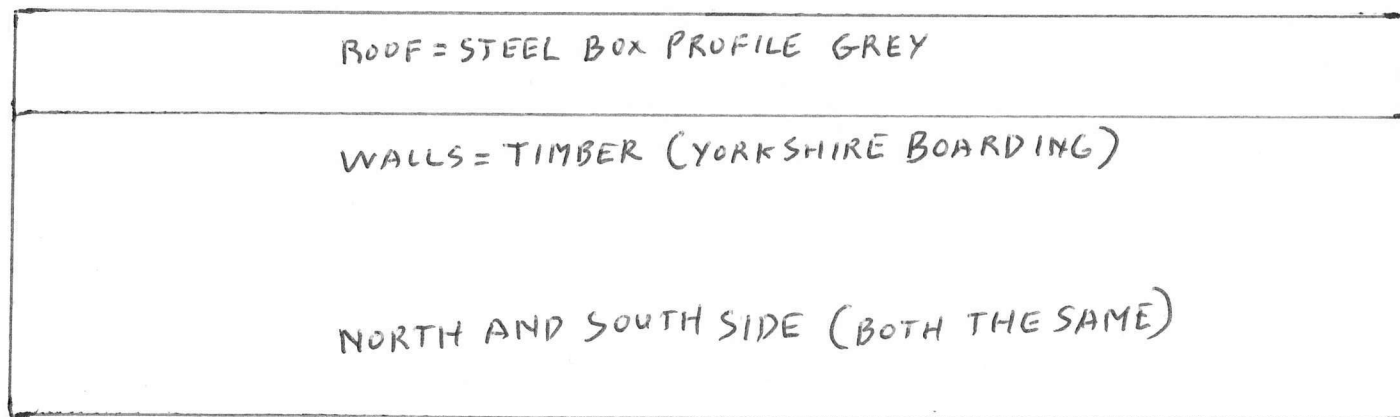
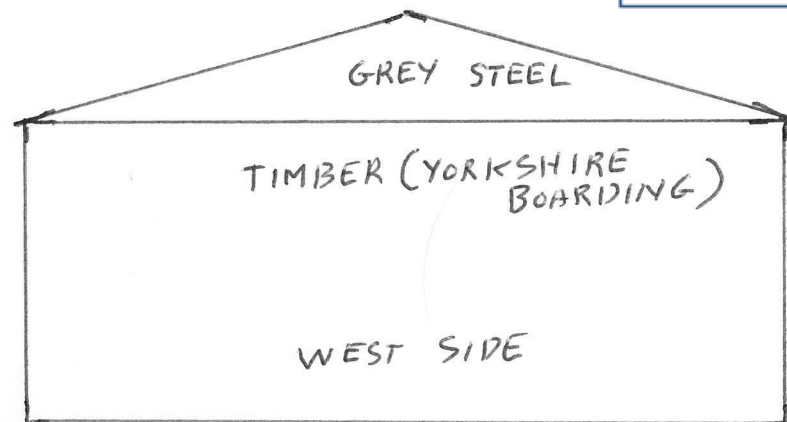
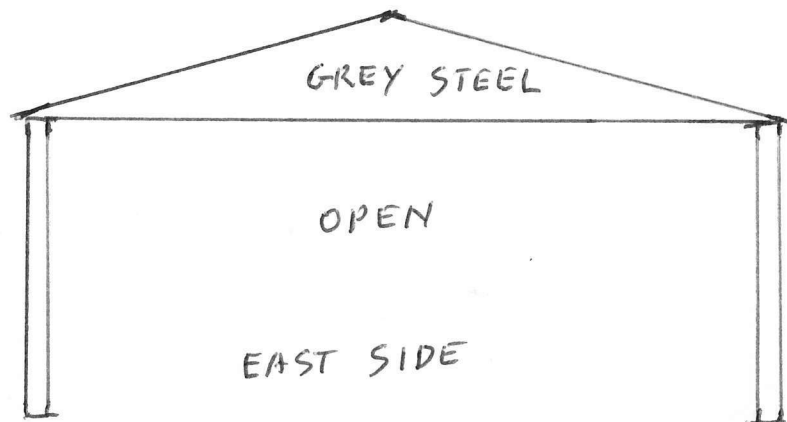

NYM/2020/0437/AGRP

PROPOSED BUILDING ELEVATIONS SCALE 1:100

Our Ref: NYM/2020/0437/AGRP

3

Date: 08 July 2020

Supporting Agricultural Information

Applicants are encouraged to complete the following as this will enable the Authority to speed up the processing of your notification/application. The purpose of this form is to provide basic information on the farm system to help assess the need and appropriateness of agricultural buildings within the National Park.

Livestock Numbers**Cattle**

	Average number throughout the year	Additional Information
Dairy Cows/Breeding Bulls		
Suckler Cows/Heifers over 24 months		
Followers (6 to 24 months)	40	BEEF CATTLE

Sheep

	Average number throughout the year	Additional Information
Breeding Ewes/Tups		
Replacement Ewe Lambs/Finishing Store Lambs		

Pigs

	Average number throughout the year	Additional Information
Sows/Boars		
Weaners		

Others

	Average number throughout the year	Additional Information
Other Livestock, i.e. Horses		

Continued...

Our Ref: NYM/2020/0437/AGRP

4

Date: 08 July 2020

Land

	Area in Hectares	Additional Information
Size of Holding	25-8723	
Available Grazing Land	25-1125	
Arable Lane		
Moorland		
Grazing Land on Short Term Tenancy		

Agricultural Buildings

List Main Existing Agricultural Buildings and Use	Approximate Dimensions in Metres	Is it a modern or traditional building?
1. CATTLE SHED	36 X 13	MODERN
2. HAY SHED	18.5 X 11	MODERN
3. STORE SHED	7 X 5	MODERN
4.		
5.		
6.		
7.		
8.		
9.		
10.		

Please Note: It would be helpful if you could attach a sketched block plan annotating which building is which as referred to above.

Please detail below how the farming operation on site may change as a result of the proposal i.e. increase in stock levels or justification for the use of the new building.

CATTLE WILL BE INCREASED TO 60 AS THE GOVERNMENT SUPPORT IS REDUCED TO NOTHING BY 2027 CATTLE HOUSING IS BIG ENOUGH BUT HAY + STRAW IS NOT