

From:
To: [Planning](#)
Subject: NYM/2020/0884/FL Application for installation of ground mounted solar array at Hern Head House
Date: 26 November 2020 14:48:08
Attachments: [image001.png](#)
[Hern Head Solar Application - Location Plan.pdf](#)
[NYM_2020_0884_FL.pdf](#)

For the Attention of Mrs J Bastow

Dear Madam

We write further to the attached consultation letter concerning the planning application NYM/2020/0884/FL to raise our concern at the proposed development. This is particularly in respect of the close proximity of the proposed solar array being located so close to the boundary of the adjacent Forestry England Plantation, which is only 5m due north of the application site (see attached Forestry England plan showing the Forestry Boundary at this location). The trees in the plantation (largely conifers planted in 1972) may be expected to reach 40 meters in height and currently the degree of risk to an adjacent landowner's agricultural/pasture land (such as is the land in the subject application) is moderate in respect of the proximity of these types of trees. Siting an electrical generation plant here however, so close to the forest, may be considered an unacceptable and unnecessary risk which could be avoided by the applicant re-siting the solar panels some 40m further from the boundary within the same field.

We ask that the application be modified or refused on the grounds of identified risk. The site in question is also shown on the applicant's location plan below.

Yours faithfully

James A Raynar MRICS FAAV
Assistant Area Land Agent

Yorkshire Forest District
Forestry England
Outgangs Road
Pickering
YO18 7EL

)

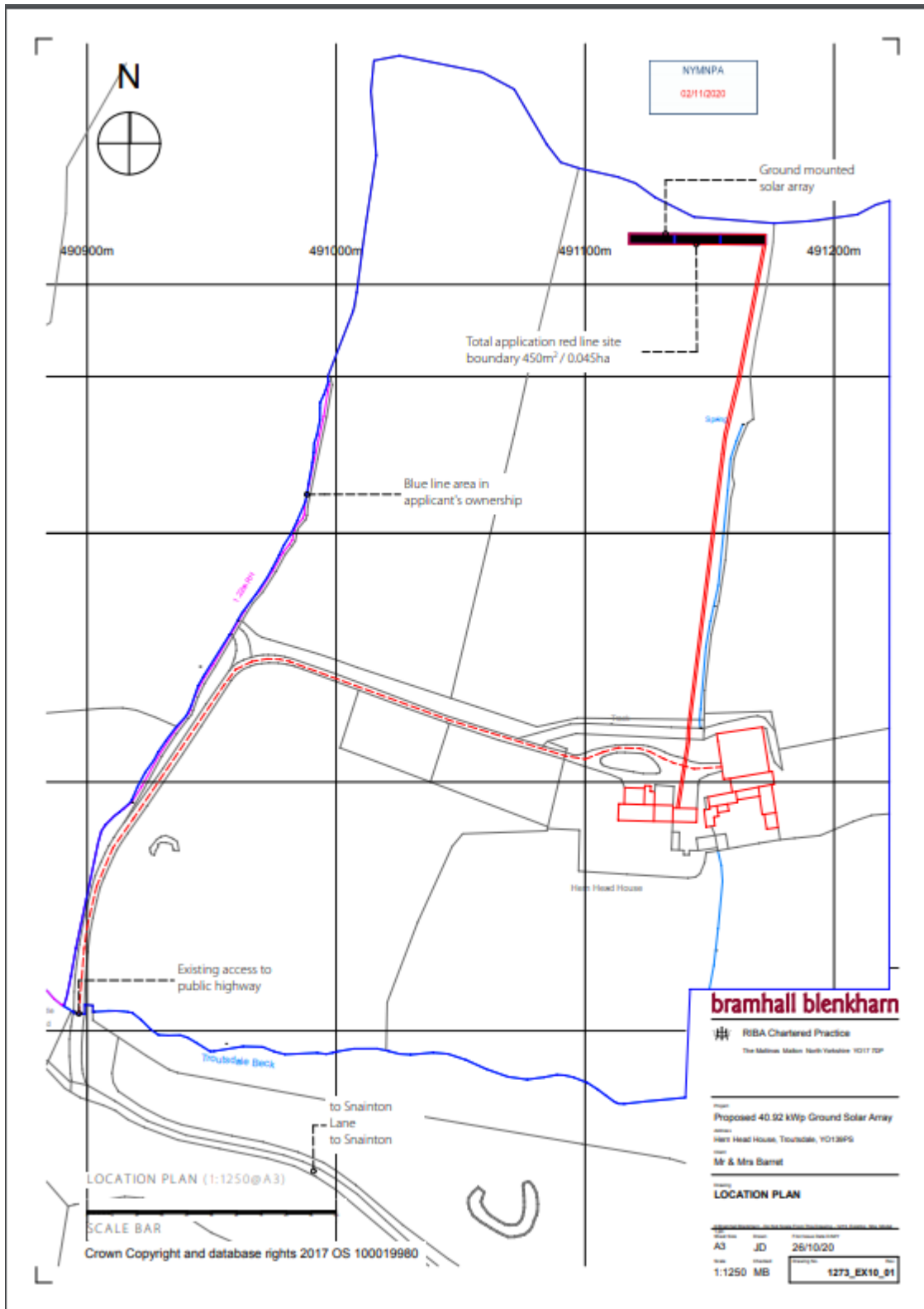

Disclaimer

The information contained in this communication from the sender is confidential. It is intended solely for use by the recipient and others authorised to receive it. If you are not the recipient, you are hereby notified that any disclosure, copying, distribution or taking action in relation of the contents of this information is strictly prohibited and may be unlawful.

This email has been scanned for viruses and malware.

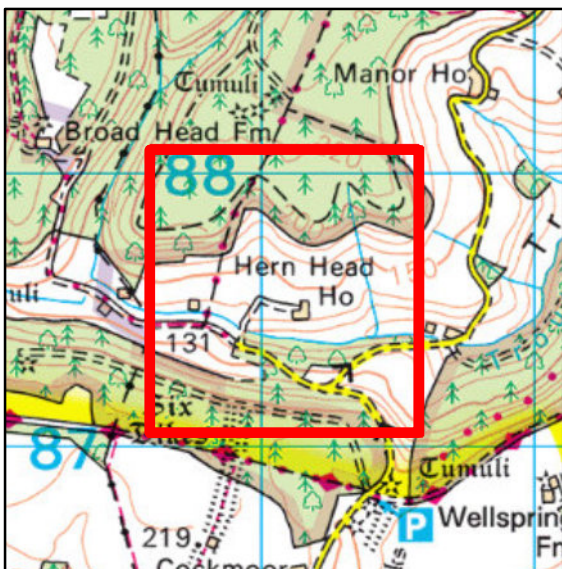
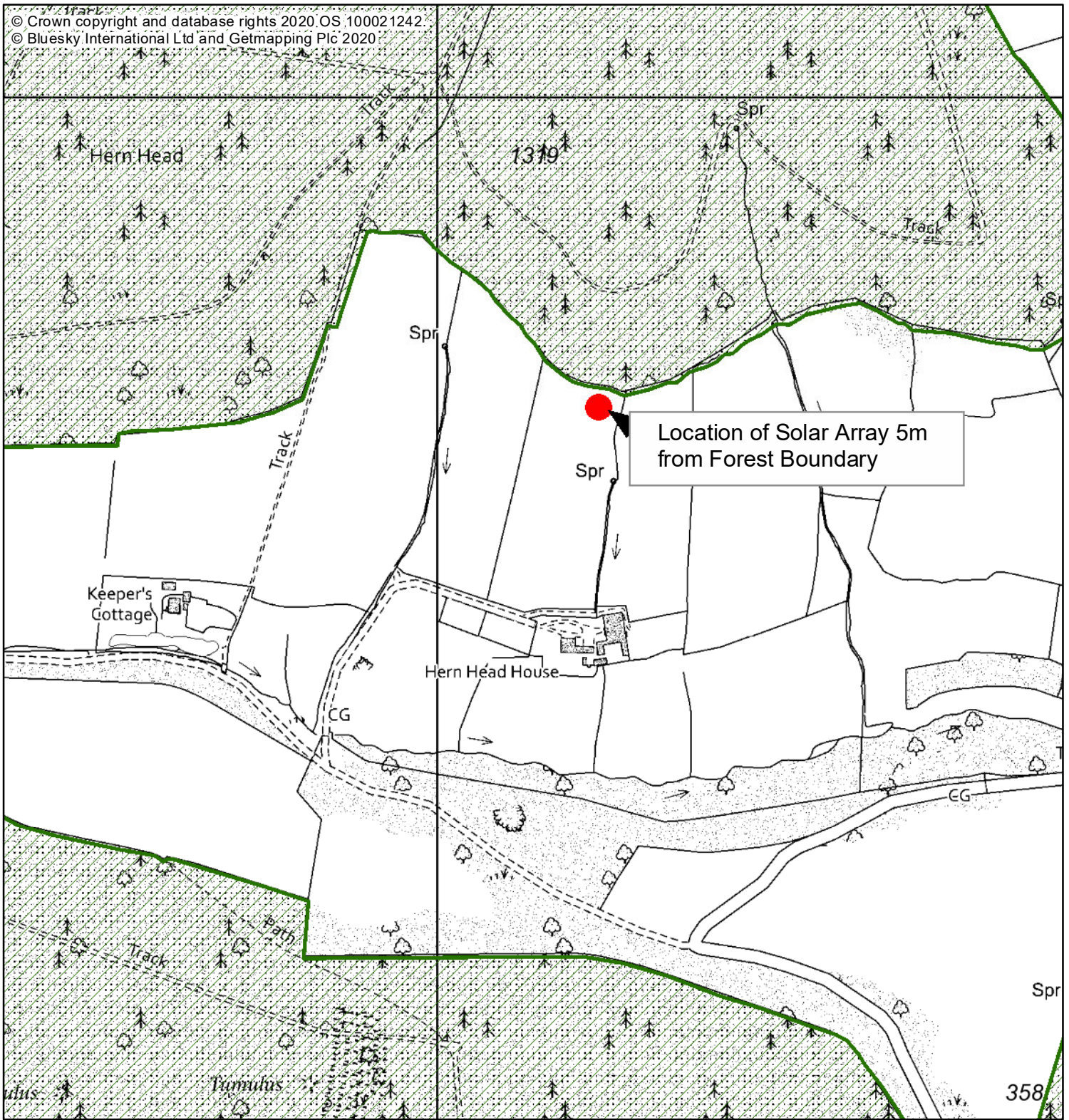

Legend

Acquisitions

 Acquisitions

FC Ownership

 FC Ownership

FC Legal Boundary

 FC Legal Boundary

Objection to Solar Application James Raynar

Scale @ A4: 1:5,000

Date: 26/11/2020

 km

0 0.08 0.16 0.24 

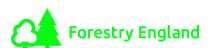

Forestry England forests and woodlands have been certified in accordance with the UK Woodland Assurance Standard (UKWAS)

