

SITE LOCATION
(Scale 1:50000)
Ordnance Survey map extract based upon Landranger map series with the permission of the controller of Her Majesty's Stationery Office
Mono Consultants Limited licence No. ES100017753
Crown copyright.

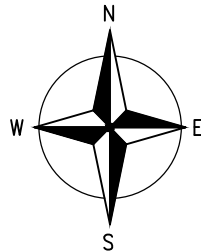

SITE LOCATION
N.G.R- E:499563 N:490313

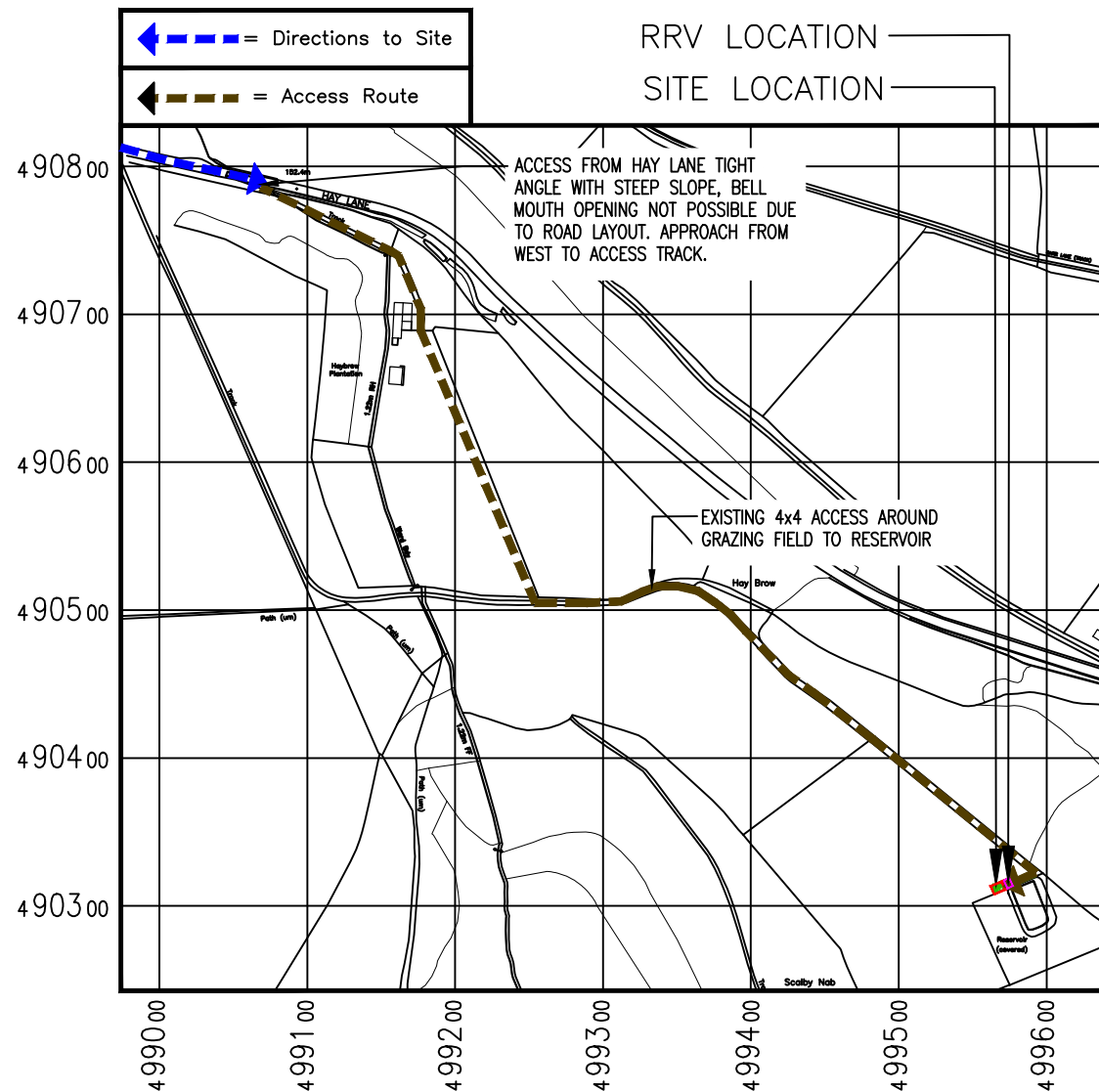

DETAILED SITE LOCATION
(Scale 1:5000)
Based upon Ordnance Survey map extract with the permission of the Controller of Her Majesty's Stationery Office.
Crown copyright.
Mono Consultants Limited licence No. ES100017753
Promap licence No. A152065A0001

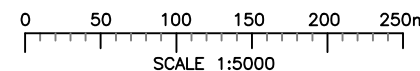

SITE PHOTOGRAPH

ACCESS NOTES:

FROM SCALBY CENTRE, FOLLOW A171 SCALBY ROAD NORTHBOUND FOR 0.6km, TURN LEFT ONTO BARMOOR LANE AT JUNCTION, FOLLOW LANE FOR 1.3km UNTIL LEFT TURN ONTO BEACON BROW ROAD, FOLLOW ROAD TO CROSSROAD THEN TURN LEFT ONTO LIMESTONE ROAD, TURNING LEFT AT THE END ONTO SWANG ROAD. FOLLOW SWANG ROAD FOR APPROX 1KM, TAKE 1ST LEFT ONTO HAY LANE. FOLLOW THIS ROAD FOR APPROX. 200m, THERE IS A GATE ON THE RHS, PROPOSED SITE ACCESS ROUTE IS TO CROSS THE FIELD THEN FOLLOW 4x4 ACCESS ROUND THE LEFT PAST GRAZING FIELD TOWARDS RESERVOIR. SITE IS AT CORNER OF RESERVOIR COMPOUND. 4x4 ACCESS ONLY.

CONSTRUCTION ACCESS:

ACCESS TO THE SITE FOR BUILD IS FROM HAY LANE ON 4WD ACCESS THROUGH FARM (4 GATES) FOR 360M, TO THE EXISTING ACCESS TRACK WHICH ACCESSES THE RESERVOIR. ACCESS ONTO AND FROM HAY LANE IS ON A STEEP SLOPE WITH A TIGHT ANGLE, APPROACH FROM THE WEST.

MAINTENANCE ACCESS TO FOLLOW SAME ROUTE

NYMNPA
28/01/2021



CROWN COPYRIGHT RESERVED. MAPS REPRODUCED WITH THE PERMISSION OF THE CONTROLLER OF HM'S STATIONERY OFFICE.

ALL DIMENSIONS IN mm UNLESS OTHERWISE STATED. THIS DRAWING TO BE READ IN CONJUNCTION WITH OTHER RELEVANT DRAWINGS.

N.G.R | E: 499563 N: 490313

UPGRADE REFERENCES

—	—	—
---	---	---

DOES THE SITE DESIGN CONFORM TO RD10414	YES	NO
	✓	

IF 'NO' DETAIL THE EXCEPTIONS BELOW:
1.
2.

ICNIRP DETAILS - RD10102/GSDD008

ACCESS CLASSIFICATION | CONTROLLED

DESIGN CLASSIFICATION | PUBLIC

DRAWING IN ACCORDANCE WITH:

NOMINATION REVISION | 07

NOMINATION DATE | 18/12/20

B	Site Compound & Track Amended	RC	RW	20.01.21
A	Issued for Approval	KC	RW	12.01.21
REV	MODIFICATION	BY	CH	DATE

mono #
MONO CONSULTANTS LIMITED
Culzean House,
36 Renfield Street
Glasgow,
G2 1111

EE REF. | 79693 | SITE REF. | ESN40229

Cell Name | LAND EAST OF SUFFIELD | IEA Opt Letter | A

Site Address / Contact Details
MOWTHORP ROAD
SUFFIELD-CUM-EVERLEY
NEWBY
SCARBOROUGH
NORTH YORKSHIRE, YO13 0BH

Drawing Title: | SITE LOCATION MAPS

Purpose of issue: | PLANNING

Drawing Number: | ESN40229/101

Scale: | As Shown | Page Size: | A3 | Drawn: | KC | Date: | 12.01.21 | Issue: | B

Checked: | RW | Date: | 12.01.21 | Approved: | RW | Date: | 12.01.21

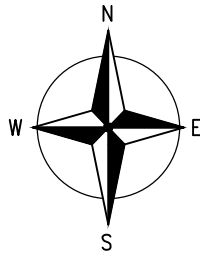

NYMNPA
28/01/2021

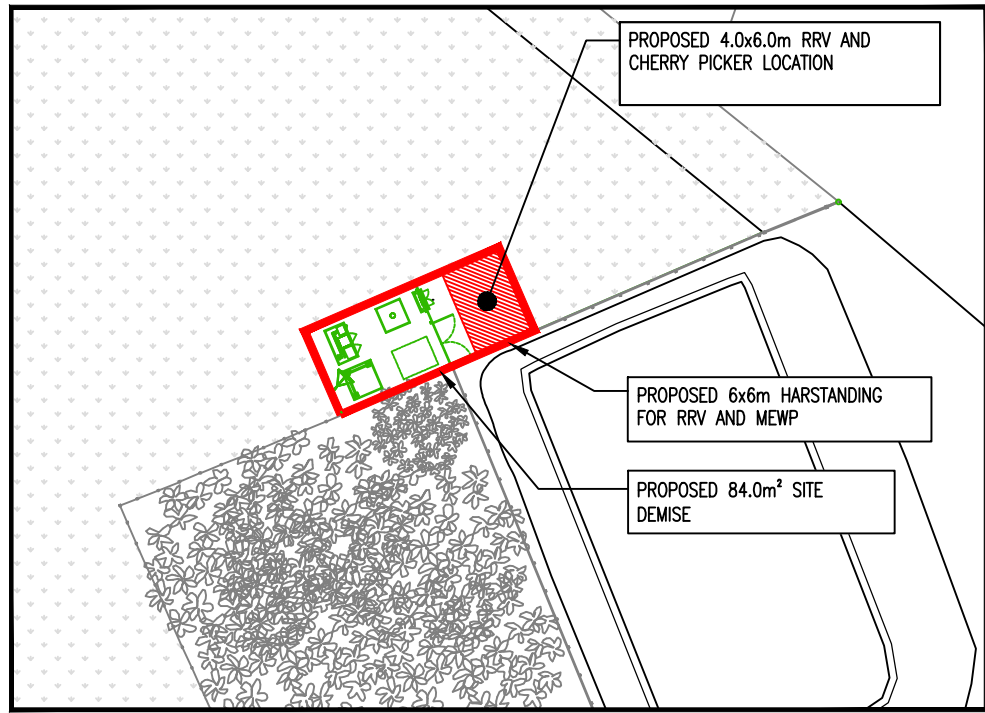

PLANNING RED LINE
(1:500)

SCALE 1:500

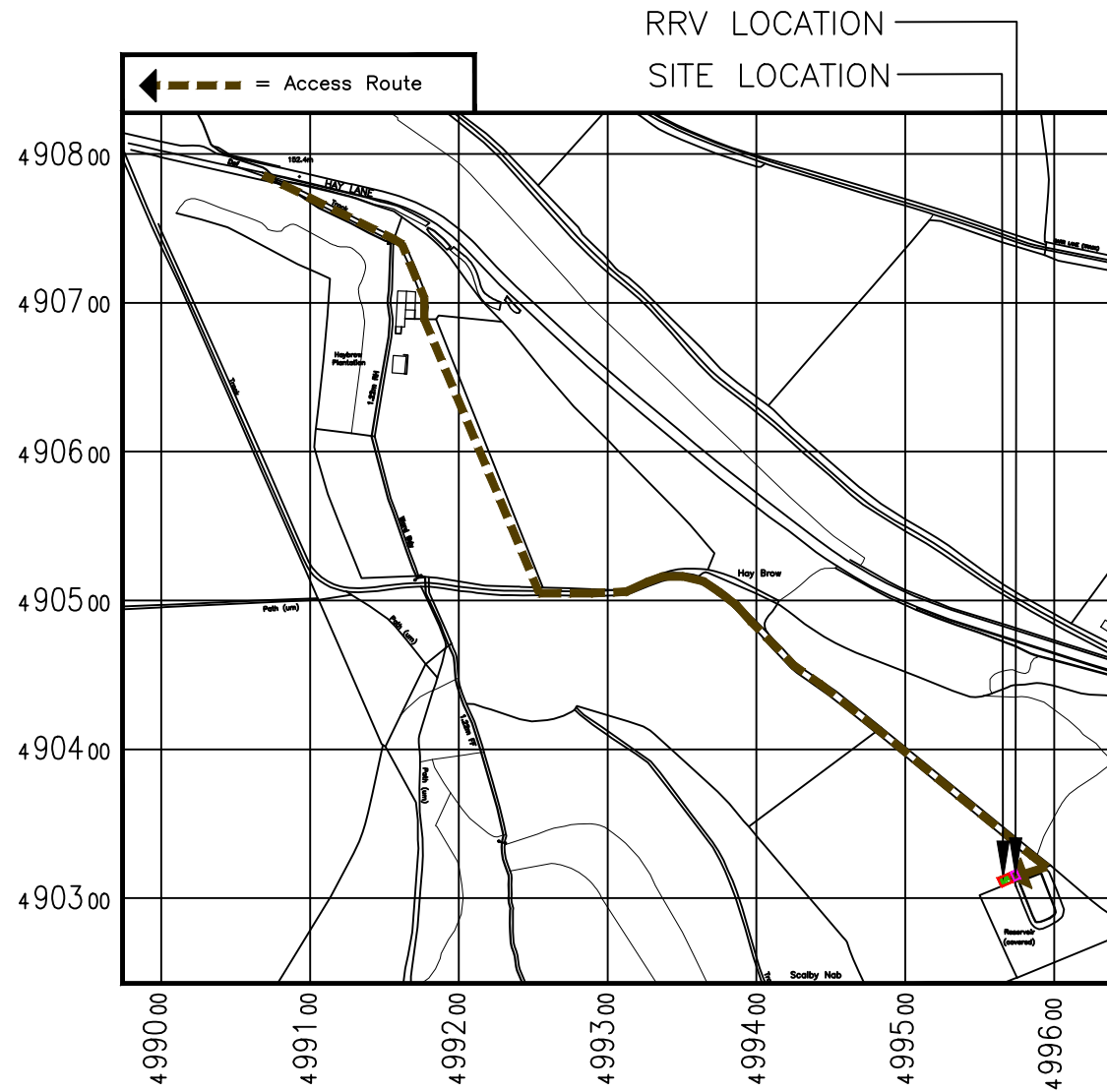

DETAILED SITE LOCATION
(Scale 1:5000)

Based upon Ordnance Survey map extract with the permission of the Controller of Her Majesty's Stationery Office. Crown copyright.
Mono Consultants Limited licence No. ES100017753
Promap licence No. A152065A0001

SCALE 1:5000

CROWN COPYRIGHT RESERVED. MAPS REPRODUCED WITH THE PERMISSION OF THE CONTROLLER OF HM'S STATIONERY OFFICE.

ALL DIMENSIONS IN mm UNLESS OTHERWISE STATED. THIS DRAWING TO BE READ IN CONJUNCTION WITH OTHER RELEVANT DRAWINGS.

N.G.R | E: 499563 N: 490313

UPGRADE REFERENCES

—	—	—

DOES THE SITE DESIGN CONFORM TO RD10414	YES	NO
	✓	

IF 'NO' DETAIL THE EXCEPTIONS BELOW:

- 1.
- 2.

ICNIRP DETAILS - RD10102/GSDD008

ACCESS CLASSIFICATION	CONTROLLED
DESIGN CLASSIFICATION	PUBLIC

DRAWING IN ACCORDANCE WITH:

NOMINATION REVISION	07
NOMINATION DATE	18/12/20

B	Permanent Generator Removed	RC	RW	20.01.21
A	Issued for Approval	KC	RW	12.01.21
REV	MODIFICATION	BY	CH	DATE

MONO CONSULTANTS LIMITED
Culzean House,
36 Renfield Street
Glasgow,
G2 1LU

EE REF.	79693	SITE REF.	ESN40229
---------	-------	-----------	----------

Cell Name	LAND EAST OF SUFFIELD	IEA Opt Letter	A
-----------	-----------------------	----------------	---

Site Address / Contact Details

MOWTHORP ROAD
SUFFIELD-CUM-EVERLEY
NEWBY
SCARBOROUGH
NORTH YORKSHIRE, YO13 0BH

Drawing Title: **PLANNING RED LINE**

Purpose of issue: **PLANNING**

Drawing Number: **ESN40229/109**

Scale:	Page Size:	Drawn:	Date:	Issue:
As Shown	A3	KC	12.01.21	
Checked:	Date:	Approved:	Date:	B
RW	12.01.21	RW	12.01.21	

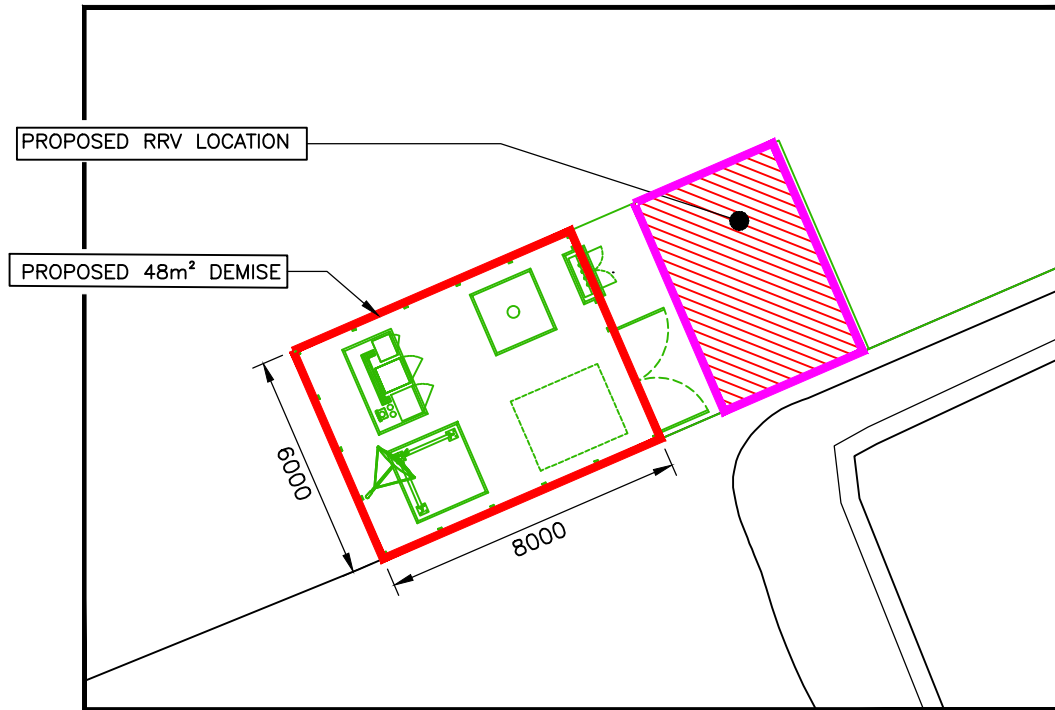
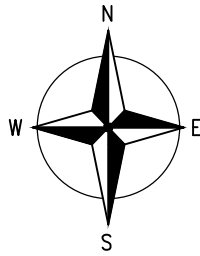

LEASE DEMISE PLAN
(1:200)

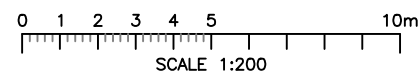

NYMNPA
 28/01/2021

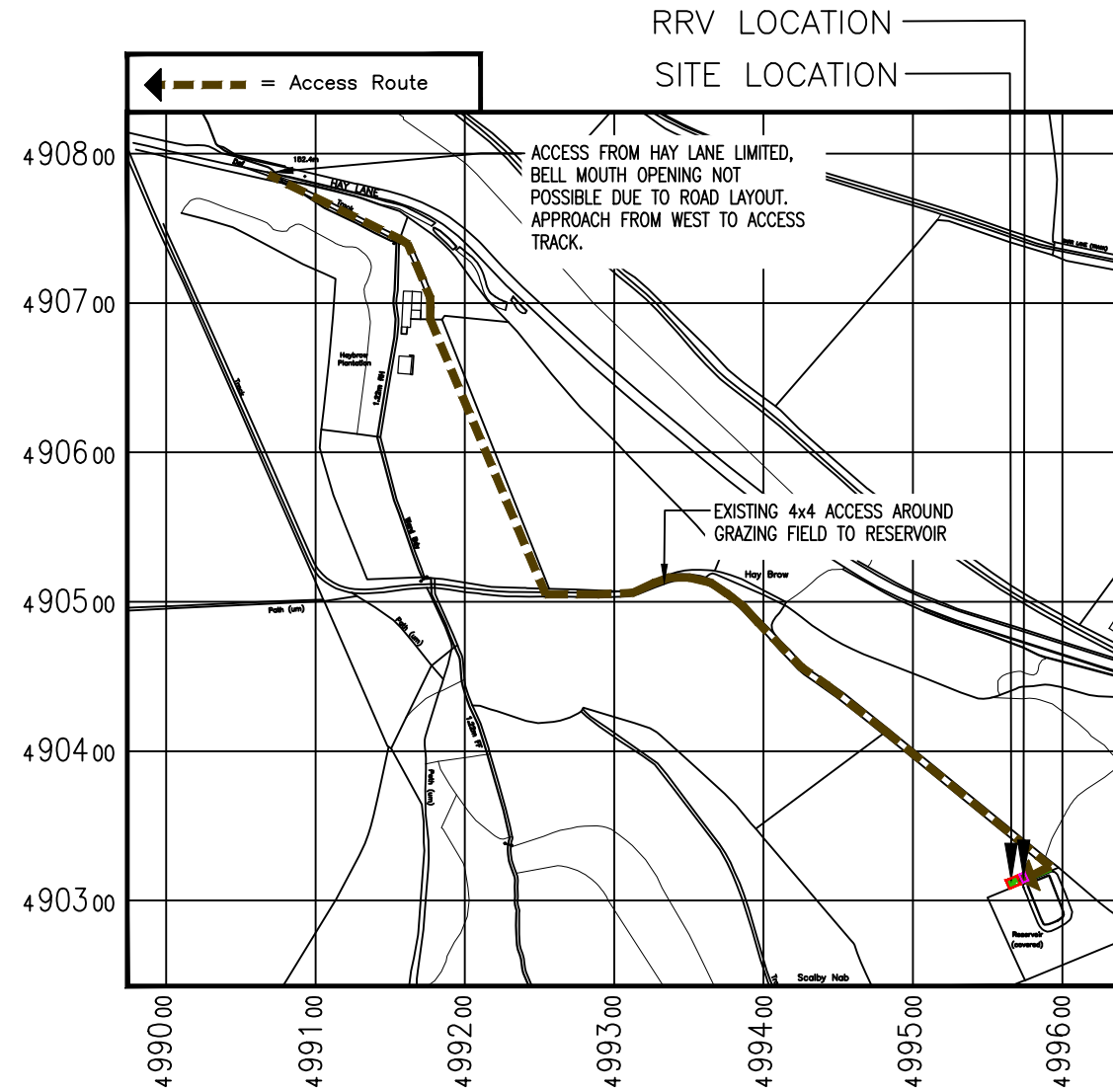

DETAILED SITE LOCATION
(Scale 1:5000)

Based upon Ordnance Survey map extract with the permission of the Controller of Her Majesty's Stationery Office. Crown copyright.
 Mono Consultants Limited licence No. ES100017753
 Promap licence No. A152065A0001

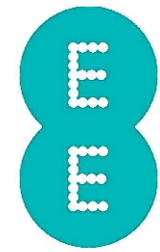
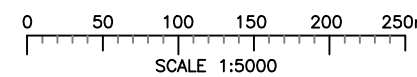

CROWN COPYRIGHT RESERVED. MAPS REPRODUCED WITH THE PERMISSION OF THE CONTROLLER OF HM'S STATIONERY OFFICE.

ALL DIMENSIONS IN mm UNLESS OTHERWISE STATED. THIS DRAWING TO BE READ IN CONJUNCTION WITH OTHER RELEVANT DRAWINGS.

N.G.R E: 499563 N: 490313

UPGRADE REFERENCES

—	—	—

DOES THE SITE DESIGN CONFORM TO RD10414	YES	NO
	✓	

IF 'NO' DETAIL THE EXCEPTIONS BELOW:

-
-

ICNIRP DETAILS - RD10102/GSDD008

ACCESS CLASSIFICATION	CONTROLLED
DESIGN CLASSIFICATION	PUBLIC

DRAWING IN ACCORDANCE WITH:

NOMINATION REVISION	07
NOMINATION DATE	18/12/20

B	Site Compound & Track Amended	RC	RW	20.01.21
A	Issued for Approval	KC	RW	12.01.21
REV	MODIFICATION	BY	CH	DATE

mono #
 MONO CONSULTANTS LIMITED
 Culzean House,
 36 Renfield Street
 Glasgow,
 G2 3JF

EE REF. 79693 SITE REF. ESN40229

Cell Name LAND EAST OF SUFFIELD IEA Opt Letter A

Site Address / Contact Details
 MOWTHORP ROAD
 SUFFIELD-CUM-EVERLEY
 NEWBY
 SCARBOROUGH
 NORTH YORKSHIRE, YO13 0BH

Drawing Title: LEASE DEMISE LAYOUT
 Purpose of issue: PLANNING
 Drawing Number: ESN40229/102

Scale: As Shown	Page Size: A3	Drawn: KC	Date: 12.01.21	Issue: B
Checked: RW	Date: 12.01.21	Approved: RW	Date: 12.01.20	

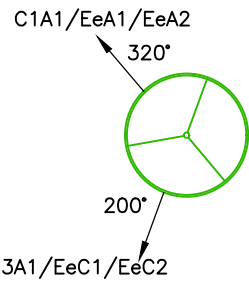

NYMNP
28/01/2021

- NOTES:
- PROPOSED SIZE AND LOCATION OF THE STRUCTURE FOUNDATION IS SUBJECT TO CONFIRMATION, UPON COMPLETION OF STAS SEARCH, GEOTECHNICAL SURVEY AND FOUNDATION DESIGN.
 - BOXED TEXT INDICATES PROPOSED WORKS
 - SOP OF POLE: NGR: E499563 N490313

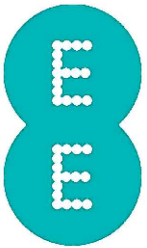

CROWN COPYRIGHT RESERVED. MAPS REPRODUCED WITH THE PERMISSION OF THE CONTROLLER OF HM'S STATIONERY OFFICE.

ALL DIMENSIONS IN mm UNLESS OTHERWISE STATED. THIS DRAWING TO BE READ IN CONJUNCTION WITH OTHER RELEVANT DRAWINGS.

N.G.R | E: 499563 N: 490313

UPGRADE REFERENCES

—	—	—

DOES THE SITE DESIGN CONFORM TO RD10414	YES	NO
	✓	

IF 'NO' DETAIL THE EXCEPTIONS BELOW:
1.
2.

ICNIRP DETAILS - RD10102/GSDD008			
ACCESS CLASSIFICATION	CONTROLLED		
DESIGN CLASSIFICATION	PUBLIC		
DRAWING IN ACCORDANCE WITH:			
NOMINATION REVISION	07		
NOMINATION DATE	18/12/20		

B	Permanent Generator Removed	RC	RW	20.01.21
A	Issued for Approval	KC	RW	12.01.21
REV	MODIFICATION	BY	CH	DATE

mono #

MONO CONSULTANTS LIMITED
Culzean House,
36 Renfield Street
Glasgow,
G2 1LU

EE REF. 79693 | SITE REF. ESN40229

Cell Name: LAND EAST OF SUFFIELD | IEA Opt Letter: A

Site Address / Contact Details
MOWTHORP ROAD
SUFFIELD-CUM-EVERLEY
NEWBY
SCARBOROUGH
NORTH YORKSHIRE, YO13 0BH

Drawing Title: PROPOSED SITE ELEVATION & ANTENNA PLAN

Purpose of issue: PLANNING

Drawing Number: ESN40229/105

Scale: As Shown	Page Size: A3	Drawn: KC	Date: 12.01.21	Issue: B
Checked: RW	Date: 12.01.21	Approved: RW	Date: 12.01.21	

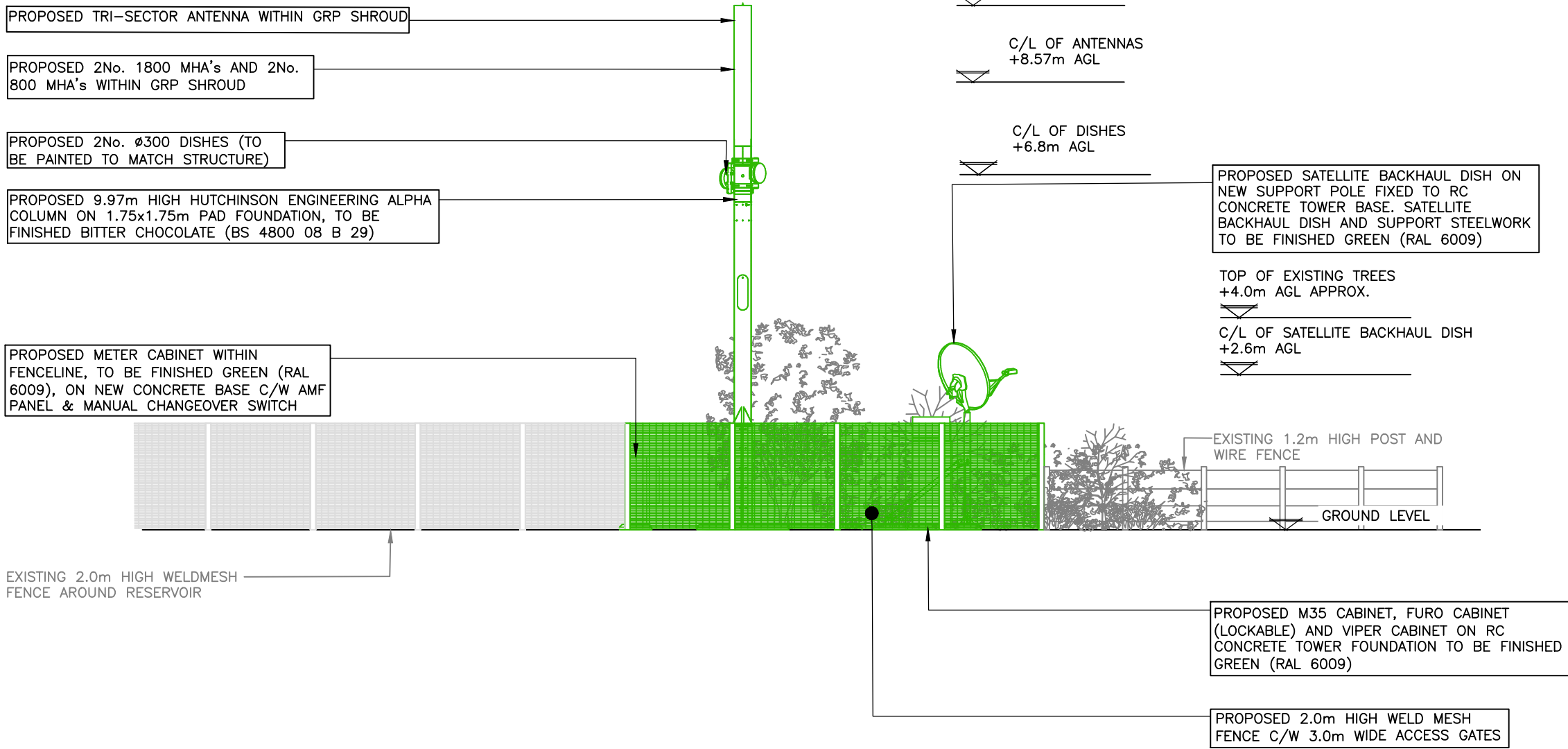

PROPOSED NORTH WEST ELEVATION
(1:100)

SCALE 1:100