

From: WJ Barker
Sent: 07 February 2021 14:01
To: Kelsey Blain
Subject: Re: nym.2020/0597/lb

Good Afternoon

Further to your email of 12th January 2021

I enclose plans replicating the oldest windows in my home.

These drawings indicate the design, detailing, finish and sectional details.

The windows will sit in the existing reveal.

The enclosed photos show a ruler held against the existing windows to prove they are an accurate copy of in terms of dimension, mouldings and placement.

The mortar used will use 'hot lime' in keeping with tradition

I await your reply

W John Barker
Greylands Farm
Hinderwell
-----Original Message-----

From: Kelsey Blain
To: WJ Barker
Sent: Tue, 12 Jan 2021 17:39
Subject: RE: nym.2020/0597/lb

Chris France

Dear Mr Barker,

Thank you for your email and for confirming that you are happy to use the Fineo glass within the replacement windows.

As previously discussed, the replacement window frames should be an accurate copy of the existing and therefore in order to progress the application without a site visit, I would be grateful to receive detailed drawings of the existing windows supported by internal photos of the windows. The details contained within these drawings and photos should be used to inform the design of the replacement window frames.

As there are currently a variety of window styles within the front elevation of the property, either of the following options would be acceptable:

- Each replacement window would be an accurate copy of the window it is replacing.
- Or;
- All 7 no. windows would be designed to replicate the details of the 2 no. ground floor windows on the south (right hand side) of the property as these are the oldest windows within the property.

I would be grateful to receive revised drawings indicating the design, detailing, finish and sectional details of the replacement windows. As advised within the Committee meeting, these drawings should indicate how the windows will sit within the reveal so that the Authority can assess the bulk of the frame. Any new window should be an accurate copy in terms of dimensions, mouldings and placement.

I hope that the above is of assistance but if you have any questions please feel free to contact me.

Kind regards,

K. Blain

Kelsey Blain
Planning Assistant

North York Moors National Park Authority
The Old Vicarage
Bondgate
Helmsley
York
YO62 5BP
Tel: 01439 772700
www.northyorkmoors.org.uk

From: WJ Barker
Sent: 12 January 2021 08:31
To: Kelsey Blain; Chris France
Subject: nym.2020/0597/lb

Good Morning

It is now over 5 weeks since the December Planning Committee Meeting where my application was deferred, and 2 planned site meetings have been cancelled by yourselves.

I have sourced my own sample of the FINEO glass that you prefer, and I have had it for a while now. I have VERY reluctantly accepted its "dotty appearance" and as the only way forward, otherwise we will endure another cold winter in this house.

My joiners, Biker Bespoke, have now got back to me with an updated price. They needed to wait until the BREXIT deal was finalised, as it has to be imported from Belgium, so much for using local products and people!

The cost of using FINEO glass has increased to cost by another £6,000, to £23,665

Can the application now move forward?

I anticipate that you will need further drawings, so which window style of my 7 differing windows do you want to replicate ?

Looking forward to you response

John Barker



CONFIDENTIALITY: The contents of this message are the views of the author, not necessarily the views of the North York Moors National Park Authority. This is a private message intended for the named addressee(s) only. Its contents may be confidential.

If you have received this message in error please reply to say so and then delete the message. Any use, copying, disclosure or distribution by anyone other than the addressee is forbidden.

www.northyorkmoors.org.uk

NYMNPA

08/02/2021



A

NYMNPA

08/02/2021



NYMNPA

08/02/2021



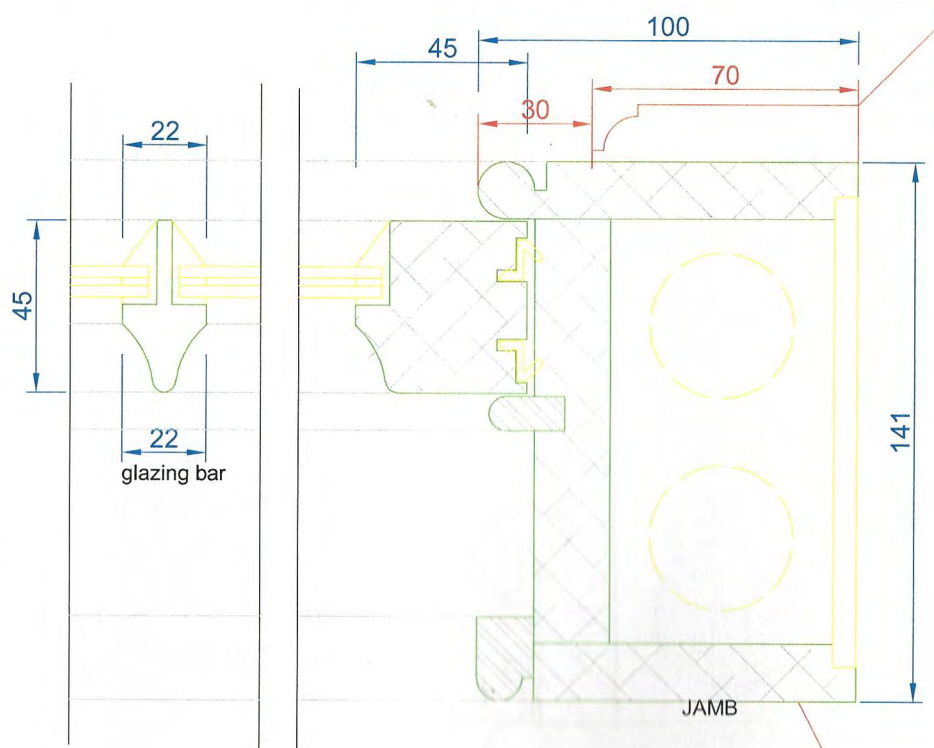
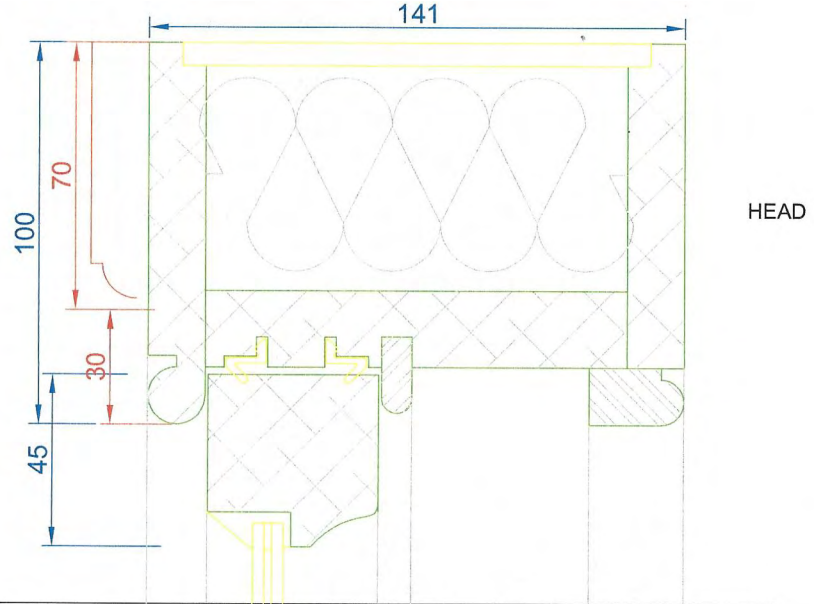

15 TO 40MM
EXISTING MORTAR
POINTING

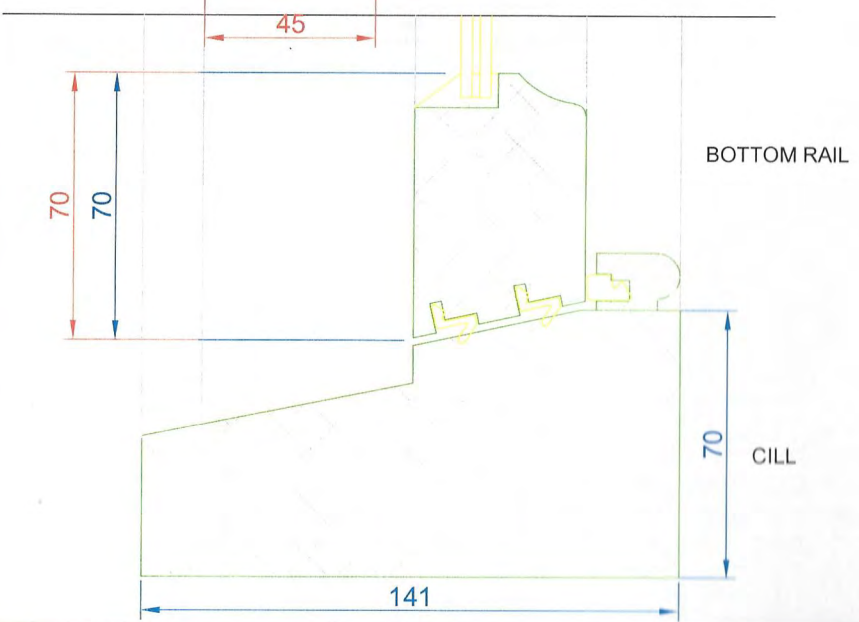
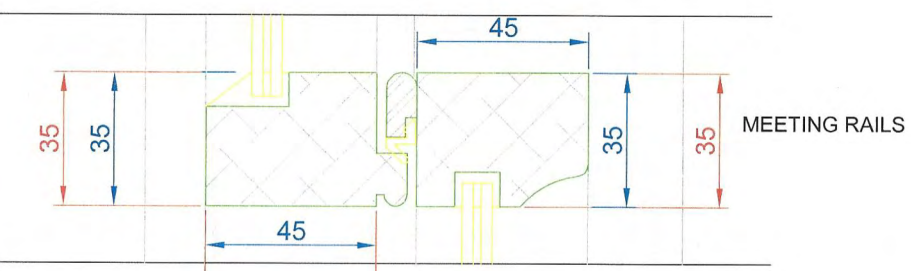

Note: - WINDOW TO SUIT FINEO 8 GLAZING UNIT
- PUTTY POINTED EXTERNALLY

BIKER BESPOKE
HANDMADE JOINERY

client: Mr & Mrs Barker

job: GREYLANDS FARM - HINDERWELL

drawing:
VERTICAL SLIDING SASH WINDOW 8
- LAMBS TONGUE DETAILS- DIMS IN
RED ARE EXISTING WINDOW SIZES

Revisions:

scale: 1:2 @ A4 (half full scale)

first issue: 05/02/2020

Drawn: JPW Checked: MT

Diagrammatic only - do not scale from drawing

AMENDED

NYMNPA
08/02/2021