

Brook House Farm

NYM/2020/0826/FL.

Hawsker

Whitby

YO22 4ST.

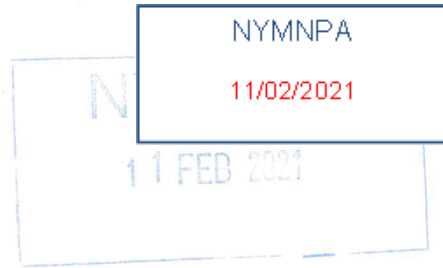

I write to confirm that the proposed use of the indoor riding facility by third parties is removed from the application at this time.

I am happy to take the advice and also have a restriction on the towing site limiting use between March + October. (Seasonal).

Many Thanks

Mrs K Rollinson

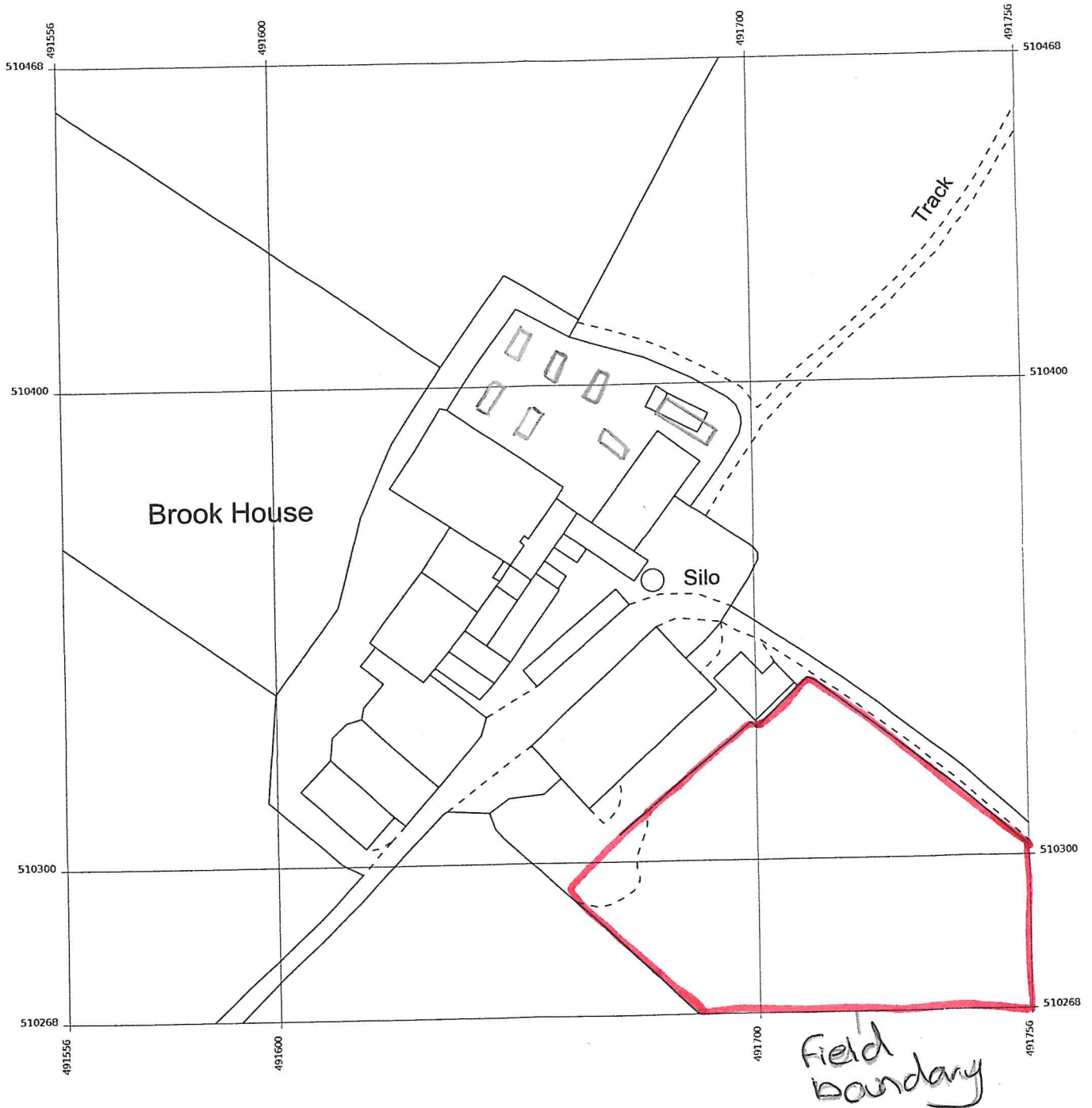

Produced 28 Oct 2020 from the Ordnance Survey MasterMap (Topography) Database and incorporating surveyed revision available at this date.

The representation of a road, track or path is no evidence of a right of way. The representation of features as lines is no evidence of a property boundary.

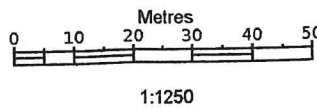

Supplied by: Stanfords 28 Oct 2020
 Licence: © Crown Copyright and database rights 2020 OS100035409
 Order Licence Reference: O11431570
 Centre coordinates: 491656 510368

Brook House Farm, Hawsker Ln To
 Whitby High Light Lighthouse, Hawsker,
 Whitby
 YO22 4JY

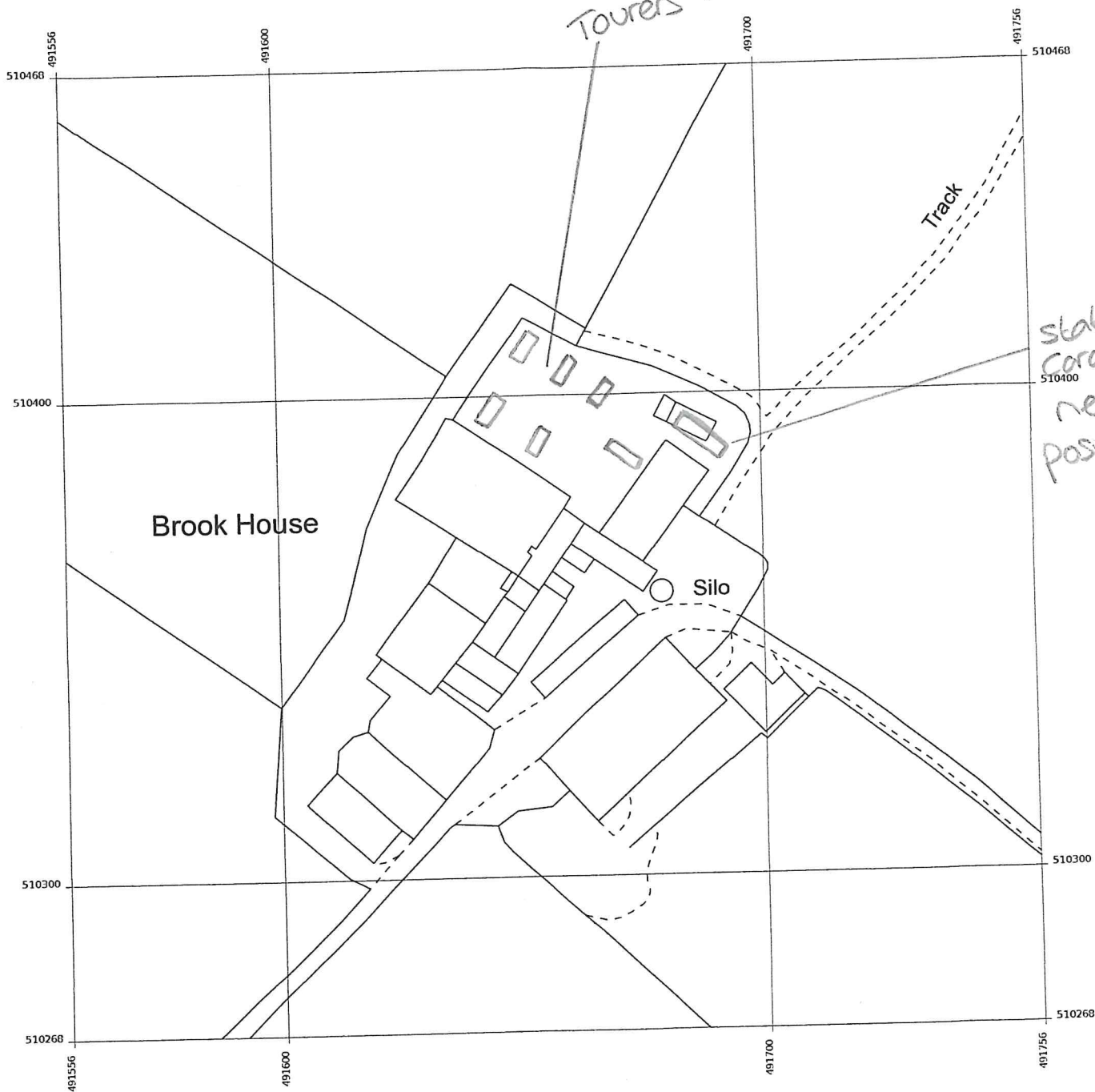

Produced 28 Oct 2020 from the Ordnance Survey MasterMap (Topography) Database and incorporating surveyed revision available at this date.

The representation of a road, track or path is no evidence of a right of way. The representation of features as lines is no evidence of a property boundary.

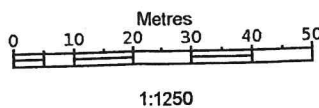

Supplied by: Stanfords 28 Oct 2020
 Licence: © Crown Copyright and database rights 2020 OS100035409
 Order Licence Reference: OI1431570
 Centre coordinates: 491656 510368

Brook House Farm, Hawsker Ln To
 Whitby High Light Lighthouse, Hawsker,
 Whitby
 YO22 4JY

Caravan site revised plan

Caravan storage in high part of barn.

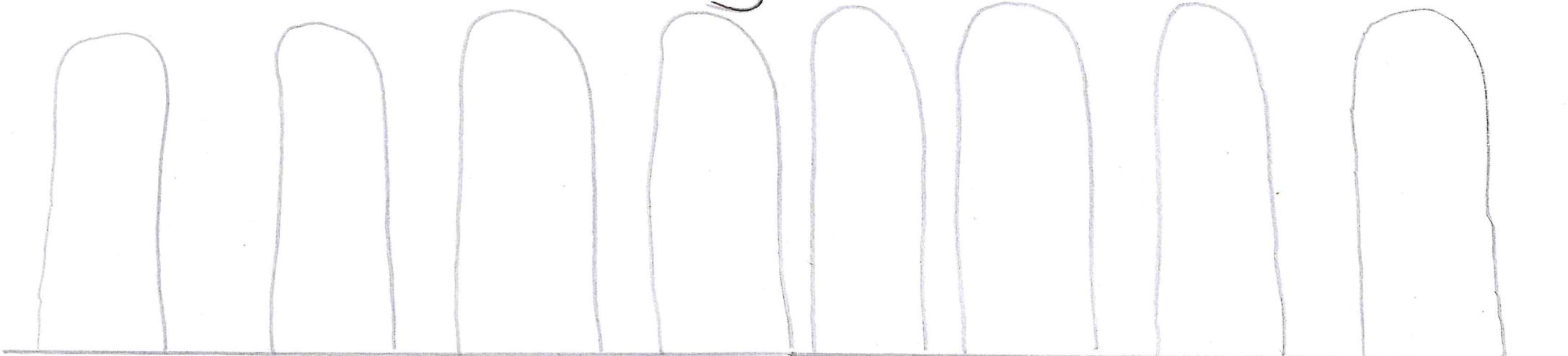

Agricultural use.

Agricultural use

Stable horse holiday

(Multi use Barn)

Stable horse holiday

Stable horse holiday