

---

**From:** Victoria Wharton

**Sent:** 09 June 2021 10:22

**To:** Helen Webster

**Subject:** Re: NYM/2021/0229/FL - land at Station Square, Ravenscar

Dear Helen,

Please find revised drawings for the above application. The applicant is not willing to compromise on size or design, he is happy to fully clad it in Yorkshire boarding though. I would like to reiterate that the building will not just be used for stabling but also storage.

We feel the proposal is a vast improvement on the existing structure/s which is/are not fit for purpose. The size is very similar to the existing building which is 37m<sup>2</sup>, the proposed building is 48m<sup>2</sup>. It is marginally higher to accommodate the large breed horses better than the current stabling, as it is they bang their heads on the beams inside.

It is more agricultural in looks than a typical domestic stable, however large breeds need a bigger space and higher roof than your average pony/horse. It also needs to be robust enough for the weather in this area, as previously mentioned Mr Anderson has provided stabling with overhangs and these have been blown off in the prevailing winds.

The site is well screened from neighbouring properties. The only viewpoint from public land is from station square, when standing in the corner looking directly at it. The cinder track is not accessible near the proposal, it is overgrown and poorly maintained in this location. The topography of the land allows it to remain hidden from all other viewpoints. Once the Yorkshire boarding has weathered to a silvery grey it will blend into the landscape and not appear at odds with it, the door could be painted a grey to match the boarding.

The building would not look out of place in this location, there are many agricultural buildings located around the area, in very visible locations, which are being used for stabling.

For the reasons given above and contained within the Design and Access Statement we feel the application is acceptable and would be fit for purpose.

Kind Regards  
Victoria Wharton  
Architectural Design



FRONT ELEVATION

SIDE ELEVATION

REAR ELEVATION

SIDE ELEVATION

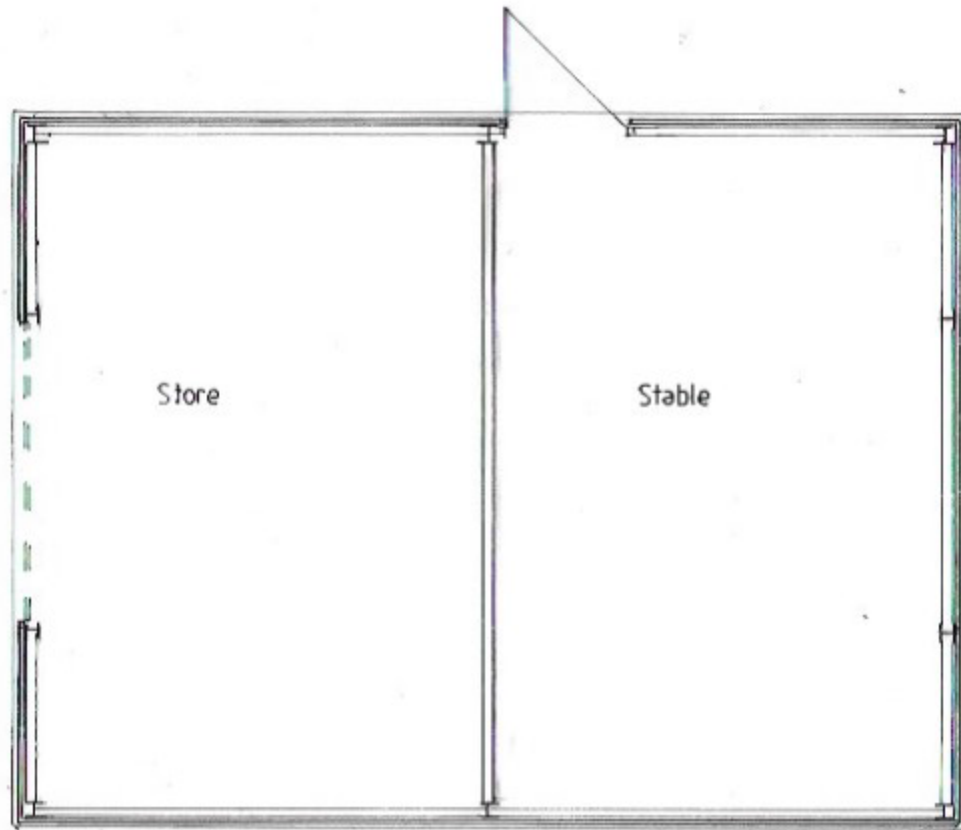

PLAN

AMENDED

NYMNP  
09/06/2021

Rev A-Blockwork removed.  
Proposed Replacement Stable Block on  
Land near to Station Square, Ravenscar

Proposed Arrangements

Date:	Mar 21	Job No.	21/03
Drawn:	VW	Drg No.	03
Scale:	1:100 1:50	Rev.	A

Victoria Wharton  
Architectural Design  
7 Red Scar Lane  
Scarborough  
YO12 5RH