From: Andrea Long
Sent: 25 March 2022 15:39
To: Hilary Saunders
Subject: Re: ADDITIONAL INFO TO ACTION - NYM/2021/0923/OU

Dear Hilary

By way of an update we have continued our discussions with Ged at Highways and we have amended the layout to take on board his comments. It is appreciated that the application is in outline and therefore the layout is reserved for a future application however, this layout does indicate that it is possible to accommodate a layout that meets the highways requirements.

As I am sure you may have already picked up the Egton show will be going ahead this year and has found a new home.

[Egton Show, near Whitby, will go ahead this summer | The Scarborough News](#)

I assume that any committee report for the application will be available from 1st April 2022?

Best Wishes

Andrea

Andrea Long
BSc Hons MRTPI
Director

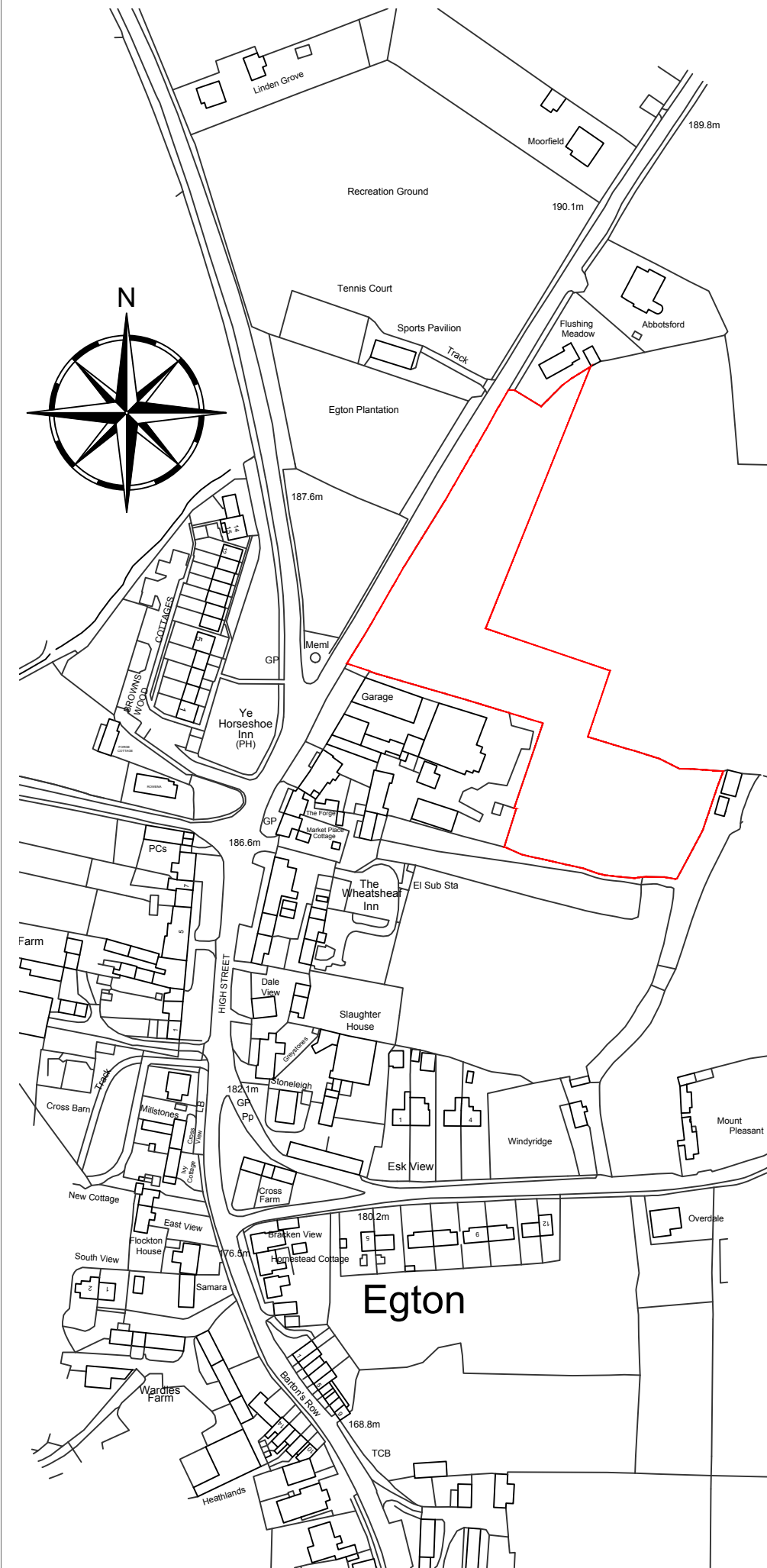

LOCATION PLAN (Scale 1:2500)

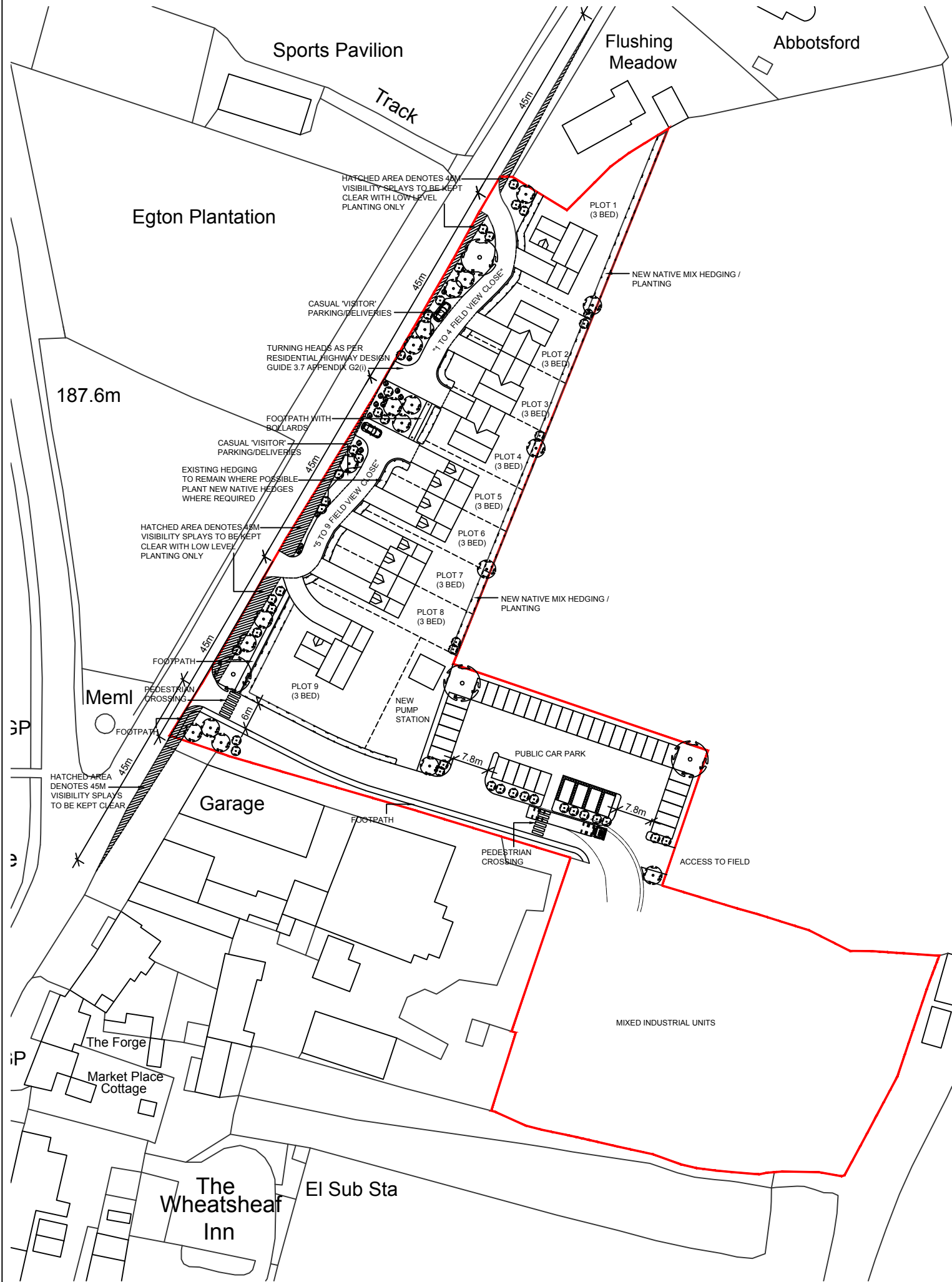

BLOCK PLAN (Scale 1:1000)

Rev	Date	Description	Drawn	Check	Approve
A	10/09/2021	VARIOUS AMENDMENTS FROM CLIENT/ESTATE DISCUSSIONS	JG	AL	RC
B	06/01/2022	VARIOUS AMENDMENTS FROM CLIENT/PLANNING DISCUSSIONS	JG	AL	RC
C	15/03/2022	LAYOUT AMENDMENTS INCLUDING TURNING HEADS	JG	AL	RC
D	25/03/2022	VISIBILITY SPLAY ANNOTATION & CAR PARK ACCESS AMENDMENTS	JG	AL	RC

NYMNPA
25/03/2022

AMENDED

dream-haus 
dream-haus limited
103 yew drive-brandon
suffolk-england-IP27 0AB

Client **EGTON & MULGRAVE ESTATES**

Project **MIXED USE SCHEME
EGTON, WHITBY, YO21 1UD**

Drawing **LOCATION & BLOCK PLANS**

Drawing Number **02-2021-1001**

Scale **VARIOUS** Sheet **1 OF 1** Rev **D**

© DREAM HAUS LIMITED 2022 (Company Reg. Number 07870039)
DRAWING PROPERTY OF DREAM HAUS LIMITED
ALL DIMENSIONS IN MILLIMETERS UNLESS STATED OTHERWISE. Drawn **JG**