

**From:**  
**To:** [Planning](#)  
**Cc:** [Andrew Muir](#)  
**Subject:** FW: Salt Pan Lodge, Cloughton - NYM/2022/0487/FL  
**Date:** 28 June 2022 15:32:11  
**Attachments:** [image001.png](#)  
[spl107.pdf](#)  
[spl104\\_a.pdf](#)  
[Diamond UK Brochure.pdf](#)  
[WPL Diamond DMS 2.pdf](#)  
[Non\\_mains\\_drain.pdf](#)

---

Dear Planning

Further to your letter today I am pleased to confirm that the development will in fact be served by a new private sewage package treatment plant as shown on the attached plan.

Please find attached completed non mains drainage form and the specification of the system to be used.

Kind regards

*Cheryl*

Cheryl Ward Planning  
MSc MRTPI (Chartered Member)

**Note: I will be away from the office on Fri 15<sup>th</sup> July**



Chartered Town Planner  
MSc MRTPI

[www.cherylwardplanning.co.uk](#)

Cheryl **Ward**  
Planning



This email and any files transmitted with it are confidential and intended solely for the use of the individual or entity to whom they are addressed. If you have received this email in error please contact

 Before printing, think about the environment

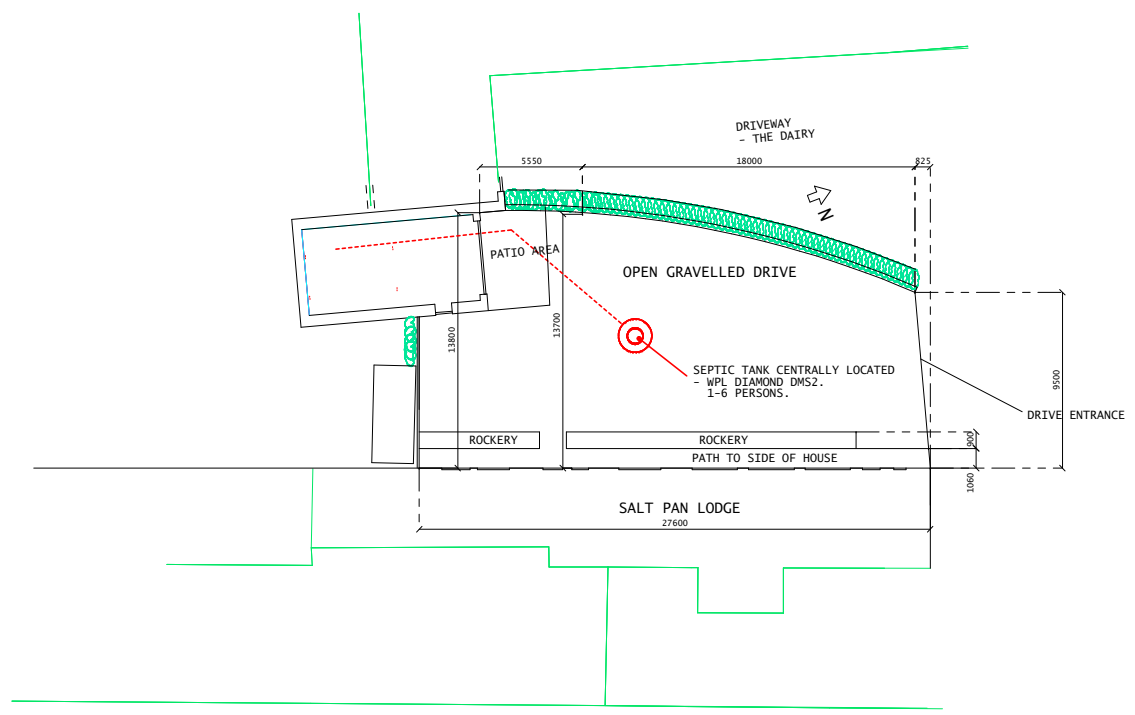

NYMNP  
28/06/2022

AMENDED

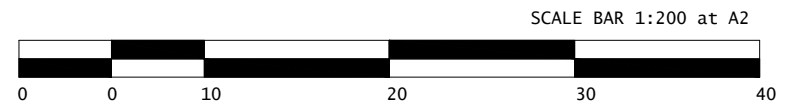

				CLIENT MICHAEL & DEBRA ALLAN	PROJECT PROPOSED ANNEX, SALT PAN LODGE, NEWLANDS LANE, CLOUGHTON, SCARBOROUGH, N.YORKS. YO13 0BB.	DESCRIPTION SEPTIC TANK LOCATION			
REV	BY	DATE	DETAILS				DATE : JUNE 2022	DWG No. - SPL107	0

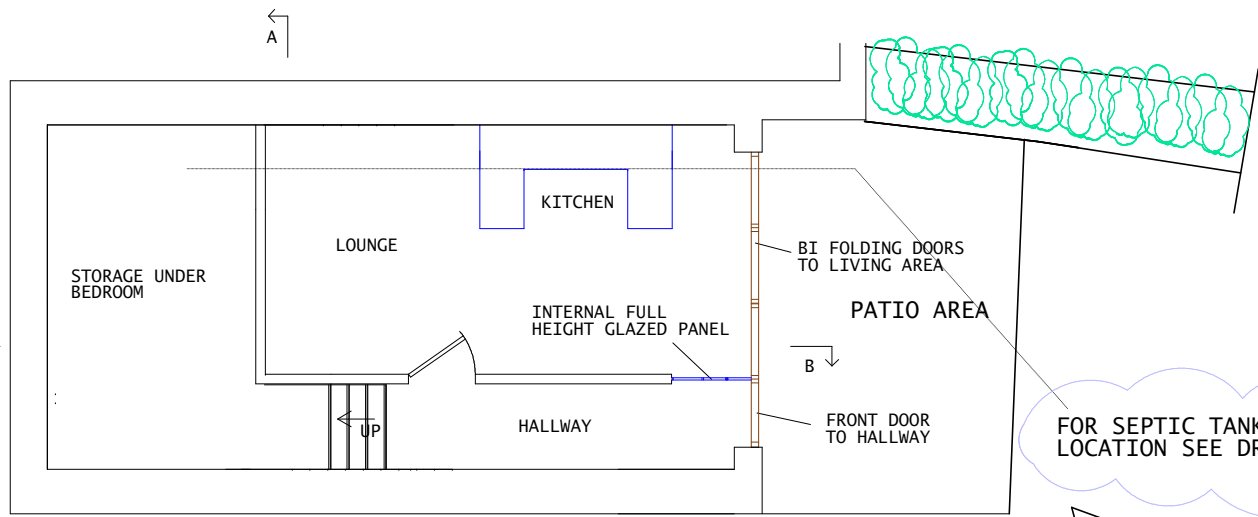

**NYMNPA**  
28/06/2022

**AMENDED**

PROPOSED GROUND FLOOR +0.00 - scale 1:50

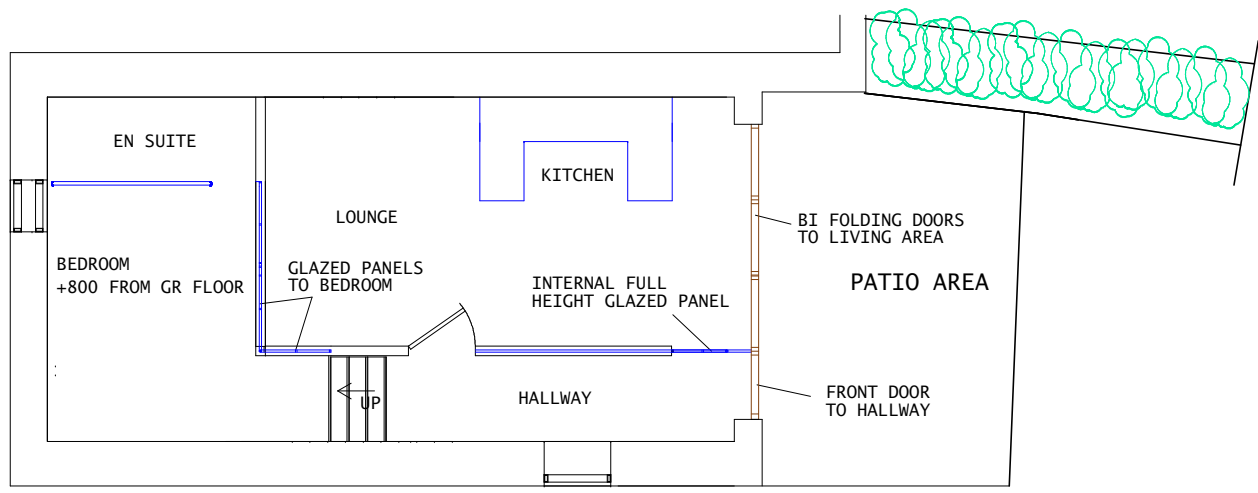

**NOTE!**  
ALL NEW INTERNAL WALLS, GLAZING AND EXISTING TRUSSES TO PROVIDE 30 MINUTE MINIMUM FIRE RESISTANCE TO BEDROOM/HALLWAY

PROPOSED MEZZ BEDROOM PLAN +800 - scale 1:50

GENERAL NOTES.

- AMENDMENTS TO DESIGN FROM PREVIOUS REFUSED APPLICATION -NYM/2021/0823/FL
1. FIRST FLOOR REMOVED AND PROPOSED LOWERING OF GROUND FLOOR NOT REQUIRED.
  2. REMOVAL OF 2 No. ROOFLIGHTS.- NONE NOW REQUIRED.
  3. NEW REAR BEDROOM AREA LIFTED TO OFFER STORAGE BENEATH FOR NEW DWELLING.
  4. SIDE DOOR REMOVED SO ALL ACCESS TO PROPERTY NOW TO BE FROM NORTH ELEVATION ONLY.

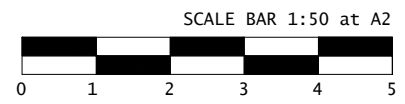

A	MA	28/06	SEPTIC TANK NOTE ADDED.	CLIENT MICHAEL & DEBRA ALLAN	PROJECT PROPOSED ANNEX, SALT PAN LODGE, NEWLANDS LANE, CLOUGHTON, SCARBOROUGH, N.YORKS. YO13 0BB.	DESCRIPTION PROPOSED FLOOR PLANS	DATE : APRIL 2022	DWG No. - SPL104	A
REV	BY	DATE	DETAILS						

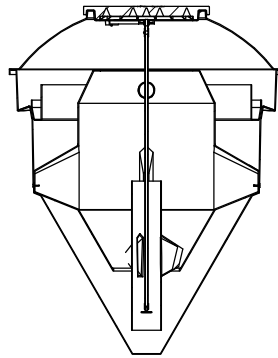
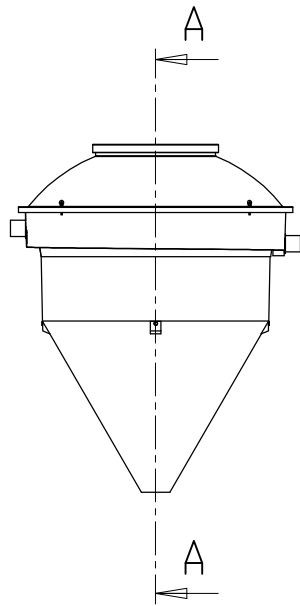

SECTION A-A

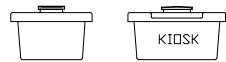
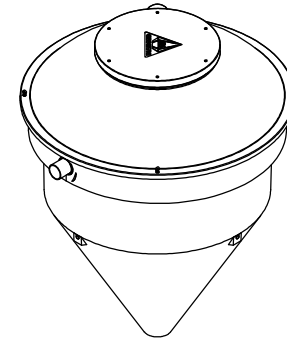

NYMNPA  
 28/06/2022

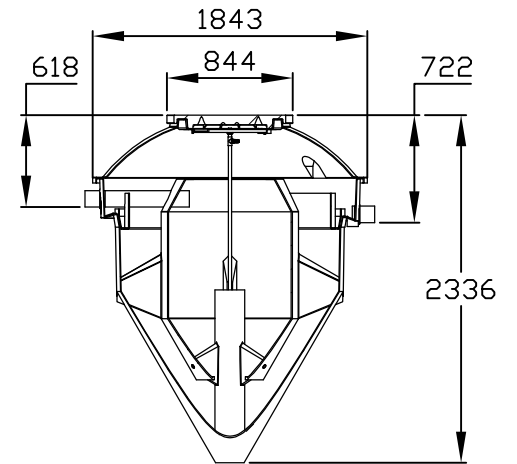
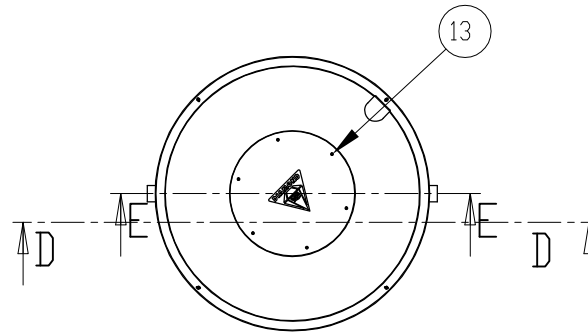

SECTION D-D

ISSUE	DATE	CHANGE	NAME	UNLESS OTHERWISE SPECIFIED: DIMENSIONS ARE IN MILLIMETERS SURFACE FINISH TOLERANCES: LINEAR: ANGULAR:			<b>WPI LIMITED</b> 1 & 2 ASTON ROAD WATERLOOVILLE HAMPSHIRE PO7 7UX TEL: (02392) 242600 FAX: (02392) 242624 e-mail: engineering@wpl.co.uk		FINISH:						
A	10/06/08	NEW DRAWING	RJM				WPL LIMITED 1 & 2 ASTON ROAD WATERLOOVILLE HAMPSHIRE PO7 7UX TEL: (02392) 242600 FAX: (02392) 242624 e-mail: engineering@wpl.co.uk		NATURAL						
.	.	.	.						TITLE: ROTAMOULD DIAMOND A ASSEMBLY						
.	.	.	.												
.	.	.	.												
.	.	.	.												
					NAME	DATE	© This drawing is the copyright of WPL Ltd REFER TO BOM		DWG NO. DD-652-301		A3				
				DRAWN	RJM	10 JUNE 08					SCALE: 1:35		SHEET 1 OF 2		REV
				CHK'D	.	.									A
				DESIGN	.	.	WEIGHT:		SHEET 1 OF 2						
				DO NOT SCALE DRAWING											



NYMNPA

28/06/2022



## **SIMPLE, RELIABLE & DISCREET**

Compact wastewater treatment plant





# WPL Diamond

---

## Environmentally compliant

Our range of WPL Diamond small packaged wastewater treatment plants are suitable for domestic and commercial properties in all ground conditions where mains drainage is unavailable.

Every day over 36 million litres of water is recycled back in to the environment through our WPL Diamond wastewater treatment plants. Our high quality treatment process consistently meets increasing regulations set by the Environment Agency, safely discharging (final effluent) into a soakaway or watercourse.

---

## British design and build

Designed and built at WPL, our patented Diamond not only gives you the highest quality process on the market, but also provides you with a discreet, efficient and cost-effective solution for the longevity of the plant. This is achieved through our continued commitment to improve product design, development and manufacturing processes; backed by our commitment to engineering excellence for over 25 years.

---

## Trusted network

Our trusted network of independent experts can offer professional advice on project specifications, compliance and guidelines; whilst providing installation, service and maintenance.

---







# WPL Promise

---

WPL has been at the forefront of wastewater treatment for over 25 years; understanding your need for a high quality, easy to maintain and discreet product.



## Low maintenance and long-term value:

- **Longer emptying cycles (up to 3 years desludge) -**  
due to our highly efficient aeration process which breaks down organic matter at a reduced sludge growth rate.
- **No internal electrical or mechanical moving parts -**  
inside the tank, offering minimal maintenance compared to other processes on the market which are prone to breaking down.
- **25 years tank warranty -**  
and 2 years warranty on the blowers (housed in the kiosk)\*.



## Compliant - meeting standards and codes of practice:

- **Fully tested, accredited and certified -**  
under European Standard BS EN12566-3 2014 approval which allows a CE mark.
- **Meets consent standards -**  
of 20mg/l BOD; 30mg/l SS; 20mg/l NH<sub>4</sub> as a minimum.
- **General Binding Rules update 1st January 2020 -**  
unlike a septic tank we consistently meet the General Binding Rules: small sewage discharge to surface water.
- **Part H2 UK -**  
of building regulations.
- **Binding Rules legislation -**  
for exemption from a permit to discharge by the Environmental Agency.
- **LABC registered**
- **Designed using the British Water Code of Practice Flows and Loads -**  
to ensure that the tank is correctly sized.
- **Safe discharge -**  
of final effluent into a soakaway or watercourse.



## Discreet

- **Our plant is odourless -**  
so you won't even know it's there!\*
- **Flushest lids to the ground -**  
creating perfect integration in to the landscape.
- **Compact in design -**  
keeps the excavation to a minimum and installation simple.
- **Range of invert depths -**  
for complicated sites, allowing more discharge options.

\*subject to correct installation, consistent influent conditions and regular plant maintenance as per the manufacturers' instructions

---



## Ideal septic tank replacement - General Binding Rules regulation update

Homeowners with septic tanks that discharge directly into the surface water will now need to consider the option of replacing with a packaged wastewater treatment plant such as a WPL Diamond - by (or before) the 1st January 2020 when selling a property or upgrading an 'end of life' septic tank.

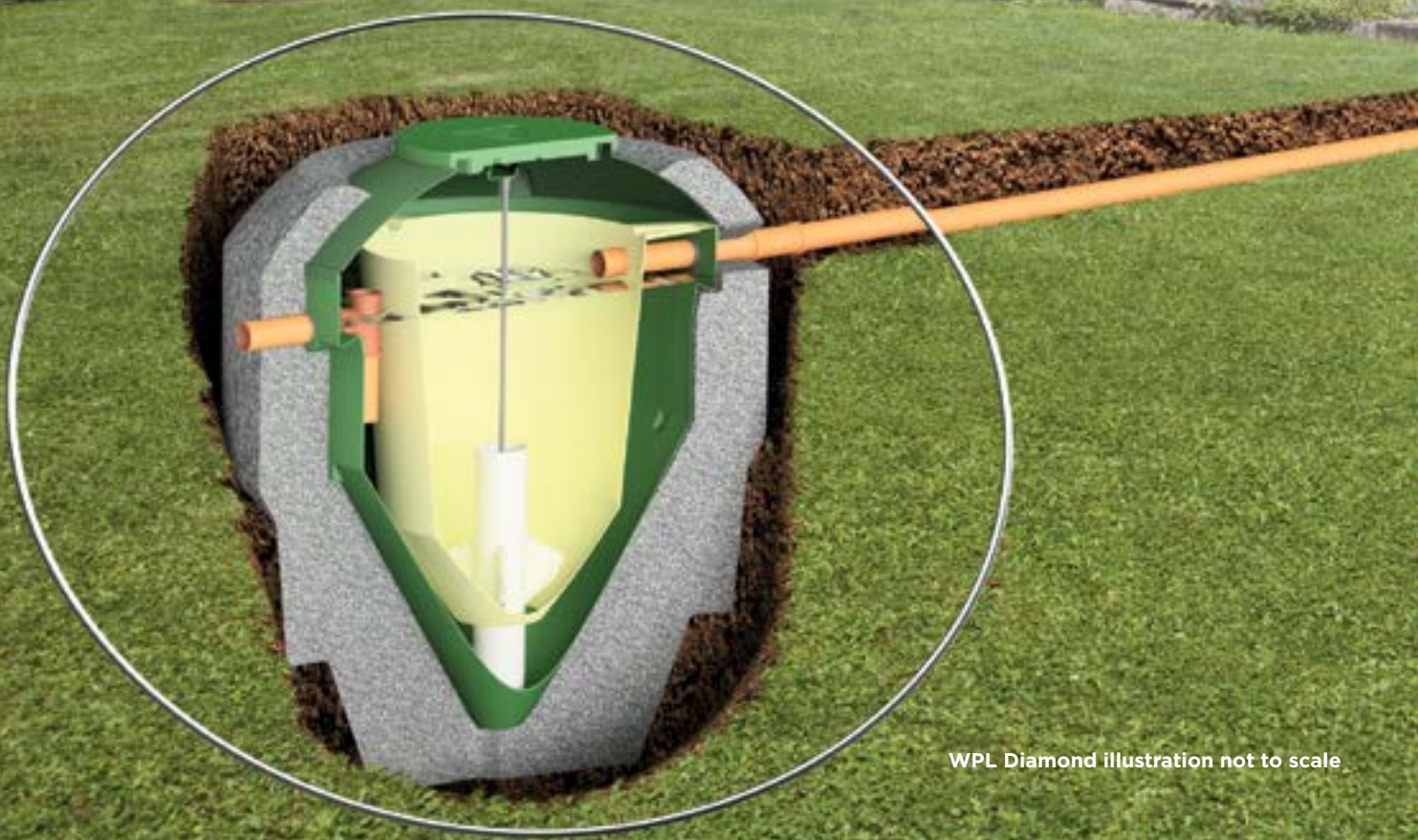

WPL Diamond illustration not to scale

# Simple and reliable operation

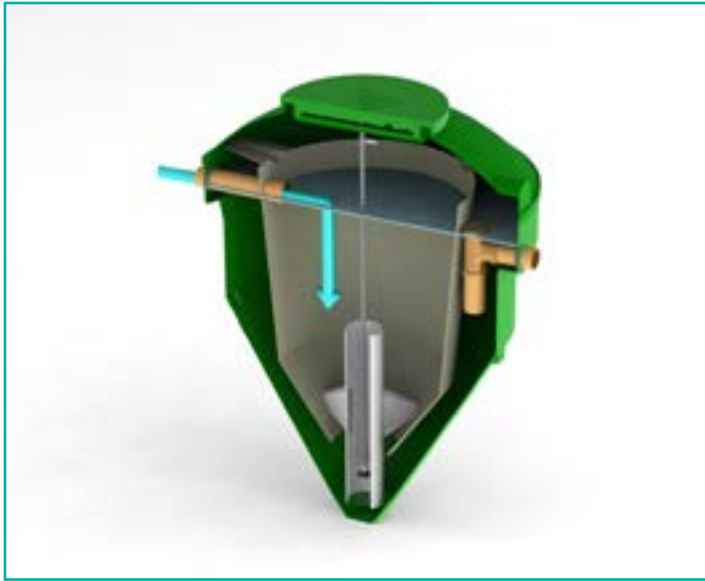

**1: The wastewater flows into the main tank and enters directly into the bio-chamber.**

The bio-chamber is a zone where the solids circulate continuously; this is achieved by air rather than mechanical or electrical parts inside the tank.

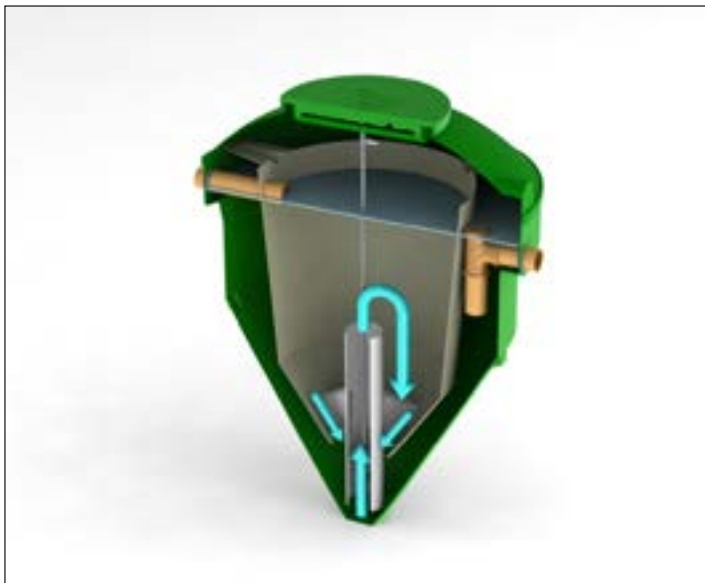

**2: The draft tube enables the solids to be drawn back up into the central aeration chamber and re-circulated through the treatment process.**

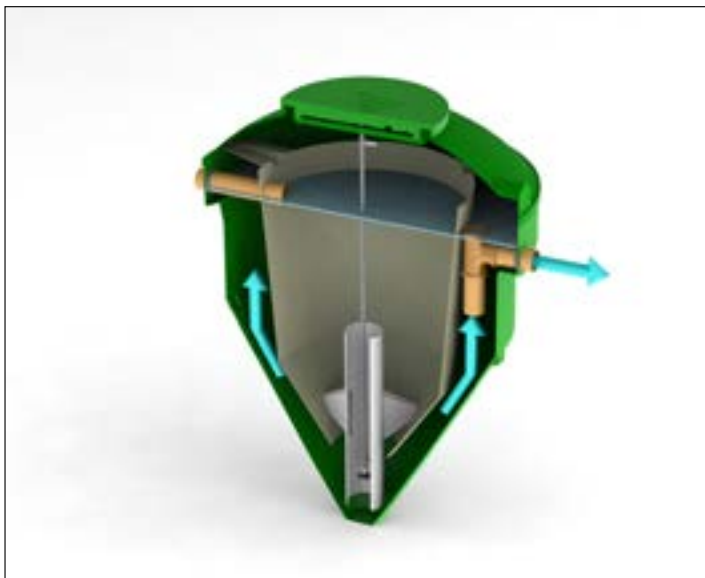

**3: The treated liquid then exits through the dip pipe and is discharged safely in to the environment, meeting the required consent standard.**

# Technical Specification

## Loadings

Model	DMS2	DMS3	DMS4	DMS5	DMC6	DMC7	DMC8	DMC9
Population range (persons)	1-6	5-11	10-15	14-20	21-27	28-35	36-45	46-55
Blower motor size (kw)*	0.080	0.090	0.160	0.230	0.230	0.221	0.221	0.221
Total power consumption	0.080	0.090	0.160	0.230	0.460	0.663	0.663	0.663

\*Actual power consumption may vary (dependent on motor efficiency and nature of installation), size stated is motor size NOT actual power consumption. Blower options available on request.

## Dimensions

Model	Max outside diameter (m)	*Inlet invert depth (mm)	Max height/ in ground depth (m)	Weight empty (kg)
DMS2	1.74	630	2.33	155
DMS3	1.96	760	2.59	192
DMS4	1.99	780	2.78	210
DMS5	1.99	780	2.78	210
DMC6	3.30	570	3.35	380
DMC7	3.30	570	3.35	380
DMC8	3.30	580	3.72	460
DMC9	3.30	580	3.72	460

\* Deeper inverts can be accommodated with our range of standard invert extensions. All dimensions +/- 3% tolerance.



We can help you with additional information or recommend your nearest independent expert for installation, service and maintenance of your WPL Diamond packaged sewage treatment plant.

For more information contact us at:

[wpldiamond.com](http://wpldiamond.com)





## Our roots

WPL have been at the forefront of wastewater treatment technology for over 25 years, with international experience of technical design, quality of manufacture and supply of environmental wastewater solutions.

Our high level of expertise means that we offer all of our customers, from the individual home owner to the large municipal communities and industrial markets, robust wastewater treatment process solutions that are environmentally compliant.



## Contact

**WPL Limited**  
Unit 1 Aston Road  
Waterlooville  
Hampshire  
PO7 7UX  
United Kingdom

**Tel:** +44 (0)23 9224 2600  
**Email:** [enquiries@wpl.co.uk](mailto:enquiries@wpl.co.uk)  
**Web:** [wpldiamond.com](http://wpldiamond.com)

**WPL independent expert:**

## Disclaimer

WPL Limited registered in England & Wales NI 2583411 VAT No. 568 3801 15.  
WPL Limited has a policy of continual product development and the above information may be subject to change without notice. WPL Limited are fully compliant with the British Water Code of Practice.

WPL Ltd reserve the right to change specifications in line with company policy of improvement through research and development. Errors and omissions excepted. Models shown in this data sheet may include additional cost options that are not part of the standard specification.

**NORTH YORK MOORS NATIONAL PARK**

**NON MAINS DRAINAGE ASSESSMENT FORM**

*This form must be completed if your planning application includes proposals to use non mains drainage. Please complete and return 4 copies with your Planning Application (to enable prompt consultation with the appropriate bodies).*

In order that the suitability of these proposals can be assessed, the following information is required. All the relevant information requested must be supplied. Failure to do so may result in the Environment Agency objecting to your proposals until such time as the information is received, which means that your application will either be refused or not determined.

Location of the application site SANT PAN LODGE, NEWLANDS ROAD, GLOUGHTON

1. Please indicate distance to nearest mains drainage 190 m.

2. Number of Occupiers of proposed development:

Full Time \_\_\_\_\_

Part Time 2 PERSONS (MAX)

3. Number of previous occupiers (if applicable) N/A

4. What method of foul drainage is proposed (please tick the relevant box)

Septic Tank  Package Treatment Plant  Cess Pool

*If discharge to a soakaway is proposed please attach percolation test results, which should be carried out in accordance with BS 6297. You will need to have a percolation test carried out. For guidance on how to undertake this test, you may wish to seek advice from:*

The Environment Agency, Coverdale House, Aviator Court,  
Amy Johnson Way, Clifton Moor, York, YO3 4UZ.  
Tel: 01904 692296

*NB: If no results are provided, the Environment Agency may issue a prohibition notice preventing the use of the septic tank until such results are supplied.*

5. If a package treatment plant is proposed please supply details of plant manufacturer and model.

*NB: A discharge consent may be required for discharge from a treatment plant to watercourse or soakaway. Please contact the Environment Agency for an application form if you have indicated that a treatment plant is to be installed.*

6. i) If a cess pool is proposed please indicate why this method has been chosen in preference to an alternative such as a package treatment plant or septic tank N/A.

ii) Please advise capacity of cess pool (minimum size 18 cubic metres) \_\_\_\_\_

NYMNPA  
28/06/2022