From:**Sent:** 05 December 2022 13:59**To:** Megan O'Mara**Subject:** 2021/1028 Moor Lodge E12121- nymnp areas

Hi Megan,

Apologies for not getting back to you with the areas on this development.

I attach a plan showing my figures on this.

I have looked at the planning file on your website and it appears that there have been 2 approvals for single storey extensions, **4034 0170A** 26/09/2002 and **4034 0170** 23/05/80.

Having looked at the property it is very difficult to ascertain where or what part of the building these are. I have attached a few pictures for your help with this.

However, to be certain I have presumed all single storey elements are the subject of the two approvals noted and the 2 storey part of the Building is all original.

This still results in a gain of less than 30%.

Hopefully you are happy with this but let me know if you have any queries.

Kind regards

Neil

BHD Design Ltd Architectural services

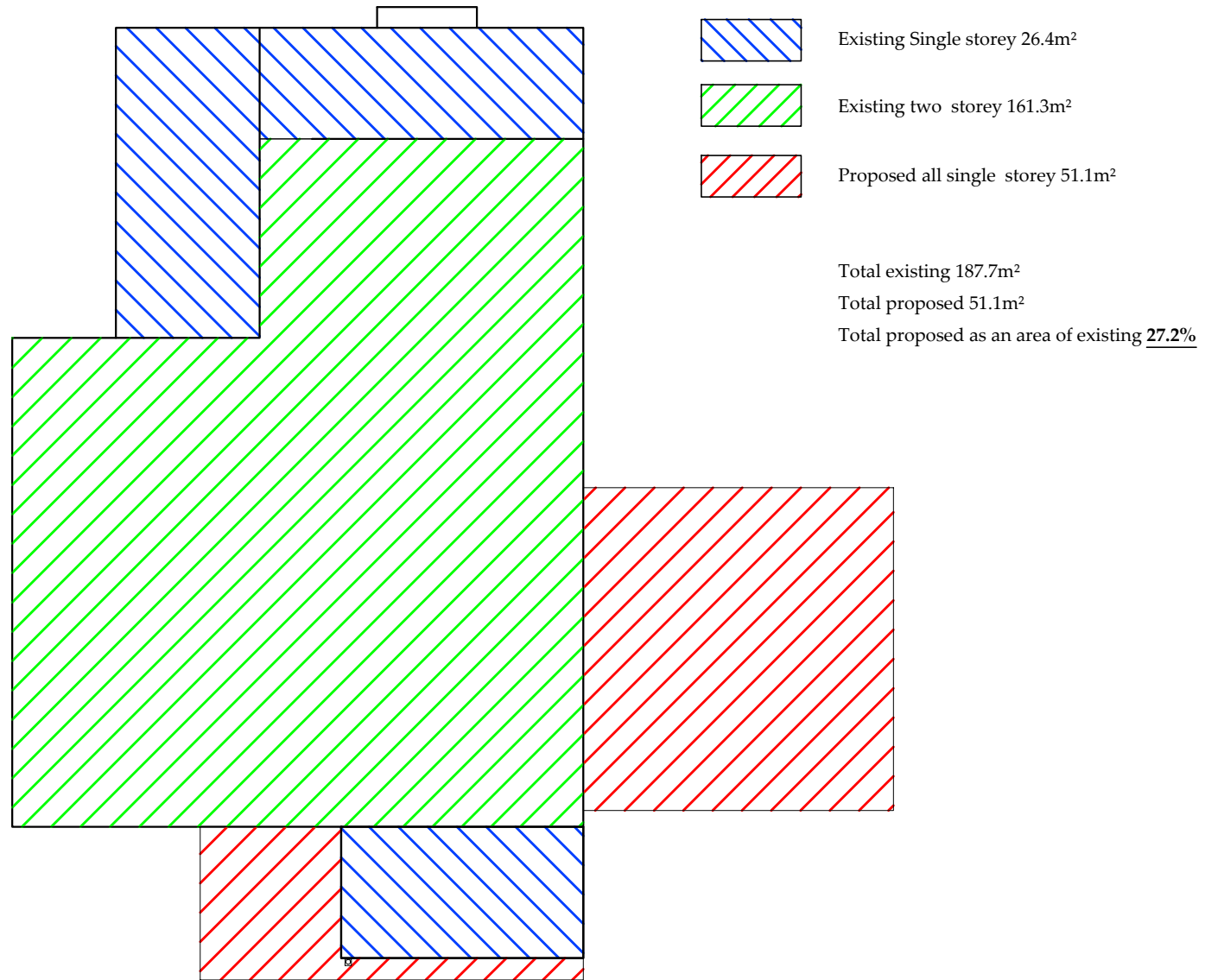

NYMNP

05/12/2022



NYMNPA

05/12/2022



NYMNP

05/12/2022



NYMNPA

05/12/2022



NYMNPA

05/12/2022

