

**ROOF CONSTRUCTION**  
 Roof construction to comprise of pantiles on 50x25 treated tile laths on a vapour permeable barrier (eg. Marley Ultima PR) or similar.  
 Built upon standard roof trusses  
 All tiles including eaves, ridge and verges to be nailed/clipped  
 roof members to be secured using proprietary anchors, clips and fixings all in accordance with specialist recommendations  
 Note: no notches or holes to be cut in roof rafters other than at supports where they may be birdsmouthed to a depth not exceeding 1/3 rafter depth

**construction notes:**

walls to be 100x50 treated timber studs with 25 thick wbp  
 plywood sheeting outer skin  
 50x25 treated horizontal battens  
 treated timber vertical yorkshire boarding

150 square treated timber post supports to the carport section

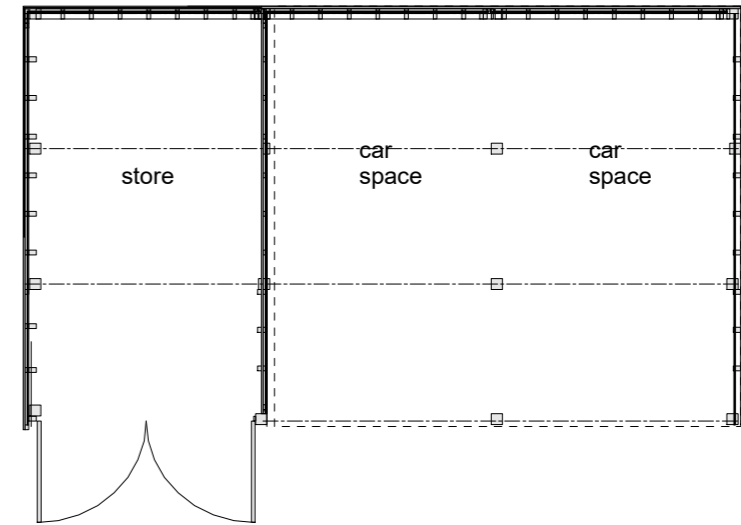

layout

**NYMNPA**  
**29/11/2022**

variation - proposed garages

