

Notes:

- For proposed general arrangement refer to drawing 40-ARI-WS-7100-CI-22-01103.
- For the existing layout refer to drawing 40-ARI-WS-7100-CI-22-01105.

Key:

- Planning Boundary
- - - Land ownership boundary

NYMNPA

09/01/2023

0	07/12/22	KK	JD	CW
For Planning				
A	01/11/22	KK	JD	CW
For Review				
REV	DATE	BY	CHKD	APPD

AngloAmerican

Anglo American Woodsmith Project Ltd
Rushden House Lakes View Scarborough YO11 3ZB North Yorkshire
T: +44 (0) 1723 470010 | W: uk.angloamerican.com

Drawing Title: **Woodsmith Mine Temporary Earthwork Storage Bund Location Plan**

SCALE: 1:2000

Job No: **253285**

DRG No: **40-ARI-WS-7100-CI-22-01106**

REV **0**

0 10 20 30 40 50 100 Metres

Scale 1:2000

THIS DRAWING IS CONFIDENTIAL AND THE PROPERTY OF ANGLO-AMERICAN PLC IT MUST NOT BE COPIED WITHOUT WRITTEN CONSENT

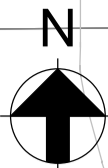

- Notes:
- For proposed general arrangement refer to drawing 40-ARI-WS-7100-CI-22-01103.
 - For the location plan refer to drawing 40-ARI-WS-7100-CI-22-01106.
- Key:
- Planning Boundary

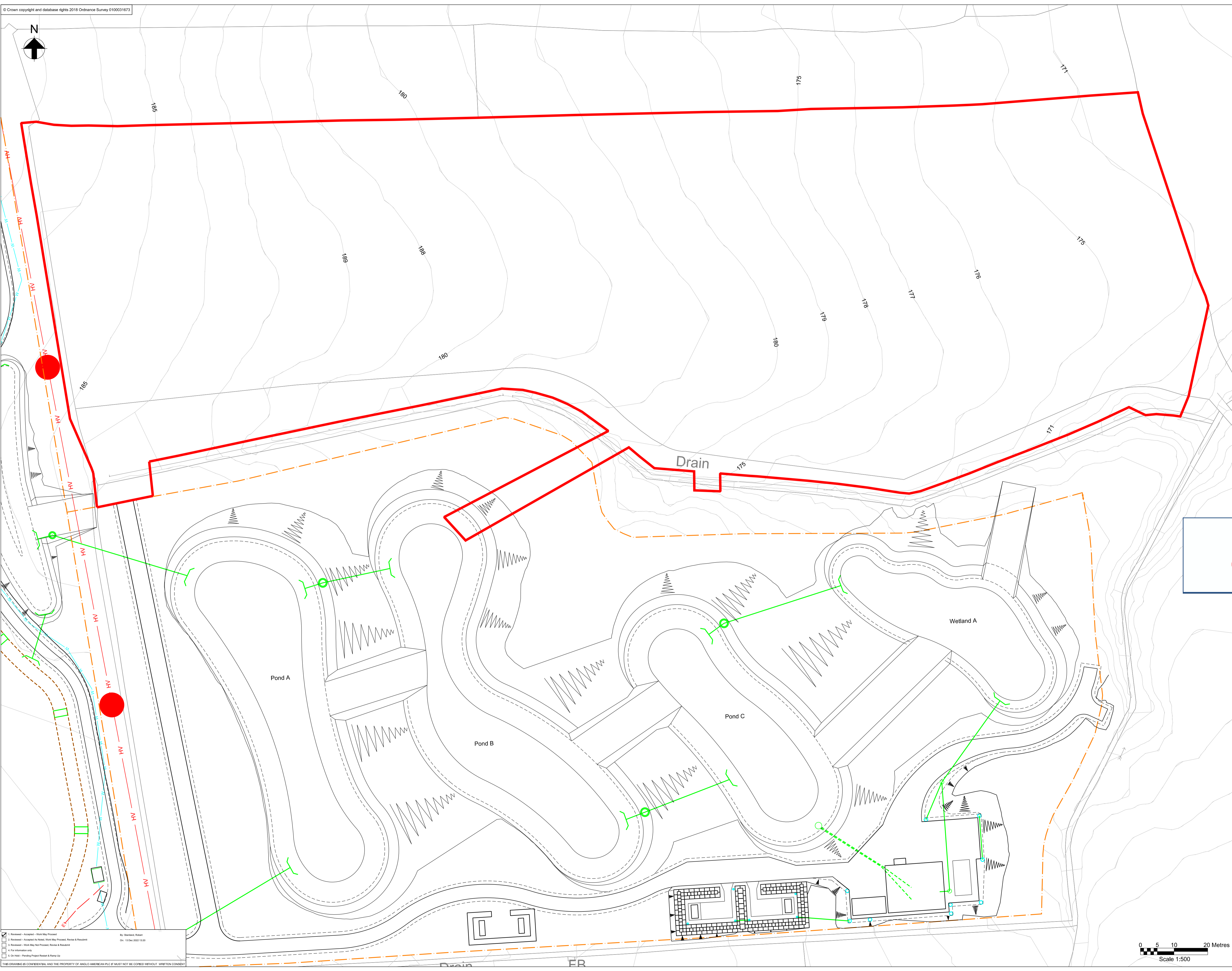

NYMNPA
09/01/2023

0	07/12/22	KK	JD	CW
For Planning				
A	01/11/22	EC	JD	CW
For Review				
REV	DATE	BY	CHKD	APPD



Drawing Title: **Woodsmith Mine
Temporary Earthwork Storage Bund
Existing Layout**

SCALE @ A1: **1:500**

Job No: **253285**



DRG No: **40-ARI-WS-7100-CI-22-01105** REV **0**

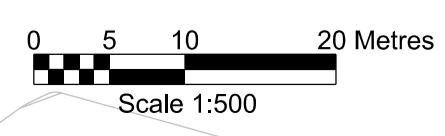

By: **Sebastian Ricketts** On: **13/06/2022 13:18**

Reviewed - Approved - Work May Proceed
 Reviewed - Approved As Noted - Work May Proceed, Review & Resubmit
 Reviewed - Work May Not Proceed - Review & Resubmit
 For Information Only
 On Hold - Pending Project Restart & Permit Up

THIS DRAWING IS CONFIDENTIAL AND THE PROPERTY OF ANGLO-AMERICAN PLC. IT MUST NOT BE COPIED WITHOUT WRITTEN CONSENT.

C:\global\enr\leeds\40-ARI-WS-7100-CI-22-01105_Planet\Revised\020 CAD P110 - Platform Redesign\020 CAD P110 - Platform Redesign\020 CAD P110 - Platform Redesign\020 CAD P110 - Platform Redesign\020 CAD P110 - Platform Redesign.dwg

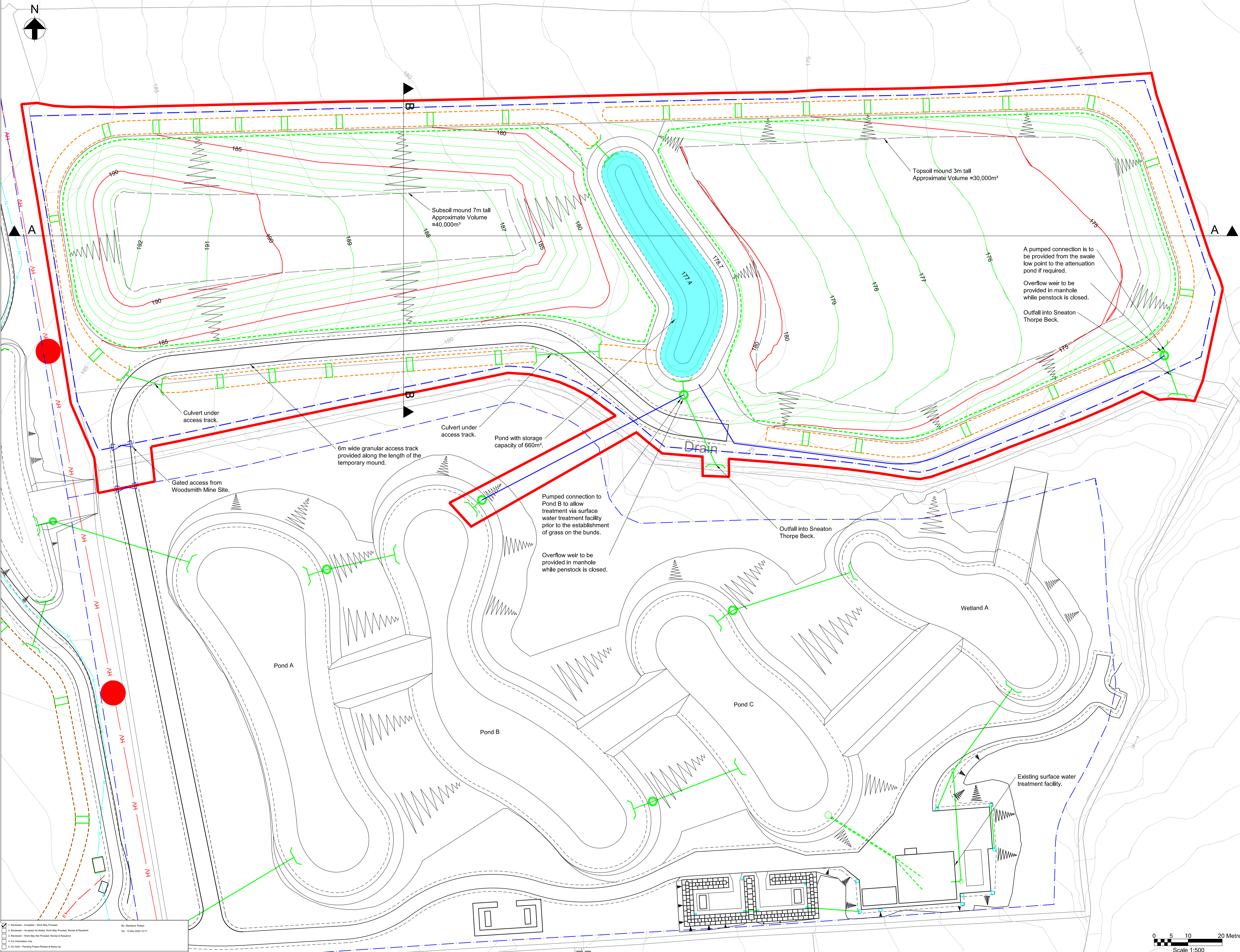

- Notes:
- For cross sections refer to drawing 40-ARI-WS-7100-CI-10-01104.
 - For the existing layout refer to drawing 40-ARI-WS-7100-CI-22-01105.
 - For the location plan refer to drawing 40-ARI-WS-7100-CI-22-01106.

- Key:
- Planning Boundary
 - Major Contour (5m)
 - Minor Contour (1m)
 - Pumped connection
 - Carrier Pipe
 - - - Swale with check dams
 - - - 2.4m high black weld mesh fence
 - - - Silt fence

NYMNP
09/01/2023

0	07/12/22	KK	JD	CW
For planning				
A	01/11/22	EC	JD	CW
For Review				
REV	DATE	BY	CHKD	APPD

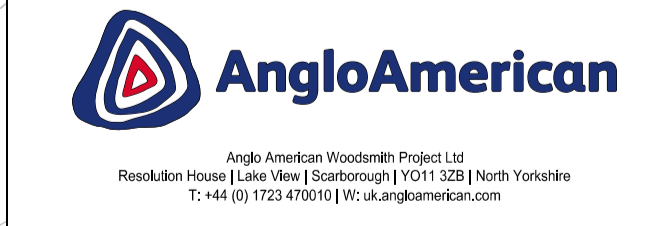

Drawing Title: **Woodsmith Mine Temporary Earthwork Storage Bund Proposed General Arrangement**

SCALE @ A1: 1:500

Job No: **253285**

DRG No: **40-ARI-WS-7100-CI-22-01103**

REV **0**

By: **Geoffrey Robert**
On: **10/06/2022 13:11**

Reviewed - Approved - Work May Proceed
 Reviewed - Approved for Issue - Work May Proceed, Review & Resubmit
 Reviewed - Work May Not Proceed, Review & Resubmit
 For Information Only
 On Hold - Pending Project Restart & Permit ID

THIS DRAWING IS CONFIDENTIAL AND THE PROPERTY OF ANGLO-AMERICAN PLC. IT MUST NOT BE COPIED WITHOUT WRITTEN CONSENT.

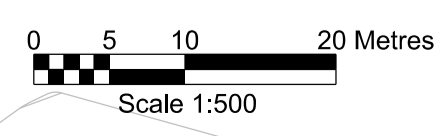

G:\ba\enep\Leeds\ba20000253285-001\2_Aup - P10 Platform Reseign\1020 CAD P10 - Platform Reseign\Paper Land\40-ARI-WS-7100-CI-22-01103_Paper Bund - GA.dwg

NYMNPA
09/01/2023

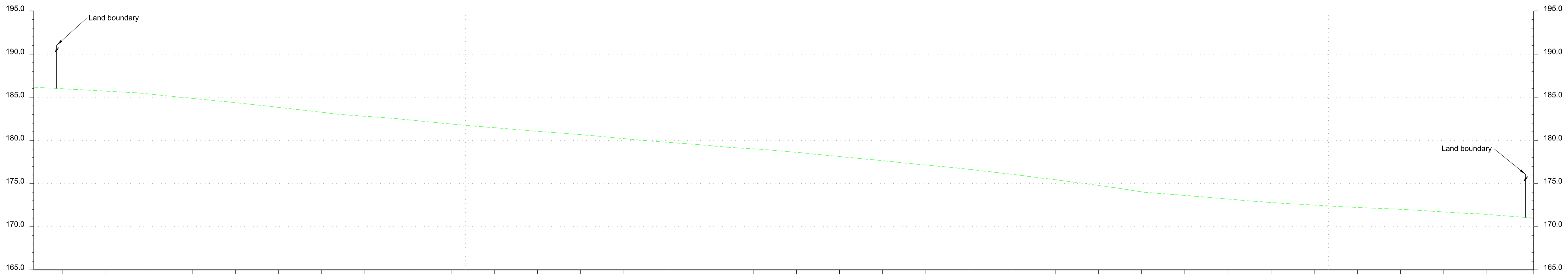

Section A-A
Scale H 1:500 V 1:250

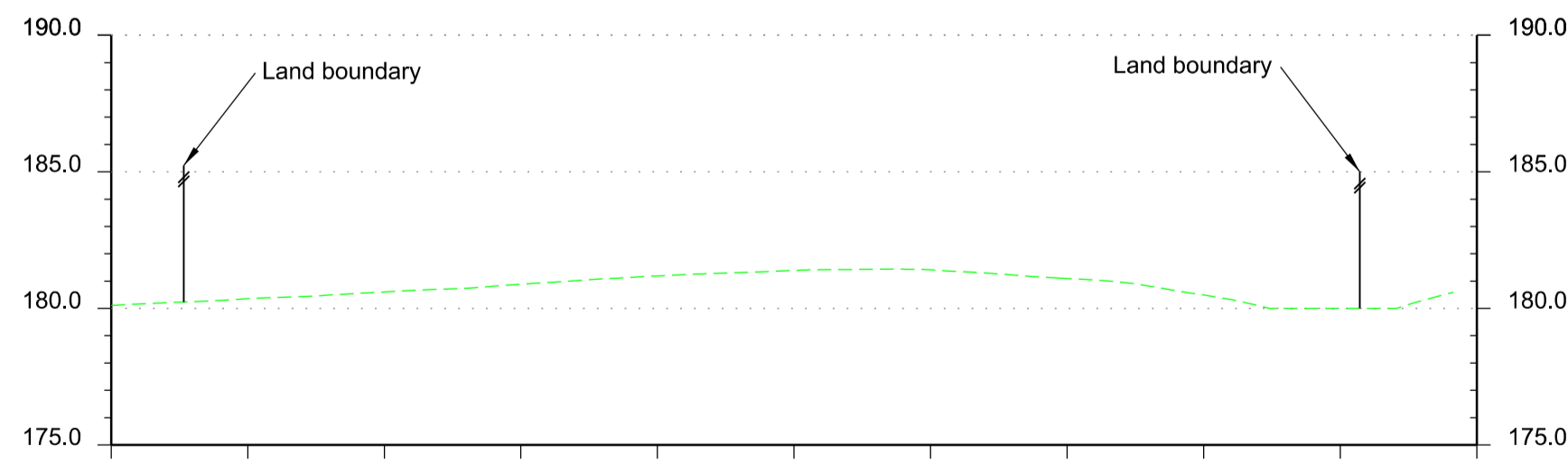

Section B-B
Scale H 1:500 V 1:250

Notes:

- For proposed general arrangement and sections location refer to drawing 40-ARI-WS-7100-CI-22-01103.

Key:

--- Existing terrain

0	19/12/22	JD	CW	CW
For Planning				

A	13/12/22	KK	JD	CW
For Review				

REV	DATE	BY	CHKD	APPD
-----	------	----	------	------



Anglo American Woodsmith Project Ltd
Resolution House | Lakes View | Scarborough | YO11 3ZB | North Yorkshire
T: +44 (0) 1753 470101 | W: uk.angloamerican.com

Drawing Title: **Woodsmith Mine
Temporary Earthwork Storage Bund
Existing Cross Sections**

SCALE @ A1: **As shown**

Job No:

253285



DRG No: **40-ARI-WS-7100-CI-10-01107**

REV **0**

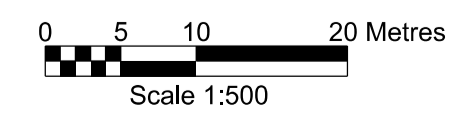

<input checked="" type="checkbox"/>	Reviewed - Approved - Work May Proceed	By: Bill Cheekin
<input type="checkbox"/>	Reviewed - Approved for Hand - Work May Proceed - Review & Resubmit	On: 20 Dec 2022 09:14
<input type="checkbox"/>	Reviewed - Work May Not Proceed - Review & Resubmit	
<input type="checkbox"/>	For Information Only	
<input type="checkbox"/>	On Hold - Pending Project Restart & Range Up	

THIS DRAWING IS CONFIDENTIAL AND THE PROPERTY OF ANGLO-AMERICAN PLC. IT MUST NOT BE COPIED WITHOUT WRITTEN CONSENT.

NYMNP
09/01/2023

Notes:
1. For proposed general arrangement and sections location refer to drawing 40-ARI-WS-7100-CI-22-01103.
Key:
— Proposed layout
--- Existing terrain

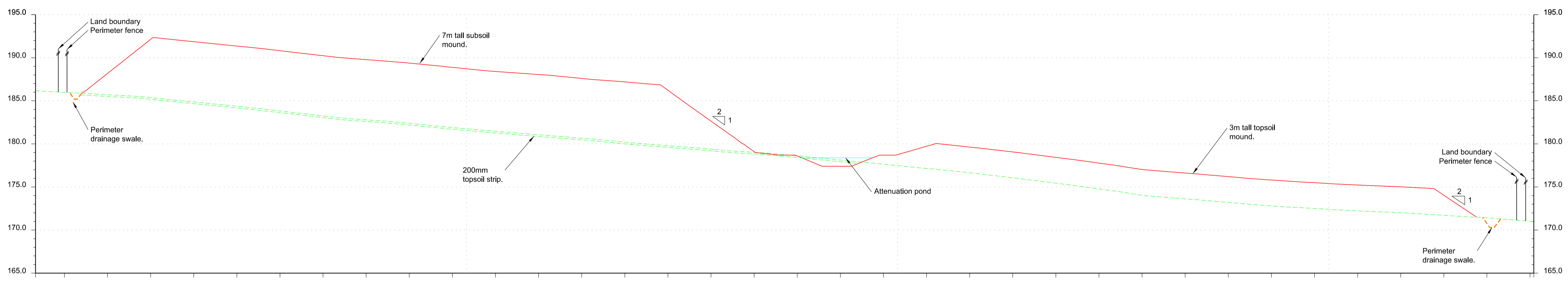

Section A-A
Scale H 1:500 V 1:250

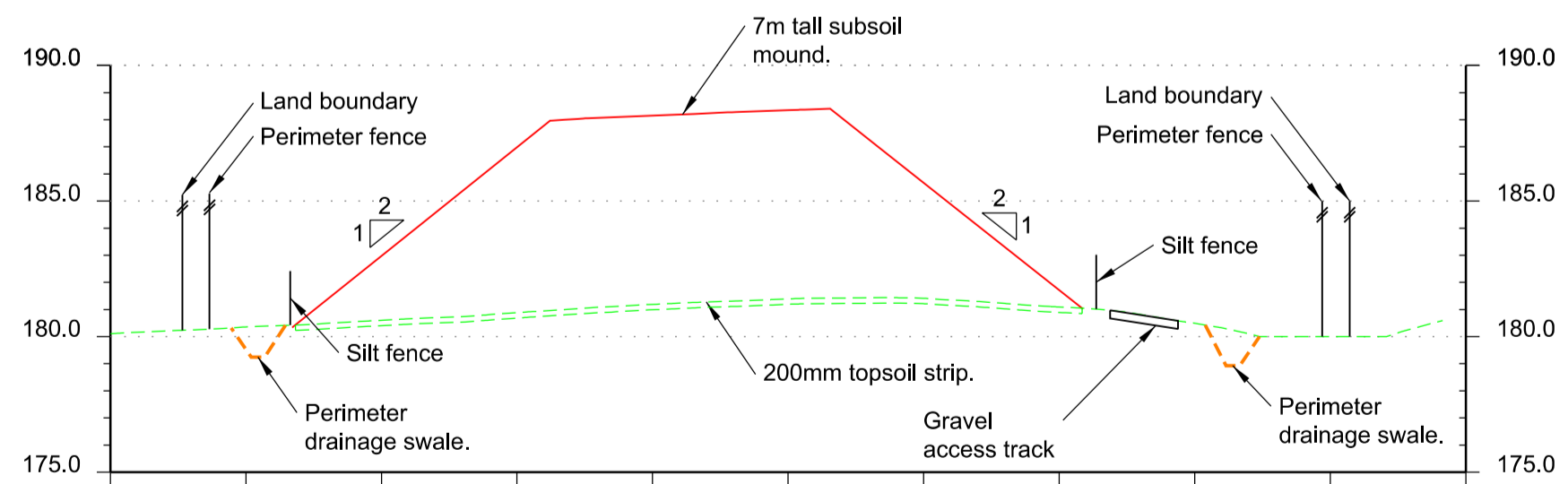

Section B-B
Scale H 1:500 V 1:250

0	07/12/22	KK	JD	CW
For planning				
A	01/11/22	EC	JD	CW
For Review				
REV	DATE	BY	CHKD	APPD



Drawing Title: **Woodsmith Mine Temporary Earthwork Storage Bund Proposed Cross Sections**

SCALE @ A1: **As shown**

Job No: **253285**

DRG No: **40-ARI-WS-7100-CI-10-01104** REV **0**

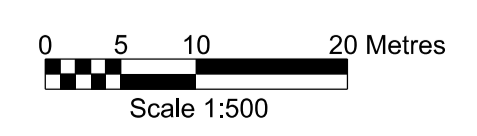

Reviewed - Approved - Work May Proceed By: **Seamus, Robert** On: **10/09/2022 11:18**
 Reviewed - Approved for Hand-Over May Proceed, Review & Resubmit
 Reviewed - Work May Not Proceed, Review & Resubmit
 For Information Only
 On Hold - Pending Project Restart & Ramp-Up
 THIS DRAWING IS CONFIDENTIAL AND THE PROPERTY OF ANGLO-AMERICAN PLC. IT MUST NOT BE COPIED WITHOUT WRITTEN CONSENT.

Global\temp\Leeds\25000000\253285\01-2_Aup - P10 Platform Redesign\0-20 CAD P10 - Platform Redesign\0-20 CAD P10 - Platform Redesign\0-20 CAD P10 - Platform Redesign - Cross sections.dgn