

**Revisions**

- A** 18.1.2023 Unit 3 moved 3.0M to the east
- B** 24.2.2023 Unit 3 repositioned

AMENDED

NYMNP  
06/03/2023

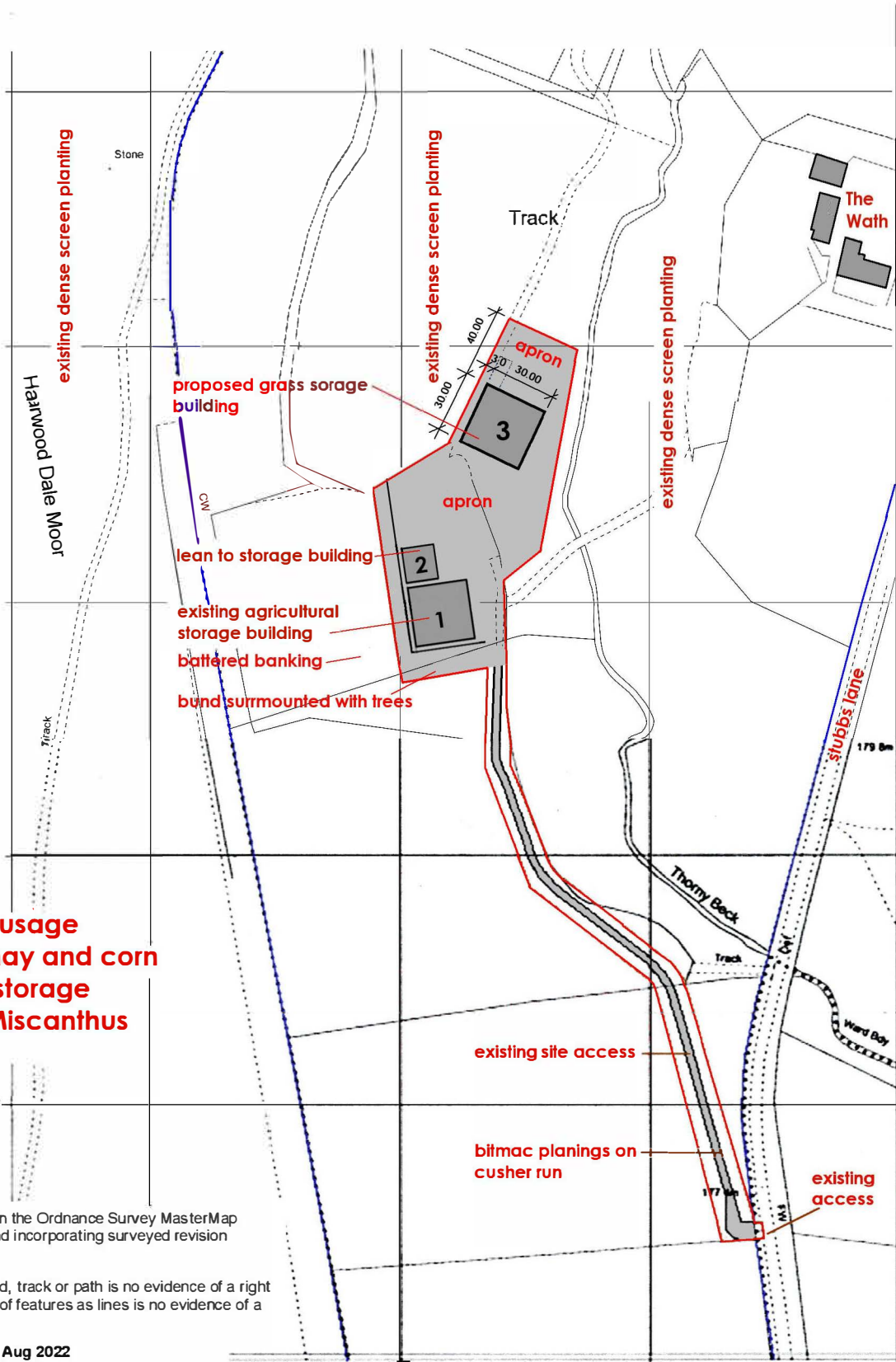
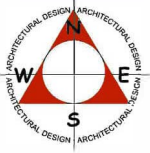

- KEY: Buildings usage**
- 1** Storage of hay and corn
  - 2** Machinery storage
  - 3** Storage of Miscanthus grass

Produced 24 Aug 2022 from the Ordnance Survey MasterMap (Topography) Database and incorporating surveyed revision available at this date.

The representation of a road, track or path is no evidence of a right of way. The representation of features as lines is no evidence of a property boundary.

Supplied by: **Stanfords 24 Aug 2022**  
 Licence: © Crown Copyright and database rights 2022 OS10003 5409  
 Order Licence Reference: OI1558311 and OI1558312  
 Centre coordinates: 497200 498650 and 497196 498411

**PROPOSED AGRICULTURAL BUILDING FOR THE STORAGE OF OF MISCANTHUS GRASS AT THORNY BECK, STUBBS LANE, STAINTONDALE FOR TEYDALE FARMING LIMITED**

Richard G Winn Old Barn Cottage, Middle Farm, Main Street, Allerston, North Yorkshire YO18 7PG tel: 01723 850300

scale : 1:2500  
 date : Aug 2022  
 dwg. no: 5013 -1B  
 email: richard@winn-design.co.uk