

NYMNP

30/03/2023

AMENDED



REV	DATE	BY	AMENDMENT	CHKD	APVD
B	22/03/23	RH	CLIENTS COMMENTS	GRH	
A	15/03/23	RH	PLANNERS COMMENTS	GRH	

G.R. HENDERSON ARCH. DESIGN
 ARCHITECTURAL DESIGN CONSULTANT
 20 CONWAY ROAD, REDCAR, CLEVELAND, TS10 2EN
 TEL: 01642 276840 FAX: 01642 276840

CLIENT:
HAZEL COVERDALE
5 THE LANE, MICKLEBY
NORTH YORKS. TS13 5LU

PROJECT:
PROPOSED TEA ROOM, AGRICULTURAL
BUILDING, ALTERATIONS & MAINTENANCE

TITLE:
LOCATION PLAN

DRAWN:
ROB HENDERSON CHECKED: APPROVED:

SCALE & SIZE:
1:1250 @ A1 DATE: **28/02/23** DRAWING STATUS:

DRAWING NO: **005** REV: **B**

NYMNPA
30/03/2023

AMENDED

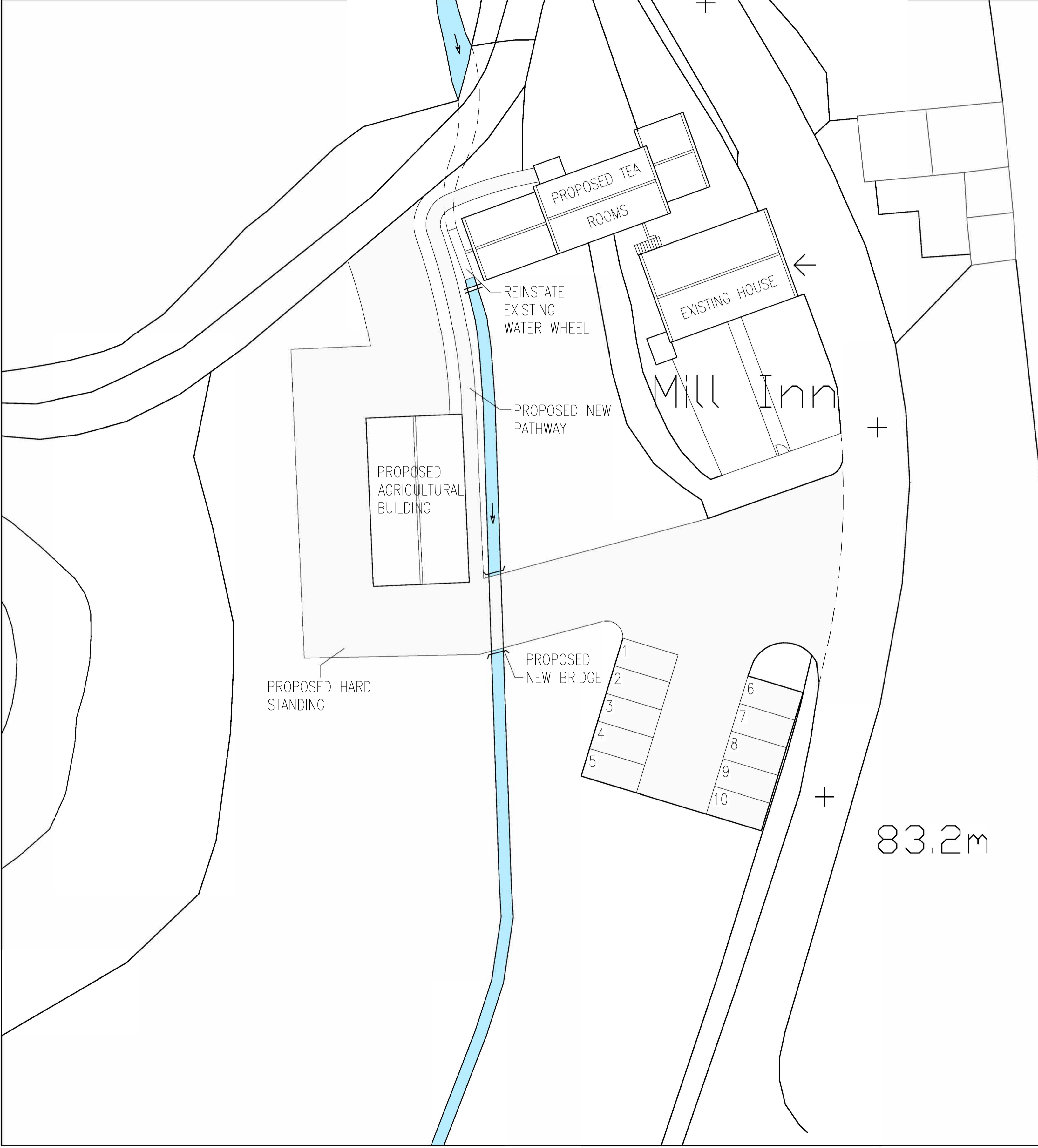

PROPOSED SITE LAYOUT

REV	DATE	BY	AMENDMENT	CHKD	APVD
B	28/03/23	RH	CLIENTS COMMENTS	GRH	
A	22/03/23	RH	CLIENTS COMMENTS	GRH	

G.R. HENDERSON ARCH. DESIGN
ARCHITECTURAL DESIGN CONSULTANT
20 CONWAY ROAD, REDCAR, CLEVELAND, TS10 2EN
TEL: 01642 276840 FAX: 01642 276840

CLIENT:
HAZEL COVERDALE
5 THE LANE, MICKLEBY
NORTH YORKS. TS13 5LU

PROJECT:
PROPOSED TEA ROOM, AGRICULTURAL BUILDING, ALTERATIONS & MAINTENANCE

TITLE:
PROPOSED SITE LAYOUT

DRAWN: ROB HENDERSON	CHECKED:	APPROVED:
SCALE: 1:200 @ A1	DATE: 28/02/23	DRAWING STATUS:
DRAWING NO: 004	REV: B	

NYMNPA

30/03/2023

AMENDED

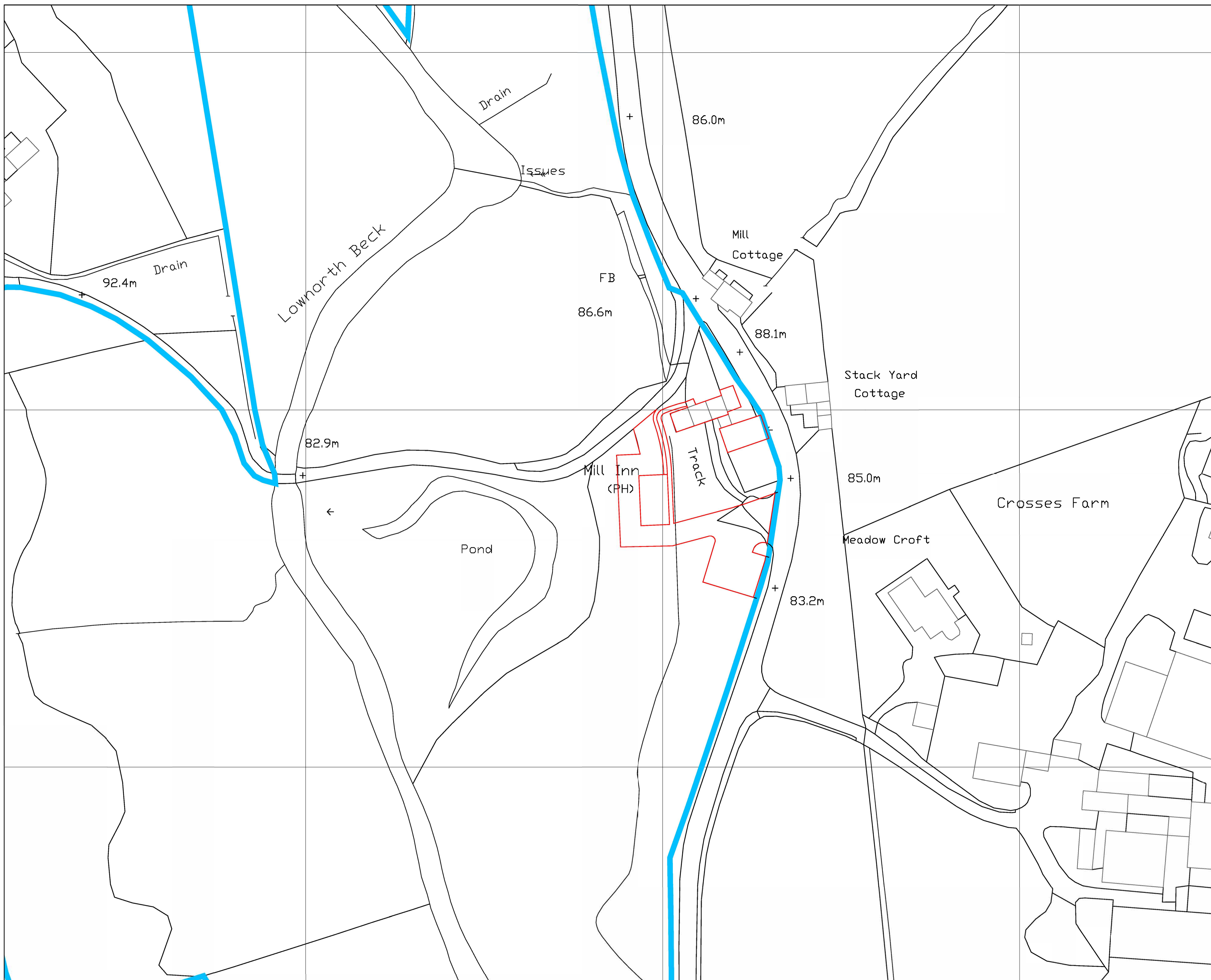

REV	DATE	BY	AMENDMENT	CHKD	APVD
B	22/03/23	RH	CLIENTS COMMENTS	GRH	
A	15/03/23	RH	PLANNERS COMMENTS	GRH	

G.R. HENDERSON ARCH. DESIGN
 ARCHITECTURAL DESIGN CONSULTANT
 20 CONWAY ROAD, REDCAR, CLEVELAND, TS10 2EN
 TEL: 01642 276840 FAX: 01642 276840

CLIENT:
HAZEL COVERDALE
5 THE LANE, MICKLEBY
NORTH YORKS. TS13 5LU

PROJECT:
PROPOSED TEA ROOM, AGRICULTURAL
BUILDING, ALTERATIONS & MAINTENANCE

TITLE:
SITE PLAN

DRAWN:
ROB HENDERSON

SCALE @ SIZE:
1:500 @ A1

DRAWING NO:
006

REV: **B**