

FOR PROPOSED DRAINAGE LAYOUT PLEASE REFER TO SRC DRAWING 14321/05

FOR PROPOSED DRAINAGE DETAILS PLEASE REFER TO SRC DRAWING 14321/06

FOR EXTERNAL WORKS LAYOUT PLEASE REFER TO SRC DRAWING 14321/08 & 09

FOR EXTERNAL WORKS DETAILS PLEASE REFER TO SRC DRAWING 14321/07

PLEASE DO NOT SCALE FROM THIS DRAWING

GENERAL NOTES:
Where other Specifications, British Standards, Codes of Practice or other documents are referred to, they shall be deemed to be incorporated with, and form part of this specification. All documents shall be the current issue at the time of tender or subsequent contract.

Access to site - The contractor shall be deemed to have visited the site and to have satisfied himself as to the nature of the existing roads and access to site and available areas for working and storage are adequate.

Approval or acceptance by the engineer shall in no way relieve the contractor of his contractual responsibilities to provide materials of the required quality and carry out the works to an acceptable standard of workmanship as set out in this specification.

FOUNDATIONS:
For all foundation notes & details, please refer to latest revision of SRC drawing 14321/30.

FLOOR SLAB CONSTRUCTION:
For all floor slab notes & details, please refer to latest revision of SRC drawing 14321/31.

STRUCTURAL STEELWORK:
For all steelwork notes & details, please refer to latest revisions of SRC drawings 14321/20 to 26 inclusive.

UNDER THE CONSTRUCTION DESIGN AND MANAGEMENT REGULATIONS 1994:
Site to be protected to prevent public access to work. Health and Safety Executive to be notified of project by the planning supervisor.
Health and Safety Executive to be notified of any works involving demolition by the planning supervisor.
Work adjacent/in highway. Care to be taken for safety of pedestrians and operatives. Use traffic management i.e. barriers, signs, lights etc. Operatives to wear high visibility clothing.
Take precautions to prevent contact with any overhead cables. Contractor to provide for safe lifting and manoeuvring of timber trusses.
Contractor to ensure appropriate manpower/machinery available for lifting heavy or awkward materials.
Consideration should be given to using high strength lightweight trench blocks with hand hoists where possible.
All sharp ends of reinforcing bars/mesh to be protected, e.g. by use of plastic caps.
Safe access to roof plant and maintenance of i.e. windows, cleaning/painting.
Provide safe access ladder with safety hoops and fall arrest system.
Fall arrest system to be fitted to roof for maintenance purposes if any plant or equipment is located on the roof. Provision to be made for maintenance and cleaning windows - hook points (if used) to be maintained and tested periodically. Due care and attention to be taken with regard to the public if footpaths/public areas/roads are closed off and/or motorised equipment used for maintenance and cleaning purposes. Consider times for this purpose to suit public/opening times, traffic etc.
Consideration to be given to access for maintenance of ceiling mounted fittings, i.e. drop down fittings.
Permanent roof edge protection to be considered if maintenance access is required for plant or machinery. Windows to be hinged to enable cleaning to be undertaken internally.
Contractor to take account of COSHH Regulations in respect to materials and safe methods, contaminated water and associated diseases.
Contractor to take account of making excessive noise, particularly during unsocial hours.
Contractor to prepare a method for working in the confined site area.

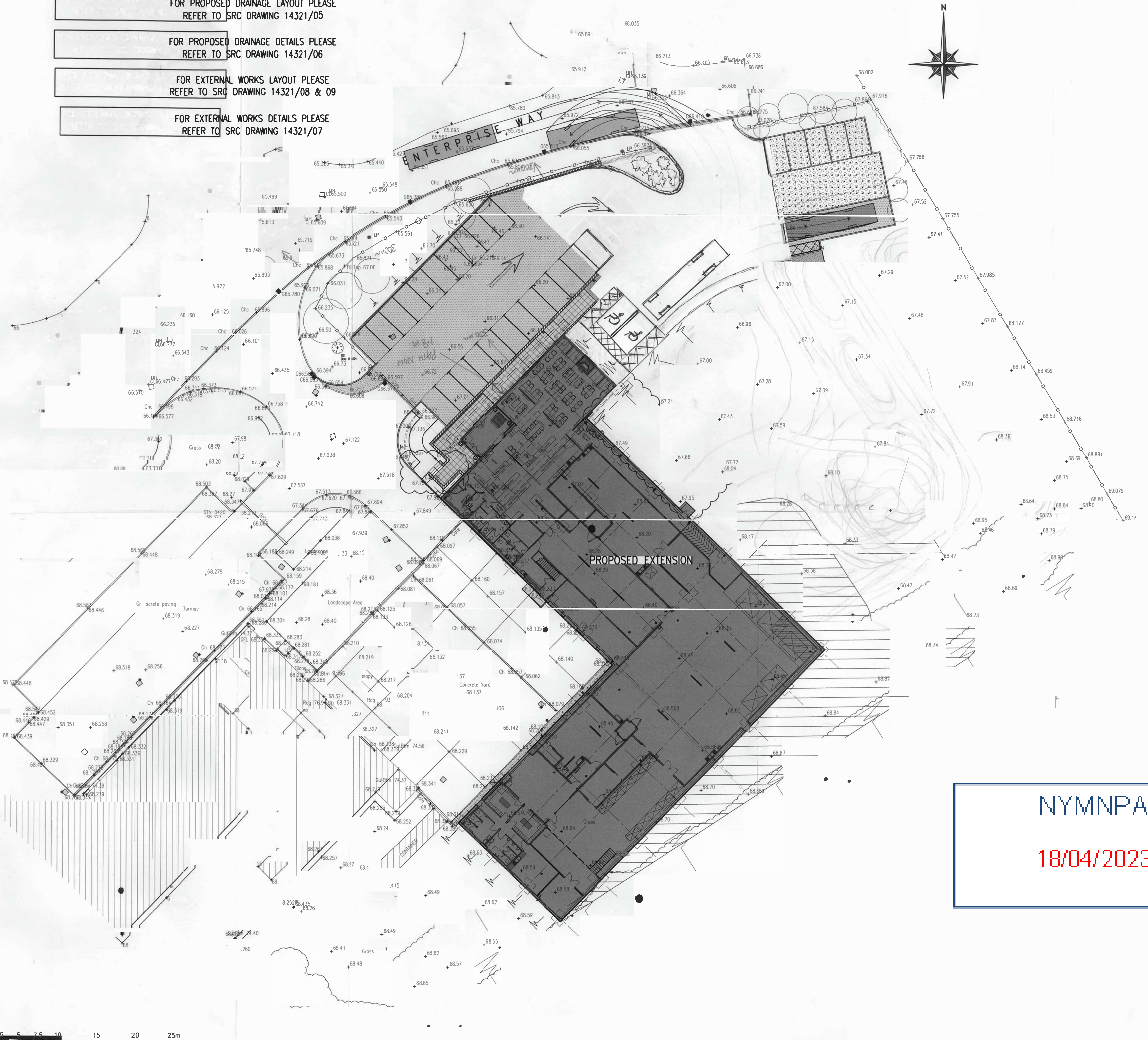

NYMNPA
18/04/2023

Rev	Date	Remarks
F	28.06.22	Drawing Updated Where Clouded.
D	14.12.21	Further Notes Added
E	30.09.21	Drawing Issued For 'BUILDING REGULATION'
C	28.06.21	Drawing Generally Updated.
B	22.04.21	External Works Arrangement Generally Updated.
A	13.04.21	Car Park Arrangement Amended.

Status **BUILDING REGULATION**

SRC CONSULTING STRUCTURAL AND CIVIL ENGINEERS
 SIDEBOTTOM RICHARDSON CHENG LTD
 15 High Street, Spalding, Lincoln PE11 1TW
 Tel: 01779 712660 Fax: 01775 712635 Email: src@srcltd.com

Project **Proposed Development at Bothams Bakery, Enterprise Way, Whitby, YO22 4NH**

Title **Proposed Site Layout CAR PARK REVISION MARCH 23**

Date	Scale	Checked	File Name
March 21	1:250	JAR	14321-03
Drawn			
Design			

DRG No. 14321/Q3