

Rev	Date	Description	Drawn	Check	Approve
A	28/09/2023	AMENDMENT TO RED & BLUE LINES	JG	JL	RC

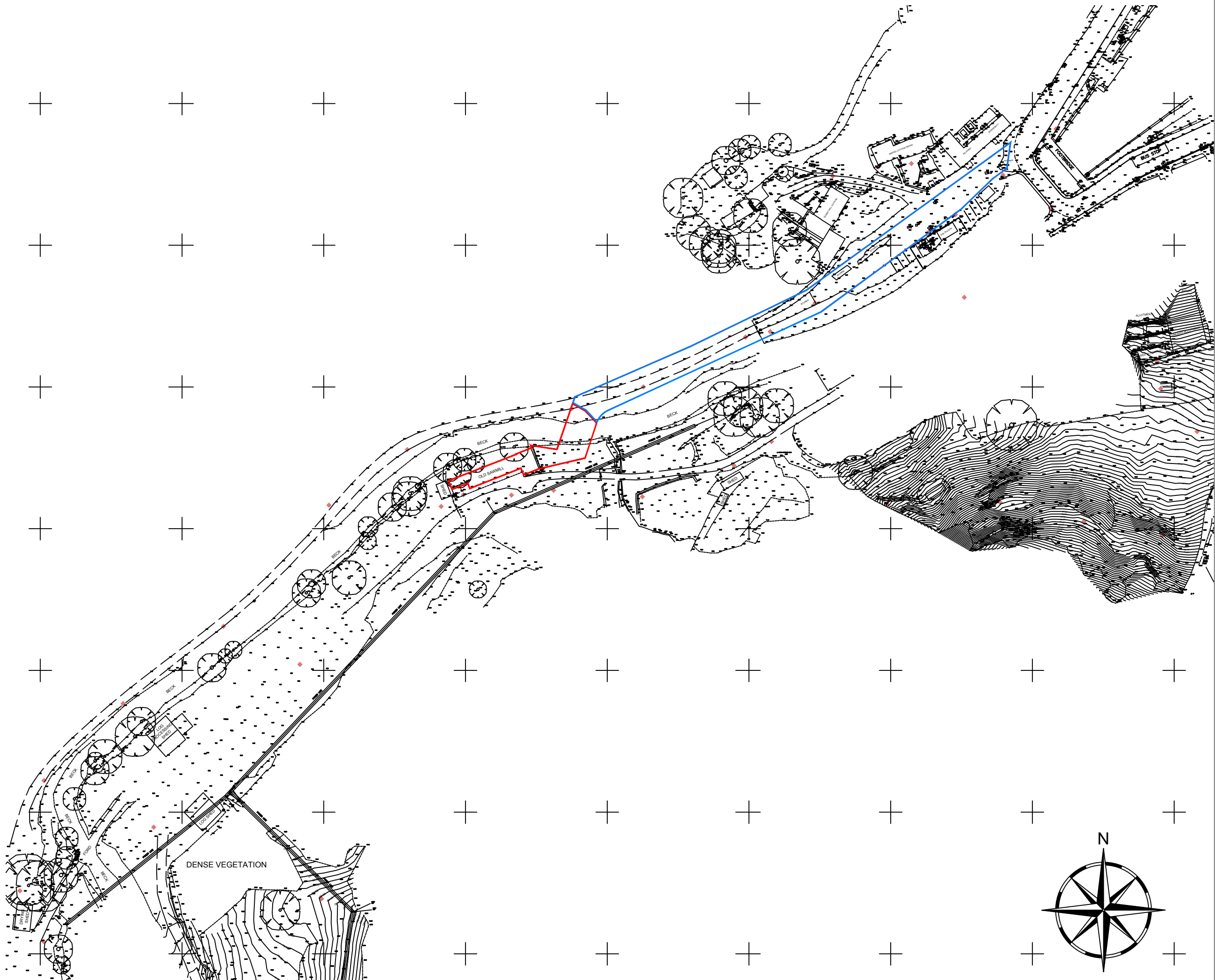

SCOPE OF WORKS
 PROPOSAL TO CONVERT THE OLD SAWMILL INTO THREE SMALL SELF CONTAINED RETAIL UNITS IN SANDSEND, EAST YORKSHIRE

THE PROJECT WILL AIM TO COMPLIMENT THE LOCAL PROPERTIES AND ENHANCE THE AREA & USE SUSTAINABLE MATERIALS AND ECO PRODUCTS WHERE AVAILABLE.

NO ADDITIONAL FENESTRATION TO BE INSTALLED

UNIT MATERIAL SCHEDULE

EXTERIOR WALLS: TO BE RE-POINTED AND REPAIRED WHERE REQUIRED

INTERIOR WALLS: INDEPENDENT INSULATED WALLS TO BE CONSTRUCTED TO PROTECT THE ORIGINAL BUILDING FABRIC. NEW DIVIDING WALLS TO BE TIMBER/METAL FRAME WITH PLASTER SKIM. MINIMAL MASONRY FIXINGS INTO THE ORIGINAL STRUCTURE

ROOF: TRADITIONAL SLATE ROOF

RAINWATER GOODS: CAST IRON PAINTED IN A COLOUR/SHADE TO COMPLIMENT/MATCH THE EXISTING BUILDING MASONRY TO ACHIEVE LESS VISUAL IMPACT

DOORS & WINDOWS: TIMBER WITH MINIMAL MASONRY FIXINGS/FRICTION FIT INTO THE ORIGINAL STRUCTURE.

FLOOR: INDEPENDENT 'FLOATING' FLOOR TO ALLOW SERVICES BELOW. THE EXISTING FLOOR WILL REMAIN IN SITU

NOTE 1: EXISTING SITE LEVELS TO REMAIN UNCHANGED
 NOTE 2: STRUCTURAL CALCULATIONS & FOUNDATION DESIGN BY OTHERS
 NOTE 3: BUILDING REGULATIONS & CONSTRUCTION DETAILS BY OTHERS
 NOTE 4: SITE AREA = 0.194 ha (0.478 Acre)
 NOTE 5: FFL = +6.0M

BS 1192: Part 3 - CONSTRUCTION DRAWING PRACTICE
 THESE DRAWINGS ARE INTENDED FOR PLANNING PURPOSES ONLY.

NYMNP
 29/09/2023

AMENDED

dream-haus

dream-haus limited
 103 yew drive-brandon
 suffolk-england-IP27 0AB
 +44 (0) 1942 845 828
 enquiries@dream-haus.com
 www.dream-haus.com

Client **MULGRAVE ESTATE**

Project **OLD SAWMILL
 SANDSEND, WHITBY**

Drawing **3No NEW RETAIL UNITS
 LOCATION PLAN**

Drawing Number **02-2023-3001**

Scale **1:1250** Sheet **1 OF 1** Rev **A**

©DREAM HAUS LIMITED 2023 (Company Reg. Number 07870039)
 DRAWING PROPERTY OF DREAM HAUS LIMITED
 ALL DIMENSIONS IN MILLIMETERS UNLESS STATED OTHERWISE.

Drawn **JG**

LOCATION PLAN (Scale 1:1250)

Rev	Date	Description	Drawn	Check	Approve
A	28/09/2023	AMENDMENT TO RED & BLUE LINES	JG	JL	RC

SCOPE OF WORKS
 PROPOSAL TO CONVERT THE OLD SAWMILL INTO THREE SMALL SELF CONTAINED RETAIL UNITS IN SANDSEND, EAST YORKSHIRE

THE PROJECT WILL AIM TO COMPLIMENT THE LOCAL PROPERTIES AND ENHANCE THE AREA & USE SUSTAINABLE MATERIALS AND ECO PRODUCTS WHERE AVAILABLE.

NO ADDITIONAL FENESTRATION TO BE INSTALLED

UNIT MATERIAL SCHEDULE

EXTERIOR WALLS: TO BE RE-POINTED AND REPAIRED WHERE REQUIRED

INTERIOR WALLS: INDEPENDENT INSULATED WALLS TO BE CONSTRUCTED TO PROTECT THE ORIGINAL BUILDING FABRIC. NEW DIVIDING WALLS TO BE TIMBER/METAL FRAME WITH PLASTER SKIM. MINIMAL MASONRY FIXINGS INTO THE ORIGINAL STRUCTURE

ROOF: TRADITIONAL SLATE ROOF

RAINWATER GOODS: CAST IRON PAINTED IN A COLOUR/SHADE TO COMPLIMENT/MATCH THE EXISTING BUILDING MASONRY TO ACHIEVE LESS VISUAL IMPACT

DOORS & WINDOWS: TIMBER WITH MINIMAL MASONRY FIXINGS/FRICTION FIT INTO THE ORIGINAL STRUCTURE.

FLOOR: INDEPENDENT 'FLOATING' FLOOR TO ALLOW SERVICES BELOW. THE EXISTING FLOOR WILL REMAIN IN SITU

NOTE 1: EXISTING SITE LEVELS TO REMAIN UNCHANGED
 NOTE 2: STRUCTURAL CALCULATIONS & FOUNDATION DESIGN BY OTHERS
 NOTE 3: BUILDING REGULATIONS & CONSTRUCTION DETAILS BY OTHERS
 NOTE 4: SITE AREA = 0.194 ha (0.478 Acre)
 NOTE 5: FFL = +6.0M

BS 1192: Part 3 - CONSTRUCTION DRAWING PRACTICE

THESE DRAWINGS ARE INTENDED FOR PLANNING PURPOSES ONLY.

NYMNP
 29/09/2023

AMENDED

dream-haus 

dream-haus limited
 103 yew drive-brandon
 suffolk-england-IP27 0AB
 +44 (0) 1942 845 828
 enquiries@dream-haus.com
 www.dream-haus.com

Client **MULGRAVE ESTATE**

Project **OLD SAWMILL SANDSEND, WHITBY**

Drawing **3No NEW RETAIL UNITS REDLINE PLAN**

Drawing Number **02-2023-3005**

Scale	NTS	Sheet	1 OF 1	Rev	A
-------	-----	-------	--------	-----	---

<small>©DREAM HAUS LIMITED 2023 (Company Reg. Number 07870039) DRAWING PROPERTY OF DREAM HAUS LIMITED ALL DIMENSIONS IN MILLIMETERS UNLESS STATED OTHERWISE.</small>	Drawn	JG
--	-------	----

