

From:
Sent: Saturday, November 18, 2023 4:55 PM
To: Planning <
Cc: Woody Clark
Subject: Re: NYM/2023/0664, High Farm, Stonegate, Whitby - Existing Access
Importance: High

Dear Lucy

Thank you for your letter dated 17 November 2023, ref: NYM/2023/0664 and for your support of the proposed works. Further to the information requested from the Local Highways, I can confirm that we will continue to use the existing access as shown in blue dotted lines on the attached plan.

I hope this provides the information you require but please let me know if you require any further details.

Kind regards
Peter

Peter Clark



NYMNP
20/11/2023

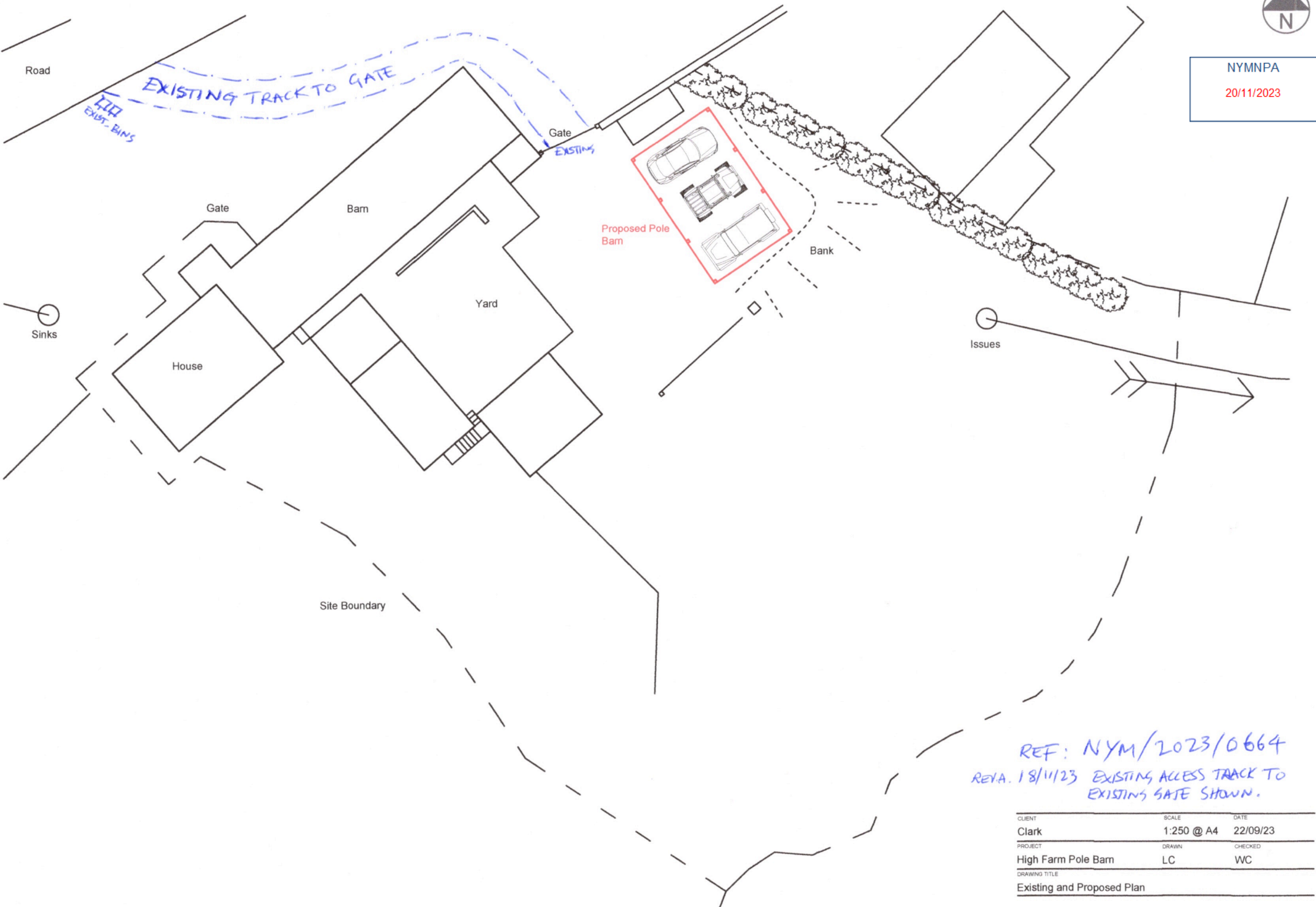

REF: NYM/2023/0664
REV. 18/11/23 EXISTING ACCESS TRACK TO EXISTING GATE SHOWN.

CLIENT	SCALE	DATE
Clark	1:250 @ A4	22/09/23
PROJECT	DRAWN	CHECKED
High Farm Pole Barn	LC	WC
DRAWING TITLE		
Existing and Proposed Plan		