

NYMNP

20/02/2024



Client:

Mr Kieran Robinson

Project:

Ladycross Plantation Holiday Park
Egton

Project No:

T22505

Report Title:

Construction Traffic Management Scheme

Prepared by:

JP

Authorised by:

GM

Rev:

Date:

16/02/2024

Hub Transport Planning Ltd

Floor 1B

4 Temple Row

Birmingham

B2 5HG

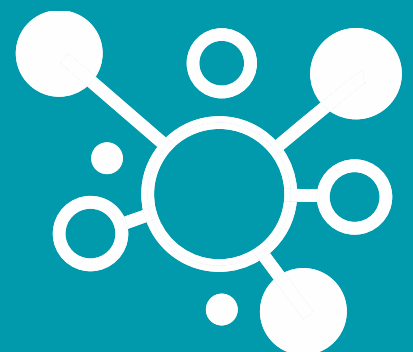

TABLE OF CONTENTS

1.0	INTRODUCTION	1
2.0	CONSTRUCTION TRAFFIC MANAGEMENT	2

DRAWINGS

T22505.005	Proposed One-Way Construction Access Route
T22505.006	Proposed Construction Temporary Signage 01
T22505.007	Proposed Construction Temporary Signage 02
T22505.008	Proposed Construction Arrangements Swept Path Analysis

APPENDICES

Appendix A	Site Location Plan
-------------------	---------------------------

1.0 Introduction

Background

- 1.1 Hub Transport Planning Ltd has been commissioned by Mr Keiran Robinson to provide transport advice for a proposed Holiday Lodge development at Ladycross Plantation Holiday Park, Egton.
- 1.2 The site received planning approval for a restructured layout of 41 previously consented Holiday Lodges together with an increase of 7 units under planning application ref. NTM/2022/0568.
- 1.3 The site location plan is shown **Appendix A** and details the area of the site being restructured, along with the route to the south.
- 1.4 This report provides a Construction Traffic Management Scheme in response to a condition of the application, which states the following:

“16. No development must commence until a Construction Management Plan has been submitted to and approved in writing by the Local Planning Authority. Construction of the permitted development must be undertaken in accordance with the approved plan.

The Plan must include, but not be limited, to arrangements for the following in respect of each phase of the works:

Restriction on the use of the proposed southern access for construction purposes:

Vehicles entering and exiting the site should be controlled to avoid meeting each other between the public highway and the open field to avoid head to head situations where one vehicle will have to reverse to allow the other one through.”

- 1.5 A Construction Management Plan has been prepared by Lambe Planning & Design Ltd, and this report should be read in conjunction with that plan.

Limitations of the Report

- 1.6 This report has been undertaken at the request of Mr Keiran Robinson, thus should not be entrusted to any third party without written permission from Hub Transport Planning Ltd. However, should any information contained within this report be used by any unauthorised third party, it is done so entirely at their own risk and shall not be the responsibility of Hub Transport Planning Ltd.
- 1.7 Where appropriate, this report has been compiled using data from a number of external sources; these sources are considered to be trustworthy and therefore the data provided is considered to be accurate and relevant at the time of preparing this report.

2.0 Construction Traffic Management

Construction Traffic Access & Egress

- 2.1 The main vehicular access to the park will be utilised for the construction traffic access; however, there will be a one-way system in place within the park, to ensure that all construction traffic utilises the consented road to the south to leave site.
- 2.2 Temporary internal signage will be in place to ensure that only construction traffic accesses the area of the site being restructured, whilst temporary advanced warning signage will also be in place on the main road to ensure that other drivers are aware that both the holiday park entrance and the consented road to the south will be used by construction traffic.
- 2.3 All signage will be provided in accordance with the Traffic Signs Manual and Traffic Signs & General Directions (2016); the proposed one-way route is shown on drawing **T22505.005**, whilst the temporary signage arrangements are shown on drawings **T22505.006 and 007**.

Swept Path Analysis

- 2.4 Swept path analysis is provided on drawing **T22505.008** to demonstrate that the largest construction vehicle expected to require access to the site during the construction phase, a large tipper HGV, can access the site at the existing holiday park entrance.
- 2.5 The drawing also demonstrates that the construction traffic will utilise the existing track along the western and southern boundaries of the site, before connecting to the consented road to the south and onto the main road to the east.
- 2.6 The drawing also shows the proposed location of the wheel wash facility, which is located 100m from the main road and will ensure that all vehicles/wheels are thoroughly cleaned prior to leaving the site, in order to minimise the amount of debris/mud that reaches the adopted highway.
- 2.7 Notwithstanding this facility, the roads will also be regularly cleaned at the access and egress locations.
- 2.8 Access to and egress from the site, will be undertaken using banksmen, to ensure safe and controlled large vehicle movements at all times.

Construction Traffic Generation

- 2.9 The volume of construction traffic, and particularly large HGVs, will be minimal; at most, it would be expected that there would only be an occasional (perhaps weekly) HGV trip to/from the site; with the vast majority of construction vehicles comprising smaller vans and cars (for tradesmen).

Ongoing Review

- 2.10 The Construction Traffic Management Plan will be routinely reviewed and updated to ensure that any ongoing requirements are being met.
- 2.11 A successful monitoring programme will safeguard safe access and egress, alongside safe operation of the existing holiday park, ensuring that appropriate measures can be put into place in a timely manner if necessary.

T22505

Ladycross Plantation Holiday Park, Egton



THIS PAGE IS LEFT INTENTIONALLY BLANK

T22505
Ladycross Plantation Holiday Park, Egton



Drawings



1. THIS DRAWING IS NOT TO BE SCALED FOR CONSTRUCTION PURPOSES.
2. THE CONTRACTOR SHALL CHECK ALL DIMENSIONS AND LEVELS ON SITE.

REV	DESCRIPTION	DATE	BY	AUTH

 TRANSPORT PLANNING LTD	Hub Transport Planning Ltd Floor 1B 4 Temple Row Birmingham B2 5HG T : 0121 454 5530
-----------------------------------------------------------------------------------------------------------------	-----------------------------------------------------------------------------------------------------

CLIENT
MR KIERAN ROBINSON

PROJECT
**LADYCROSS PLANTATION HOLIDAY PARK
 EGTON**

TITLE
**PROPOSED ONE-WAY
 CONSTRUCTION ACCESS ROUTE**

DRAWN	AUTHORISED	SCALE	SHEET SIZE	DATE
JP	GM	1:1250	A2	16.02.24

PROJECT NO.	DRAWING NO.	REV
T22505	005	-

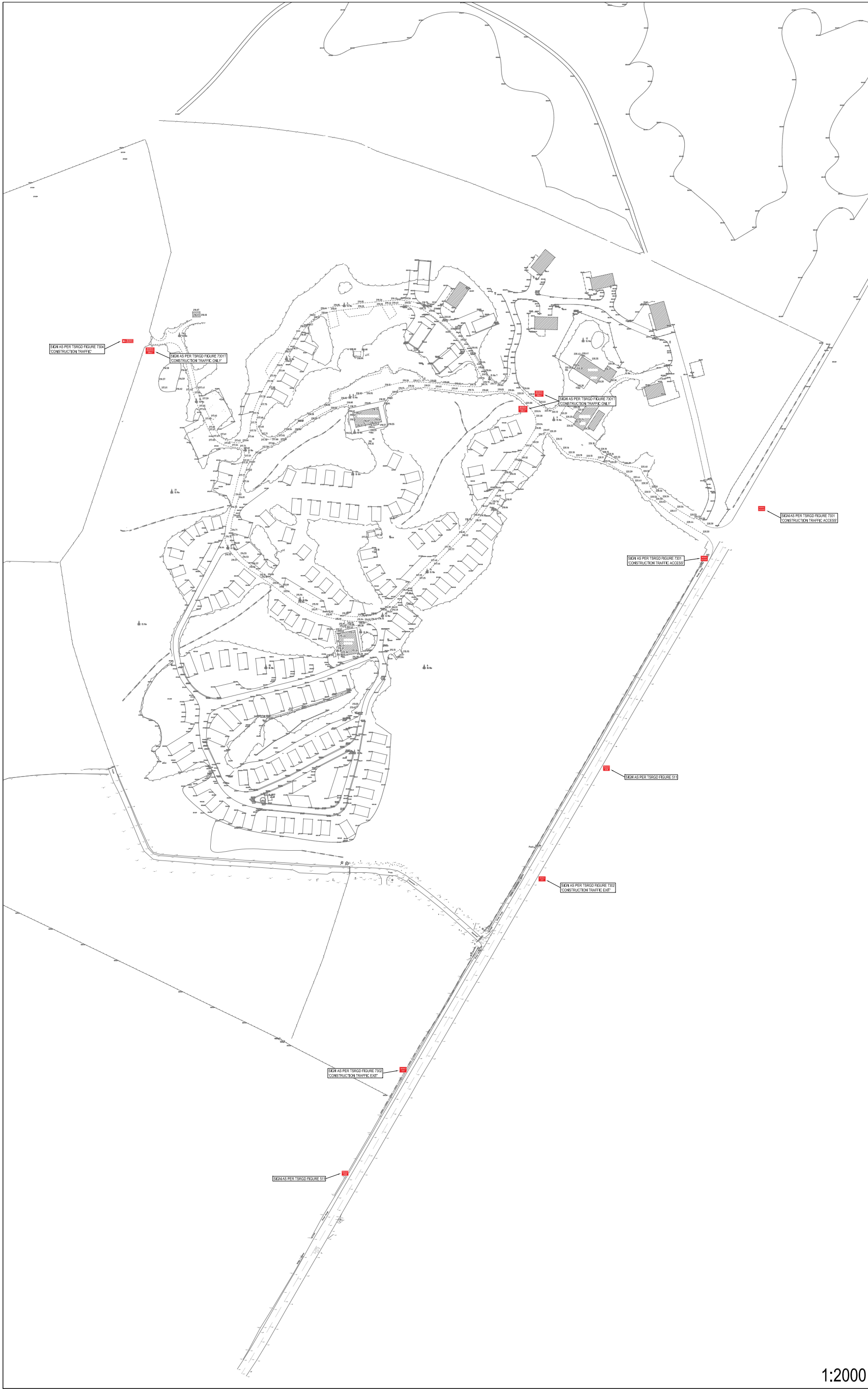

1:2000

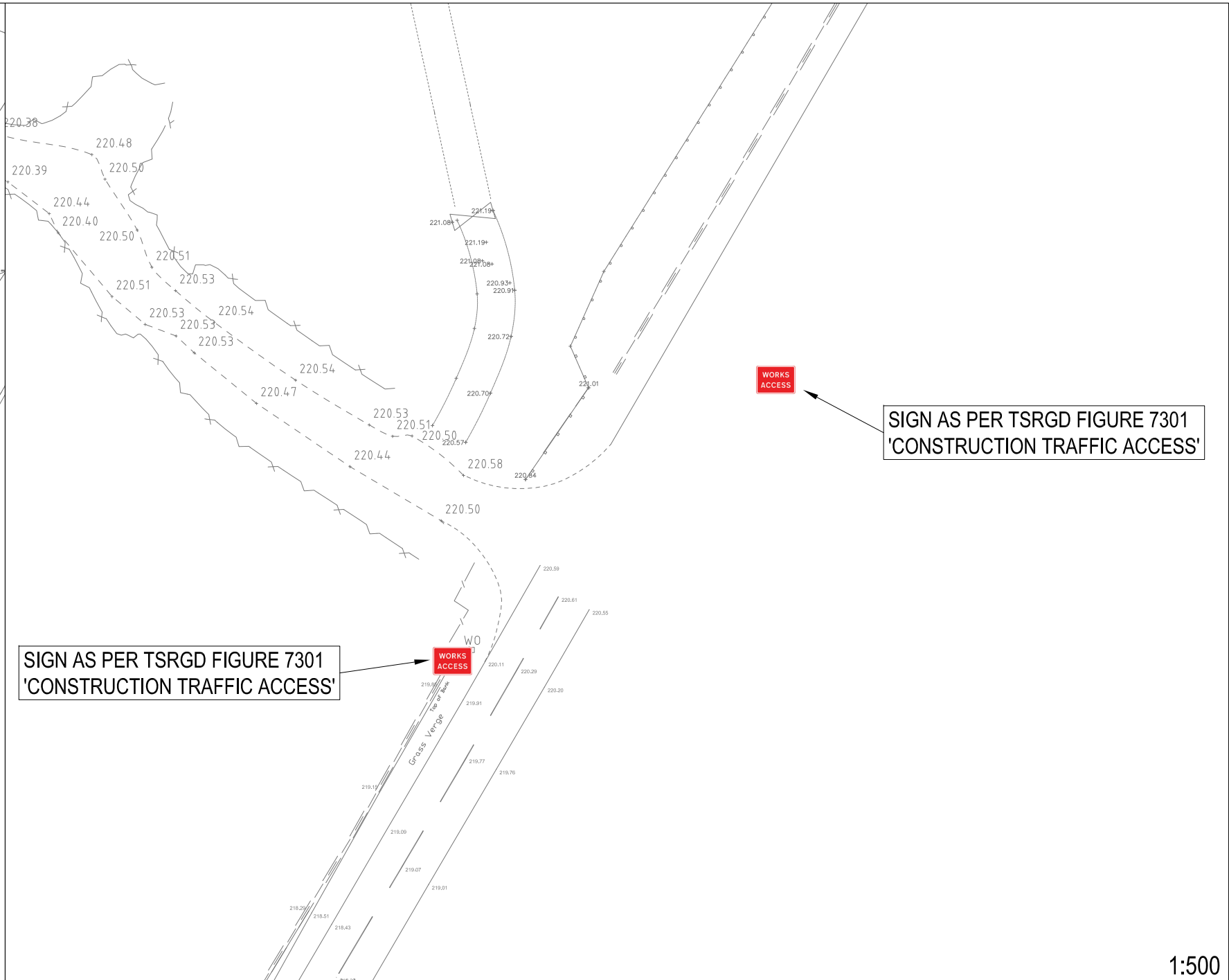

1:500

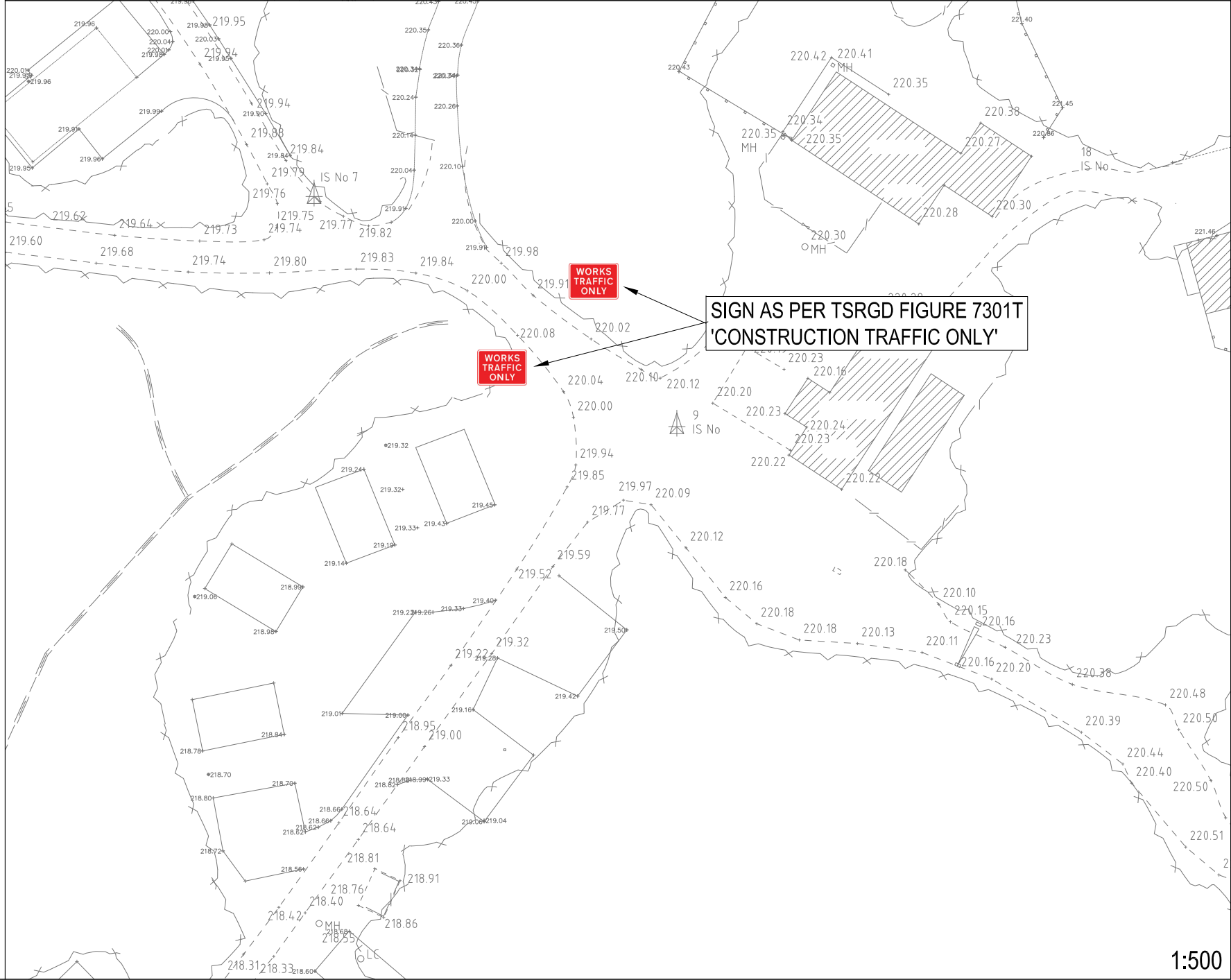

1:500

1. THIS DRAWING IS NOT TO BE SCALED FOR CONSTRUCTION PURPOSES.
2. THE CONTRACTOR SHALL CHECK ALL DIMENSIONS AND LEVELS ON SITE.

REV	DESCRIPTION	DATE	BY	AUTH
-----	-------------	------	----	------



Hub Transport Planning Ltd
 Floor 1B
 4 Temple Row
 Birmingham
 B2 5HG
 T : 0121 454 5530

CLIENT
MR KIERAN ROBINSON

PROJECT
**LADYCROSS PLANTATION HOLIDAY PARK
 EGTON**

TITLE
**PROPOSED CONSTRUCTION
 TEMPORARY SIGNAGE 01**

DRAWN	AUTHORISED	SCALE	SHEET SIZE	DATE
JP	GM	AS SHOWN	A2	16.02.24

PROJECT NO.	DRAWING NO.	REV
T22505	006	-

1. THIS DRAWING IS NOT TO BE SCALED FOR CONSTRUCTION PURPOSES.
2. THE CONTRACTOR SHALL CHECK ALL DIMENSIONS AND LEVELS ON SITE.

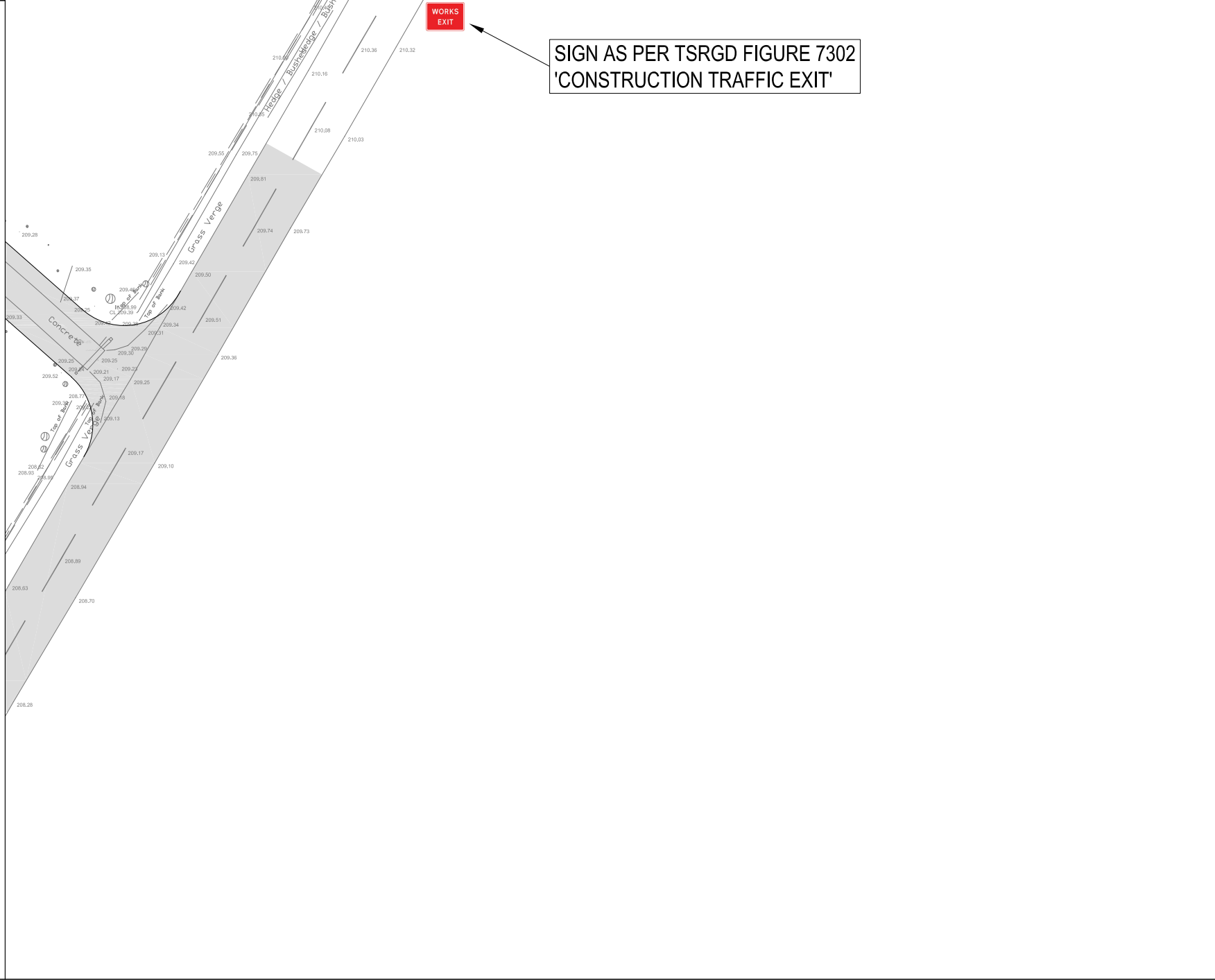
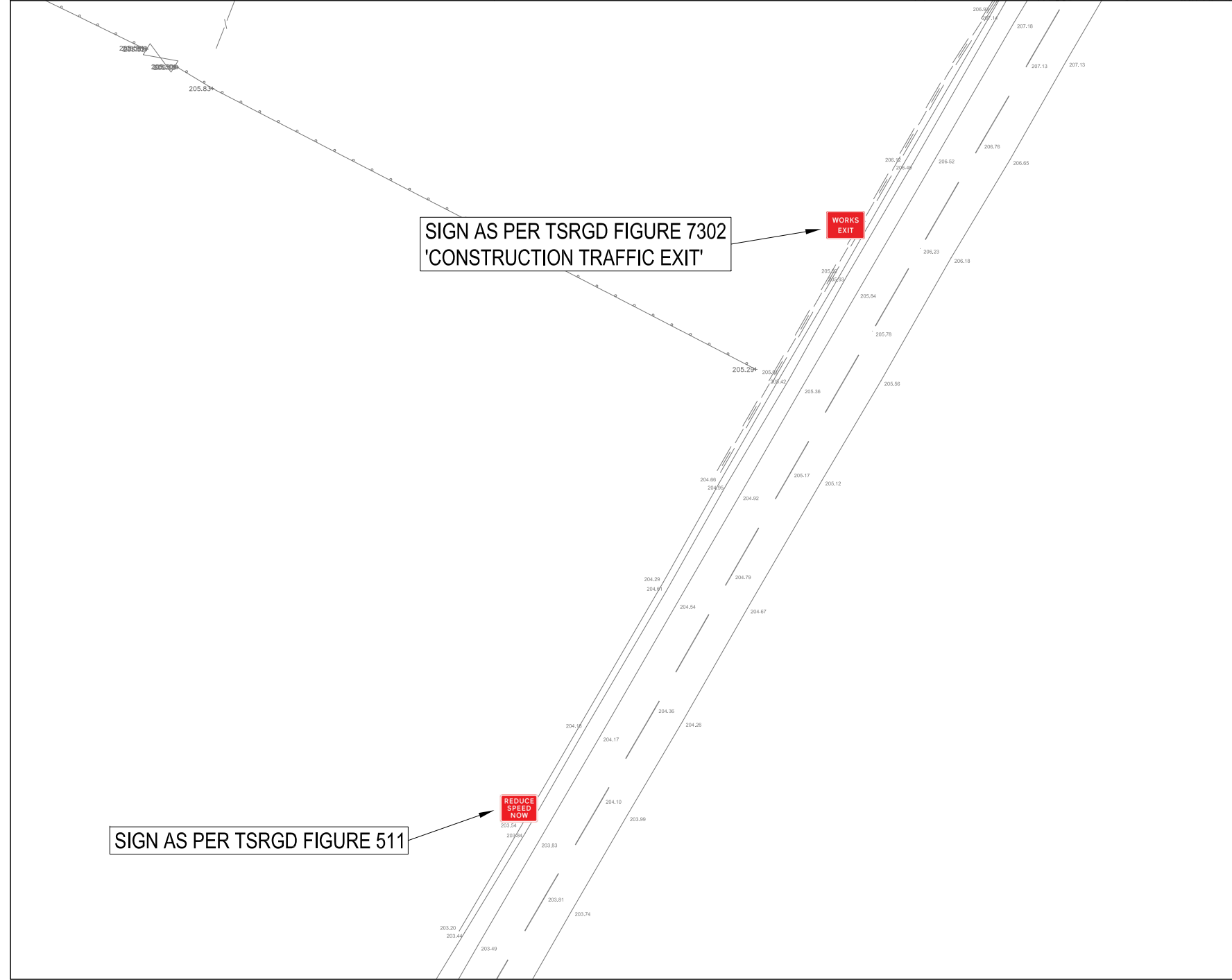
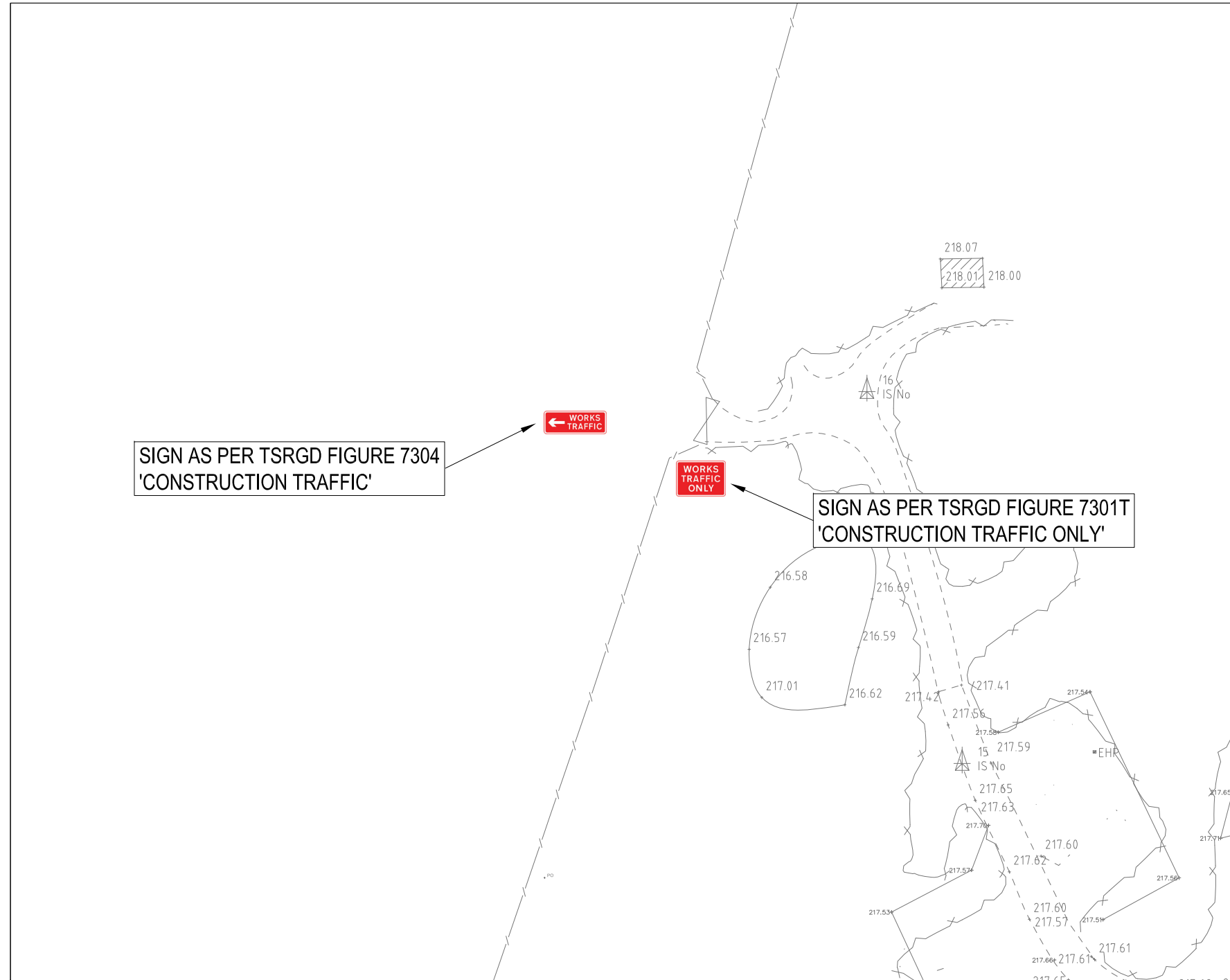

REV	DESCRIPTION	DATE	BY	AUTH
-----	-------------	------	----	------



Hub Transport Planning Ltd
 Floor 1B
 4 Temple Row
 Birmingham
 B2 5HG
 T : 0121 454 5530

CLIENT
MR KIERAN ROBINSON

PROJECT
**LADYCROSS PLANTATION HOLIDAY PARK
 EGTON**

TITLE
**PROPOSED CONSTRUCTION
 TEMPORARY SIGNAGE 02**

DRAWN JP	AUTHORISED GM	SCALE 1:500	SHEET SIZE A2	DATE 16.02.24
PROJECT NO. T22505			DRAWING NO. 007	REV -



1:2000

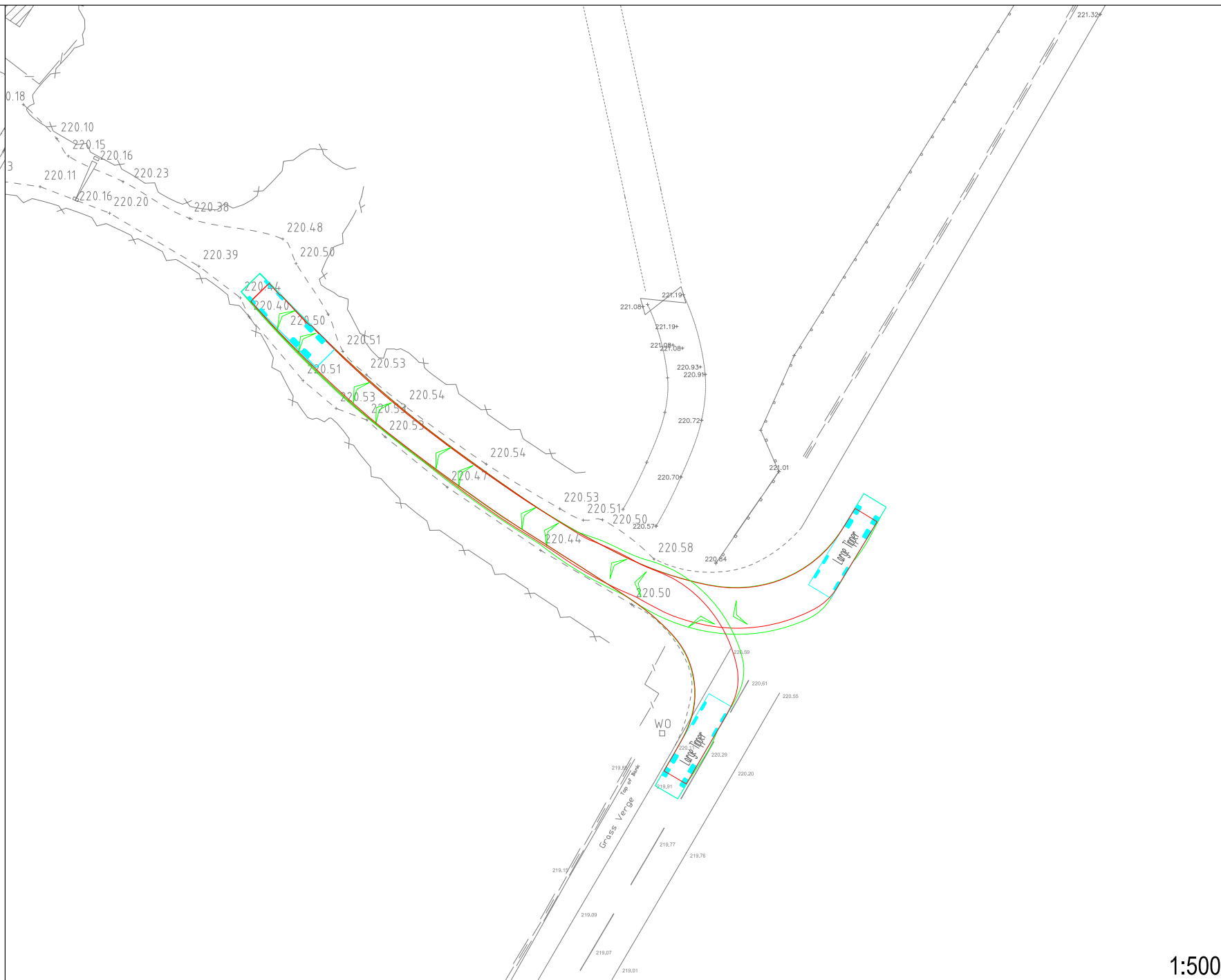

1:500



1:500

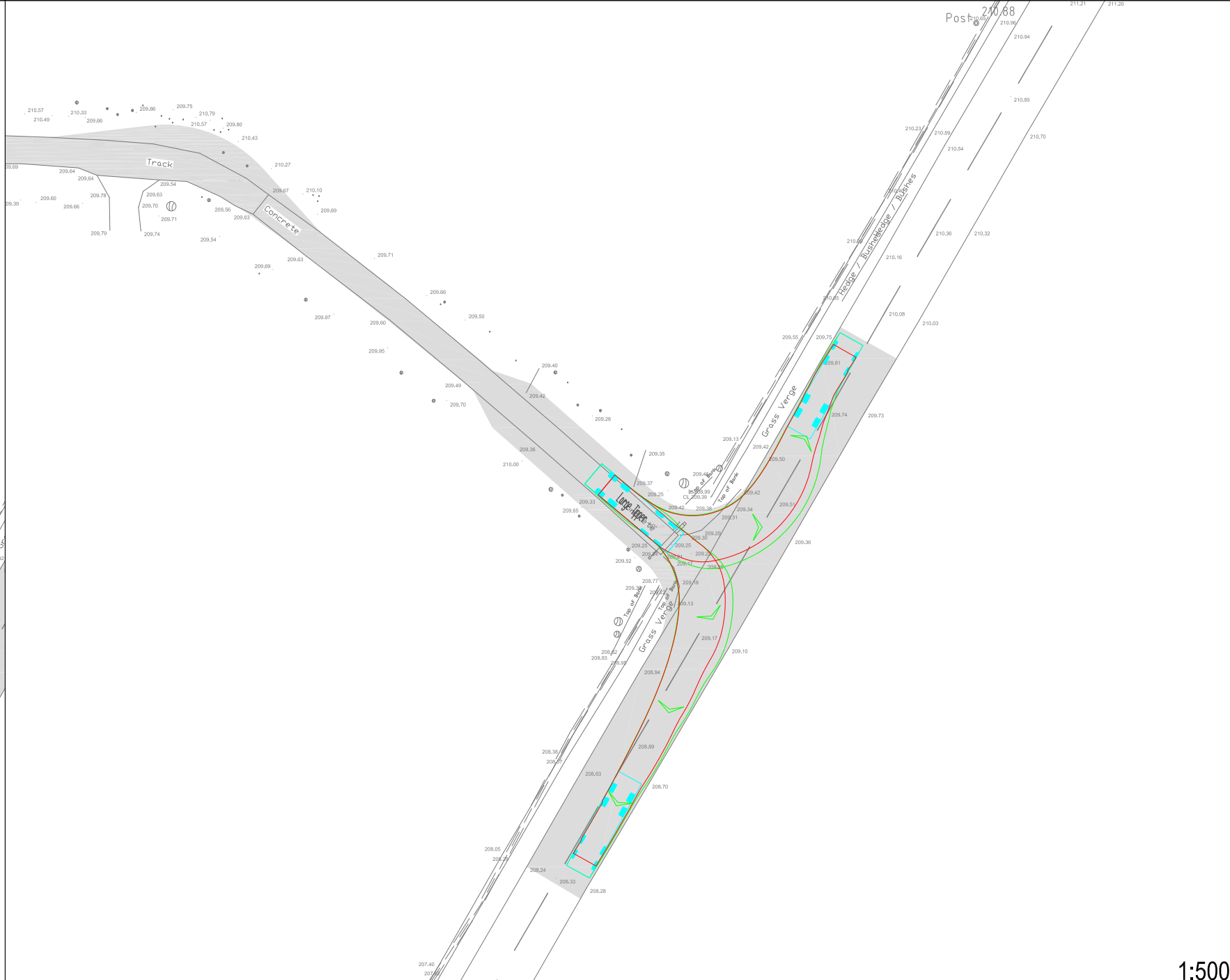

1:500

1. THIS DRAWING IS NOT TO BE SCALED FOR CONSTRUCTION PURPOSES.
2. THE CONTRACTOR SHALL CHECK ALL DIMENSIONS AND LEVELS ON SITE.

REV	DESCRIPTION	DATE	BY	AUTH
-----	-------------	------	----	------



Hub Transport Planning Ltd
 Floor 1B
 4 Temple Row
 Birmingham
 B2 5HG
 T : 0121 454 5530

CLIENT
MR KIERAN ROBINSON

PROJECT
**LADYCROSS PLANTATION HOLIDAY PARK
 EGTON**

TITLE
**PROPOSED CONSTRUCTION
 ARRANGEMENTS SWEEP PATH ANALYSIS**

DRAWN	AUTHORISED	SCALE	SHEET SIZE	DATE
JP	GM	AS SHOWN	A2	16.02.24

PROJECT NO.	DRAWING NO.	REV
T22505	008	-

T22505
Ladycross Plantation Holiday Park, Egton



Appendix A

Site Location Plan

Site Location Plan

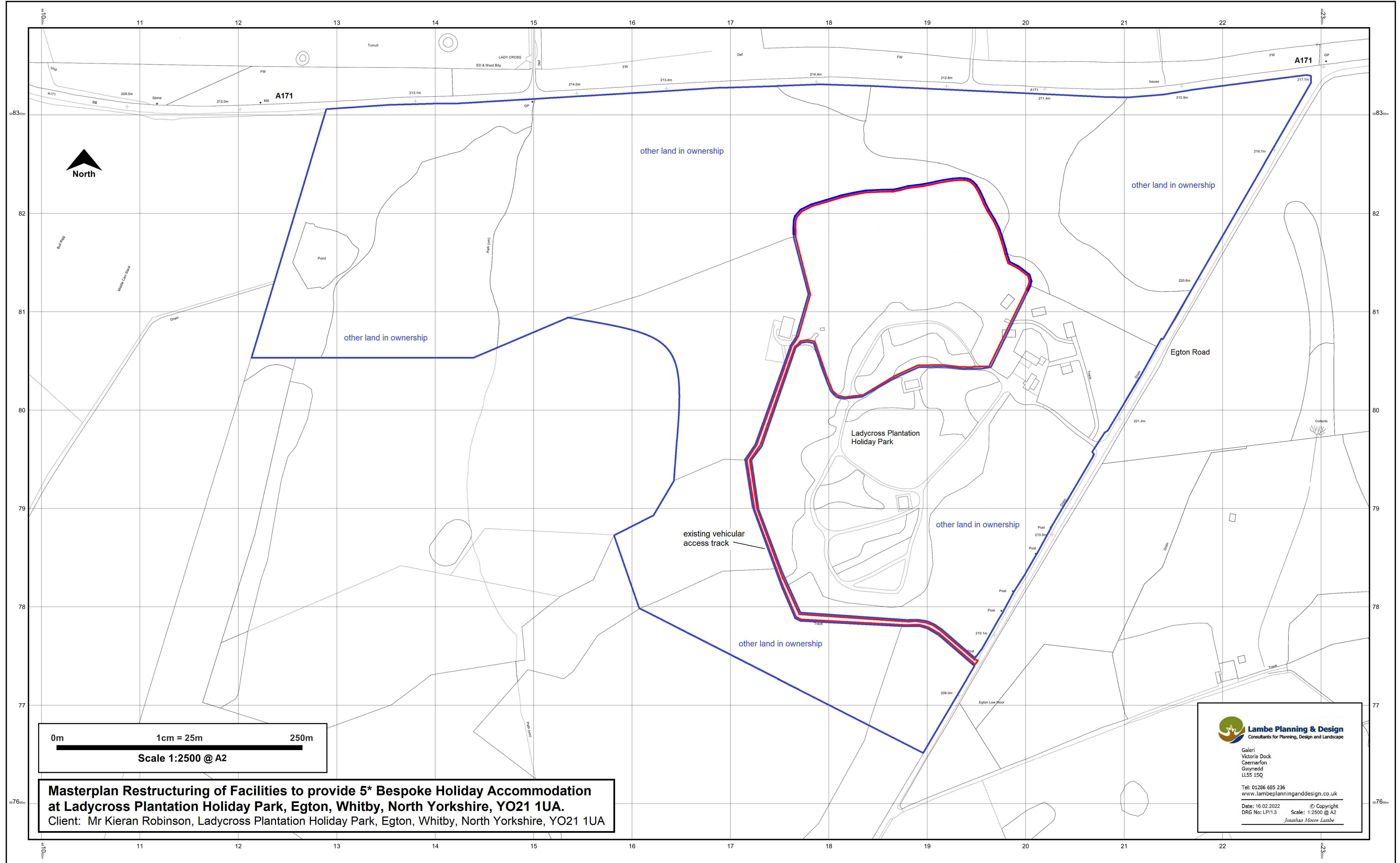

Masterplan Restructuring of Facilities to provide 5* Bespoke Holiday Accommodation at Ladycross Plantation Holiday Park, Egton, Whitby, North Yorkshire, YO21 1UA.
 Client: Mr Kieran Robinson, Ladycross Plantation Holiday Park, Egton, Whitby, North Yorkshire, YO21 1UA

Lambe Planning & Design
 Consultants for Planning, Design and Landscape

Galeri
 Victoria Dock
 Caernarfon
 Gwynedd
 LL55 1SQ

Tel: 01286 685 236
 www.lambeplanninganddesign.co.uk

Date: 16.02.2022 © Copyright
 DRG No: LP113 Scale: 1:2500 @ A2
 Jonathan Moore Lambe

© Crown copyright and database rights 2020 Ordnance Survey 100048957. The representation of road, track or path is no evidence of a boundary or right of way. The representation of features as lines is no evidence of a property boundary.