

### Amendments/Additional Information

- Amended layout of buildings/outside areas
- Additional background information
- Amended design
- Revised access arrangements
- Change of description of proposed development
- Change in site boundaries
- Other (as specified below) *Revised red line.*

2016102331FL

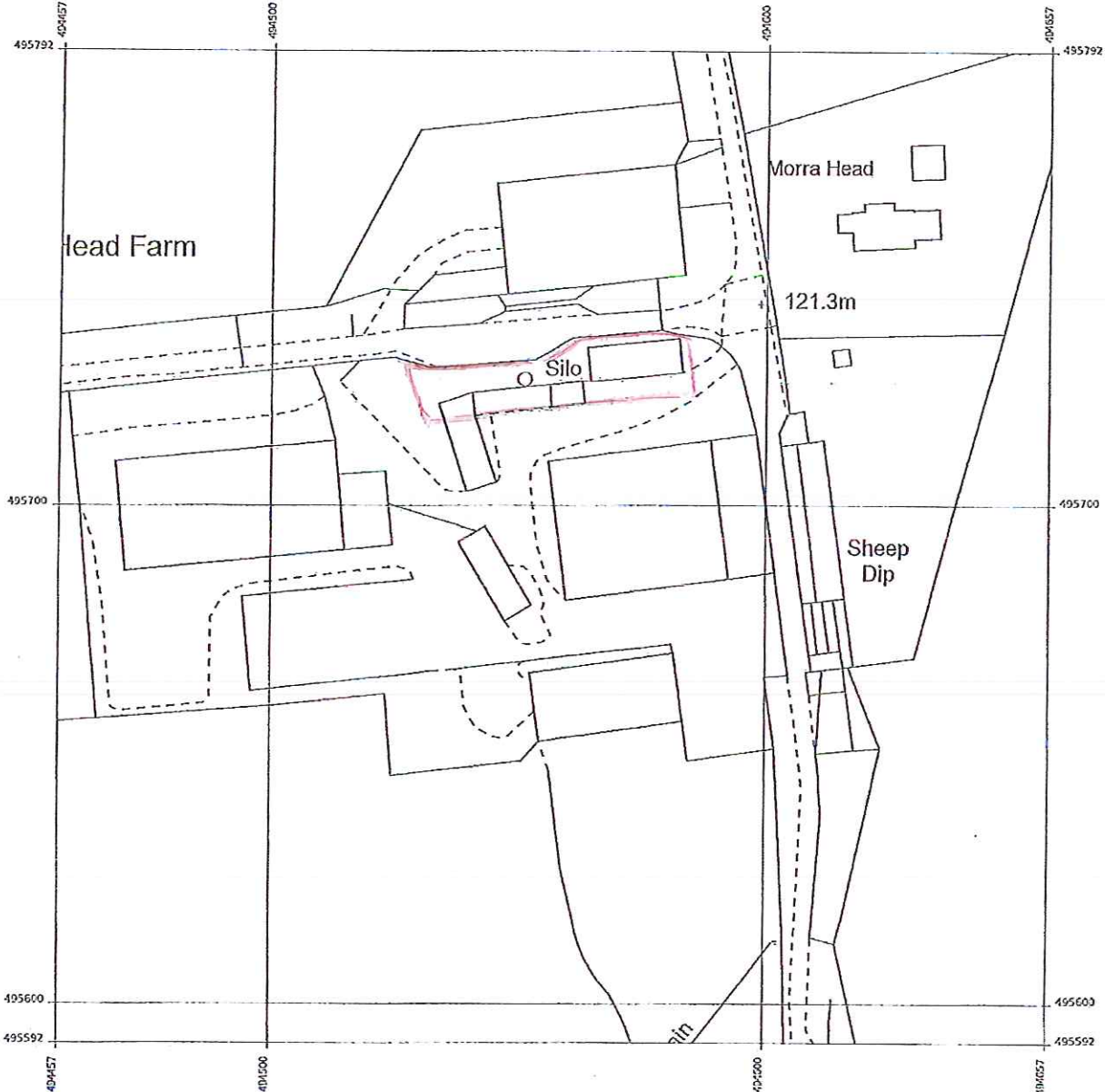

Produced 23 May 2016 from the Ordnance Survey MasterMap (Topography) Database and incorporating surveyed revision available at this date.

The representation of a road, track or path is no evidence of a right of way. The representation of features as lines is no evidence of a property boundary.

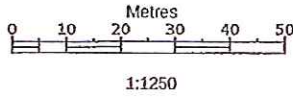

Morra Head Farm, Harwood Dale,  
Scarborough  
YO13 0LA

Supplied by: Stanfords 23 May 2016  
Licence: © Crown Copyright and  
database rights 2016 OS100035409  
Order Licence Reference: OI1000239  
Centre coordinates: 494557 495692

**NYMNP**  
31 MAY 2016  
@

**AMENDED**

Notes

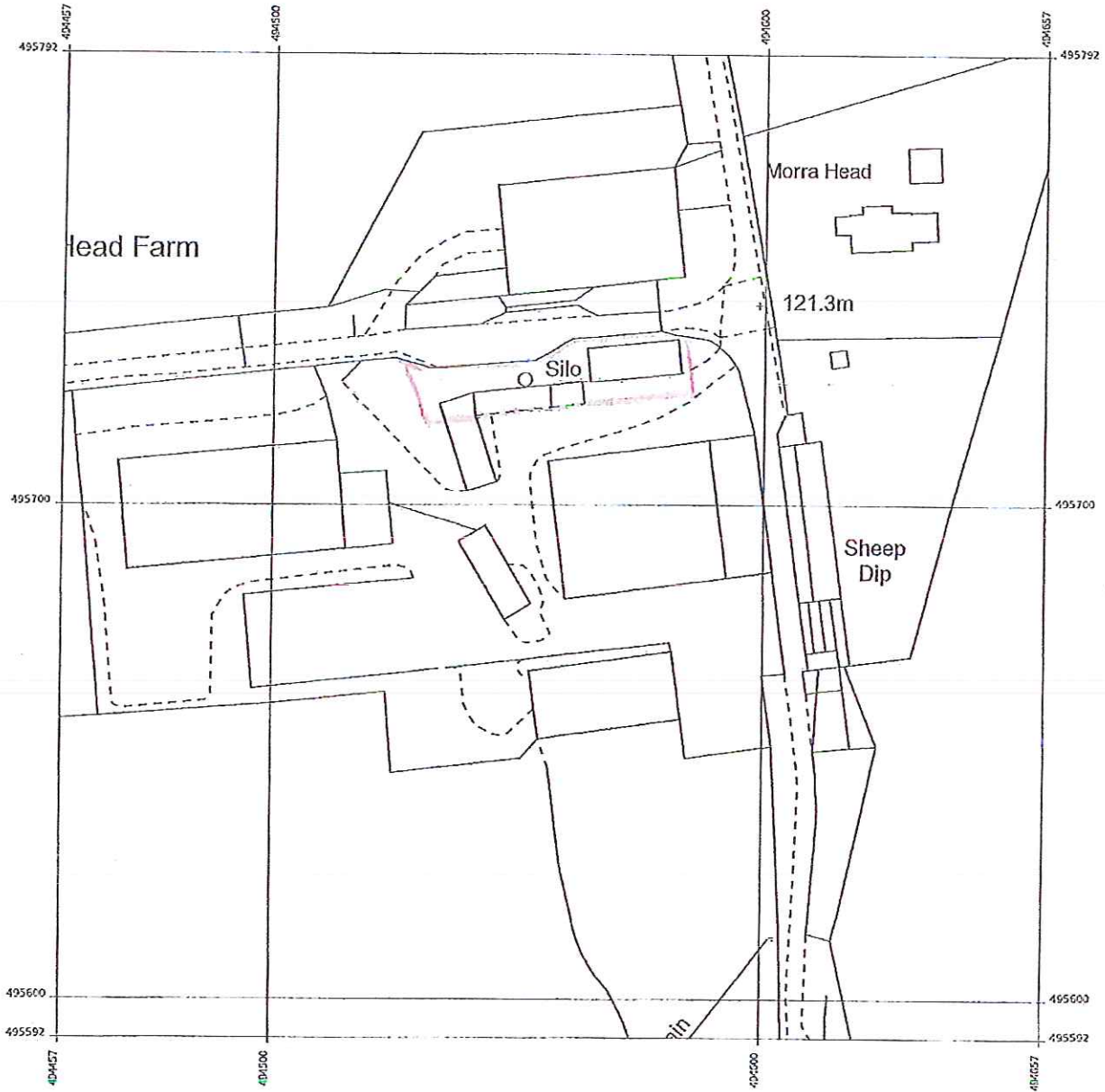

Produced 23 May 2016 from the Ordnance Survey MasterMap (Topography) Database and incorporating surveyed revision available at this date.

The representation of a road, track or path is no evidence of a right of way. The representation of features as lines is no evidence of a property boundary.

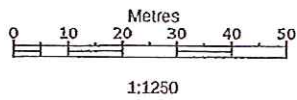

Morra Head Farm, Harwood Dale,  
Scarborough  
YO13 0LA

Supplied by: Stanfords 23 May 2016  
Licence: © Crown Copyright and  
database rights 2016 OS100035409  
Order Licence Reference: O11000239  
Centre coordinates: 494557 495692

AMENDED
Notes

NYMNP

31 MAY 2016

MORRA HEAD  
PLAN SHOWING OWNERSHIP  
OF BOUNDARY FENCES  
SCALE 1:9000

J.R. WISSONS & SON  
MORRA HEAD FM  
Lownorth (Co.)

AMENDED

Notes

NYMNP  
31 MAY 2012

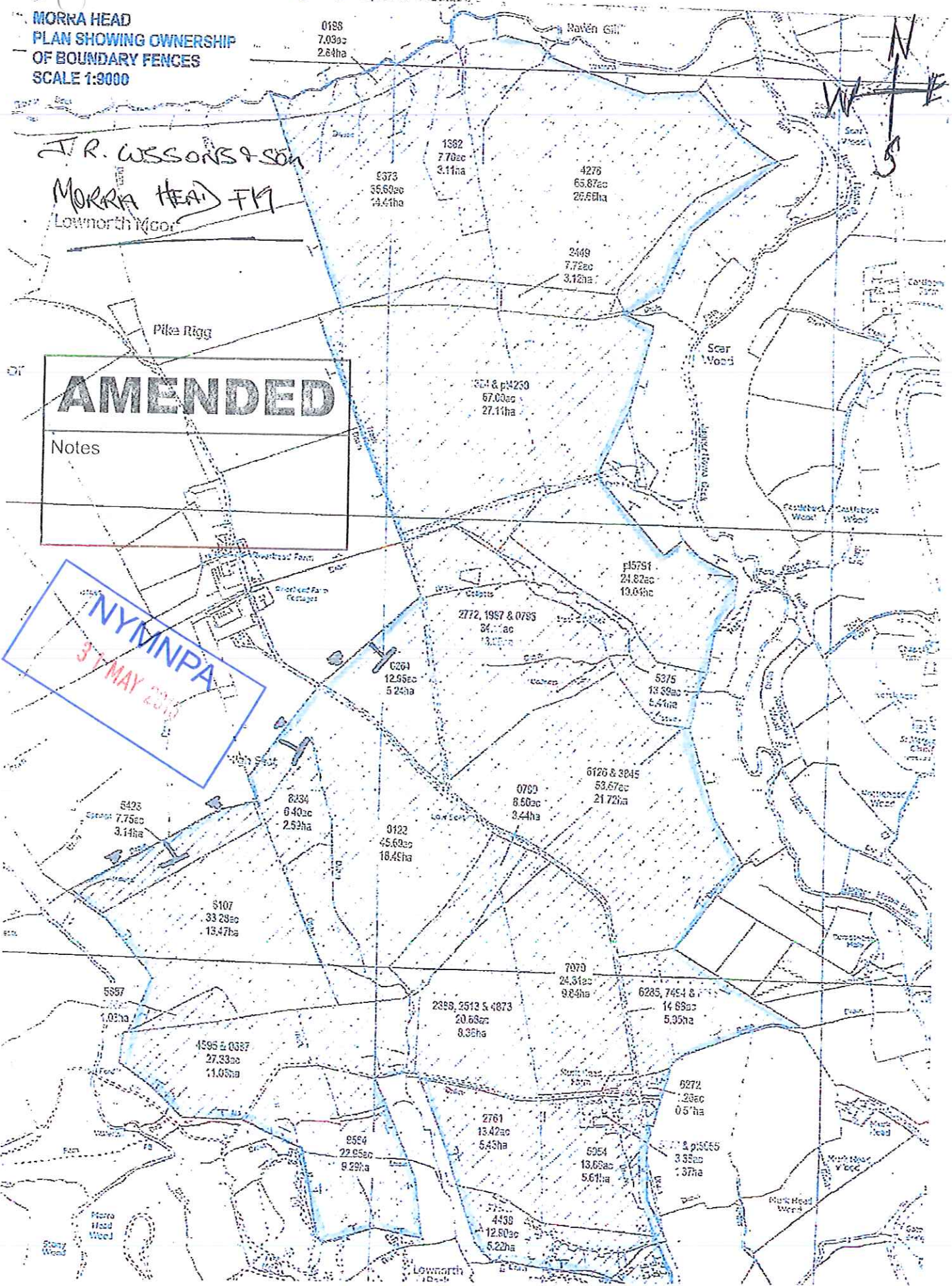

**MORRA HEAD  
PLAN SHOWING OWNERSHIP  
OF BOUNDARY FENCES  
SCALE 1:9000**

**A. R. WISSON & SON**  
**MORRA HEAD FM**  
Lownorth (Co.)

0188  
7.03ac  
2.64ha

1392  
7.70ac  
3.11ha

4276  
65.87ac  
26.55ha

6373  
55.60ac  
21.41ha

2449  
7.72ac  
3.12ha

304 & p1423  
67.60ac  
27.11ha

**AMENDED**

Notes

**NYMNP**  
31 MAY 2016

2772, 1957 & 0785  
84.11ac  
33.22ha

p15751  
24.82ac  
10.04ha

0261  
12.95ac  
5.24ha

5375  
18.58ac  
7.44ha

0700  
8.60ac  
3.44ha

6126 & 3045  
53.67ac  
21.72ha

9122  
45.60ac  
18.45ha

8234  
6.40ac  
2.53ha

5107  
33.29ac  
13.47ha

7070  
24.31ac  
9.84ha

6285, 7454 &  
14.88ac  
5.95ha

1595 & 0387  
27.33ac  
11.05ha

2358, 2512 & 4873  
20.63ac  
8.35ha

6272  
2.28ac  
0.91ha

2761  
13.42ac  
5.43ha

6954  
13.05ac  
5.61ha

8984  
22.05ac  
9.29ha

4438  
12.60ac  
5.22ha

577 & p13055  
3.55ac  
1.37ha

