

Amendments/Additional Information

- Amended layout of buildings/outside areas
- Additional background information
- Amended design
- Revised access arrangements
- Change of description of proposed development
- Change in site boundaries
- Other (as specified below)

NYMNP
The Old Vicarage
Bondsgate
Helmsley

Spring Farm
Robin Hood's Bay
Whittar
NY68

Y022 4PH

14TH November 2016

NYM/2016/0769/AGRP

Dear Sir

Thank you for your letter dated
10 November 2016.

I enclose plans drawn to scale in metres
showing floor plan and elevations, and
the Supporting Agricultural information.

Yours Sincerely



ANDREW WILLIAMSON

Others

	Average number throughout the year	Additional information
Other Livestock, i.e. Horses	/	

Land

	Area in Hectares	Additional information
Size of Holding	32.6 HECTARES	
Available Grazing Land	29.6	
Arable Land	3	
Moorland	/	
Grazing Land on Short Term Tenancy	4.15 6.73	

Agricultural Buildings

List main existing agricultural buildings and use	Approximate dimensions in metres	Is it a modern or traditional building?
1. CATTLE	12.18 x 27.41	MODERN
2. CATTLE & PIGS	12.18 x 27.41	u
3. PIGS	9.13 x 27.41	u
4.		
5.		
6.	<div style="border: 1px solid blue; padding: 5px; display: inline-block;"> <p style="color: blue; margin: 0;">NYMNPA</p> <p style="color: red; margin: 0;">16 NOV 2016</p> </div>	
7.		
8.		

Proposed building(s) and use	Dimensions in metres
1. HAY & STRAW STORAGE	30.45 x 15.23
2.	

Please Note: It would be helpful if you could attach a sketched block plan annotating which building is which as referred to above.

Please detail below how the farming operation on site may change as a result of the proposal i.e. increase in stock levels or justification for the use of the new building.

TO KEEP FODDER & STRAW DRY

HAY & STRAW BARN
 AT SPRING FARM
 R. M. BAY 4022 4PH
 NYM/2016/0769/AGRP

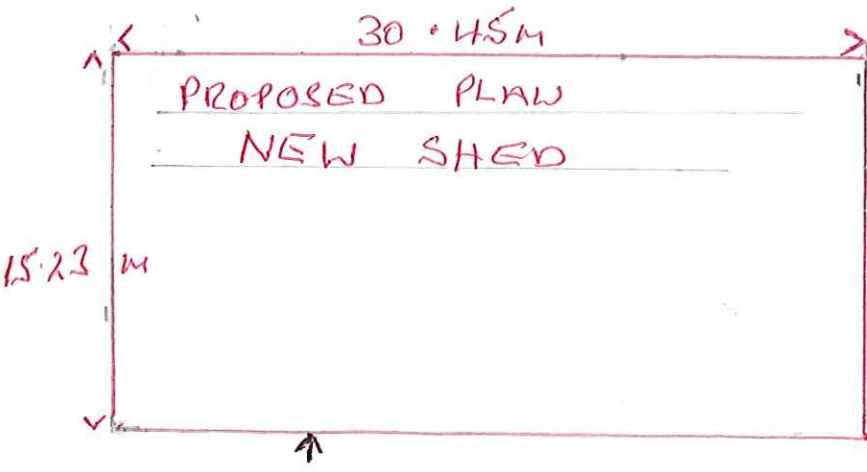

24.36m.

AMENDED
Notes

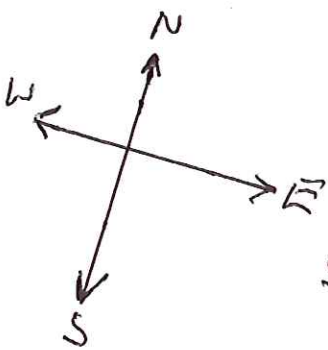
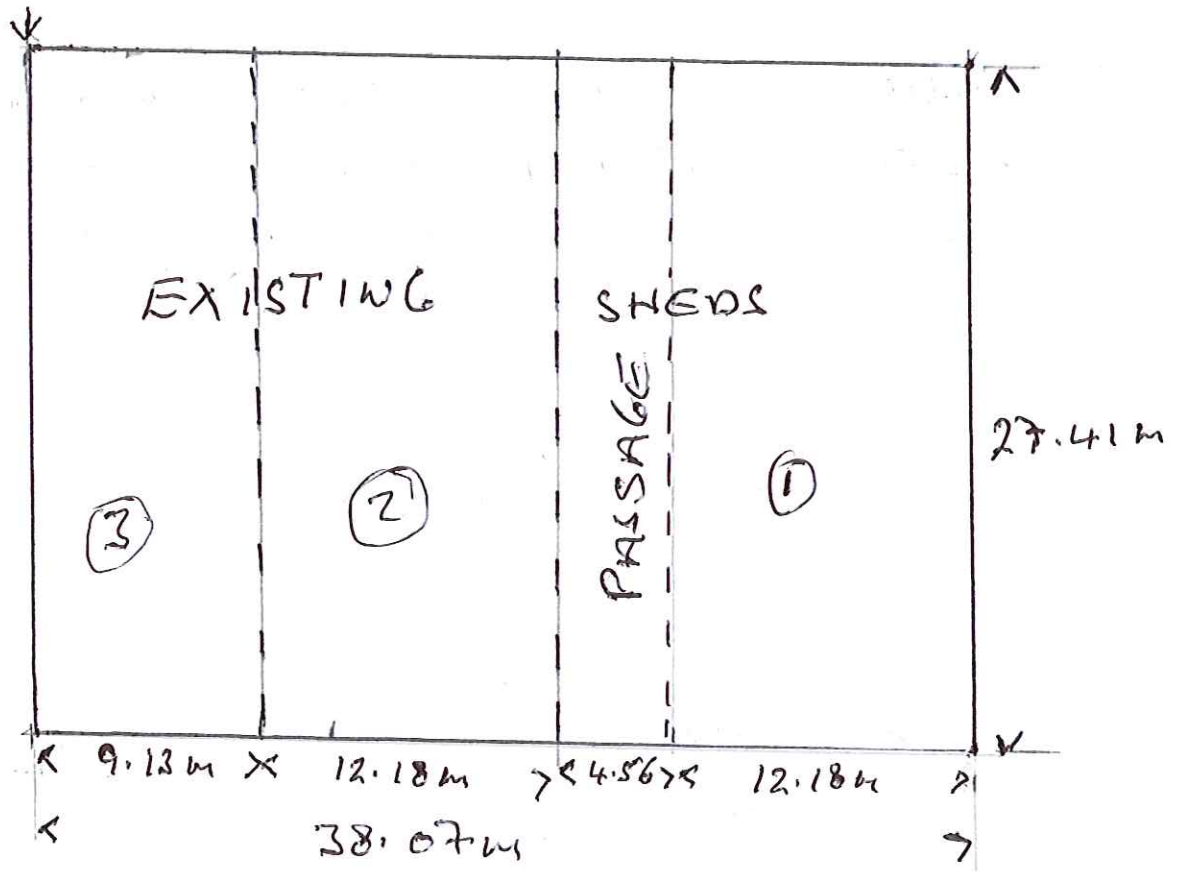

SCALE 1 - 300

NYMNP
 16 NOV 2016

(1)

HAY v STRAW BARR AT SPRING IN R.H. 13.194 1022 484

PROPOSED END ELEVATION

N/M/2016/0769/AGRP

AMENDED
Notes

NYMNP
 16 NOV 2016

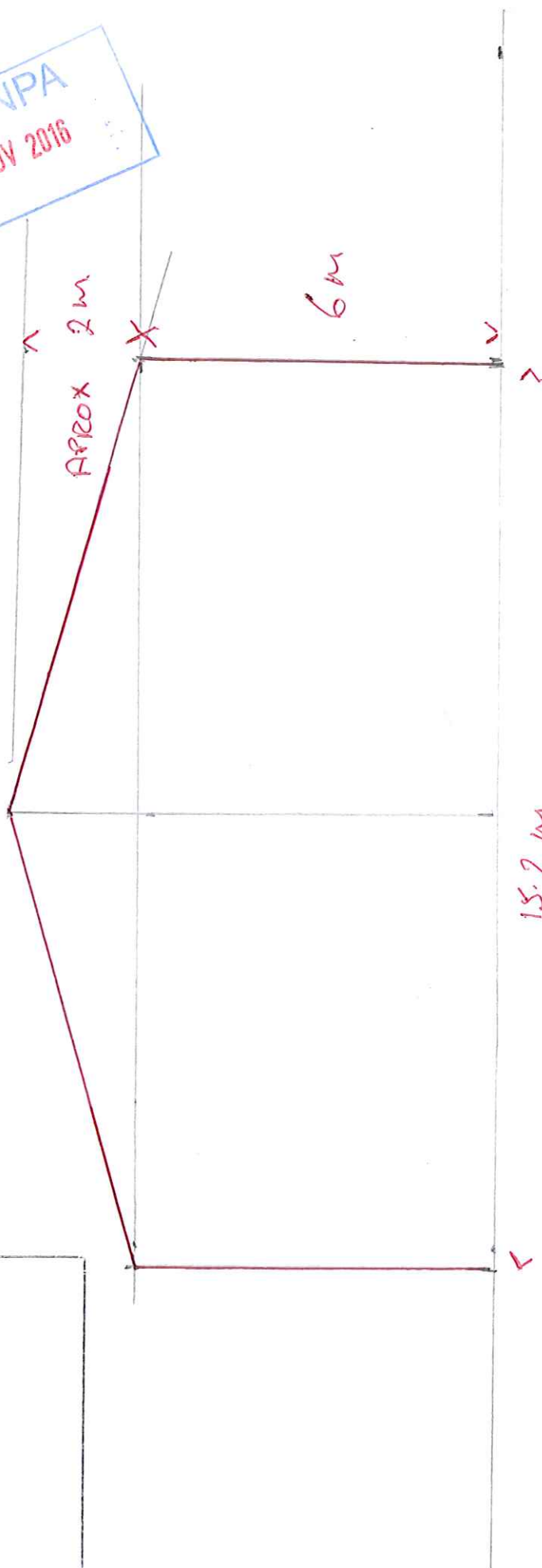

SCALE 1 ÷ 200