

# SITE LAYOUT PLAN OF PROPOSED POND.

18/10/18

Two of Two.

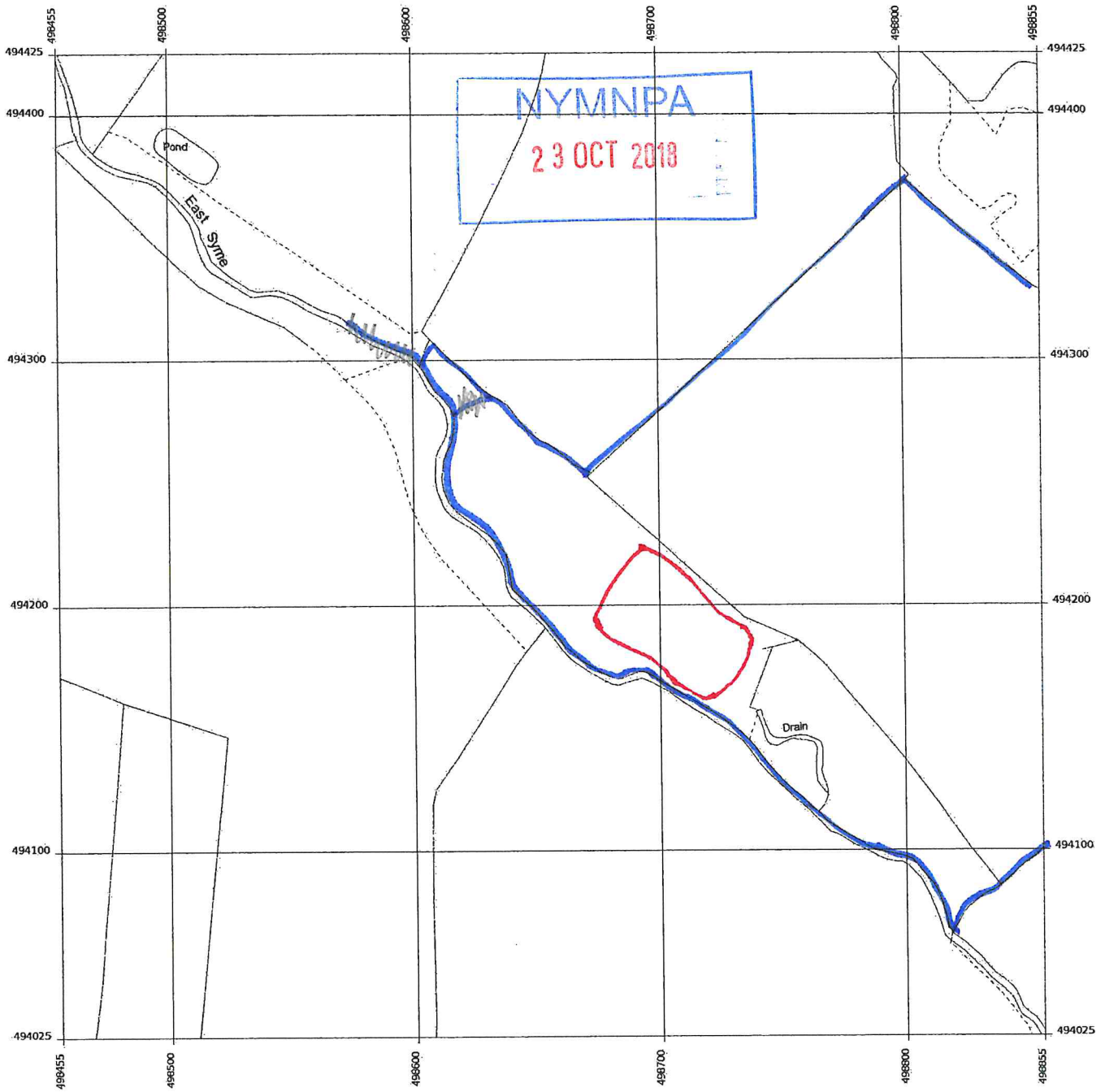
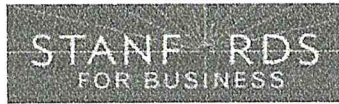

Produced 19 Oct 2018 from the Ordnance Survey MasterMap (Topography) Database and incorporating surveyed revision available at this date.

The representation of a road, track or path is no evidence of a right of way. The representation of features as lines is no evidence of a property boundary.

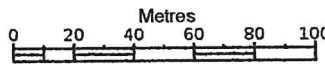

1:2500



land south east of Thirley Beck  
Harwood Dale Road  
Harwood Dale

Supplied by: Stanfords 19 Oct 2018  
Licence: © Crown Copyright and  
database rights 2018 OS100035409  
Order Licence Reference: OI1273061  
Centre coordinates: 498655 494225

Key.

- Proposed Pond  
65m x 45m
- Land owned  
by D-E New

① - NEWHAM: your REF:- NYM/2018/0275/NEW

D. NEWHART

Map to show Surrounding land.

18-10-18

Ref: NYM/2018/0215/NE

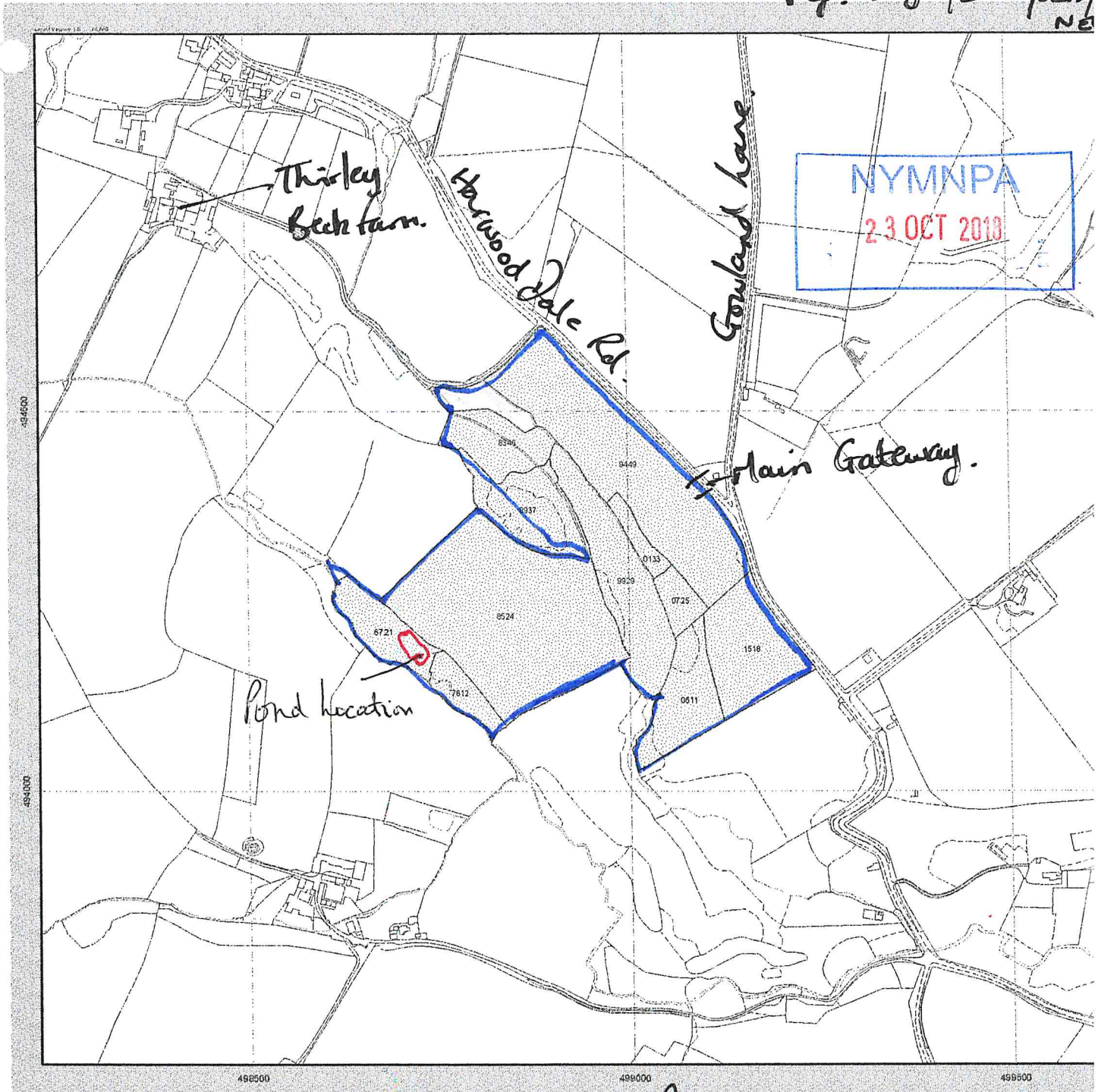

land owned by ...

D. NEWHAM.

Proposed

Your Ref:- NYM/2018/0275/NEW.

Re-instatement of pond at Thirley Beck, Harwood Dale.

Longitudinal Section.



Key:-  
metres).  
1 5m. 1

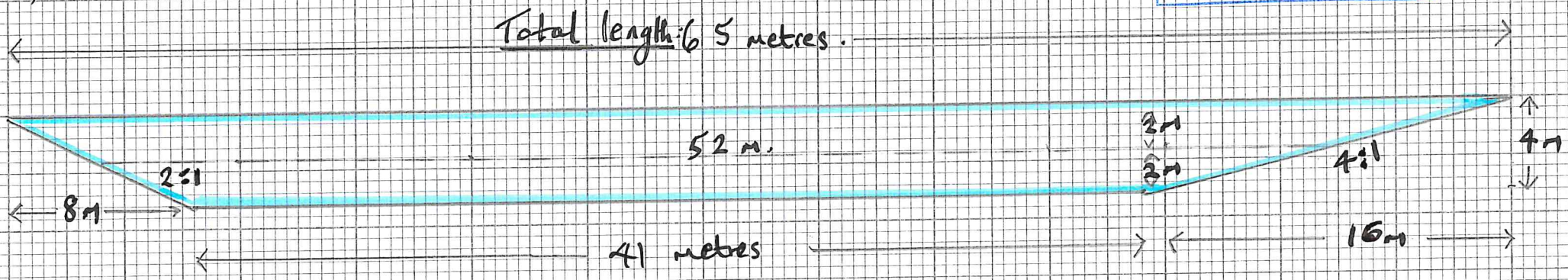

Cross Section

