

From:
To: [Planning](#)
Subject: NYM/2018/0107/CVC - FAO Jill Bastow
Date: 01 June 2018 11:24:59
Attachments: [1986 - 1 - Construction Site Plan - Existing Site Plan.pdf](#)
[1986 - 2 - Construction Site Plan - Proposed Site GA Plan.pdf](#)
[1986 - 3 - Construction Site Plan - Site Drainage Plan.pdf](#)
[1986 - 4 - Construction Site Plan - Service Supply Plan.pdf](#)
[1986 - 5 - Construction Site Plan - Road Plan.pdf](#)

Dear Jill,

In response to your letter relating to the above discharge of condition application I have addressed the outstanding points, as requested, within this email.

Condition 10:

The position of the poles existing position has been highlighted on the existing site plan attached (1986 – 1) and the proposed position is highlighted on the following proposed plans (1986-2,3,4,5)

We proposed that the pole is to be set back a minimum of 1.2m from the current location to give the required visibility splays for the new proposed vehicle exit from the site. In terms of timescale for this work our client will be looking to undertake this relocation work within these summer months once site construction work begins.

In relation to the tallest caravan to be situated on the site it is proposed that this height will be 3.75m however we will be proposing to cut the hanging branches back to a minimum of 5m from ground level to give ample room for flat-bed transportation heights. Again any work that is to be undertaken to these affected trees will be undertaken within the summer once work commences.

Condition 12:

Please see the attached plan 1986-3 I have shortened the land drainage pipe runs by 3m to provide a soak away area before discharging into the existing becks. Hopefully this will meet your ecologists requirements.

Condition 13:

Please see the attached plan 1986-3 again as I have now removed the proposal of a hydro break chamber. All foul water drainage will run directly and freely into the existing system.

Hopefully, this information provided will now suffice your requirements for the outstanding conditions.

I'll await your response.

Kind regards

Jonathan Loughrey *BSc (Hons)*
Building Surveyor

Vega House
8 Grange Road

NYMNPA

01/06/2018

Hartlepool
TS26 8JA



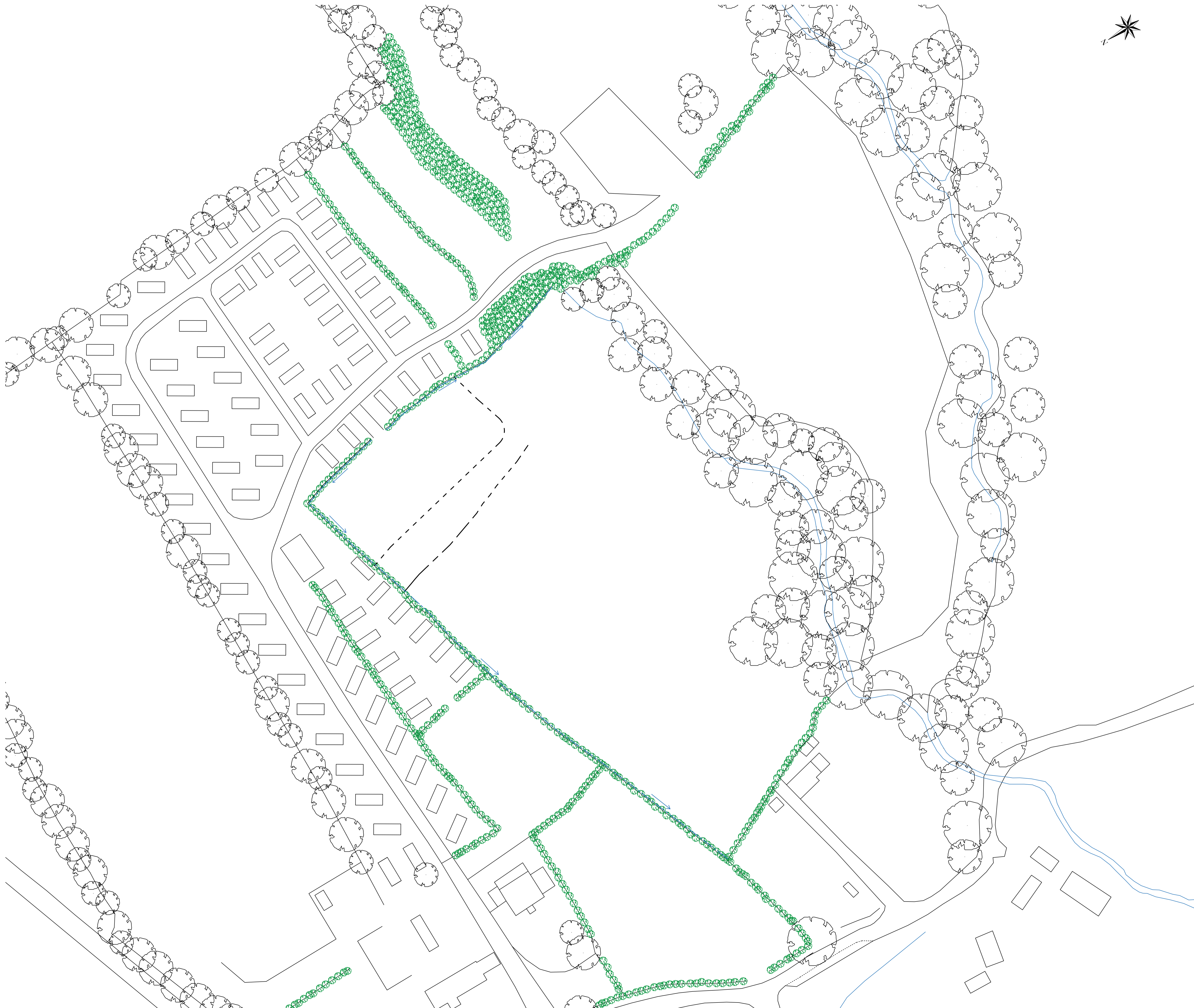
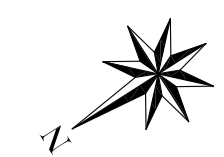

NYMNPA
01/06/2018

AMENDED

A	Construction Plans - First Issue	JL	13/11/2017
B	Amendments for planning purposes	JL	03/05/2018
Revision	Description	By	Date
<small>Notes: THE COPYRIGHT OF THIS DRAWING IS VESTED IN ASP ASSOCIATES AND IT MAY NOT BE REPRODUCED IN WHOLE OR PART OR USED FOR THE MANUFACTURE OF ANY ARTICLES WITHOUT THE EXPRESS PERMISSION OF THE COPYRIGHT HOLDERS. NOTE TO EMPLOYEES: DIMENSIONS ONLY. ALL DIMENSIONS TO BE CHECKED ON SITE PRIOR TO COMMENCEMENT OF WORK. THE DRAWING IS TO BE USED IN CONJUNCTION WITH ALL RELEVANT ARCHITECT'S SERVICES ENGINEERS AND MANUFACTURER'S DRAWINGS AND SPECIFICATIONS.</small>			
 ARCHITECTURE SURVEYING & PLANNING			
Vega House, 8 Grange Road Hartlepool, TS26 8JA www.aspassociates.co.uk			
Project Address	York House Caravan Park Brick Lane, High Hawkser Whitby	Dwg No.	1986/CSP/1
Client	Mr C Wharton	Status	Construction Issue
Dwg Title	Existing Site Plan	Paper size	A1
Rev	B	Scale	1:500
Rev Date	03/05/2018	Drawn By	JL

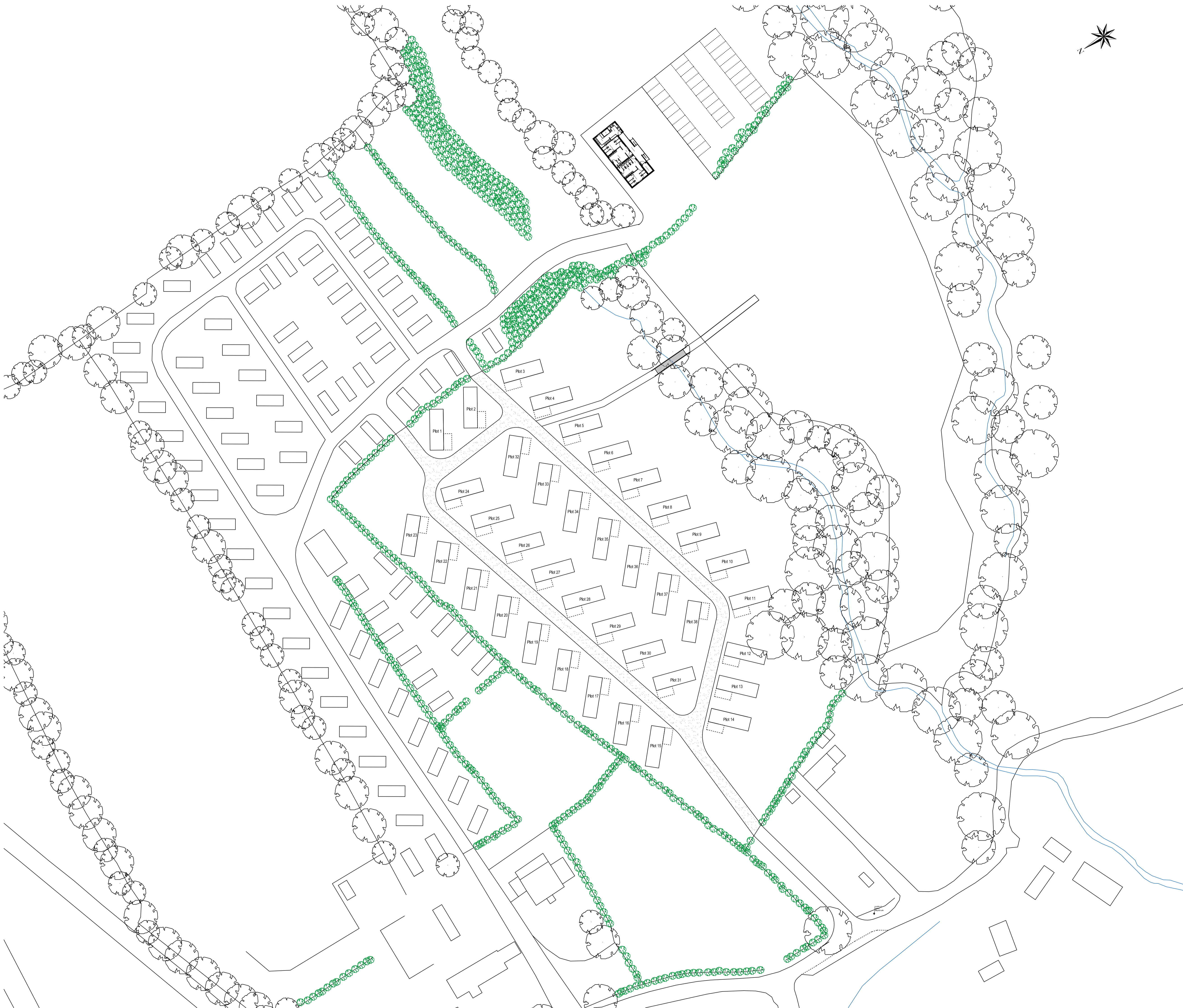

NYMNP
01/06/2018

AMENDED

Proposed new 8berth caravan plot berths - 38No.

Planning permission has been previously approved for the proposed sanitary building

Revision	Description	By	Date
A	Construction Plans - First Issue	JL	13/11/2017
B	Amendments for planning purposes	JL	03/05/2018

Notes:
THE COPYRIGHT OF THESE DRAWINGS IS RESERVED BY ASP ASSOCIATES AND IT MAY NOT BE REPRODUCED IN WHOLE OR PART OR USED FOR THE
MANUFACTURE OF ANY ARTICLES WITHOUT THE EXPRESS PERMISSION OF THE COPYRIGHT HOLDERS.
WORKS TO RELATED INSTRUCTIONS ONLY. ALL DIMENSIONS TO BE CHECKED ON SITE PRIOR TO COMMENCEMENT OF WORK.
THE DRAWING IS TO BE READ IN CONJUNCTION WITH ALL RELEVANT ARCHITECT'S SERVICE ENGINEER'S AND MANUFACTURER'S DRAWINGS AND
SPECIFICATIONS.

ASP ASSOCIATES
ARCHITECTURE
SURVEYING
& PLANNING

Vega House, 8 Grange Road
Hartlepool, TS26 8JA
www.asppartners.co.uk

Project Address	York House Caravan Park Brick Lane, High Hawkser Whitby	Dwg No.	1986/CSP/2
Client	Mr C Wharton	Status	Construction Issue
Dwg Title	Proposed Site Plan	Paper size	A1
Rev	B	Scale	1:500
Rev Date	03/05/2018	Drawn By	JL

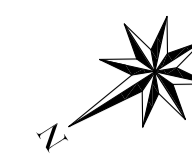

UNDERGROUND FOUL DRAINAGE
Underground drainage to consist of 100mm diameter UPVC proprietary pipe work to give a 1:40 fall. Surround pipes in 100mm pea shingle. Provide 600mm suitable cover (900mm under drives). Shallow pipes to be covered with 100mm reinforced concrete slab over compressible material. Provide rodding access at all changes of direction and junctions. All below ground drainage to comply with BS EN 1401-1: 2009.





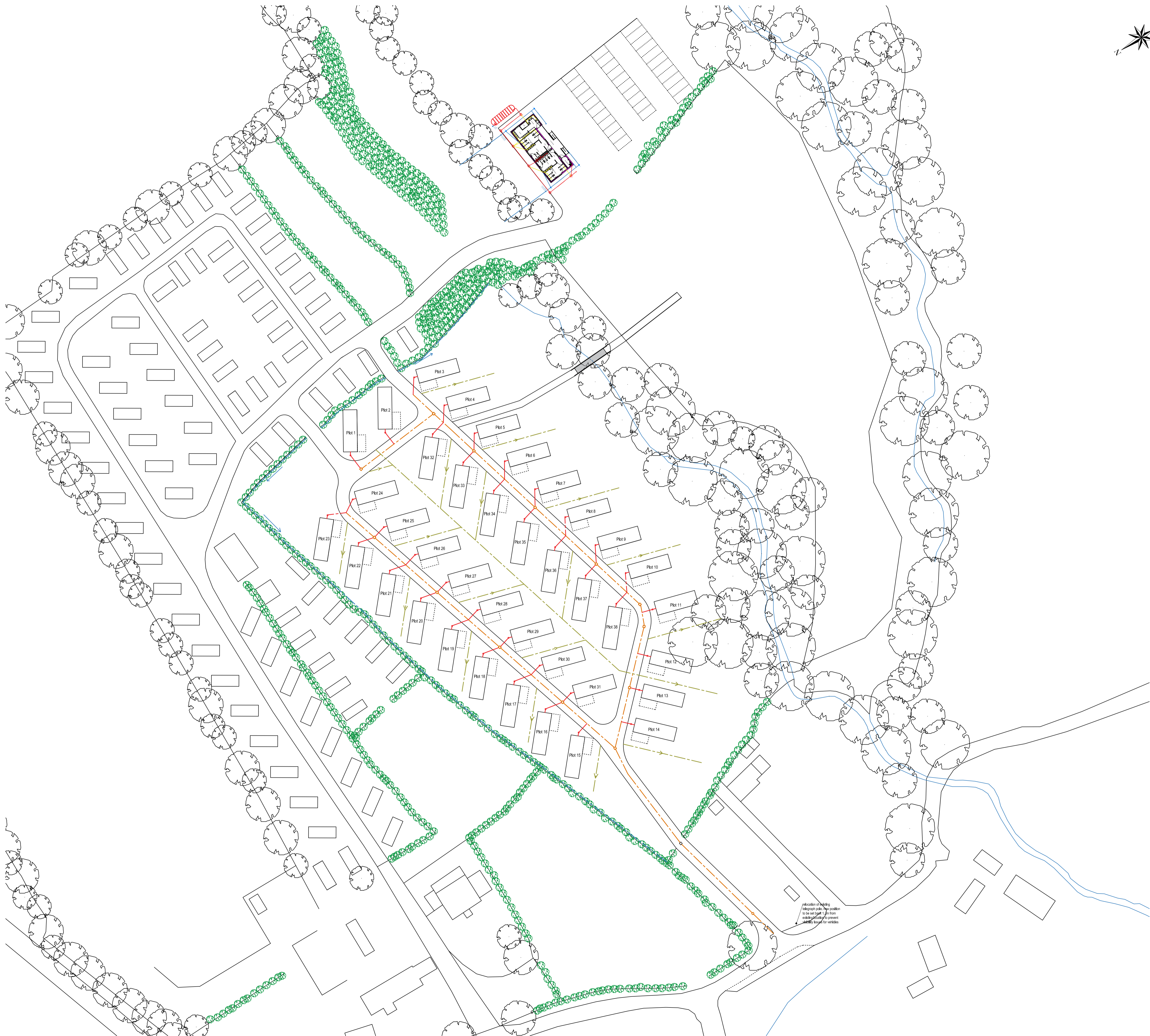

INSPECTION CHAMBERS
Underground quality proprietary UPVC 450mm diameter inspection chambers to be provided at all changes of level, direction, connections and every 45m in straight runs. Inspection chambers to have bolt down double sealed covers in buildings and be adequate for vehicle loads in driveways.

PIPEWORK THROUGH WALLS
Where pipework passes through external walls form rocker joints either side wall face of max length 600mm with flexible joints with short length of pipe bedded in wall.
Alternatively provide 75mm deep pre-cast concrete plank lintels over drain to form opening in wall to give 50mm space all round pipe; mask opening both sides with rigid sheet material and compressible sealant to prevent entry of fill or vermin.



NYMNPA
01/06/2018

AMENDED

-  Proposed Mains foul drainage Manholes 600mm² concrete chambers - 13No. total
-  Proposed plot foul drainage inspection chambers 300mm \varnothing 38no. one based on each plot
-  Proposed Mains foul drainage 225mm PVC Pipe
-  Proposed Plot foul drainage 150mm PVC Pipe
-  Proposed Mains land drainage 150mm Perforated PVC Pipe
-  Existing surface water land becks to be retained. All surface water will be discharged into the existing water courses and channels as existing.

Revision	Description	By	Date
A	Construction Plans - First Issue	JL	13/11/2017
B	Amendments for planning purposes	JL	03/05/2018

Notes:
The copyright of the drawings is vested in ASP associates and it may not be reproduced in whole or part or used for the manufacture of any articles without the written permission of the copyright holders.
Work to proposed dimensions only. All dimensions to be checked on site prior to commencement of work.
The drawings to be read in conjunction with ALL relevant 'SPECIFICATIONS', SERVICE SCHEDULES AND WORKMANSHIP INSTRUCTIONS AND PARTICULARS.

ASP associates ARCHITECTURE SURVEYING & PLANNING
Vega House, 8 Grange Road
Hartlepool, TS26 8JA
www.aspassociates.co.uk

Project Address	York House Caravan Park Brick Lane, High Hawkser Whitby	Dwg No.	1986/CSP/3
Client	Mr C Wharton	Status	Construction Issue
Dwg Title	Proposed Drainage Site Plan	Paper size	A1
Rev	B	Scale	1:500
Rev Date	03/05/2018	Drawn By	JL

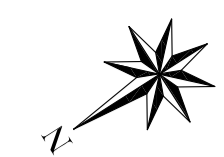

NYMNPA
01/06/2018

AMENDED

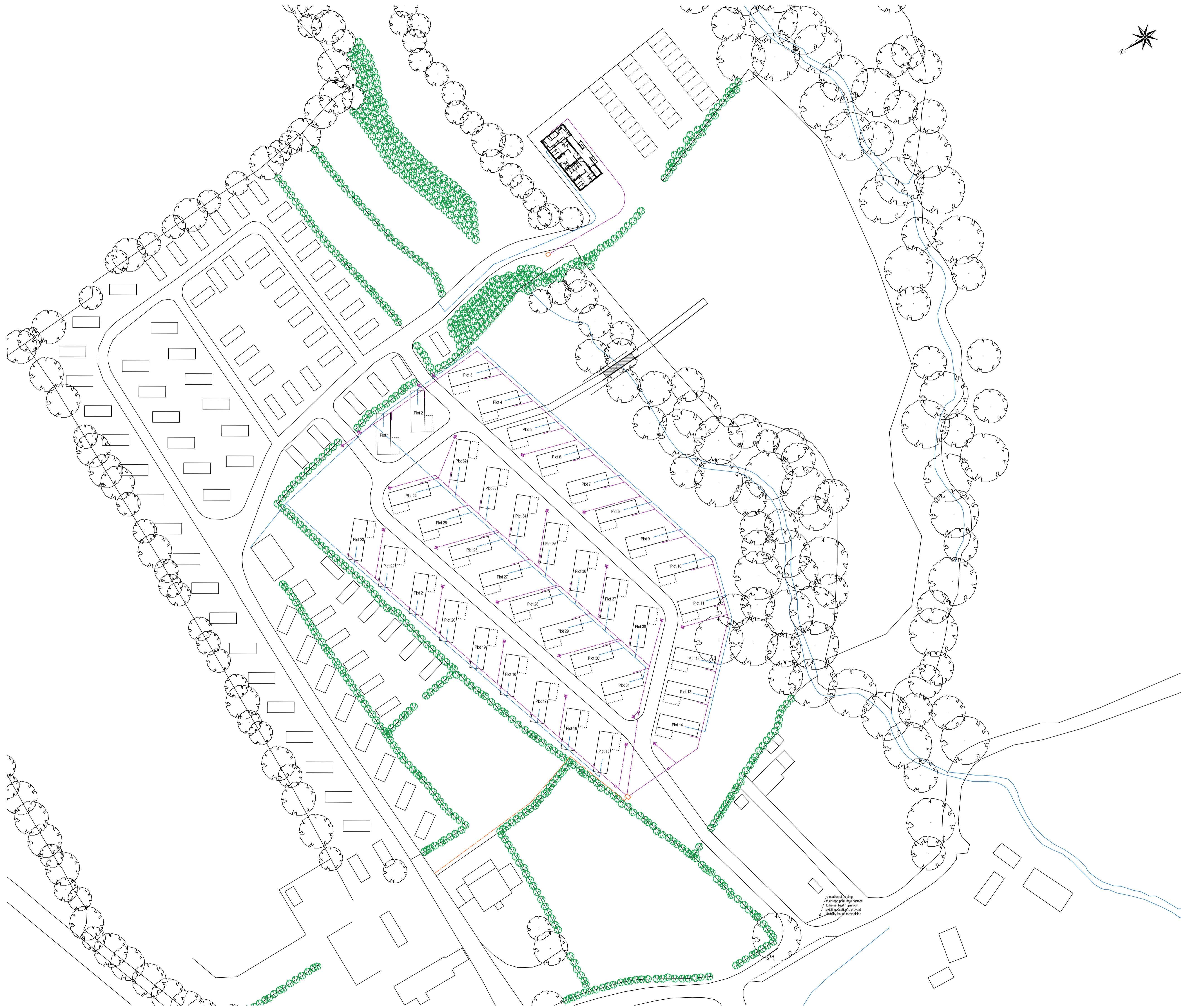







COLD WATER SUPPLY
There must be a suitable installation for the provision of a wholesome water supply in accordance with Approved Document G. Cold water supply to be provided to washbasins, bidets, baths, WCs, showers, any place when drinking water is drawn off and to any sink provided in areas where food is prepared.
Supply of cold water to comply with section 67 of the water industry act 1991 and the Water Supply Regulations 2000.
Approved contractor can be used to install the on site water supply using MDPE pipe but approval should be attained by the relevant governing body.

Electrical supply full approval and design should be attained by the relevant governing body for the supply runs and the junction boxes.

clients discretion to install external site lighting to new proposed caravan campsite.

PLEASE NOTE: ALL SERVICE SUPPLIES TO BE ENCLOSED WITH 50-100MM PVC PIPE FOR PROTECTION AND MAINTENANCE ACCESS.

-  Proposed locations of Knightsbridge IP54 240V Anti-Corrosion Powder Coated Bollard P1163 750mm high lighting
-  Main consumer unit control box to provide phased feeds off
-  Single ring control cut off box

	Proposed Electric runs to plots	100mm PVC Pipe protective ducting
	Proposed Mains Electric Feed	100mm PVC Pipe protective ducting
	Proposed Mains water feed to plots	50mmØ MDPE Pipe with 25mmØ tee offs to each plot

relocation of bollards
where possible. New position
to be set 1.5m from
existing location of bollards
and to be used for vehicles

A	Construction Plans - First Issue	JL	13/11/2017
B	Amendments for planning purposes	JL	03/05/2018
Revision	Description	By	Date

NOTES:
THE COPYRIGHT OF THIS DRAWING IS VESTED IN ASP ASSOCIATES AND IF ANY PART IS REPRODUCED IN WHOLE OR PART OR USED FOR THE MANUFACTURE OF ANY ARTICLES WITHOUT THE EXPRESS PERMISSION OF THE COPYRIGHT HOLDERS.
WORK TO BE DONE SHOULD BE CHECKED ON SITE PRIOR TO COMMENCEMENT OF WORK.
THE DRAWING IS TO BE READ IN CONJUNCTION WITH ALL RELEVANT ARCHITECTS, SERVICES ENGINEERS AND MANUFACTURERS DRAWINGS AND SPECIFICATIONS.



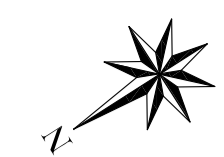

ASP associates ARCHITECTURE SURVEYING & PLANNING
Vega House, 8 Grange Road
Hartlepool, TS26 8JA
www.aspassociates.co.uk

Project Address	York House Caravan Park Brick Lane, High Hawkser Whitby	Drawn By	JL
Client	Mr C Wharton	Project No.	1986/CSP/4
Dwg Title	Proposed Service Site Plan	Status	Construction Issue
Rev	B	Rev Date	03/05/2018
Scale	1:500	Paper size	A1
Drawn By	JL		



NYMNPA
01/06/2018

AMENDED

-  location of 'one way' signs
arrows on the road dictate direction of the one way
-  location of 'do not turn' signs
-  Proposed 3.7m wide access road
-  Proposed gravel footpath across new bridge

A	Construction Plans - First Issue	JL	13/11/2017
B	Amendments for planning purposes	JL	03/05/2018
Revision	Description	By	Date

Notes:
THE COPYRIGHT OF THIS DRAWING IS VESTED IN ASP ASSOCIATES AND IF ANY PART IS REPRODUCED IN WHOLE OR IN PART OR USED FOR THE MANUFACTURE OF ANY ARTICLES WITHOUT THE EXPRESS PERMISSION OF THE COPYRIGHT HOLDERS.
WORK TO BE DONE SHOULD ONLY BE UNDERTAKEN TO BE CHECKED ON SITE PRIOR TO COMMENCEMENT OF WORK.
THE DRAWING IS TO BE READ IN CONJUNCTION WITH ALL RELEVANT ARCHITECTS, SERVICES ENGINEERS AND MANUFACTURERS DRAWINGS AND SPECIFICATIONS.

ASP ASSOCIATES
ARCHITECTURE
SURVEYING
& PLANNING

Vega House, 8 Grange Road
Hartlepool, TS26 8JA
www.aspassociates.co.uk

Project Address	York House Caravan Park Brick Lane, High Hawkser Whitby	Dwg No.	1986/CSP/3
Client	Mr C Wharton	Status	Construction Issue
Dwg Title	Proposed Road Site Plan	Paper size	A1
Rev	B	Scale	1:500
Rev Date	03/05/2018	Drawn By	JL

Allocation of parking
/signage pole. This position
is to be checked on site from
existing site to prevent
any issues for vehicles