

NOTES

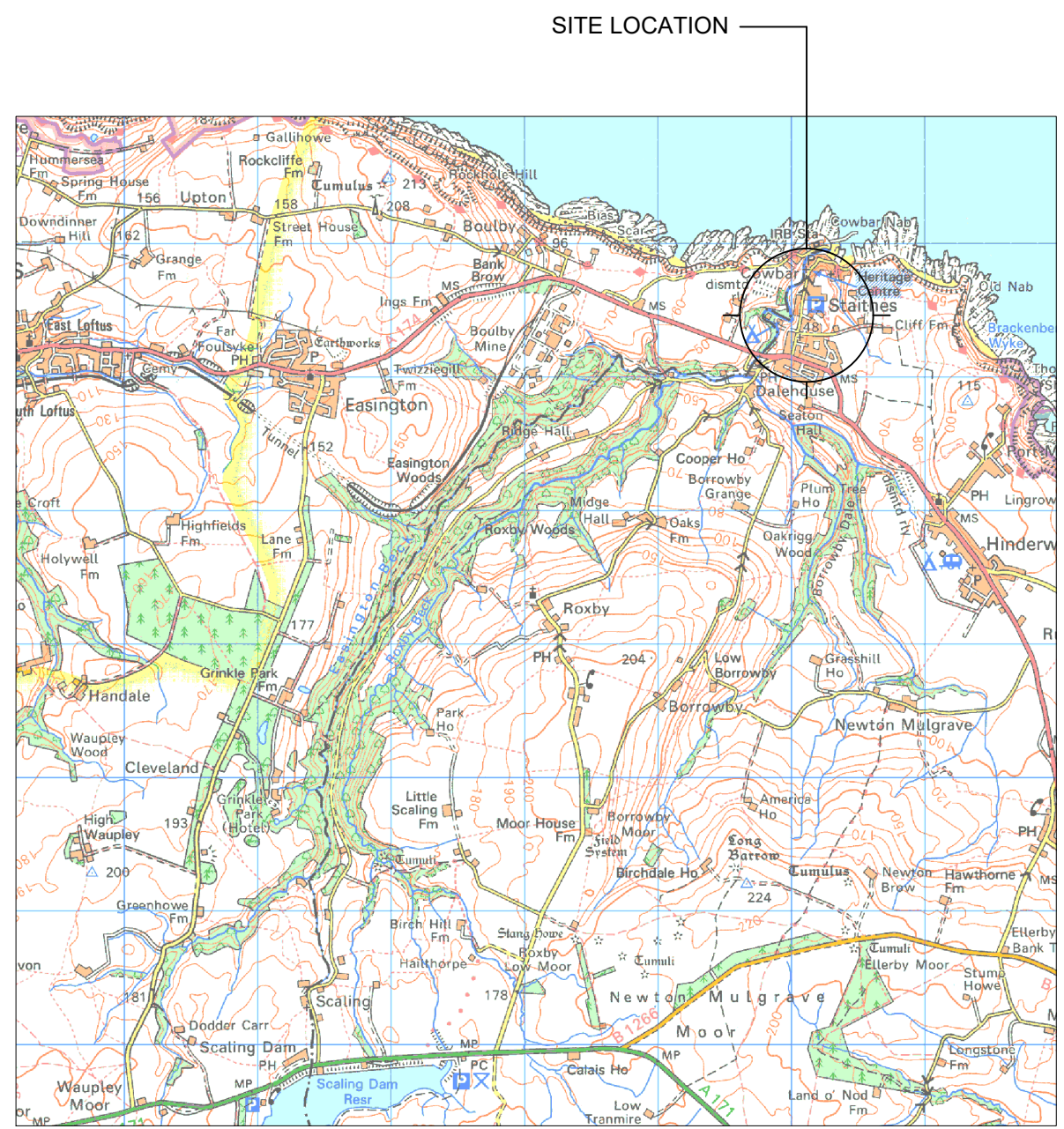

← = ACCESS ROUTE TO SITE



SITE LOCATION PLAN
 SCALE 1:50000

CROWN COPYRIGHT RESERVED. MAPS REPRODUCED WITH THE PERMISSION OF THE CONTROLLER OF HM'S STATIONERY OFFICE DIGITAL MAPPING SOLUTIONS FROM ORDNANCE SURVEY © CROWN COPYRIGHT 2016

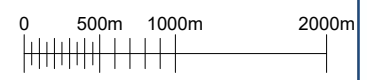

NYMNPA
 28/06/2018

AMENDED

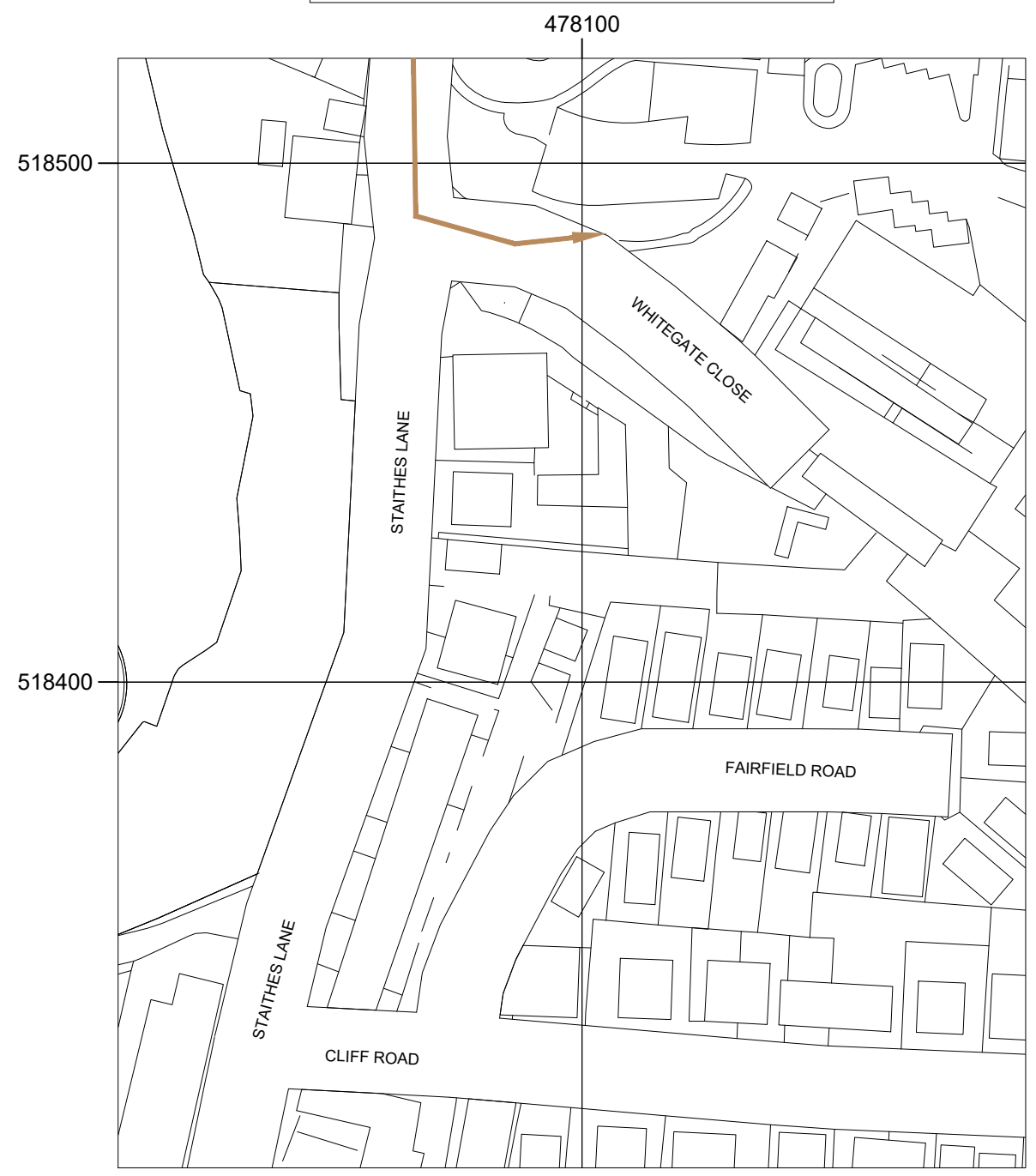

SITE ACCESS PLAN
 SCALE 1:1250

CROWN COPYRIGHT RESERVED. MAPS REPRODUCED WITH THE PERMISSION OF THE CONTROLLER OF HM'S STATIONERY OFFICE DIGITAL MAPPING SOLUTIONS FROM ORDNANCE SURVEY © CROWN COPYRIGHT 2016 ALL RIGHTS RESERVED LICENCE NUMBER 100022432

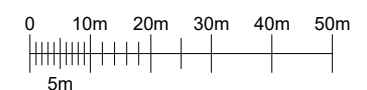

CELL No.	TS301
PROJ No	
PROJ No	
PROJ No	
1.A	WHP
1	PROJ No 206969 MASTER CREATION 10/05/18 AN JY
ISS	REVISION DATE DRN APP



Crawley Court, Winchester, Hampshire, SO21 2QA

SITE No 305711
 CSP_TS301
 SW OFF WHITEGATE CLOSE
 VERGE AT APPROACH TO STAITHE
 SALT BURN BY THE SEA
 NORTH YORKSHIRE
 TS13 5AD

NGR NZ 78106 18487
 OS GRID 478106 518487

TITLE
 LOCATION PLAN

SCALE	AS SHOWN
DRAWN	AN 04/05/18
APPROVED	JY 10/05/18

DRG No. Sheet 1 of 1 Rev
 305711-00-004-MD001 1.A



NOTES

AMENDED

NYMNP
 28/06/2018

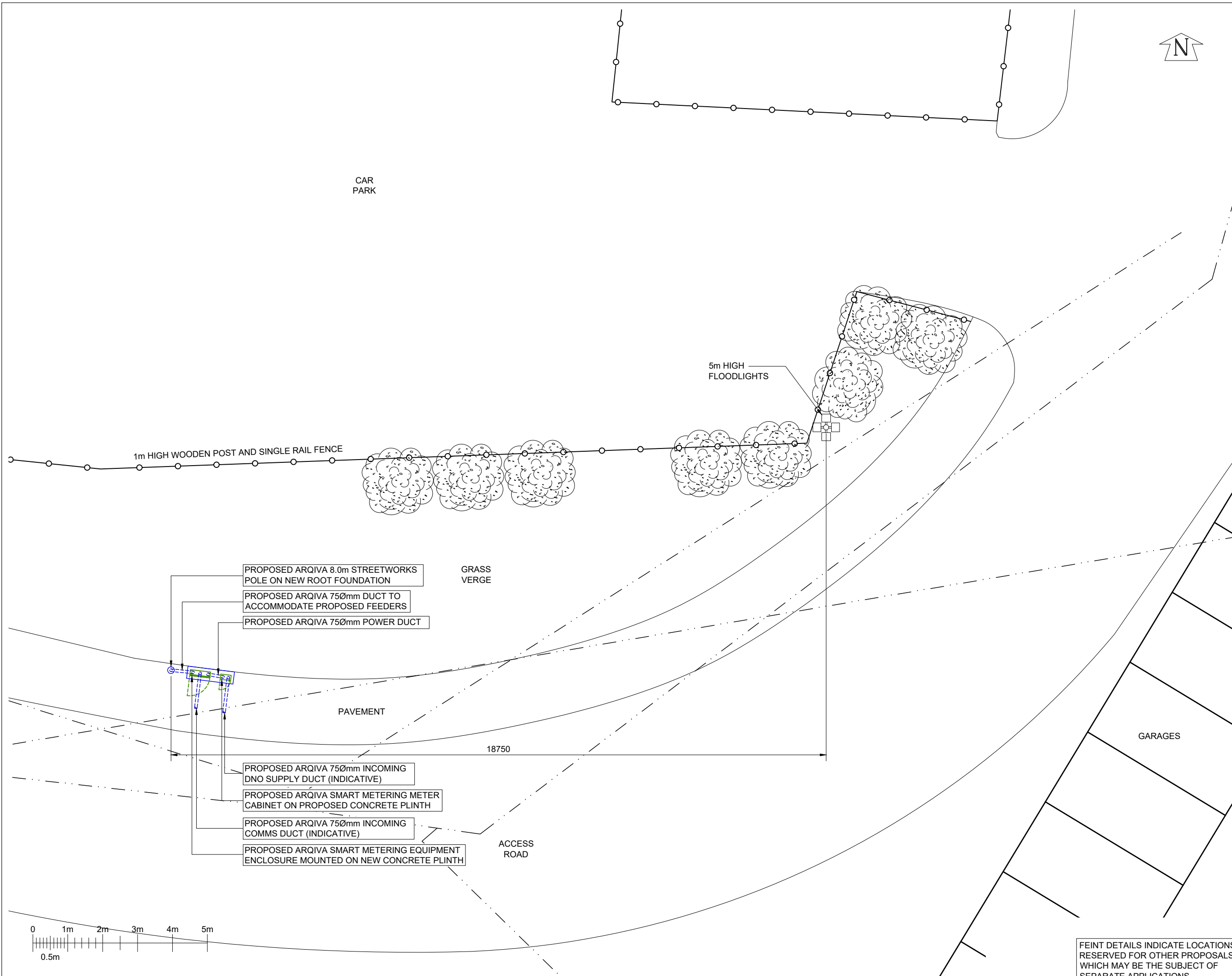

CELL No.	TS301
PROJ No	
PROJ No	
PROJ No	
PROJ No	
1.A	WHP
1	PROJ No 206969 MASTER CREATION 10/05/18 AN JY
ISS	REVISION DATE DRN APP



Crawley Court, Winchester, Hampshire, SO21 2QA

SITE No 305711
 CSP_TS301
 SW OFF WHITEGATE CLOSE
 VERGE AT APPROACH TO STAINES
 SALT BURN BY THE SEA
 NORTH YORKSHIRE
 TS13 5AD
 NGR NZ 78106 18487
 OS GRID 478106 518487

TITLE	SITE PLAN PROPOSED ARQIVA	
SCALE	1:100	
DRAWN	AN	04/05/18
APPROVED	JY	10/05/18
DRG No.	Sheet 1 of 1	Rev
305711-01-100-MD001	1.A	

FEINT DETAILS INDICATE LOCATIONS RESERVED FOR OTHER PROPOSALS WHICH MAY BE THE SUBJECT OF SEPARATE APPLICATIONS

NOTES

AMENDED

NYMNP

28/06/2018

CELL No. TS301

PROJ No			
PROJ No			
PROJ No			
PROJ No			
1.A			WHP
1	PROJ No 206969 MASTER CREATION	10/05/18	AN JY
ISS	REVISION	DATE	DRN APP



Crawley Court, Winchester, Hampshire, SO21 2QA

SITE No 305711
 CSP_TS301
 SW OFF WHITEGATE CLOSE
 VERGE AT APPROACH TO STAINES
 SALT BURN BY THE SEA
 NORTH YORKSHIRE
 TS13 5AD

NGR NZ 78106 18487

OS GRID 478106 518487

TITLE
 EQUIPMENT LAYOUT
 PROPOSED
 ARQIVA

SCALE 1:25

DRAWN AN 04/05/18

APPROVED JY 10/05/18

DRG No. Sheet 1 of 1 Rev

305711-01-101-MD001 1.A

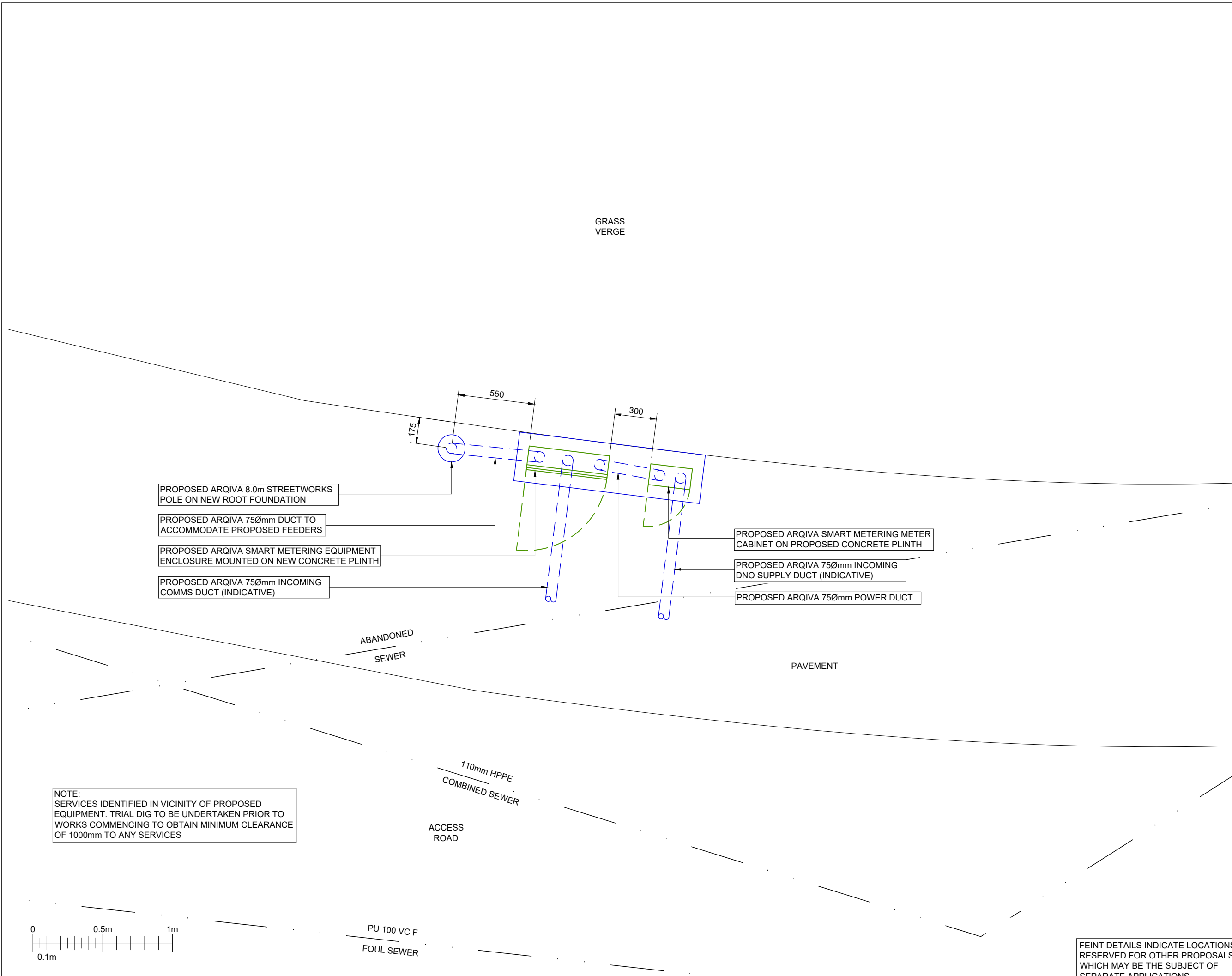

NOTE:
 SERVICES IDENTIFIED IN VICINITY OF PROPOSED EQUIPMENT. TRIAL DIG TO BE UNDERTAKEN PRIOR TO WORKS COMMENCING TO OBTAIN MINIMUM CLEARANCE OF 1000mm TO ANY SERVICES



FEINT DETAILS INDICATE LOCATIONS RESERVED FOR OTHER PROPOSALS WHICH MAY BE THE SUBJECT OF SEPARATE APPLICATIONS

PROPOSED ANTENNA DETAILS

I.D. No.	ITEM	TYPE / SIZE	BEARING	MEAN HEIGHT	ELEC TILT	FUNC.	FEEDER LENGTH	FEEDER TYPE	LNA/MHA	No. OF FEEDERS	RET/VET
TBC	A1	SKYMAST SC3B-460	OMNI	9.15m	0°	Tx/Rx	11.0m	LCF12-50	0	1	NO
N/A	A2	TRIMBLE BULLET III GPS	0° E.T.N.	8.3m	N/A	Tx/Rx	11.0m	CNT400	0	1	NO
N/A	A3	SIRO SO-918-2	OMNI	7.6m	N/A	Tx/Rx	10.0m	CNT400	0	1	NO

©2010 Arqiva
 All rights reserved. No part of this publication may be reproduced, stored in a retrieval system or transmitted in any form or by any means (Electronic, Mechanical, Photocopying, Recording or otherwise), without the prior written consent of the Company.

NOTES

AMENDED

NYMNPA
 28/06/2018

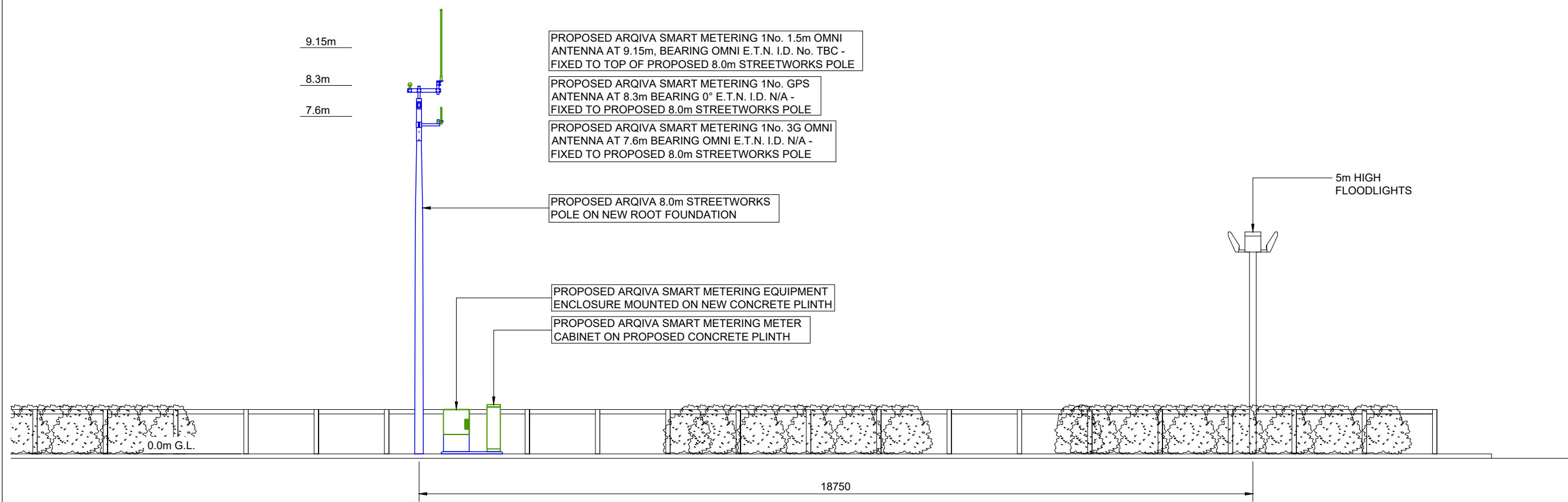

PROPOSED ARQIVA SMART METERING 1No. 1.5m OMNI ANTENNA AT 9.15m, BEARING OMNI E.T.N. I.D. No. TBC - FIXED TO TOP OF PROPOSED 8.0m STREETWORKS POLE

PROPOSED ARQIVA SMART METERING 1No. GPS ANTENNA AT 8.3m BEARING 0° E.T.N. I.D. N/A - FIXED TO PROPOSED 8.0m STREETWORKS POLE

PROPOSED ARQIVA SMART METERING 1No. 3G OMNI ANTENNA AT 7.6m BEARING OMNI E.T.N. I.D. N/A - FIXED TO PROPOSED 8.0m STREETWORKS POLE

PROPOSED ARQIVA 8.0m STREETWORKS POLE ON NEW ROOT FOUNDATION

PROPOSED ARQIVA SMART METERING EQUIPMENT ENCLOSURE MOUNTED ON NEW CONCRETE PLINTH

PROPOSED ARQIVA SMART METERING METER CABINET ON PROPOSED CONCRETE PLINTH

5m HIGH FLOODLIGHTS

18750

0.0m G.L.

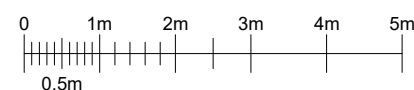

SOUTH ELEVATION

CELL No.	TS301
PROJ No	
PROJ No	
PROJ No	
PROJ No	
1.A	WHP
1	PROJ No 206969 MASTER CREATION 10/05/18 AN JY
ISS	REVISION DATE DRN APP



Crawley Court, Winchester, Hampshire, SO21 2QA

SITE No 305711
 CSP_TS301
 SW OFF WHITEGATE CLOSE
 VERGE AT APPROACH TO STAINES
 SALTBYRN BY THE SEA
 NORTH YORKSHIRE
 TS13 5AD

NGR NZ 78106 18487
 OS GRID 478106 518487

TITLE
 ELEVATION - SOUTH
 PROPOSED
 ARQIVA

SCALE 1:100

DRAWN AN 04/05/18
 APPROVED JY 10/05/18

FEINT DETAILS INDICATE LOCATIONS RESERVED FOR OTHER PROPOSALS WHICH MAY BE THE SUBJECT OF SEPARATE APPLICATIONS

DRG No. 305711-01-150-MD001
 Sheet 1 of 1 Rev 1.A