

- General Notes**
- 1 - Do not scale from this drawing
 - 2 - All dimensions quoted are in millimetres unless noted otherwise.
 - 3 - All levels quoted are in metres above datum level.
 - 4 - All setting out and levels to be finalised at site stage to suit existing structures.
 - 5 - This drawing shall be read in conjunction with all other specialists drawings and specifications.
 - 6 - The location of all services shall be identified prior to excavation or construction works and all appropriate measures taken to avoid damage to the same.
 - 7 - The contractor is to comply with all relevant health and safety legislation to safeguard work force, the general public and all other parties.

- Temporary Works**
- 1 - The main contractor shall be responsible for all temporary works. A specialist subcontractor shall be appointed to design and install temporary works to adequately support all applied loads.
 - 2 - The contractor shall take all appropriate measures to avoid causing instability or damage to adjacent structures, surfaces, finishes etc.

- Private Drainage**
- 1 - Existing sewer levels to be checked on site before laying any pipework.
 - 2 - All pipework to be installed in accordance with building regs part H.
 - 3 - All pipework to be 100mm Hepworth Plastidrain or similar approved.
 - 4 - Pipework downstream of demarcation chambers to be Hepworth clay Housetrain or similar approved.
 - 5 - All pipework shall pass an air test in accordance with part H of the building regs (2.60).
 - 6 - All pipework shall be laid to gradients deduced from the manhole invert levels provided.
 - 7 - All pipework is 100mm Ø unless stated otherwise.
 - 8 - Pipework to have a min. 100mm granular bed and surround.
 - 9 - Min. gradients of foul pipes are 1 in 80 for 100mm and 1 in 150 for 150mm.
 - 10 - Min. gradients of SW pipes are 1 in 100 for 100mm and 1 in 150 for 150mm.
 - 11 - All private drives to have porous surfaces where shown. Front roof drainage to discharge to porous drives sub-base via silt traps.
 - 12 - Soakaways to be located a min. of 5.0m from building foundations and 2.0m from the carriageway. Where not possible distance to be maximised and structural advice sought.
 - 13 - No surface water from private drives shall discharge onto the highway.
 - 14 - All inspection chambers shall be Hepworth polypropylene (PPIC) or similar approved.

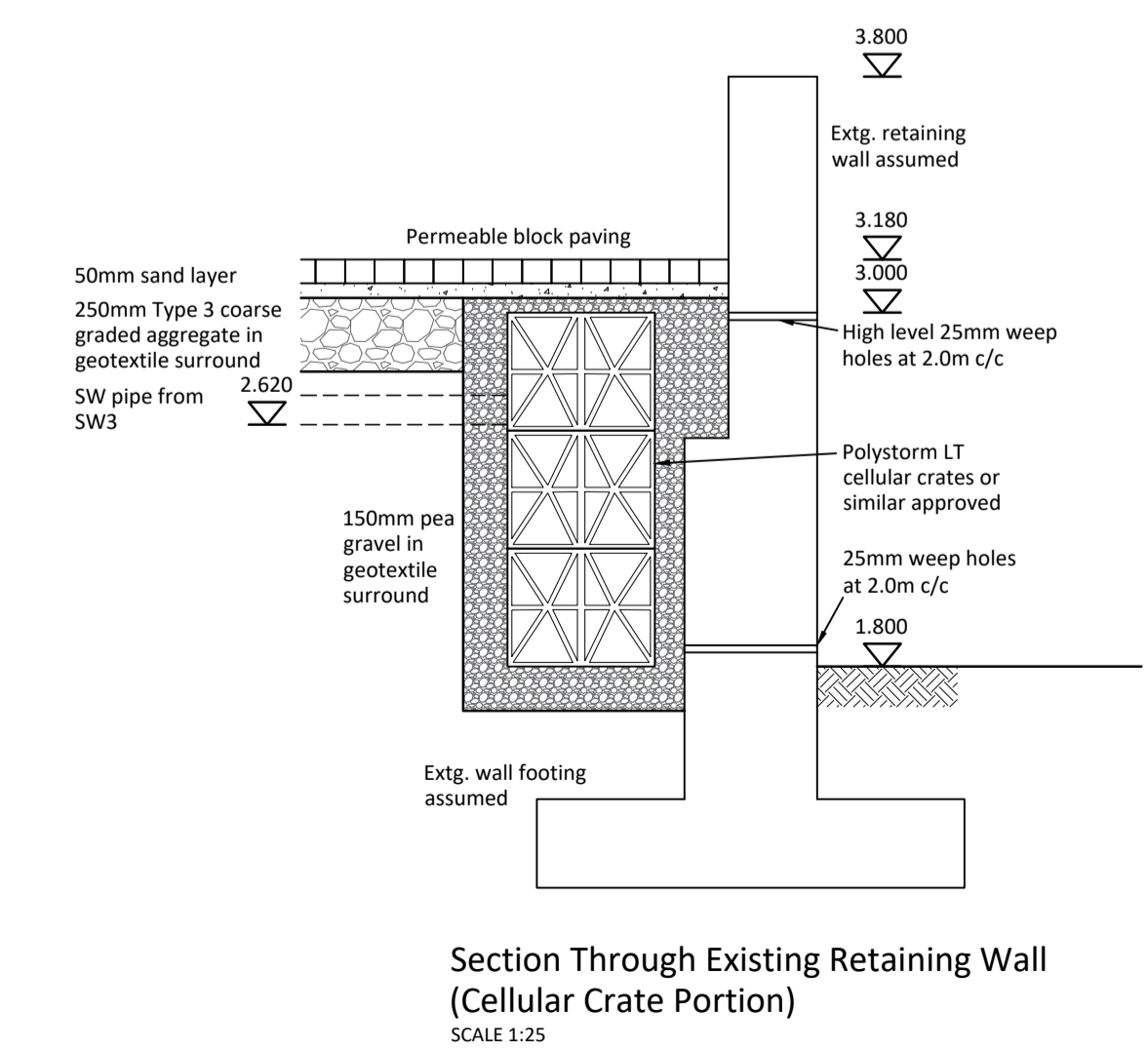
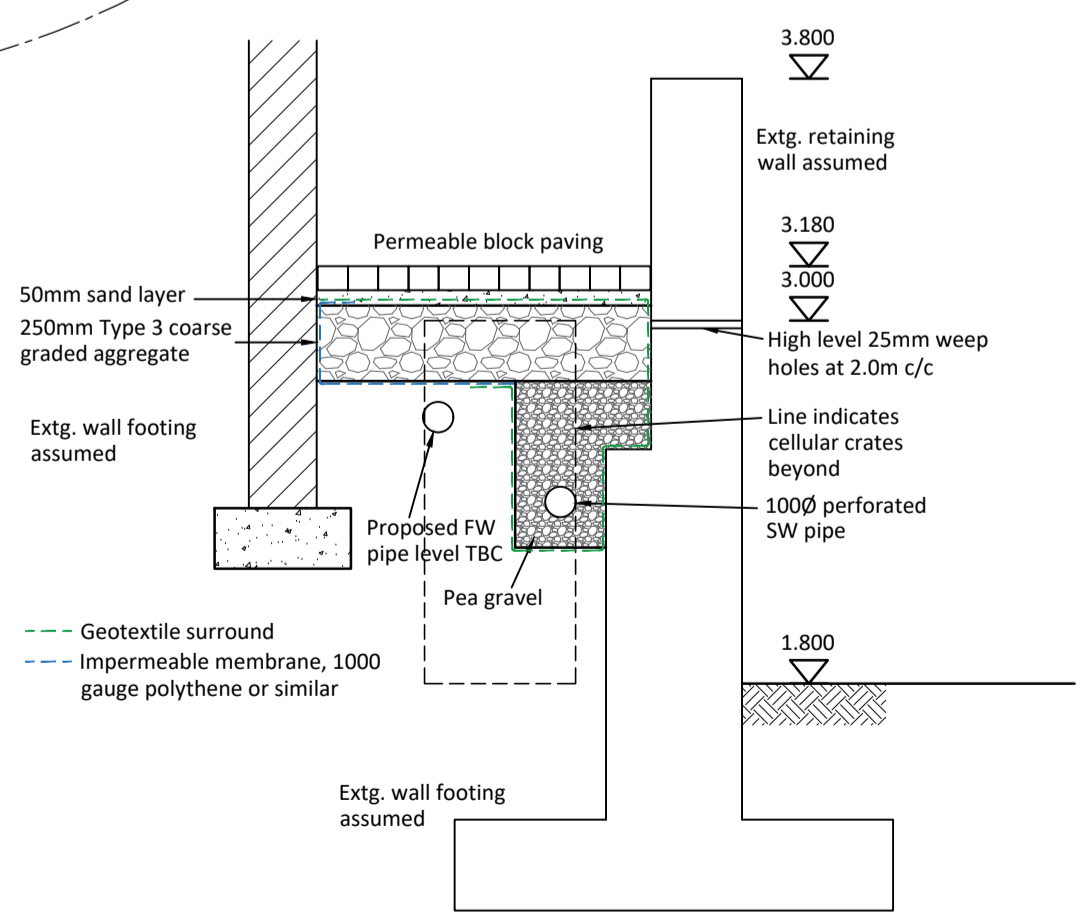
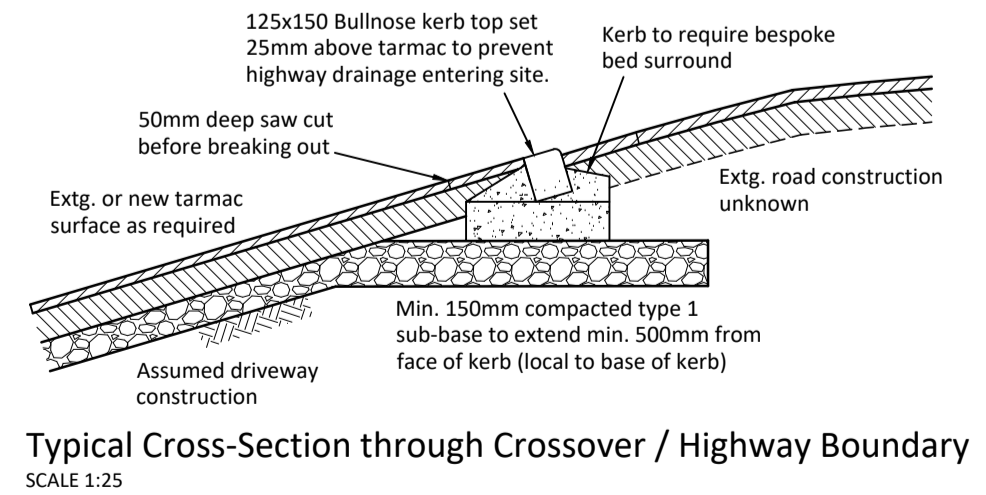
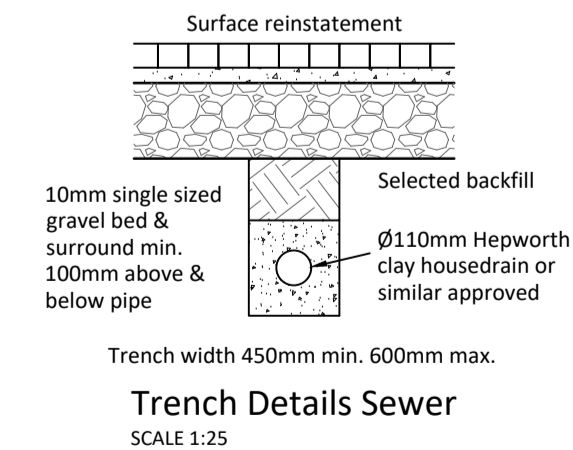
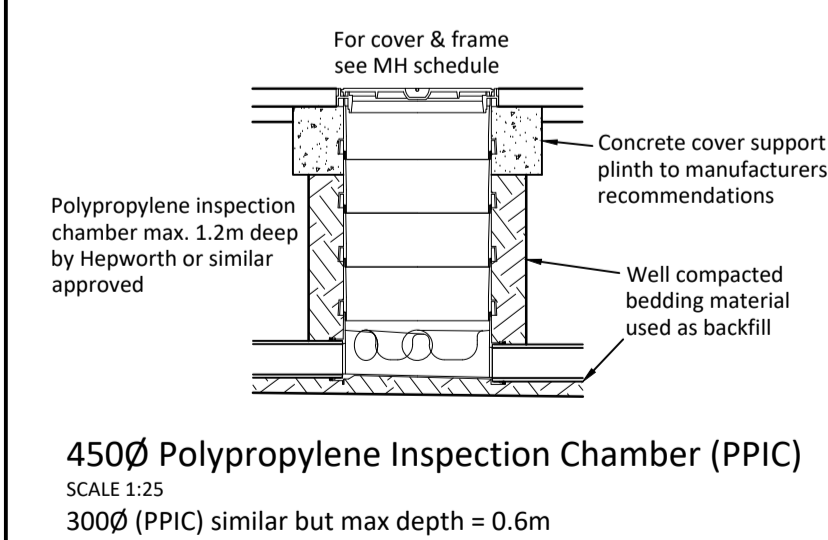
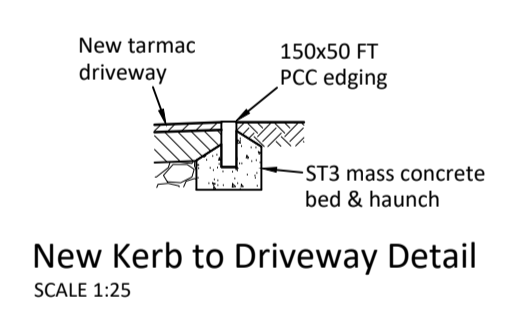
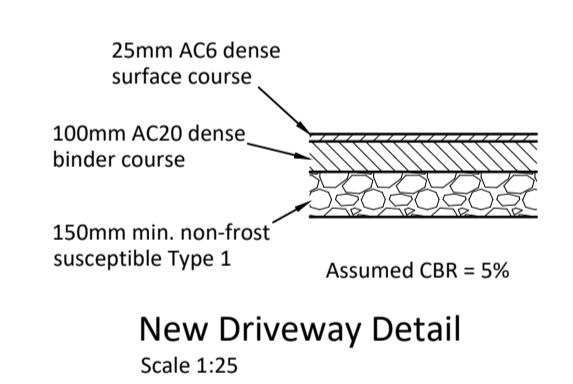
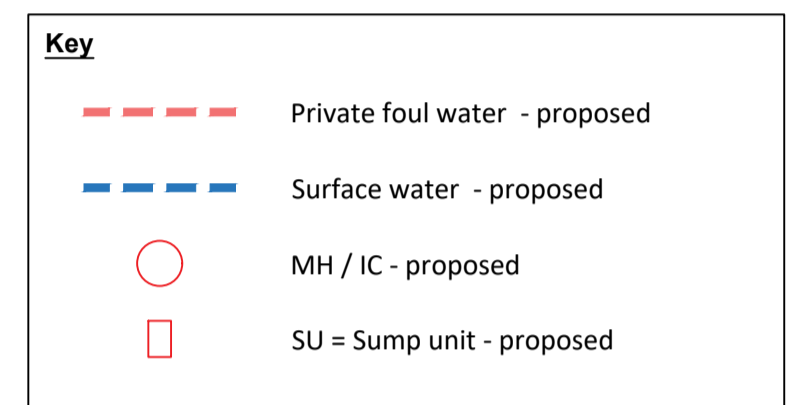

Revision	Details	Date

Steve Gilman Design Ltd
CONSULTING STRUCTURAL ENGINEERS
Lych Gate Barn, Church Lane
Carlton Le Moorland, Lincoln, LN5 9HS

Project Proposed Alterations
21 Egton Road
Aislaby
Whitby

Client Mr & Mrs D. Catley

Title Proposed Site Drainage Alterations

Date	November 2018	Scale	1:100
Number	5126/10	Status	Preliminary