

NYMNP

07/01/2019

From: Mick Paxton

Sent: 07 January 2019 16:15

To: Harriet Frank

Subject: Re: New application post - NYM/2018/0736/CVC - Horseshoe Cottage, Newlands Lane, Cloughton
- Building cons

hi harriet - happy new year to you - and like you thought I had returned the revised drawing but just in case have attached it for you - thanks - regards mick

The windows are draught sealed with gaskets.

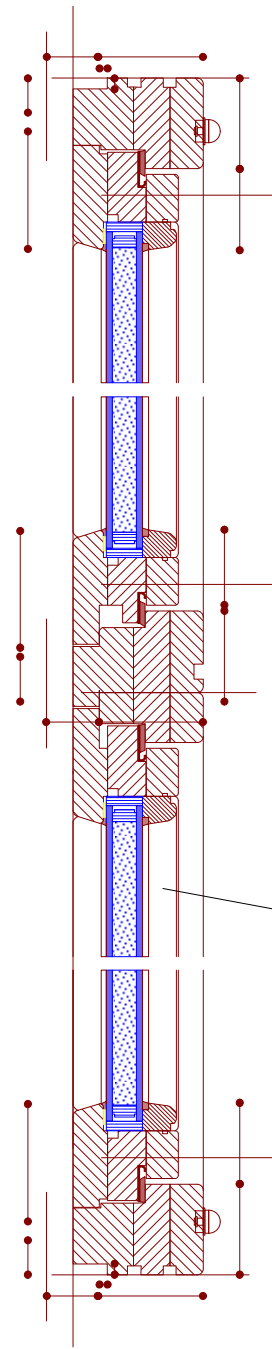

vertical section
scale 1 : 5

The windows are draught-sealed with gaskets.

proposed double glazed units to be a 4:16:4 (24mm) argon gas filled unit with softcoat low emissivity (Low E) glass on the inside leaf, giving a glass U value of 1.2. The type of egde spacer used within the unit to be warmedge spacer bars.

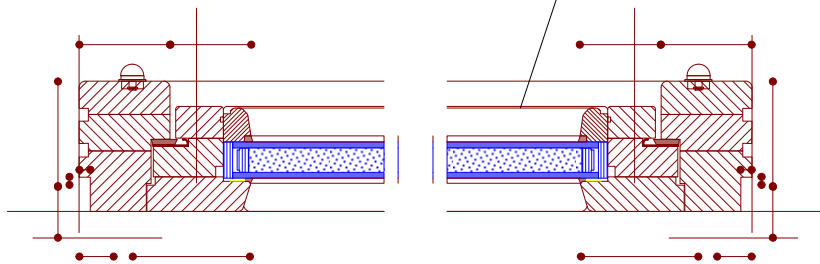

horizontal section
scale 1 : 5

Timber
to be treated laminated hardwood and sourced from sustainable sources only and in compliance with the terms required by the British Woodworking Federation BWF Timber Window Accreditation TWA scheme
All timber to comply with the requirements of BS EN 942 2007.

Preservation
components to be subjected to preservative treatment by double vacuum pressure impregnation The preservative to be used must meet UK Building Regulations

Glass
proposed double glazed units to be a 4:16:4 (24mm) argon gas filled unit with softcoat Saint Gobain Low-E glass on the inside leaf, giving a U value of 1.2 W/m2K. The type of egde spacer used within the unit to be warmedge type.
A toughened/laminated glass is used where necessary to comply with the Building Regulations;

Operation and Ironmongery
Side Hung operation - a casement stay and fastener with a lockable handle for an increased security
Ironmongery to be brushed stainless steel finish

The windows are draught-sealed with gaskets.

WEATHERSHIELD AQUATECH WOODSTAIN - external
DULUX TRADE PROTECTIVE WOODSHEEN - internal
Surfaces must be sound, clean and dry before treating. if necessary strip back to bare wood.
Remove and treat any mould, algae, lichen or moss with *Weathershield Multi-Surface Fungicidal Wash.
Clean the rebates and any loose or open joints.
Thoroughly rub down all surfaces in the direction of the grain to remove any grey, weathered wood and surface sheen from remaining coatings, and then dust off (refer to your COSHH Assessment).
Prime all bare wood with 1 coat of ** Weathershield Aquatech Preservative Basecoat+ (BP) including any new or bare replacement beading. Excess basecoat should be wiped off surrounding paintwork.

Mix the ** Weathershield Aquatech Preservative Basecoat+ (BP) thoroughly by shaking the container. Pour out a sufficient amount of primer for the job into a suitable metal container. Do not use direct from the can or return any unused basecoat to the container. Do not thin.
Fill any surface defects, open joints etc. Do not use linseed oil putty for glazing (or making good) with natural wood finishes, The normal finishing process is 2 coats of Weathershield Aquatech Woodstain.
When treating timber that has been pressure impregnated with preservative ensure that the surface is completely dry.
The use of silicone sealants can cause "cissing" of this product. Do not use on resinous wood or woodwork with a history of blistering. The maximum benefits of this system will only be realised when used as directed above on good quality timber that conforms to BS942: 2007 (or as amended), in conjunction with good component design.