

.....
 This Drawing is an instrument of service and shall remain the property of Align Property Partners Ltd copyright ©. It may not be reproduced or copied in any form. It shall not be used for the construction, enlargement or alteration of a building or area other than the said project without the authorisation of the issuing office.
 Contractors shall verify and be responsible for all dimensions and conditions and shall report any discrepancies to the issuing office before proceeding with any work. Drawings shall not be scaled.

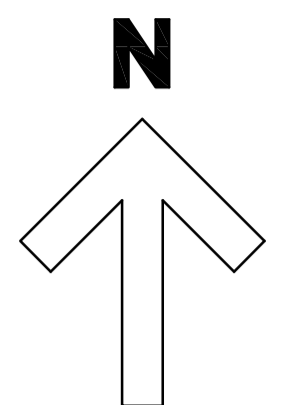

NOTES...

READ IN CONJUNCTION WITH THE FOLLOWING ATTACHED DRAWING.

DWG No. FSH.AWP.ZZ.XX.DR.C.3001 P1 - Existing Drainage Works

DWG No. FSH.AWP.ZZ.XX.DR.C.3000 P2 - Proposed Drainage Layout

DWG No. 17043 015 XRef 002 P1 Block Plan, Existing and Proposed

NYMNPA
06/02/2019

P4	Planning Application	KRB	RA	DJS
Ver.	Details	Author & Date	Checked & Date	Approved & Date
P1	Pre-planning application enquiry	KRB	RA	DJS
Ver.	Details	Author & Date	Checked & Date	Approved & Date



Mount View, Standard Way, Northallerton, North Yorkshire, DL6 2YD Tel: _____

Client: NORTH YORKSHIRE COUNTY COUNCIL

Project name: Hackness Community VC Primary School Proposed New Sewage Treatment Plant

Drawing Title: OS location plan

Purpose: Planning Application

Scale	Drawn	Checked	Approved
1:1250	KRB	RA	DJS
Original Size	Date	Date	Date
A1	16/08/2018	16/08/2018	16/08/2018

Drawing Number: _____
 Drawing no. 17043 015 Xref 001

Ver: P4

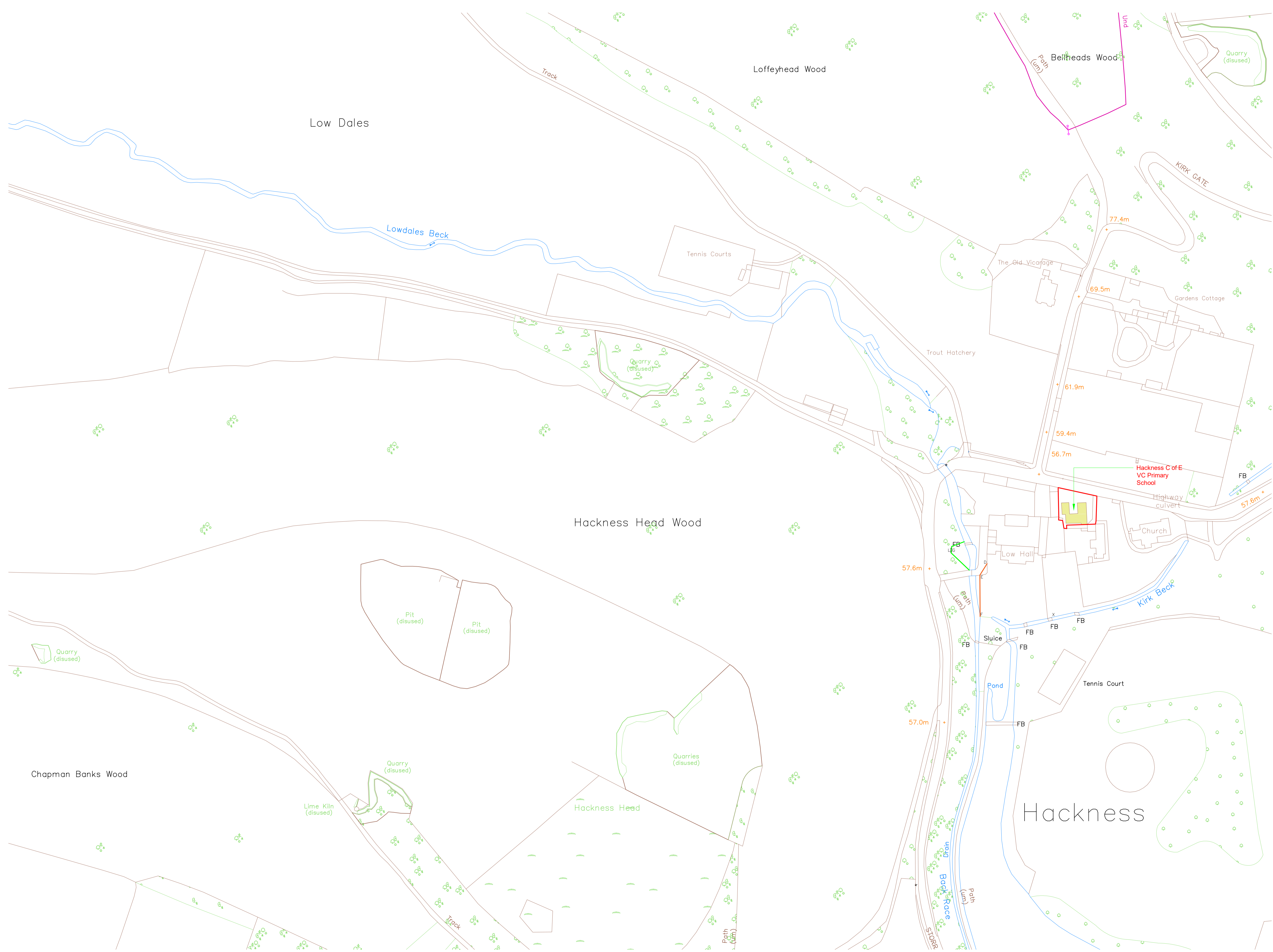

Reproduction from the Ordnance Survey Map with the permission of the controller of Her Majesty's Stationery Office. Crown copyright reserved. Licence No. AL 100017329

This Drawing is an instrument of service and shall remain the property of Align Property Partners Ltd copyright ©. It may not be reproduced or copied in any form. It shall not be used for the construction, enlargement or alteration of a building or area other than the said project without the authorisation of the issuing office.
Contractors shall verify and be responsible for all dimensions and conditions and shall report any discrepancies to the issuing office before proceeding with any work. Drawings shall not be scaled.

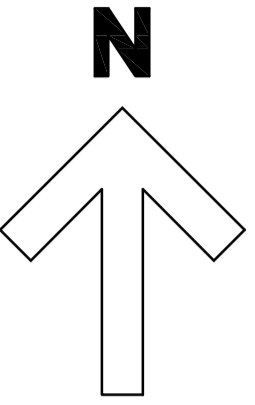

Highway and drainage culvert

Highway and drainage culvert

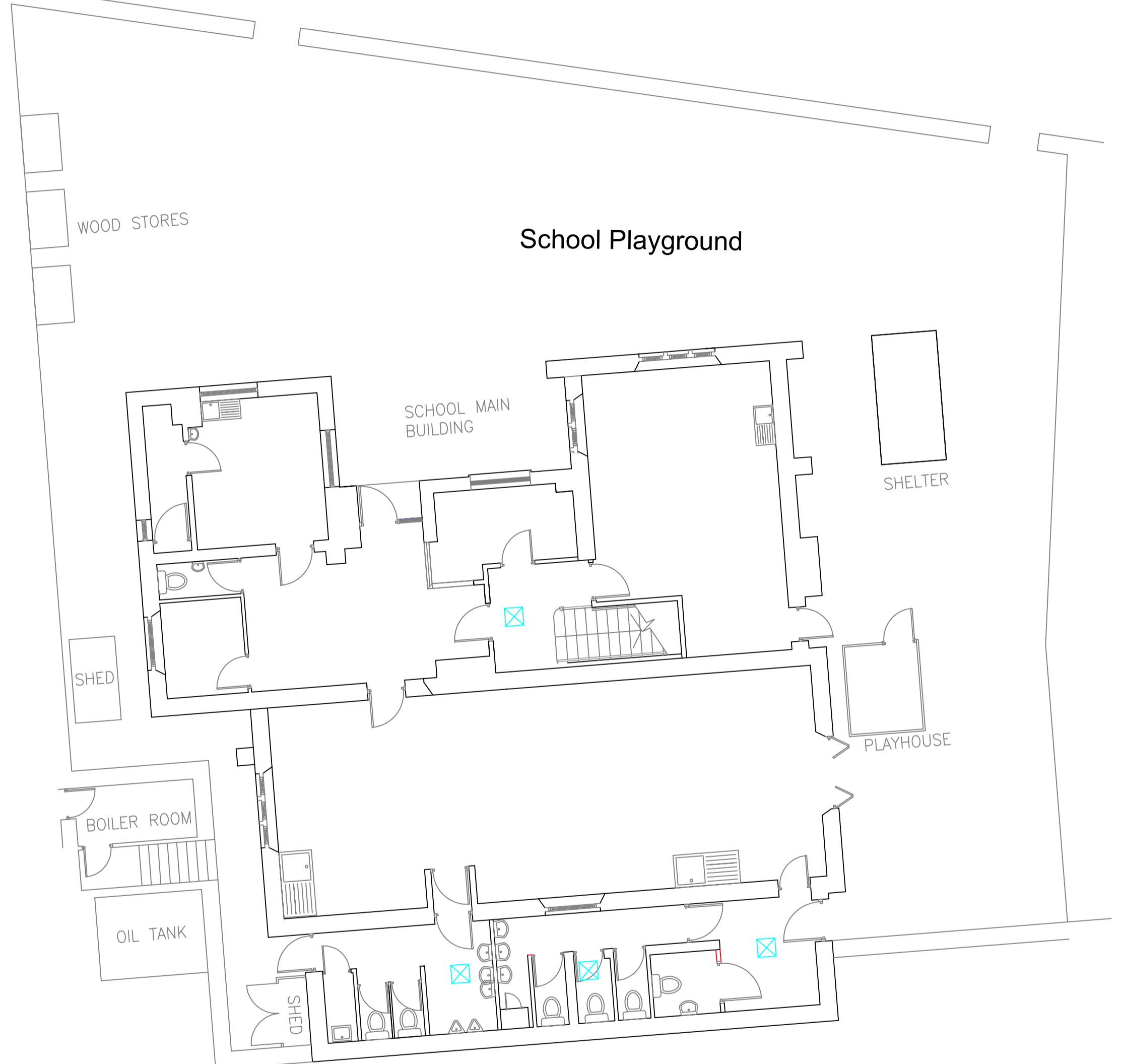

GROUND FLOOR PLAN AS EXISTING
Scale 1:100



GROUND FLOOR PLAN AS PROPOSED
Scale 1:100

NOTES...
READ IN CONJUNCTION WITH THE FOLLOWING ATTACHED DRAWINGS...
DWG No. 17043 015 XRef 001 OD Location Plan
DWG No. FSH.AWP.ZZ.XX.C.3001 P1 Existing Drainage Works
DWG No. FSH.AWP.ZZ.XX.C.3000 P2 Proposed Drainage Layout

NYMNPA
06/02/2019

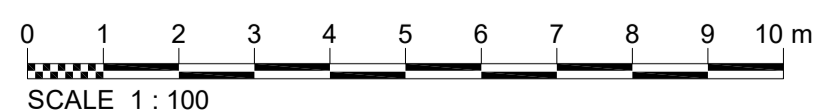

P1	Planning	KRB	RA	DJS
Ver.	Details	Author & Date	Checked & Date	Approv. & Date
		29.1.19	29.1.19	29.1.19

align PROPERTY PARTNERS
Mount View, Standard Way, Northallerton, North Yorkshire, DL6 2YD Tel: [redacted]

Client: North Yorkshire County Council
Project name: Hackness Community VC Primary School Proposed New Sewage Treatment plant
Drawing Title: Block Plan Existing and Proposed
Purpose: Planning Application

Scale	Drawn	Checked	Approved
1:100	KRB	RA	DJS
Original Size	Date	Date	Date
A1	29/01/2019	29/01/2019	RA
Drawing Number	Version		
Drawing no. 17043 015 XRef 002	P1		

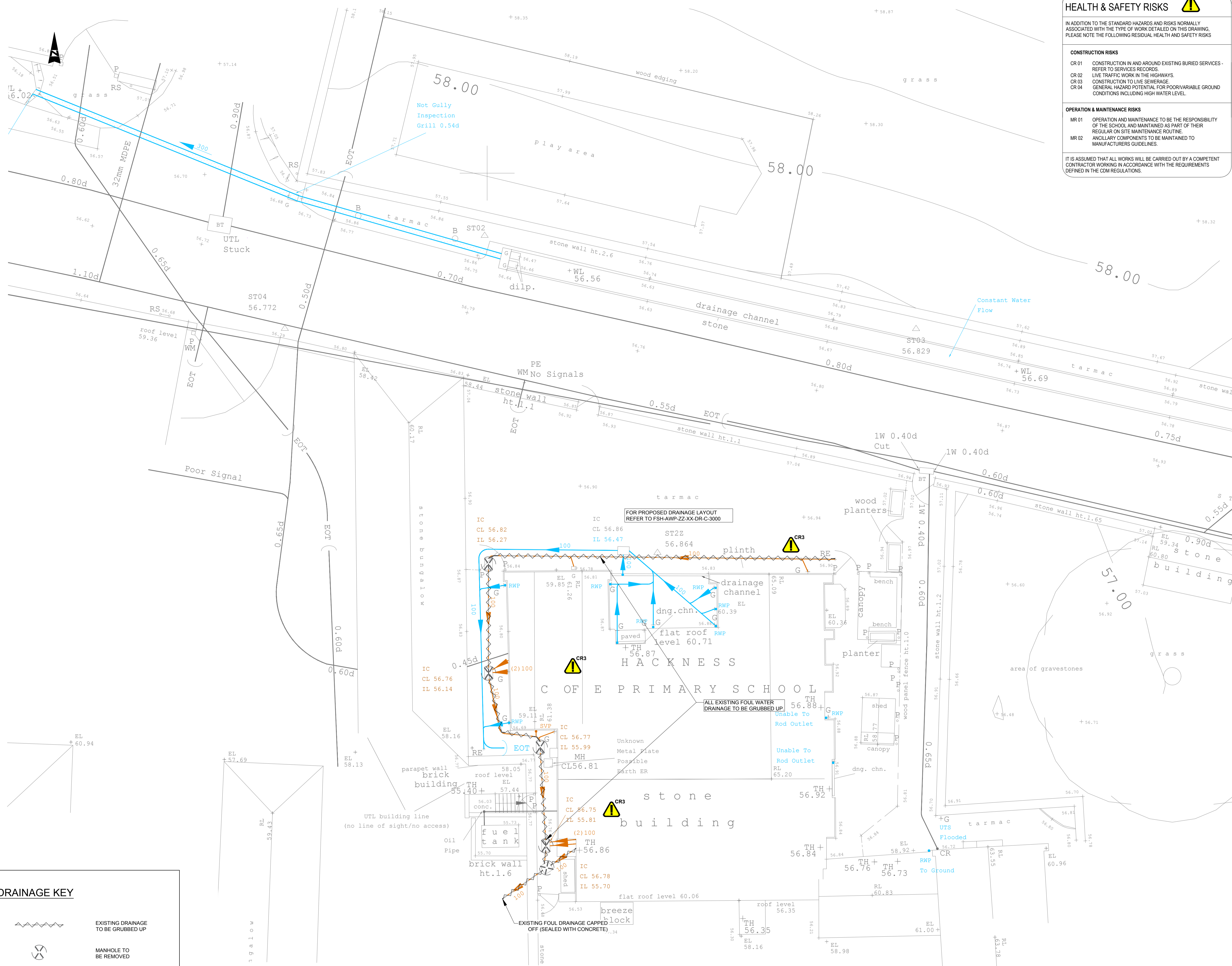

HEALTH & SAFETY RISKS

IN ADDITION TO THE STANDARD HAZARDS AND RISKS NORMALLY ASSOCIATED WITH THE TYPE OF WORK DETAILED ON THIS DRAWING, PLEASE NOTE THE FOLLOWING RESIDUAL HEALTH AND SAFETY RISKS

CONSTRUCTION RISKS

- CR 01 CONSTRUCTION IN AND AROUND EXISTING BURIED SERVICES - REFER TO SERVICES RECORDS.
- CR 02 LIVE TRAFFIC WORK IN THE HIGHWAYS.
- CR 03 CONSTRUCTION TO LIVE SEWERAGE.
- CR 04 GENERAL HAZARD POTENTIAL FOR POOR/VARIABLE GROUND CONDITIONS INCLUDING HIGH WATER LEVEL.

OPERATION & MAINTENANCE RISKS

- MR 01 OPERATION AND MAINTENANCE TO BE THE RESPONSIBILITY OF THE SCHOOL AND MAINTAINED AS PART OF THEIR REGULAR ON SITE MAINTENANCE ROUTINE.
- MR 02 ANCILLARY COMPONENTS TO BE MAINTAINED TO MANUFACTURERS GUIDELINES.

IT IS ASSUMED THAT ALL WORKS WILL BE CARRIED OUT BY A COMPETENT CONTRACTOR WORKING IN ACCORDANCE WITH THE REQUIREMENTS DEFINED IN THE COM REGULATIONS.

- NOTES:**
- THESE NOTES ARE INTENDED TO AUGMENT DRAWINGS AND SPECIFICATIONS. WHERE CONFLICT OF REQUIREMENTS EXIST THE ORDER OF PRECEDENCE SHALL BE AS SHOWN IN THE SPECIFICATION, OTHERWISE THE STRICTEST PROVISION SHALL GOVERN.
 - THIS DRAWING IS TO BE READ IN CONJUNCTION WITH ALL OTHER RELEVANT ENGINEERS AND ARCHITECTS DRAWINGS.
 - DRAWINGS NOT TO BE SCALED. ALL DIMENSIONS TO BE CHECKED ON SITE BY THE CONTRACTOR. ANY DISCREPANCIES TO BE NOTIFIED TO THE ENGINEER AND FURTHER INSTRUCTIONS OBTAINED BEFORE WORK IS COMMENCED.
 - THE STRUCTURE IS DESIGNED TO BE SELF-SUPPORTING AND STABLE AFTER THE BUILDING IS FULLY COMPLETED. IT IS THE CONTRACTOR'S SOLE RESPONSIBILITY TO DETERMINE THE ERECTION PROCEDURE AND SEQUENCE AND ENSURE THAT THE BUILDING AND ITS COMPONENTS ARE SAFE DURING ERECTION. THIS INCLUDES THE ADDITION OF WHATEVER TEMPORARY BRACING, GUYS OR TIE-DOWNS WHICH MAY BE NECESSARY. SUCH MATERIAL REMAINING THE PROPERTY OF THE CONTRACTOR ON COMPLETION, AND FOR ENSURING THAT THE WORKS AND ANY ADJACENT PROPERTIES ARE SAFE IN THE TEMPORARY CONDITION.

NYMNP
06/02/2019

P1	FIRST ISSUE	24.10.18	LV	TW	JAG
Rev	Description	Date	By	Chk	App

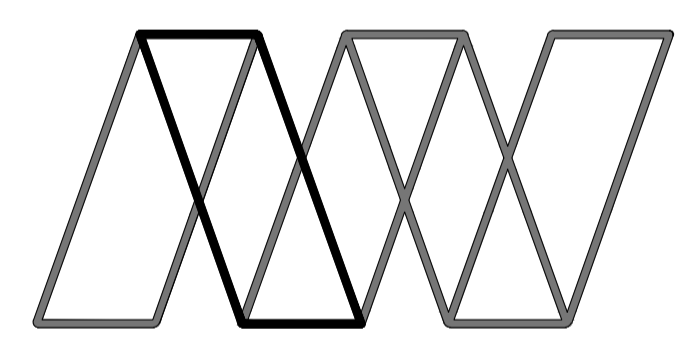

Alan Wood & Partners

Hull Office
341 Beverley Road
Hull
HU5 1LD

Consulting Civil & Structural Engineers
Project Managers
Building Surveyors

Project: **Feasibility Study at Hackness CE School, Scarborough**

Client: **Align Property Partners Ltd**

Drawing: **Existing Drainage Works**

Role: **Civil Engineer**
Drawing Status: **WORK IN PROGRESS**

Job no: **40836** Scale@A1: **As Noted** Rev: **P1**

Project Originator Volume Level Type Role Number
FSH - AWP - ZZ - XX - DR - C - 3001

DRAINAGE KEY

- EXISTING DRAINAGE TO BE GRUBBED UP
- MANHOLE TO BE REMOVED

SITE LAYOUT - EXISTING ABANDONED DRAINAGE
SCALE 1:100

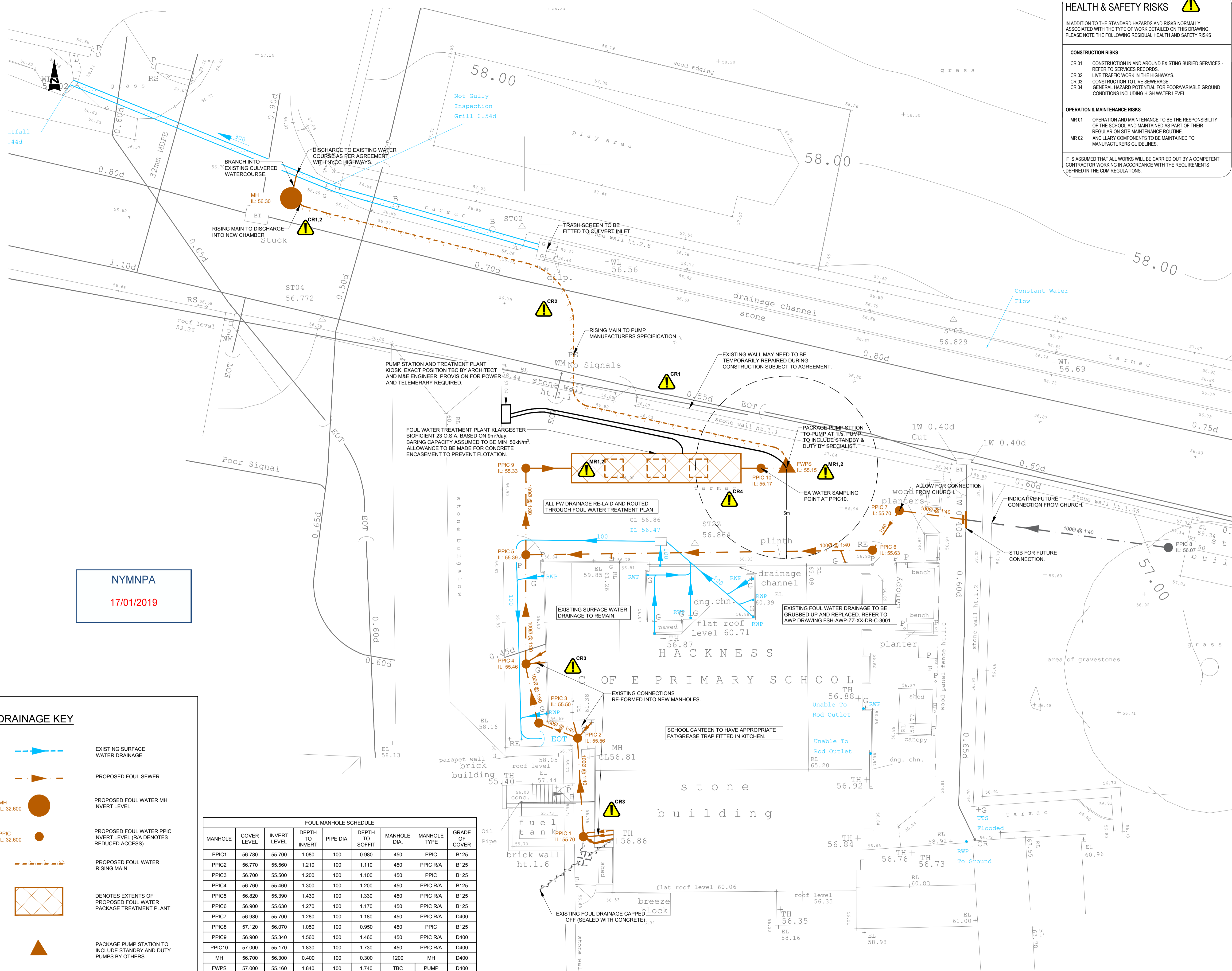

NYMNP
17/01/2019

DRAINAGE KEY

- EXISTING SURFACE WATER DRAINAGE
- PROPOSED FOUL SEWER
- PROPOSED FOUL WATER MH INVERT LEVEL
- PROPOSED FOUL WATER PPIC INVERT LEVEL (RA DENOTES REDUCED ACCESS)
- PROPOSED FOUL WATER RISING MAIN
- DENOTES EXTENTS OF PROPOSED FOUL WATER PACKAGE TREATMENT PLANT
- PACKAGE PUMP STATION TO INCLUDE STANDBY AND DUTY PUMPS BY OTHERS

FOUL MANHOLE SCHEDULE

MANHOLE	COVER LEVEL	INVERT LEVEL	DEPTH TO INVERT	PIPE DIA.	DEPTH TO SOFFIT	MANHOLE DIA.	MANHOLE TYPE	GRADE OF COVER
PPIC1	56.780	55.700	1.080	100	0.980	450	PPIC	B125
PPIC2	56.770	55.560	1.210	100	1.110	450	PPIC R/A	B125
PPIC3	56.700	55.500	1.200	100	1.100	450	PPIC	B125
PPIC4	56.760	55.460	1.300	100	1.200	450	PPIC R/A	B125
PPIC5	56.820	55.390	1.430	100	1.330	450	PPIC R/A	B125
PPIC6	56.900	55.630	1.270	100	1.170	450	PPIC R/A	B125
PPIC7	56.980	55.700	1.280	100	1.180	450	PPIC R/A	D400
PPIC8	57.120	56.070	1.050	100	0.950	450	PPIC	B125
PPIC9	56.900	55.340	1.560	100	1.460	450	PPIC R/A	D400
PPIC10	57.000	55.170	1.830	100	1.730	450	PPIC R/A	D400
MH	56.700	56.300	0.400	100	0.300	1200	MH	D400
FWPS	57.000	55.160	1.840	100	1.740	TBC	PUMP	D400

SITE LAYOUT - PROPOSED DRAINAGE
SCALE 1:100

HEALTH & SAFETY RISKS

IN ADDITION TO THE STANDARD HAZARDS AND RISKS NORMALLY ASSOCIATED WITH THE TYPE OF WORK DETAILED ON THIS DRAWING, PLEASE NOTE THE FOLLOWING RESIDUAL HEALTH AND SAFETY RISKS

CONSTRUCTION RISKS

- CR 01 CONSTRUCTION IN AND AROUND EXISTING BURIED SERVICES
- CR 02 LIVE TRAFFIC WORK IN THE HIGHWAYS
- CR 03 CONSTRUCTION TO LIVE SEWERAGE
- CR 04 GENERAL HAZARD POTENTIAL FOR POOR/VARIABLE GROUND CONDITIONS INCLUDING HIGH WATER LEVEL

OPERATION & MAINTENANCE RISKS

- MR 01 OPERATION AND MAINTENANCE TO BE THE RESPONSIBILITY OF THE SCHOOL AND MAINTAINED AS PART OF THEIR REGULAR ON SITE MAINTENANCE ROUTINE
- MR 02 ANCILLARY COMPONENTS TO BE MAINTAINED TO MANUFACTURERS GUIDELINES

IT IS ASSUMED THAT ALL WORKS WILL BE CARRIED OUT BY A COMPETENT CONTRACTOR WORKING IN ACCORDANCE WITH THE REQUIREMENTS DEFINED IN THE CDM REGULATIONS.

- NOTES:**
- THESE NOTES ARE INTENDED TO AUGMENT DRAWINGS AND SPECIFICATIONS. WHERE CONFLICT OF REQUIREMENTS EXIST THE ORDER OF PRECEDENCE SHALL BE AS SHOWN IN THE SPECIFICATION. OTHERWISE THE STRICTEST PROVISION SHALL GOVERN.
 - THIS DRAWING IS TO BE READ IN CONJUNCTION WITH ALL OTHER RELEVANT ENGINEERS AND ARCHITECTS DRAWINGS.
 - DRAWINGS NOT TO BE SCALED. ALL DIMENSIONS TO BE CHECKED ON SITE BY THE CONTRACTOR. ANY DISCREPANCIES TO BE NOTIFIED TO THE ENGINEER AND FURTHER INSTRUCTIONS OBTAINED BEFORE WORK IS COMMENCED.
 - THE STRUCTURE IS DESIGNED TO BE SELF-SUPPORTING AND STABLE AFTER THE BUILDING IS FULLY COMPLETED. IT IS THE CONTRACTORS SOLE RESPONSIBILITY TO DETERMINE THE ERECTION PROCEDURE AND SEQUENCE AND ENSURE THAT THE BUILDING AND ITS COMPONENTS ARE SAFE DURING ERECTION. THIS INCLUDES THE ADDITION OF WHATEVER TEMPORARY BRACING, GUYS OR TIE-DOWNS WHICH MAY BE NECESSARY SUCH MATERIAL REMAINING THE PROPERTY OF THE CONTRACTOR ON COMPLETION, AND FOR ENSURING THAT THE WORKS AND ANY ADJACENT PROPERTIES ARE SAFE IN THE TEMPORARY CONDITION.
- PRIVATE DRAINAGE NOTES:**
- DRAINAGE SYSTEMS TO COMPLY WITH THE FOLLOWING STANDARDS:
 - BS EN 752:2008
 - BUILDING REGULATIONS APPROVED DOCUMENT PART H, 2015 EDITION
 - ALL COMPONENTS USED IN DRAINAGE SYSTEMS TO COMPLY WITH THE FOLLOWING: BS EN 476:2011
 - ALL DRAINAGE SYSTEMS AND COMPONENTS TO BE CONSTRUCTED AND TESTED TO THE FULL SATISFACTION OF BOTH BUILDING REGULATIONS AND WARRANTY PROVIDER INSPECTORS
 - ALL DRAINAGE TO BE CONSTRUCTED AND TESTED IN ACCORDANCE WITH BS EN 1810:2015.
 - V.C. DENOTES VITRIFIED CLAY. VITRIFIED CLAY PIPES AND FITTINGS TO COMPLY WITH THE RELEVANT PROVISIONS OF BS EN 124-1 TO 6:2015. MANHOLE COVERS AND FRAMES TO BE OF A NON-ROCKING DESIGN WITH CUSHION INSERTS AND BE KITEMARKED. ALL PIPES SHALL BE EXTRA STRENGTH TO BS 65 OR EQUIVALENT BS EN295 PIPE CRUSHING STRENGTH.
 - LATERAL DRAIN CONNECTIONS (PIPES CONNECTING INTO ADAPTABLE SEWERS) TO BE VITRIFIED CLAY. WHERE COVER IS LESS THAN 1.2m TO GROUND LEVEL PIPE PROTECTION IS REQUIRED IN THE FORM OF A CONCRETE COVER SLAB.
 - PVC-U DENOTES UNPLASTICISED POLYVINYL CHLORIDE. PVC-U PIPES AND FITTINGS TO COMPLY WITH THE RELEVANT PROVISIONS OF BS EN1401, BS EN13476-2 AND BS4660:1989/2000 RESPECTIVELY AND BE KITEMARKED.
 - PRECAST CONCRETE MANHOLES TO BE IN ACCORDANCE WITH BS EN 1917:2002 AND BS 5911-3:2010. 42002 AND TO BE KITEMARKED. PRECAST CONCRETE RINGS AND COVER SLABS TO CONCRETE PIPES TO BE JOINED WITH CEMENT MORTAR UNLESS NOTED OTHERWISE.
 - INSITU AND PRECAST CONCRETE UNITS SHALL HAVE SULPHATE RESISTING PORTLAND CEMENT TO BS EN 197-1:2011.
 - POLYPROPYLENE INSPECTION CHAMBERS TO COMPLY WITH BS EN 13598-1:2010, 2:2016 AND BS 7158:2001 AND TO BE KITEMARKED.
 - MANHOLE COVERS AND FRAMES SHALL COMPLY WITH THE RELEVANT PROVISIONS OF BS EN 124-1 TO 6:2015. MANHOLE COVERS AND FRAMES TO BE OF A NON-ROCKING DESIGN WITH CUSHION INSERTS AND BE KITEMARKED. LOAD CLASS A15 COVERS TO BE USED IN AREAS INACCESSIBLE TO VEHICLES; LOAD CLASS B125 COVERS TO BE USED IN PRIVATE DRIVES; LOAD CLASS D400 COVERS TO BE USED IN PRIVATE ROADS. ALL COVERS TO BE BADGED 'FW' OR 'SW' AS APPROPRIATE. MANHOLE COVER SLABS AND ACCESS TO BE IN ACCORDANCE WITH CONCRETE PIPE ASSOCIATION TECHNICAL BULLETIN ISSUED SEPTEMBER 2001.
 - POLYPROPYLENE INSPECTION CHAMBER COVERS AND FRAMES SHALL COMPLY WITH THE RELEVANT PROVISIONS OF BS EN 124-1 TO 6:2015. COVERS AND FRAMES TO BE OF A NON-ROCKING DESIGN WITH CUSHION INSERTS AND BE KITEMARKED. LOAD CLASS A15 COVERS TO BE USED IN AREAS INACCESSIBLE TO VEHICLES; LOAD CLASS B125 COVERS TO BE USED IN PRIVATE DRIVES; LOAD CLASS D400 COVERS TO BE USED IN PRIVATE ROADS.
 - CLASS 2 BEDDING DETAIL SHALL BE PROVIDED:
 - WHERE COVER TO PIPE BARREL IS:
 - i) <1.2m IN VEHICULAR TRAFFICKED AREAS
 - ii) <0.9m IN AREAS INACCESSIBLE TO VEHICLES
 - AT ALL ROAD GULLY, YARD GULLY, RWP, SWP AND DRAINAGE CHANNEL BRANCHES.
 - AREAS OF DEEP ROOTING VEGETATION.
 - PIPE RUNS NEAR BUILDINGS IN ACCORDANCE WITH TYPICAL SECTIONS ON AWP DETAILS DRAWING.
 - WHERE TWO PIPES CROSS WITH A CLEAR GAP OF <300mm, CLASS 2 SURROUNDING TO EXTEND A MINIMUM OF 1.0m FROM THE CENTRE OF THE CROSSING POINT & EXTENDED TO WITHIN 150mm OF THE NEAREST FLEXIBLE JOINT, WHERE REQUIRED.
 - NO MECHANICAL COMPACTION OF FILL MATERIAL WITHIN 300mm OF THE CROWN OF ANY PIPE.

Alan Wood & Partners

Hull Office
341 Beverley Road
Hull
HU5 1LD

Consulting Civil & Structural Engineers
Project Managers
Building Surveyors

Project: **Feasibility Study at Hackness CE School, Scarborough**

Client: **Align Property Partners Ltd**

Drawing: **Proposed Drainage Layout**

Role: **Civil Engineer**

Drawing Status: **WORK IN PROGRESS**

Job no: **40836** Scale@ A1: **As Noted** Rev: **P1**

Project Originator Volume Level Type Role Number
FSH - AWP - ZZ - XX - DR - C - 3000

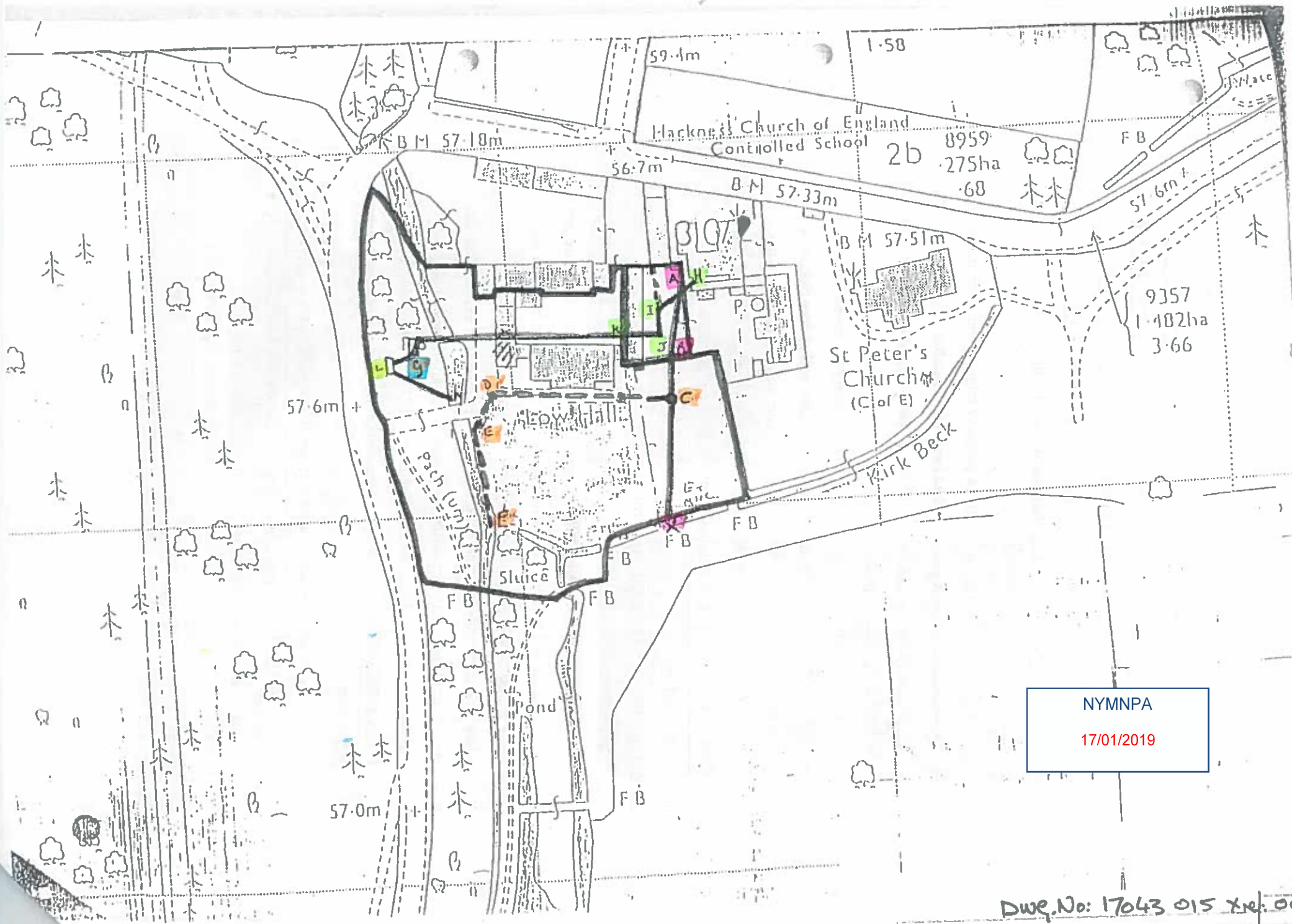

NYMNP
 17/01/2019

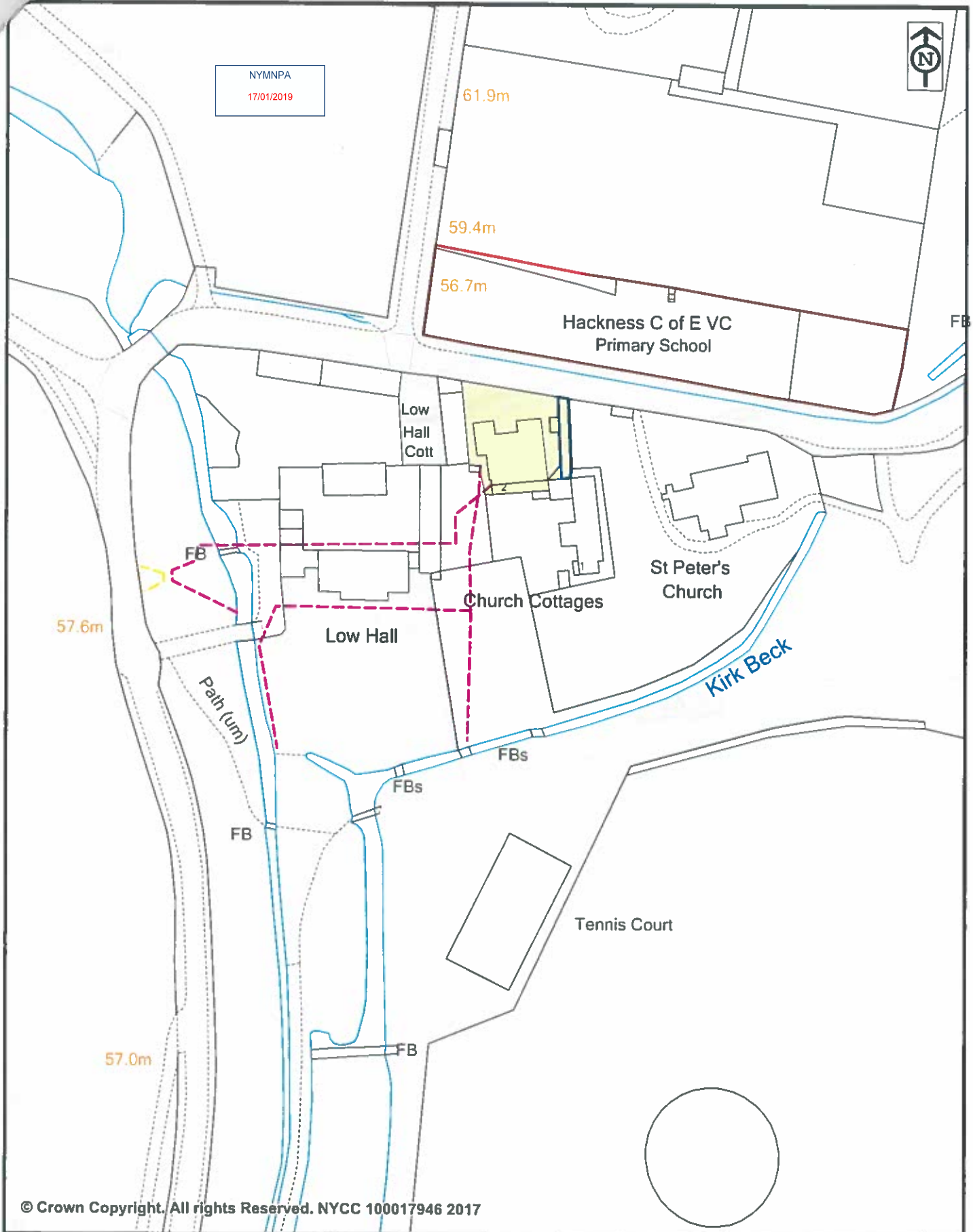

© Crown Copyright. All rights Reserved. NYCC 100017946 2017



E3046 Hackness CoE VC Primary School

Shaded Yellow = Managed
 Red Outline = Lease In
 Blue Outline = Right of Way Out
 Pink / Yellow Hatched Line = Easement's In

Scale: 1:1250
 Drawn: AW
 Date: September 2017
 Dwg No: 7381
 OS Grid: 496866 490568

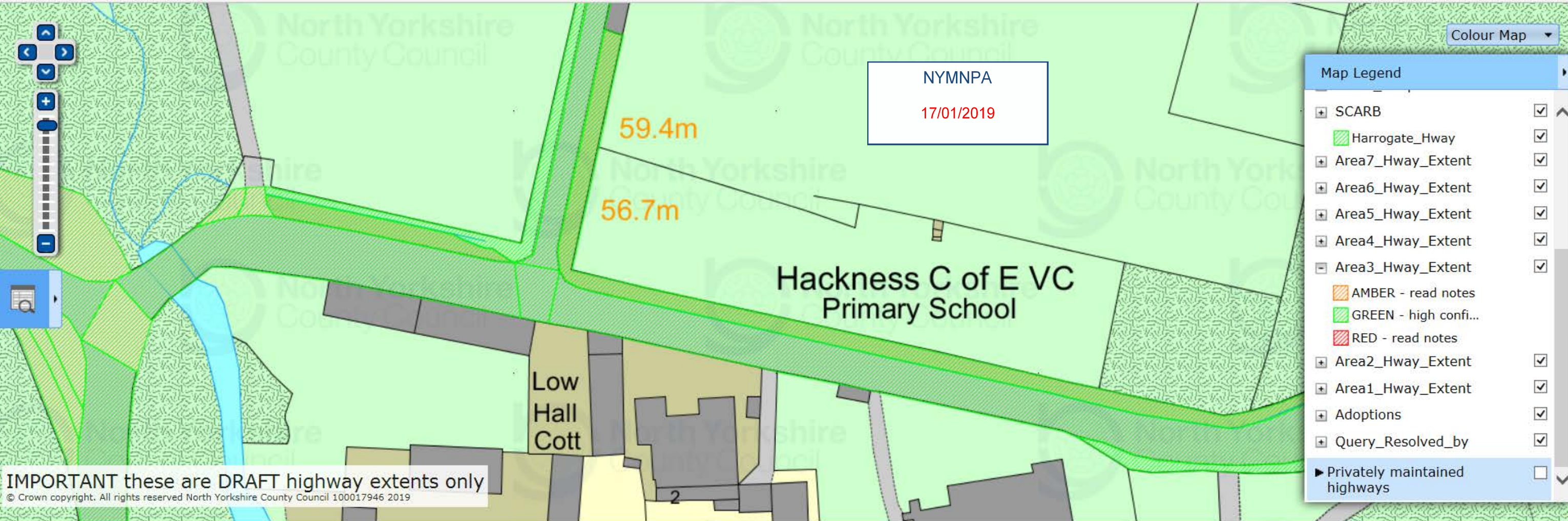

Map Legend

- SCARB
- Harrogate_Hway
- Area7_Hway_Extent
- Area6_Hway_Extent
- Area5_Hway_Extent
- Area4_Hway_Extent
- Area3_Hway_Extent
- AMBER - read notes
- GREEN - high confi...
- RED - read notes
- Area2_Hway_Extent
- Area1_Hway_Extent
- Adoptions
- Query_Resolved_by
- Privately maintained highways

IMPORTANT these are DRAFT highway extents only
© Crown copyright. All rights reserved North Yorkshire County Council 100017946 2019