

PAUL ELM Dip.T.P., M.R.T.P.I

CHARTERED TOWN PLANNER & ARCHITECTURAL DESIGNER

15 Crabmill Lane Easingwold York YO61 3DE

Your Ref: NYM/2018/0835/OU

Our Ref: R 2186

15 February 2019

National Park Officer
North York Moors National Park
The Old Vicarage
Bondgate
Helmsley
York
YO62 5BP

For the attention of Mrs Jill Bastow

Dear Mrs Bastow

PROPOSED FARM HOUSE AT FOX HOUNDS FARM HIGH KILBURN

Further to our exchanges of e-mails and telephone calls in connection with the outline planning application relating to the above proposal, I now enclose a copy of a revised site plan showing the application site moved into the south eastern corner of the field, as you requested.

I trust that you will now be able to recommend the approval of the application to the NP Committee at its meeting on 28 February 2019.

Should you have any further query, please do not hesitate to get in touch.

Best wishes

Yours sincerely

Paul Elm



enc

Copy to: Mr Paul Dean



Buy A Plan

UK's Fastest and Easiest Planning Site

AMENDED



River Lane End, River Lane, York, YO61 4AJ

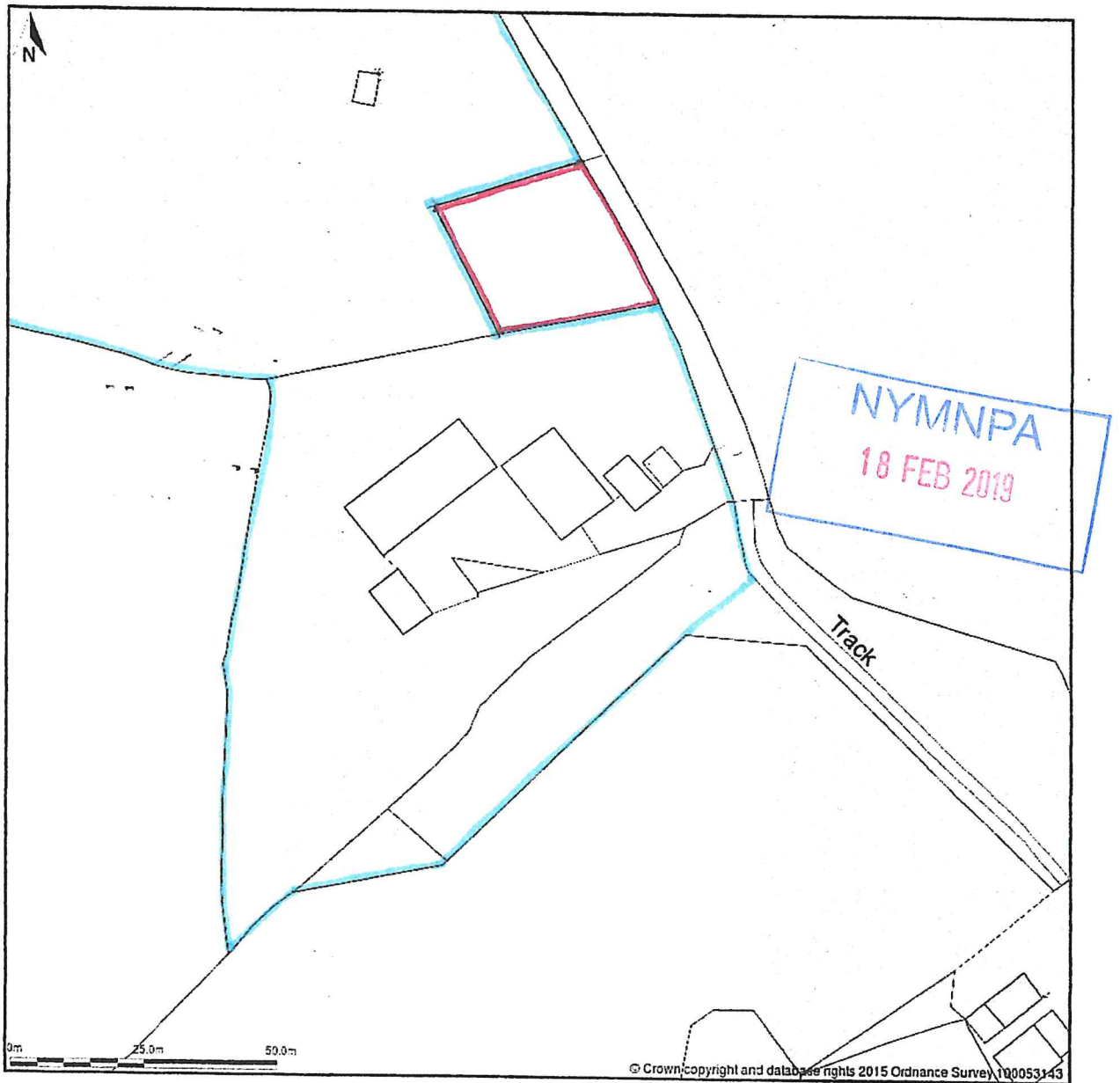

Site Plan shows area bounded by: 451896.99004492,479250.77150351 452096.99004492,479450.77150351 (at a scale of 1:1250) The representation of a road, track or path is no evidence of a right of way. The representation of features as lines is no evidence of a property boundary.

Produced on 3rd Sep 2015 from the Ordnance Survey National Geographic Database and incorporating surveyed revision available at this date. Reproduction in whole or part is prohibited without the prior permission of Ordnance Survey. © Crown copyright 2015. Supplied by buyaplan.co.uk a licensed Ordnance Survey partner (100053143). Unique plan reference: #00074931-EB9767

Ordnance Survey and the OS Symbol are registered trademarks of Ordnance Survey, the national mapping agency of Great Britain. Buy A Plan logo, pdf design and the buyaplan.co.uk website are Copyright © Pass Inc Ltd 2015

Outline application for the construction of a
Farmhouse at Fox Hounds Farm, High Kilburn

Revised site plan

Scale 1:1250

February 2019