

NYMNPA

06/03/2019

**From:** Russell Lumb  
**Sent:** 06 March 2019 11:23  
**To:** Jill Bastow  
**Subject:** Re: NYM/2019/0040/FL Susannah Hill Cottage, Browside

Jill,

Apologies for the discrepancy between plan and elevation for the proposed new dormer, and please find attached revised First Floor plan 18.01.06A indicating a full-width window to the S.W. elevation.

Regards, Russell.

NYMNP  
06/03/2019

AMENDED

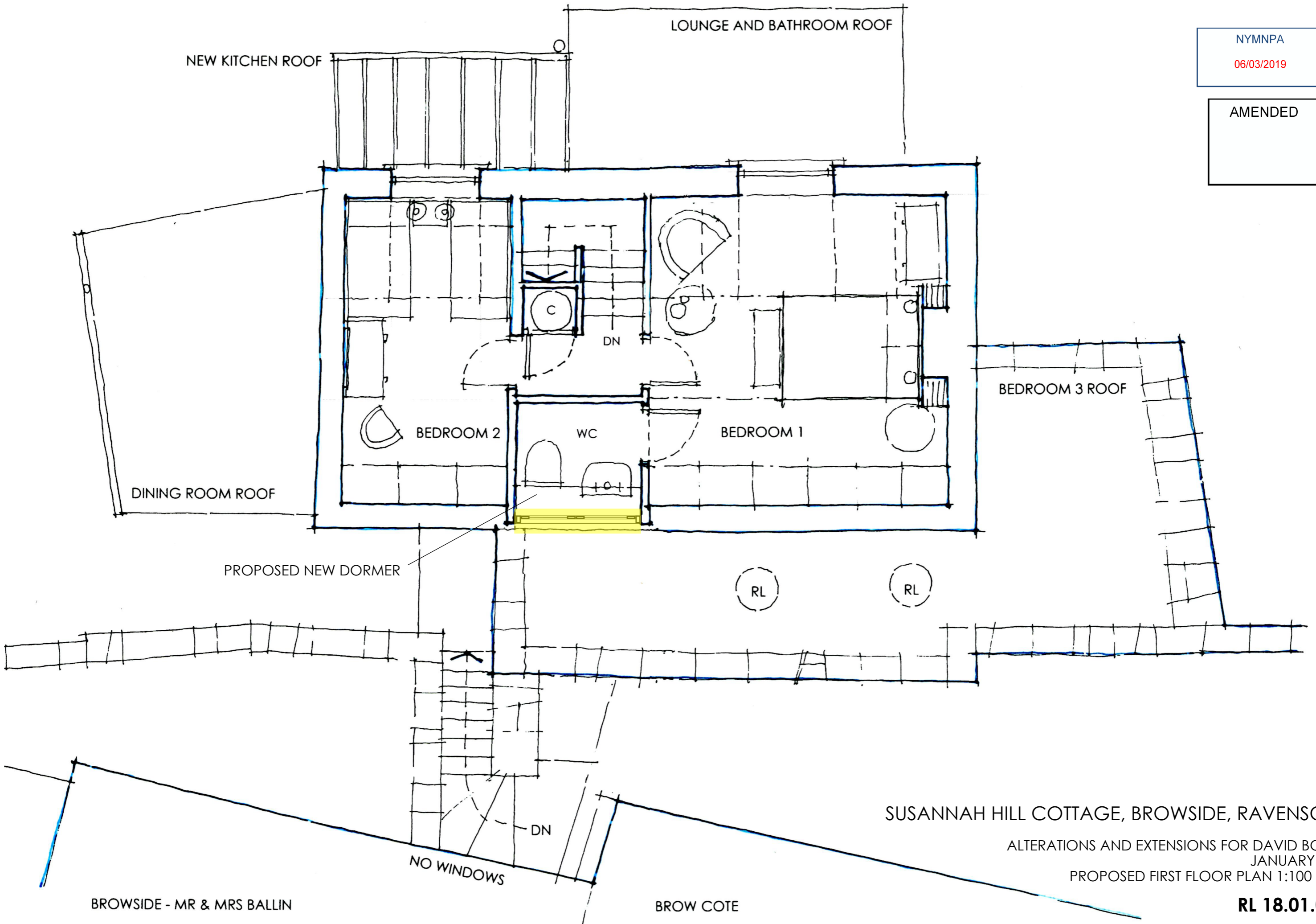

SUSANNAH HILL COTTAGE, BROWSIDE, RAVENSCAR

ALTERATIONS AND EXTENSIONS FOR DAVID BOWES  
JANUARY 2019  
PROPOSED FIRST FLOOR PLAN 1:100 @ A3

BROWSIDE - MR & MRS BALLIN

BROW COTE

RL 18.01.06A