

NOTES
 Do not scale from this Drawing.
 It is the Contractor's responsibility to check all governing dimensions with the Engineer and client and verify all dimensions on site before commencing any work or making any other drawings.
 This drawing to be read in conjunction with structural, mechanical and electrical drawings prepared by others and other relevant information and any discrepancies are to be reported to the Architect/Project Manager.
 Work and materials to be in accordance with the Building Regulations where appropriate and to comply with relevant British Standards. Materials to agree with Planning Conditions.
 This drawing is the copyright of Edwardson Associates Ltd and should not be reproduced in whole or in part without their written permission.

1. All static caravans are laid out in accordance with the Scarborough Borough Council Site License Conditions for static Caravan Sites.
2. Existing Highway entrance to be utilised.
3. Parking to be as shown.
4. Surface water to discharge to ground.
5. Foul water to discharge to existing system.

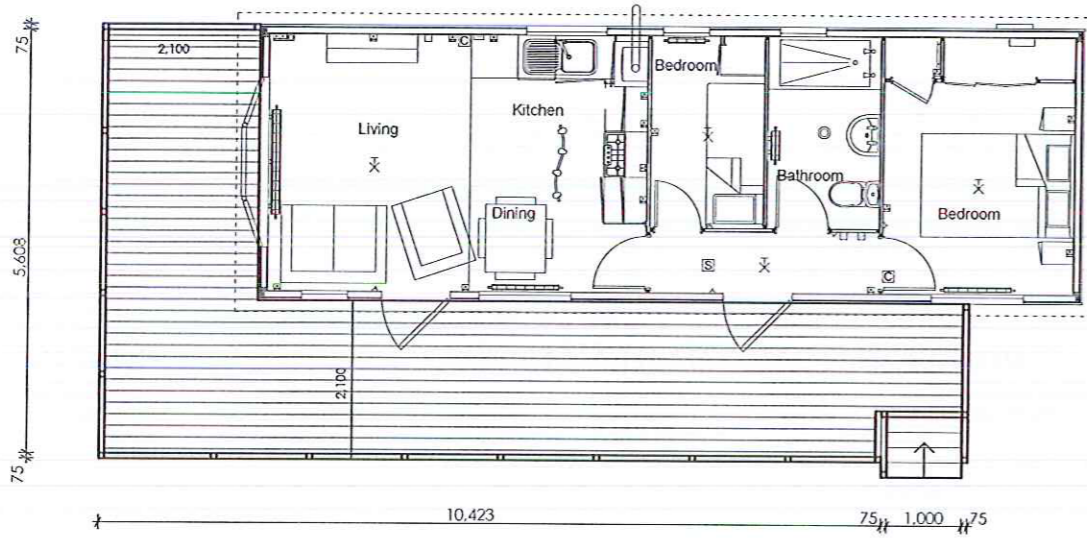

Indicative Interior plan with decking detail 1:100

Condition 8 - Decking Materials and Construction

- Decking to be of a wooden construction
- Decking to be all built by the same contractor
- Total width of the Decking to be 2.1m
- Total Height of the Decking (ground to top of rail) to be 1.6m
- Floor Height of the Decking to be 0.7m
- Rail Height on the Decking to be 0.8m
- Figures 1&2 show the construction/detail and finish of the decking

Condition 7 - Colour of the vans

- The proposed van colour will be as shown in figures 1&2
- The colour and finish of the vans will match that of the existing vans on site



Figure. 1



Figure. 2



© July 2016

EDWARDSON ASSOCIATES

project: Discharge of conditions (7) colour of vans and (8) decking materials of planning permission NYM/2016/0136/FL for the use of land for the siting of 7 no. static caravans for holiday use at Rigg Farm, Stoinsacre, North Yorkshire, YO22 4LP

client: David Stuart

drawing title: Decking Details - As Proposed

scale @ A3: 1:100 date: July 2016

drawn: DW checked:

job no: STU.D 2016.01 drawing no: 200

issue status: DOC revision:

Plotlock House, 10 Middle Street South

www.edwardsonassociates.com