

Supporting Agricultural Information

Applicants/Agents are encouraged to complete the tables below as this will enable the Authority to speed up the processing of the notification. The purpose of this form is to provide basic information on the farm system to help assess the need and appropriateness of an agricultural building within the National Park.

Livestock Numbers	Average Number Throughout the Year	Notes
Dairy Cows		
Suckler Cows/Heifers Over 24 Months		
Followers (6-24 months)		
Breeding Ewes/Tups		
Hoggs		
Other Livestock Beef Cattle	190	

Land	Area (Hectares)	Notes
Size of Holding	112.14	
Available Grazing Land	67.28	
Arable Land	44.86	
Moorland		
Grazing Land on Short Term Tenancy		

The above will help us determine the stocking density on the farm.

List Main Existing
Agricultural Buildings

Approximate
Dimensions (in metres)

Existing Usage/Notice

CATTLE SHED

23M x 9.2M

CATTLE SHED

18M x 27M

CATTLE SHED

32M x 7.5M

GENERAL PURPOSE

23M x 9.2M

GENERAL PURPOSE

18M x 23M

GRAIN STORE

15M x 18M



Any Other Relevant Information

No energy (minimial) usage

Main Holding Number
48/486/0015

Sheet Holding Number : 48/486/0015

Rural Land Register

Plot ID	Map Sheet	Field Nos.	Original Field Size (ha)	New Digital Field Size (ha)	Incorrect Boundary
	OS Map Sheet	NG Field			
1	NZ8407	4991	0.15	0.15	
2	NZ8407	6265	14.61	14.61	

NYMNP
 19 DEC 2016

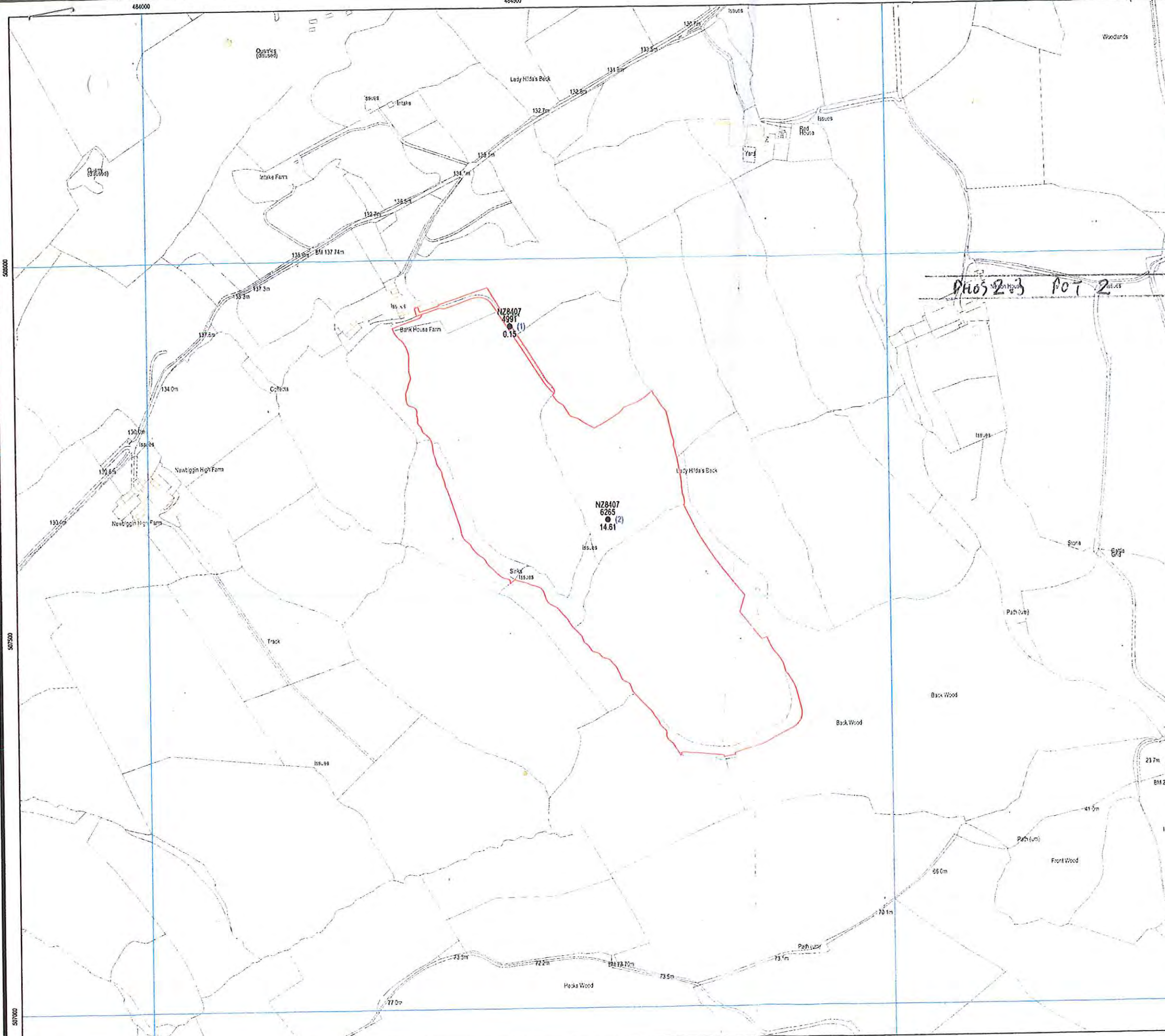

Print Name :

Signed : Date :

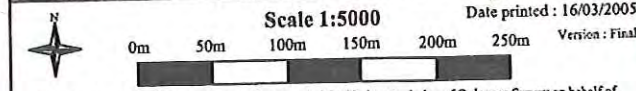

Date printed : 16/03/2005
Version : Final

This map is reproduced from Ordnance Survey material with the permission of Ordnance Survey on behalf of the Controller of Her Majesty's Stationery Office. © Crown copyright. Unauthorised reproduction infringes Crown copyright and may lead to prosecution or civil proceedings. DEFRA licence No 100018850 2005

ORDNANCE SURVEY
PLAN REFERENCE

NZ 8407

Scale
1/2500

COUNTY NORTH YORKSHIRE DISTRICT SCARBOROUGH

All rights reserved
© Crown Copyright

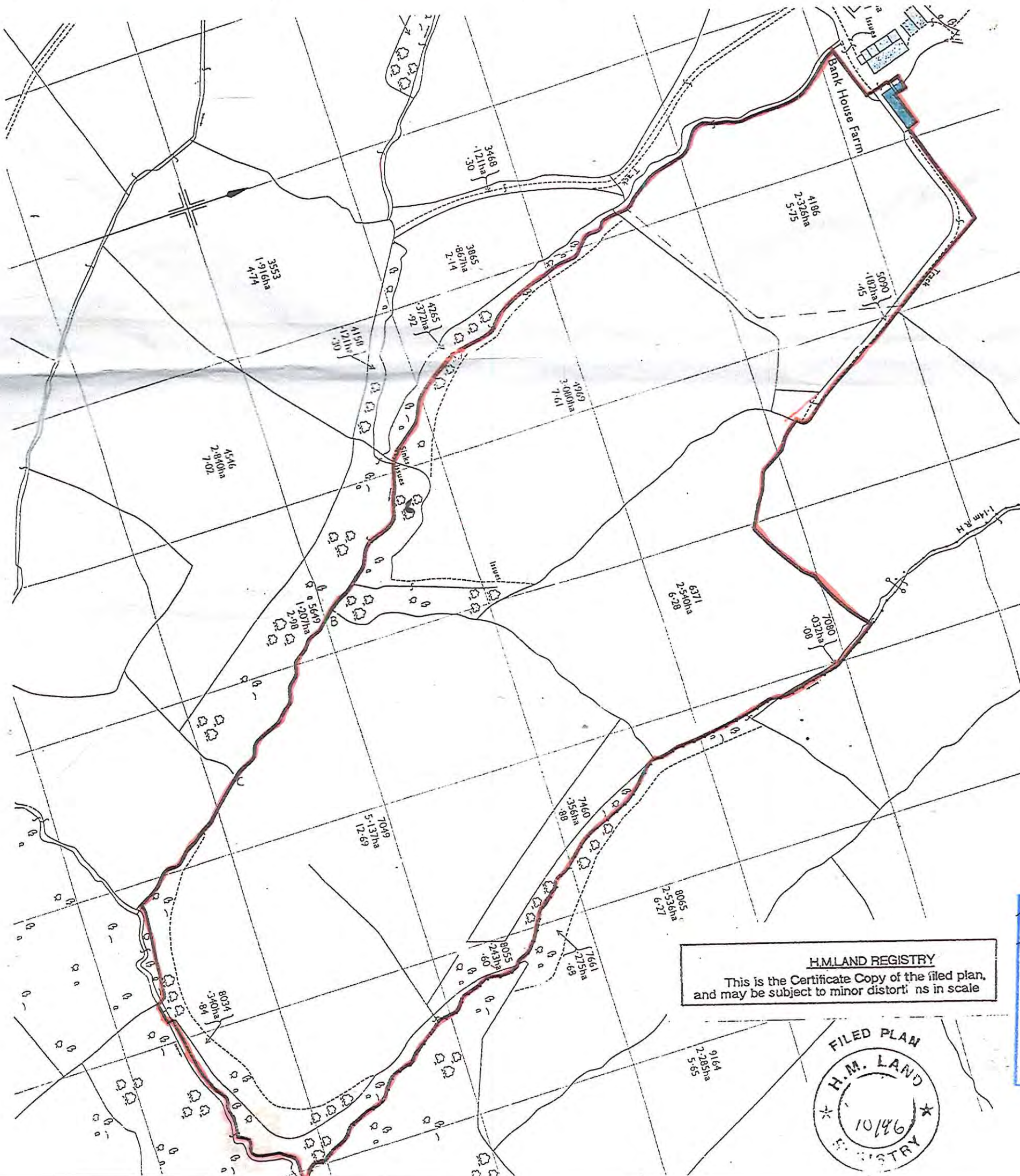

H.M. LAND REGISTRY
This is the Certificate Copy of the filed plan,
and may be subject to minor distortions in scale



NYMNPA
19 DEC 2016

