

Reproduction in whole or in part is prohibited without the prior permission of Ordnance Survey.

Ordnance Survey and the OS Symbol are registered trademarks and OS MasterMap® is a trademark of Ordnance Survey, the national mapping agency of Great Britain.

The representation of a road, track or path is no evidence of a right of way.

The representation of features as lines is no evidence of a property boundary.

Scale 1:1250

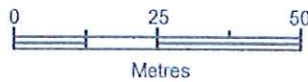

Supplied by: Getmapping  
Centre coordinates: 480960, 505852  
OS License Number: 100030848

NYMND  
11 APR 2017

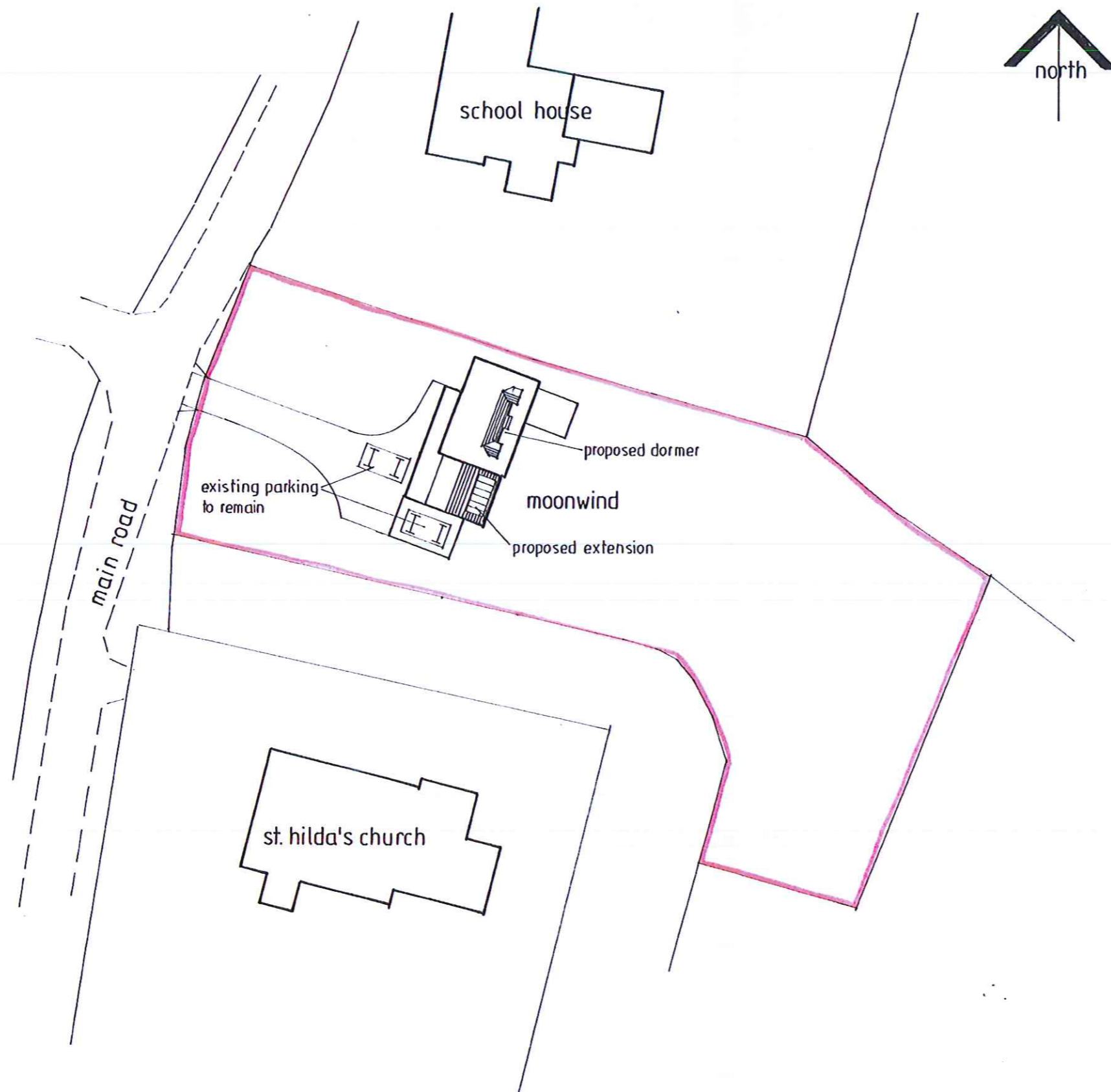

NYMNDP

11 APR 2017

revision	description	date

The contractor shall check all dimensions on site and report discrepancies before work commences  
 No dimension shall be scaled off this drawing  
 ©Copyright of this drawing is retained by A.L. Turner

client	<b>Mr &amp; Mrs Beeforth</b>
project	<b>Proposed Extensions and Alterations at Moonwind, Main Road, Egton, YO21 1UT</b>
title	<b>Block Plan</b>

**A L Turner + Associates**  
 1 LORING ROAD, RAVENSCAR, SCARBOROUGH YO13 0LY  
[www.yorkshirearchitectural.co.uk](http://www.yorkshirearchitectural.co.uk)

date	scale	dwg size	drawn
03.17	1:500	A3	ALT
issue	drawing no	rev.	
planning	2326:9		