

Supporting Agricultural Information

Applicants are encouraged to complete the following as this will enable the Authority to speed up the processing of your notification/application. The purpose of this form is to provide basic information on the farm system to help assess the need and appropriateness of agricultural buildings within the National Park.

Application Reference:

Site Address: MURK HEADS FARM HARWOOD ROAD

Applicant Name: ROBIN GRAY

Livestock Numbers

Cattle

	Average number throughout the year	Additional information
Dairy Cows/Breeding Bulls	-	
Suckler Cows/Heifers over 24 months	-	
Followers (6 to 24 months)	-	

Sheep

	Average number throughout the year	Additional information
Breeding Ewes/Tups		
Replacement Ewe Lambs/Finishing Store Lambs	50	

Pigs

	Average number throughout the year	Additional information
Sows/Boars	-	
Weaners	-	

NYM/NPA
 16 JAN 2018

Continued.../

Others

	Average number throughout the year	Additional information
Other Livestock, i.e. Horses	-	

Land

	Area in Hectares	Additional information
Size of Holding	50	740 CONTACT FARMS
Available Grazing Land	5	
Arable Land	90	including ABOVE
Moorland	-	-
Grazing Land on Short Term Tenancy	-	-

Agricultural Buildings

List main existing agricultural buildings and use	Approximate dimensions in metres	Is it a modern or traditional building?
1. MACHINE STORE	20 x 10	MODERN
2. NET GRASS STORE FERTILIZER STORE	25 x 12	"
3.		
4.		
5.		
6.		
7.		
8.		

N/A
 16 JAN 2013

Proposed building(s) and use	Dimensions in metres
1. GRAIN STORE LONG TERM	18 x 12
2. DRYER HOUSING + SPRAY FILL	14 x 12.

Please Note: It would be helpful if you could attach a sketched block plan annotating which building is which as referred to above.

Please detail below how the farming operation on site may change as a result of the proposal i.e. increase in stock levels or justification for the use of the new building.

REQUIREMENT FOR FARM ASSURED CROP STORAGE (RED TRACTOR)
ENSURE DRYER IS UNDERCOVER - DUST / RAIN ETC.
SPRAYER / WATER / WASTE CONTROL



NYM/NPA
16 JAN 2018

NYM/NPA
03 DEC 2017

Mill C

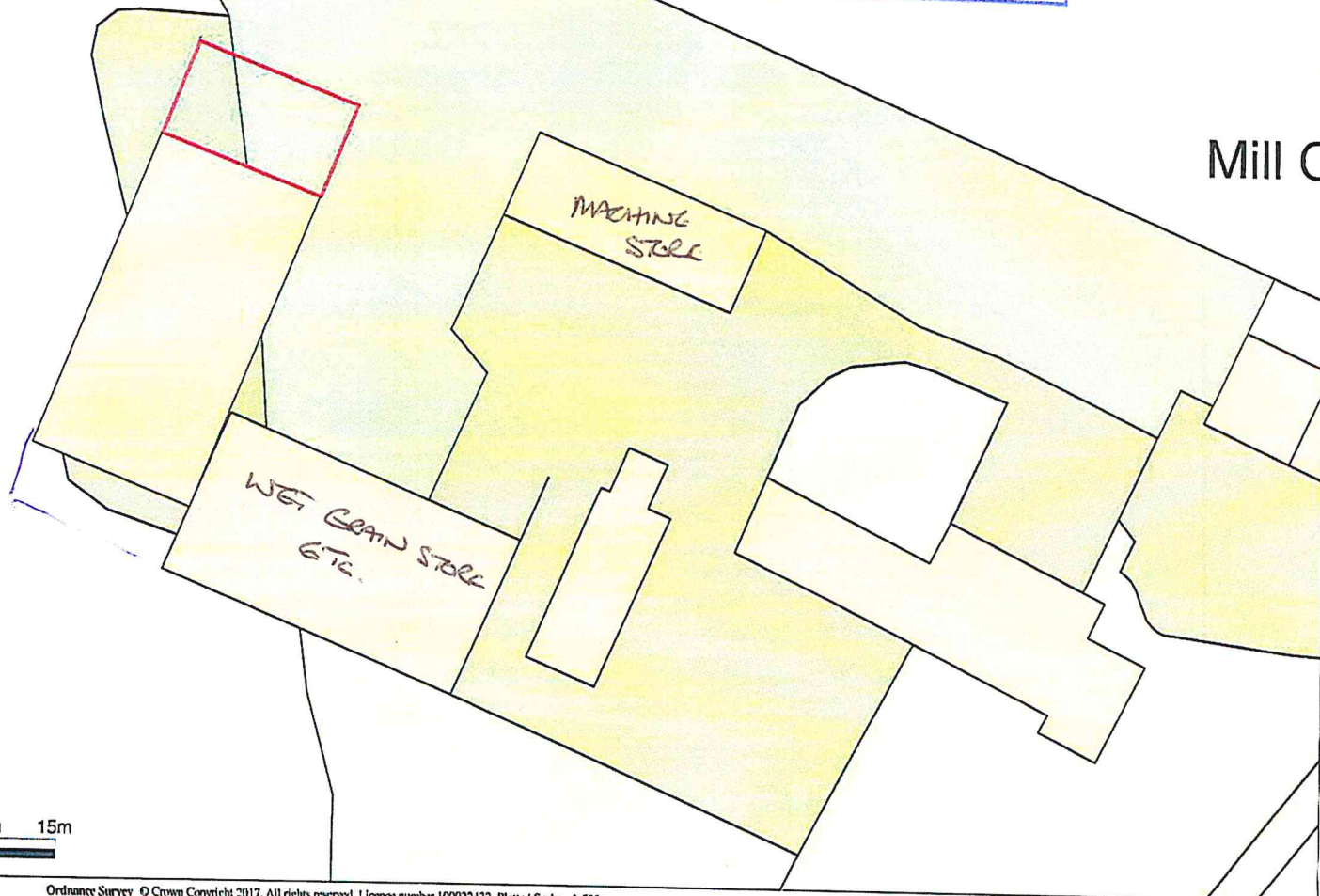

0m 5m 10m 15m

