



For office use only

Ref: NYM/2007 / U281 / CU

Admin Ref: 07/201

Date valid: _____

Grid ref: _____

SECTION 4 BUSINESS, RETAIL OR OTHER COMMERCIAL USE

18. Proposed use

Which of the following is involved in the development

Business Retail

Other (please specify) _____

If industrial, please describe the process _____

Is the proposal part of a larger scheme? ~~YES~~ / NO (delete as appropriate)

19. Floor space

Please provide the measurements of the following:

Total floor space of all buildings to which this application relates

Existing m² Proposed m²

Industrial floor space

Office floor space

Retail trading floor space

Storage floor space

Warehouse floor space

Other

NYMNP
-9 MAR 2007

3 ACRE FIELD

20. Employment

a) How many staff in total will be employed on the site as a result of the proposed development?

Industrial Other

b) How many of the employees will be new staff?

c) If staff are to be transferred from other premises, how many will be affected?

2

0

0

21. Car parking

How many car parking spaces are to be provided?

CAR PARKING FOR 6 CARS ALREADY EXISTS

22. Traffic

How many vehicles will be visiting the site each day

APPROX 6 CARS

23. Hazardous materials

Please read Note 23 in the accompanying booklet. Does the proposal involve use or storage of hazardous materials? YES/~~NO~~ (delete as appropriate) If YES, please state which materials.

Please go back to Section 5 on page 2

Please send or deliver to:
The North York Moors National Park,
The Old Vicarage, Bondgate,
Easingwold, Yorkshire YO62 5BP

SECTION 1 YOUR DETAILS

1. Applicant

Name MR M. PULLEN

Address MEETING HOUSE FARM
STAINTONDALE SCARBOROUGH

Post Code YO13 0EL

Tel No 01723 870521

2. Agent

Name _____

Address _____

Post Code _____

Tel No _____

NYMNP
-9 MAR 2007

3. Applicant's interest in the land

OWNER

SECTION 2 YOUR PROPOSAL

4. Full postal address or location of the application site

MEETING HOUSE FARM STAINTONDALE SCARBOROUGH
YO13 0EL

5. Applicant's interest in adjoining land

NONE

6. Brief description of proposed development

TO CREATE A SIBERIAN HUSKY TREKKING EXPERIENCE
BY USING ONE OF OUR FIELDS TO CREATE A TRACK FOR TREKKING
(please see accompanying letter)

SECTION 3 YOUR APPLICATION

7. Type of application (please tick ONE box only)

- A. Full application including building works
- B. Application for change of use (no building works)
- C. Outline application
- D. Reserved matters application
- E. Removal or variation of condition
- F. Renewal of temporary permission

go to Question 12
go to Question 12
go to Question 8
go to Question 9
go to Question 10
go to Question 11

8. Outline Application

What is the area of the site? _____

Please tick those details which you wish the Planning Committee to consider formally at this stage.

- Layout Scale Appearance Access Landscaping None

go to Question 12

Date of outline permission _____ Application No _____
 Please tick those details which you wish the Planning Committee to consider formally at this stage.
 Layout Scale Appearance Access Landscaping

go to Question 12

10. Removal or variation of condition

Date condition imposed _____ Application No _____
 Condition No _____

go to Question 12

11. Renewal of temporary permission

Date permission granted _____ Application No _____

12. Use

What is the building / land used for at present? GRAZING
 If it is unused at present, what was its last use?
 and on what date did it stop being used for this? (if known) _____

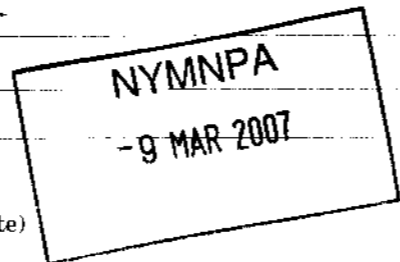

13. Access

Does your proposal require new or altered access? YES / NO (delete as appropriate)
 If YES, please tick the relevant boxes:
 New access to a road Vehicular Pedestrian
 Altered access to a road Vehicular Pedestrian
 Even if no alterations or changes are being sought, access arrangements will need to be described in the 'design and access statement'.

14. Water Supply and Drainage

Please state (Please tick one box in each section) the method of:
 Water Supply Mains Private existing/proposed*
 Surface Water Disposal Public Surface Water River/Stream
 Soakaway Other existing/proposed*
 Foul Sewage Public Foul Sewer Septic Tank Cesspit Other existing/proposed*
 *delete as appropriate

Note: If foul drainage is not to be via a public foul sewer, a drainage assessment will be required. Please see Question 14 in the accompanying booklet.

15. Trees

Does the application involve: Felling or lopping trees / hedgerows YES / NO (delete as appropriate)
 Planting trees YES / NO (delete as appropriate)

16. Materials

Walls _____
 Roof _____

17. Is your application for business, retail or other commercial use?

YES / NO (delete as appropriate) If YES please complete Questions 18 - 23 of Section 4 on page 4 of this form
 If NO go to Section 5

SECTION 5 WHAT YOU NEED TO INCLUDE WITH YOUR APPLICATION

24. Plans

Please list below the plans which will accompany the application.
ORDNANCE SURVEY MAP SHEET SHOWING FIELD WHERE TRACK TO BE CREATED, 2 PHOTOS OF HULLY TREKKING SCOOTER + 3 DUPLICATES + LETTER WITH MORE DETAILS

25.

Certificate of Ownership and Agricultural Holdings Certificate

You are required by law to complete either Certificate A or Certificate B (Ownership) and the Agricultural Holdings Certificate. It is an offence knowingly to make a false declaration.

CERTIFICATE OF OWNERSHIP : A

Complete if you are the owner of the building / land, along with Agricultural Holdings Certificate below.

I certify that: On the 21 days before the date of the accompanying application nobody, except the applicant, was the owner of any part of the land to which this application relates.

Signed _____ (Applicant/Agent)

* On behalf of _____ (Applicant)

Date 7/3/07

CERTIFICATE OF OWNERSHIP : B

Complete if you do not own any or all of the building / land, along with Agricultural Holdings Certificate below.

I certify that: I have /the applicant has given the requisite notice to everyone else who, on the 21 days before the date of the accompanying application, was the owner of any part of the land to which the application relates, as listed below.

Owner's name _____

Address at which notice served _____

Date on which notice was served _____

Signed _____ (Applicant/Agent)

* On behalf of _____ (Applicant)

Date _____

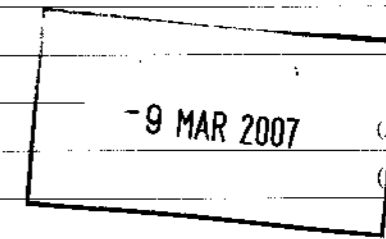

AGRICULTURAL HOLDINGS CERTIFICATE

This section MUST be completed. Delete either A or B and complete C.

A. I certify that none of the land to which this application relates is, or forms part of, an agricultural holding.

B. I have /the applicant has given requisite notice to every person other than myself /himself who, 20 days before the date of the application was a tenant of any agricultural holding any part of which was comprised in the land to which this application relates:

Name of tenant _____

Address NONE

Date notice was served _____

C. Signed _____ (Applicant/Agent)

On behalf of _____ (Applicant)

Date 7/3/07

26.

I/WE hereby apply for planning permission or approval of reserved matters as described in this application and the accompanying plans. I / We attach:

- for rural building conversion, any bat survey or structural engineer's report undertaken.
- the necessary plans numbered:
- 'design and access statement'.
- completed, dated and signed Certificate of Ownership (A or B above).
- completed, dated and signed Agricultural Holdings Certificate.
- Flood risk assessment if the development lies in zone 2/3 of the indicative floodplain map.

- the fee of £ 205 by cheque/postal order, no

Signed _____ (Applicant/Agent)

On behalf of _____ (Applicant)

Date 7/3/07

* delete where appropriate

MEETING HOUSE FARM
STAINTONDALE

NYM/ 2007 / 0 2 0

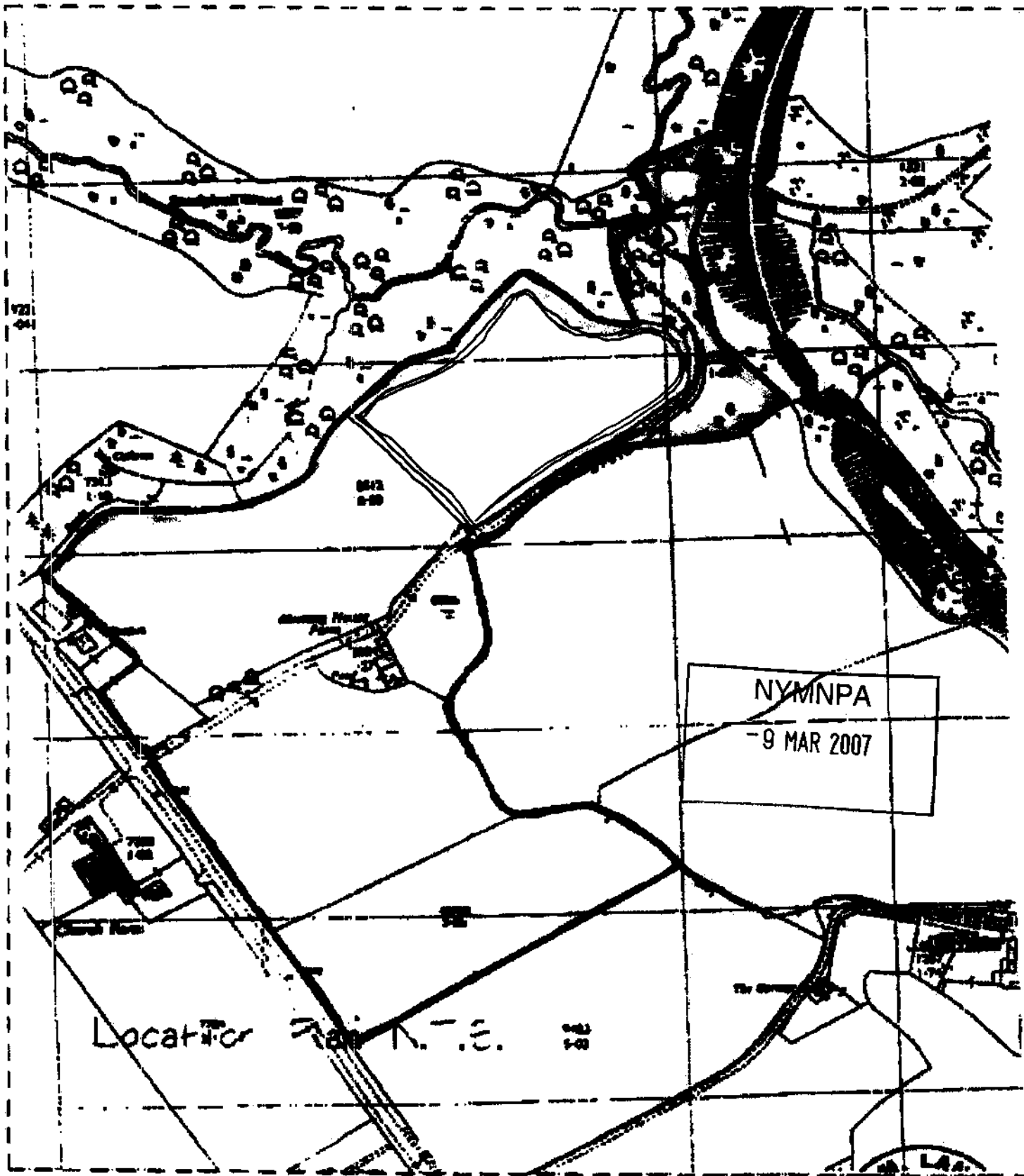

MEETING HOUSE FARM LAND

NEW INNER RING FENCE TO CREATE TREKKING TRACK
FARMSTEAD PARKING (EXISTING)

M&B Pullen
 Meeting House Farm
 Staintondale
 Scarborough
 YO13 0EL
 Tel: 01723 870521
 7/03/07

NYMNPA

- 9 MAR 2007

Dear Sir or Madam,

In the very near future I am going to have to decide whether to re-invest in the pig unit that we currently run, which provides my son and I with our main income. If we decide to go down this route it will mean carrying on in pig farming for possibly the next 20 years or so at least.

One of my hobbies is Siberian Husky trekking. This is a very enjoyable hobby and one that the more I have thought about it, could have promising commercial possibilities.

I would like to create a Siberian Husky Experience open to the public, where people could come and learn about the origins of the breed and participate in some Husky trekking activities. The Husky trekking would be run on a strictly pre-booked basis, and by doing it this way, it would not create any increase in local traffic .

The amount of dogs that I would keep would be around 12, Incidentally though, they would hardly make any noise as they have been described by The Kennel Club of Great Britain as a "mute breed", meaning no disturbances for local residents, they are also renowned for being very friendly towards people as they have lived and worked side by side with humans for centuries having been bred by the Chukchi people of Siberia to be a very successful sled dog, so pulling is second nature to them. The dogs would be securely housed in our existing barn, all 12 dogs would create 5 or 6 teams of 2 dogs to each customer. The rig they pull is quite a recent invention, please find enclosed a couple of photographs of a pair of Huskies pulling a Husky scooter, exactly the thing we would be using. They are no bigger than a pushbike, and the dogs pull them at a speed of about 10-12 mph. All customers would be provided with the correct safety equipment when Husky trekking.

I would create a ring fence circuit in one of our fields that would allow us to instruct, and then let people enjoy the thrill of being pulled along by the Huskies around the perimeter of the field. We would occasionally like to be able to use the old railway line for the more competent Trekkers, this would not create any disturbance as it would be no different to somebody riding their pushbikes with a dog trotting by their side, even less so in fact, as the Huskys are restrained on their harnesses and not running freely. I think this would create a reliable

business for us to gain an income from. Also, if it proved successful, would probably, if my projections of income are correct, allow me to reduce the amount of pigs we keep and eventually stop pig farming altogether. Each "team" of dogs would be able to complete 2 to 3 runs a day, so the maximum number of customers per day would be between 12 and 15 people. Meaning probably only about half a dozen cars in any one day, so there would obviously be no traffic problems created.

It is a business that would be very unobtrusive and quiet and would not alter the landscape. It would be no different to cycling or "walking the dog" so to speak. If it allowed us to wind down the pig farm side of our business it would benefit the area generally because it would end the smell that slurry spreading creates.

Yours sincerely

NYMNPA

-9 MAR 2007