

TEMPORARY CLASSROOM
1784

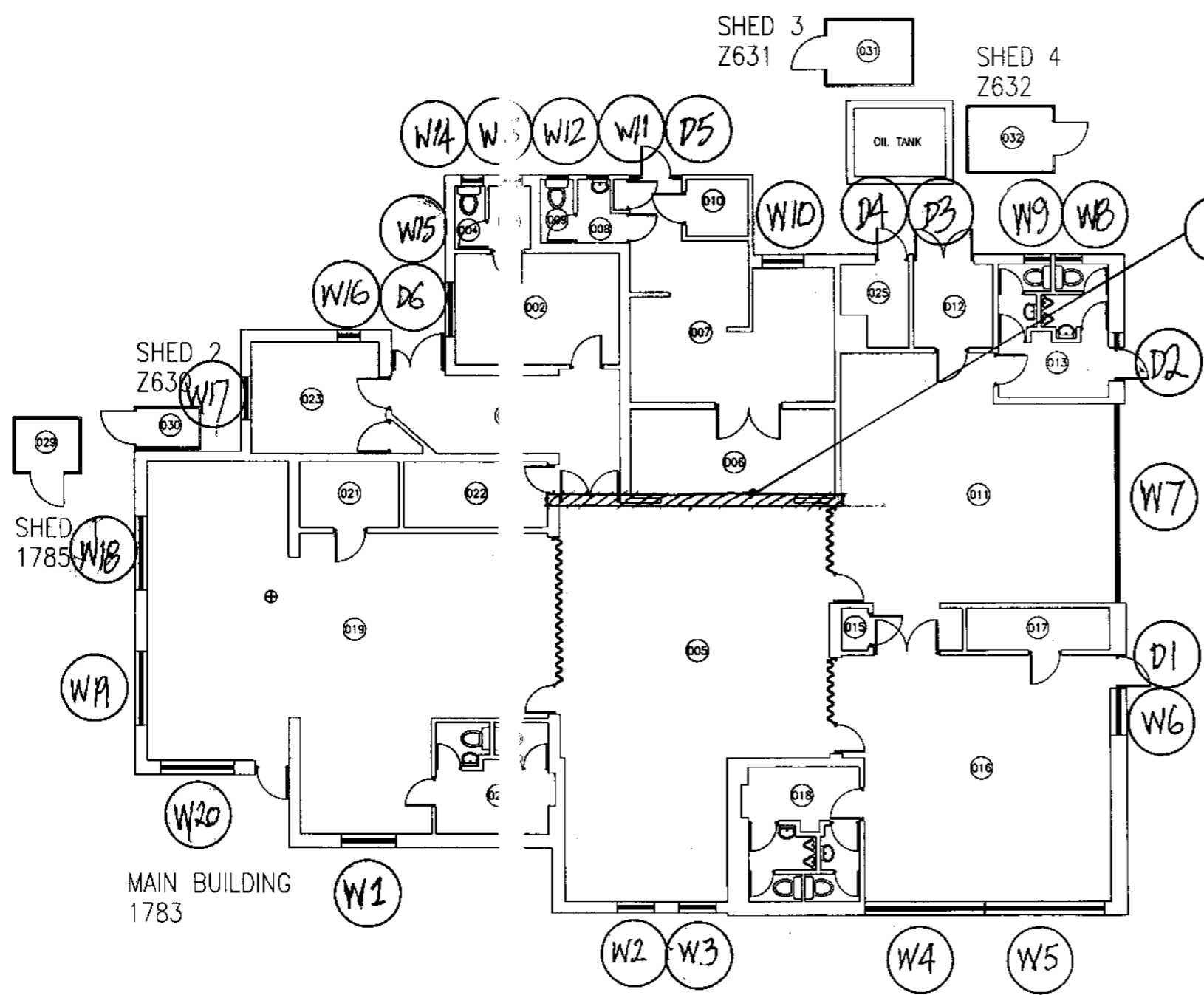

MAIN BUILDING
1783



Revision Notes
 REVISION B
 17 OCT 2005
 ROOMS 24 & 14 REMOVED AS PER
 CASELLA'S INSTRUCTIONS

NYMNP
 23 MAR 2007

THIS DRAWING SHOULD NOT BE USED
 FOR ARCHITECTURAL DESIGN PURPOSES.

THIS DRAWING AND ITS CONTENTS REMAINS
 THE PROPERTY OF NYCC, BUILDING DESIGN
 & MANAGEMENT.
 ANY MISUSE OR ALTERATION IS PROHIBITED.

NOTES

-  WALL DUCT
-  FLOOR DUCT
-  CEILING DUCT

LEGEND

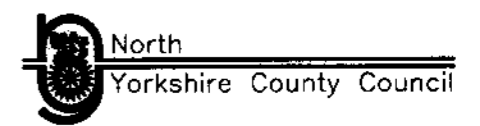

THE
 FYLINGDALES CEVCP SCHOOL
 BUILDING AND ROOM NO 1.D
 E 3139/12
 RENEW WINDOWS/DOORS
 IDENTIFICATION NOS

Scale 1:200	Drawn SCP	Checked	Date 12-03-07
----------------	--------------	---------	------------------

Unique Property Number - UP No. 0350/E3139	Sheet No.
---	-----------

Room Numbers	Revision
--------------	----------

SECTION 4 BUSINESS, RETAIL OR OTHER COMMERCIAL USE

18. Proposed use

Which of the following is involved in the development?

Business Retail

Other (please specify)

If industrial, please describe the process

Is the proposal part of a larger scheme? YES / NO (delete as appropriate)

19. Floor space

Please provide the measurements of the following:

Total floor space of all buildings to which this application relates

Industrial floor space

Office floor space

Retail trading floor space

Storage floor space

Warehouse floor space

Other

Existing m² Proposed m²

20. Employment

a) How many staff in total will be employed on the site as a result of the proposed development?

b) How many of the employees will be new staff?

c) If staff are to be transferred from other premises, how many will be affected?

Industrial Other

21. Car parking

How many car parking spaces are to be provided?

22. Traffic

How many vehicles will be visiting the site each day?

23. Hazardous materials

Please read Note 23 in the accompanying booklet. Does the proposal involve use or storage of hazardous materials? YES / NO (delete as appropriate) If YES, please state which materials.

Please go back to Section 5 on page 2

Please send or deliver to:
The North York Moors National Park,
The Old Vicarage, Bondgate,
Helm-sley,
York YO62 5BP



For office use only

Ref: NYM/ 2007 / 0242 / FL
Admin Ref: 07/242
Date valid: _____
Grid ref: _____

SECTION 1 YOUR DETAILS

1. Applicant

Name CHILDREN AND YOUNG PERSONS DIRECTORATE

Address NORTH YORKSHIRE COUNTY COUNCIL

COUNTY HALL

NORTHALLERTON

Post Code DL7 8DG

Tel No 01609-780780

2. Agent

Name JACOBS UK LTD

Address 3, LANLEY HOUSE

WYKEHAM BUSINESS CENTRE

WYKEHAM, SCARBOROUGH, YORKS

Post Code YO13 9QP

Tel No 01723-854114

3. Applicant's interest in the land

OWNER

23 MAR 2007

SECTION 2 YOUR PROPOSAL

4. Full postal address or location of the application site

FYLINGDALES CHURCH OF ENGLAND VOLUNTARY CONTROLLED PRIMARY SCHOOL
FYLINGTHORPE, WHITEY, NORTH YORKSHIRE YO22 4TH

5. Applicant's interest in adjoining land

N/A

6. Brief description of proposed development

REMOVAL OF EXISTING TIMBER WINDOWS AND DOORS AND REPLACEMENT WITH DOUBLE GLAZED ALUMINIUM WINDOWS AND ALUMINIUM DOORS.

SECTION 3 YOUR APPLICATION

7. Type of application (please tick ONE box only)

- A. Full application including building works
- B. Application for change of use (no building works)
- C. Outline application
- D. Reserved matters application
- E. Removal or variation of condition
- F. Renewal of temporary permission

go to Question 12
go to Question 12
go to Question 8
go to Question 9
go to Question 10
go to Question 11

8. Outline Application

What is the area of the site? N/A

Please tick those details which you wish the Planning Committee to consider formally at this stage.

- Siting
- Design
- External appearance
- Means of access
- Landscaping
- None

go to Question 12

9. Reserved Matters Application *N/A*

Date of outline permission _____ Application No _____
Please tick those details which you wish the Planning Committee to consider formally at this stage.
 Siting Design External appearance Means of access Landscaping

go to Question 12

10. Removal or variation of condition *N/A*

Date condition imposed _____ Application No _____
Condition No _____

go to Question 12

11. Renewal of temporary permission *N/A*

Date permission granted _____ Application No _____

12. Use

What is the building / land used for at present? EDUCATION ESTABLISHMENT
If it is unused at present, what was its last use? N/A
and on what date did it stop being used for this? (if known) N/A

13. Access

Does your proposal require new or altered access? ~~YES~~ / NO (delete as appropriate)
If YES, please tick the relevant boxes:
New access to a road Vehicular Pedestrian
Altered access to a road Vehicular Pedestrian

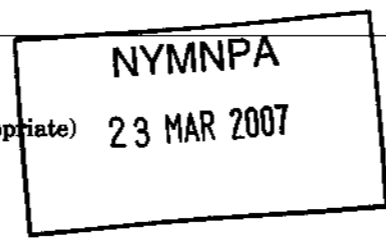

14. Water Supply and Drainage

Please state (Please tick one box in each section) the method of:
Water Supply Mains Private existing/proposed*
Surface Water Disposal Public Surface Water Sewer River/Stream existing/proposed*
 Soakaway Other
Foul Sewage Public Foul Sewer Septic Tank Cesspit Other existing/proposed*
*delete as appropriate

Note: If foul drainage is not to be via a public foul sewer, a drainage assessment will be required. Please see Question 14 in the accompanying booklet.

15. Trees

Does the application involve: Felling or lopping trees / hedgerows ~~YES~~ / NO (delete as appropriate)
Planting trees ~~YES~~ / NO (delete as appropriate)

16. Materials

Walls NEW WINDOWS TO BE (WHITE) DOUBLE GLAZED UNITS IN ALUMINIUM FRAMES
NEW DOORS TO BE (NAVY BLUE IN WHITE FRAME) ALUMINIUM.
Roof N/A

17. Is your application for business, retail or other commercial use?

~~YES~~ / NO (delete as appropriate) If NO go to Section 5
If YES please complete Questions 18 - 23 of Section 4 on page 4 of this form

SECTION 5 WHAT YOU NEED TO INCLUDE WITH YOUR APPLICATION

24. Plans

Please list below the plans which will accompany this application.
1. LOCATION PLAN - PART OF SHEET NZ9405
2. NYCC BUILDING AND ROOM NO IDENTIFICATION PLAN NO 0350/E3139
3. PHOTO/DATA SHEETS FROM MANUFACTURER (POLAR REF Q280) 10 SHEETS.

25. Certificate of Ownership and Agricultural Holdings Certificate

You are required by law to complete either Certificate A or Certificate B (Ownership) and the Agricultural Holdings Certificate. It is an offence knowingly to make a false declaration.

CERTIFICATE OF OWNERSHIP : A

Complete if you are the owner of the building / land, along with Agricultural Holdings Certificate below.
I certify that: On the 21 days before the date of the accompanying application nobody, except the applicant, was the owner of any part of the land to which the application relates.
Signed _____ (Applicant/Agent)
* On behalf of NYCC TOLATE (Applicant)
Date 05/03/07

CERTIFICATE OF OWNERSHIP : B

Complete if you do not own any or all of the building / land, along with Agricultural Holdings Certificate below.
I certify that: I have / the applicant has given the requisite notice to everyone else who, on the 21 days before the date of the accompanying application, was the owner of any part of the land to which the application relates as listed below.
Owner's name _____
Address at which notice served _____
Date on which notice was served _____
Signed _____ (Applicant/Agent)
* On behalf of _____ (Applicant)
Date _____

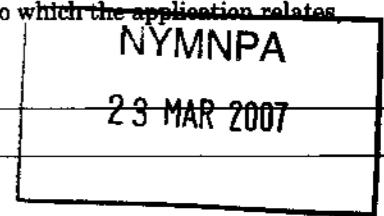

AGRICULTURAL HOLDINGS CERTIFICATE

This section MUST be completed. Delete either A or B and complete C.
~~A. I certify that none of the land to which this application relates is, or forms part of, an agricultural holding.~~
~~B. I have / the applicant has given requisite notice to every person other than myself / himself who, 20 days before the date of the application was a tenant of any agricultural holding any part of which was comprised in the land to which this application relates:~~
Name of tenant _____
Address _____
Date notice was served _____

C. Signed

Signed _____ (Applicant/Agent)
On behalf of NYCC - TOLATE (Applicant)
Date 05/03/07

26. I / We hereby apply for planning permission or approval of reserved matters as described in this application and the accompanying plans. I / We attach:

- the necessary plans, numbered _____
- completed, dated and signed Certificate of Ownership (A or B above).
- completed, dated and signed Agricultural Holdings Certificate.
- the fee of £ 135-00p by cheque/postal order no _____
Signed _____ (Applicant/Agent)
On behalf of NYCC - TOLATE (Applicant)
Date 05/03/07

* delete where appropriate

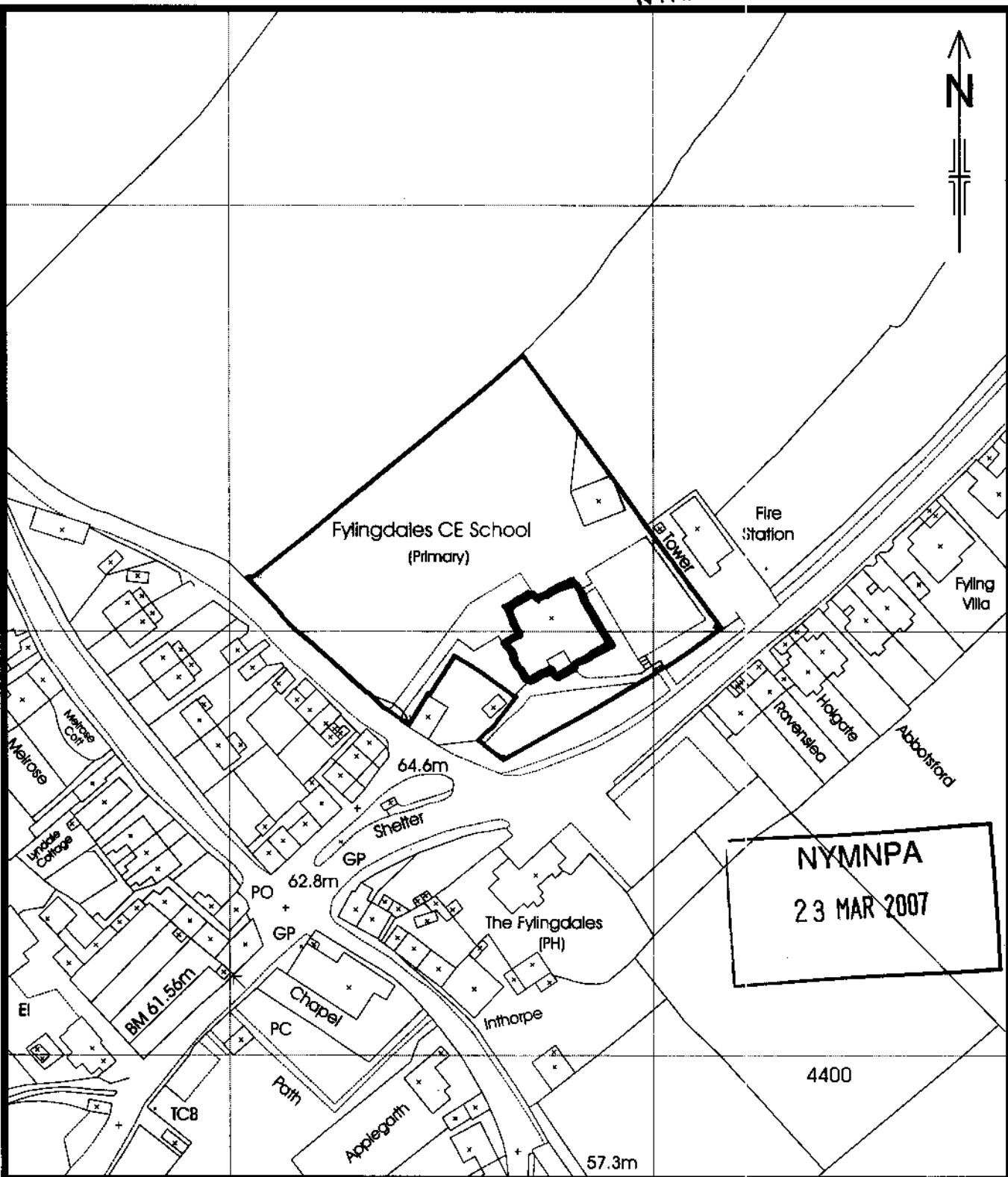

Reproduced from the Ordnance Survey digital data with the permission of the controller of Her Majesty's Stationary Office, Crown Copyright Reserved. Licence Number 100017946

Fylingdales Community Primary School



Scale 1:1250
Surveyor CGP
Date Dec 2003

Ordnance Survey Sheet/s NZ 9405

FYLINGDALES CEVCP SCHOOL, THORPE LANE, FYLINGTHORPE, WHITBY
REPLACEMENT DOORS AND WINDOWS
Project No E3139/12

DESIGN AND ACCESS STATEMENT

(to accompany NYMPNA Planning Application dated 05/03/07)

1. SCOPE OF WORK

Removal of existing timber windows and doors from Main School building and replacement with double glazed aluminium window and aluminium door units

2. CONTEXT

Replacement window and door units are being provided in order to maintain and improve the appearance of the building and to provide enhanced comfort and convenience for the School occupants and users.

3. AMOUNT AND TYPE OF DEVELOPMENT

Replacement windows and door units comprise:

21 no Window units in total
7 no Door units in total

12 12 2007

4. LAYOUT

No major changes generally to the Window / Door format or fenestration.
The project takes account of Crime Prevention in the following ways:

Windows:

- All double glazed units from 4mm toughened glass
- All key lockable
- All internally beaded
- All solid panels from anti vandal material

Doors:

- All double glazed units units from 4mm toughened glass
- All key lockable with 5 lever locks
- All internally beaded
- All solid panels from anti vandal material
- All manufactured with 2 hook locks for overnight security
- Door D6 fitted with electric lock facility connected to existing intercom system

5. SCALE

Replacement window and door units are all in proportion to and fitted within existing openings.

6. LANDSCAPING

Not Applicable

7. APPEARANCE

Replacement window and door units are all manufactured in aluminium with polyester powder coated finish.

Colours:

- Windows: White
- Doors: Navy Blue

8. ACCESS

Access points into the building will remain as existing but will include the following enhancements to comply with the Disability Discrimination Act:

- Minimum clear openings to all doors maintained or increased
- All doors to have visual contrasting colours to leaf / frame / leading edge
- All door opening furniture to contrast visually with the surface of the door and is not cold to touch.

1007