

NYMNP
14 DEC 2007

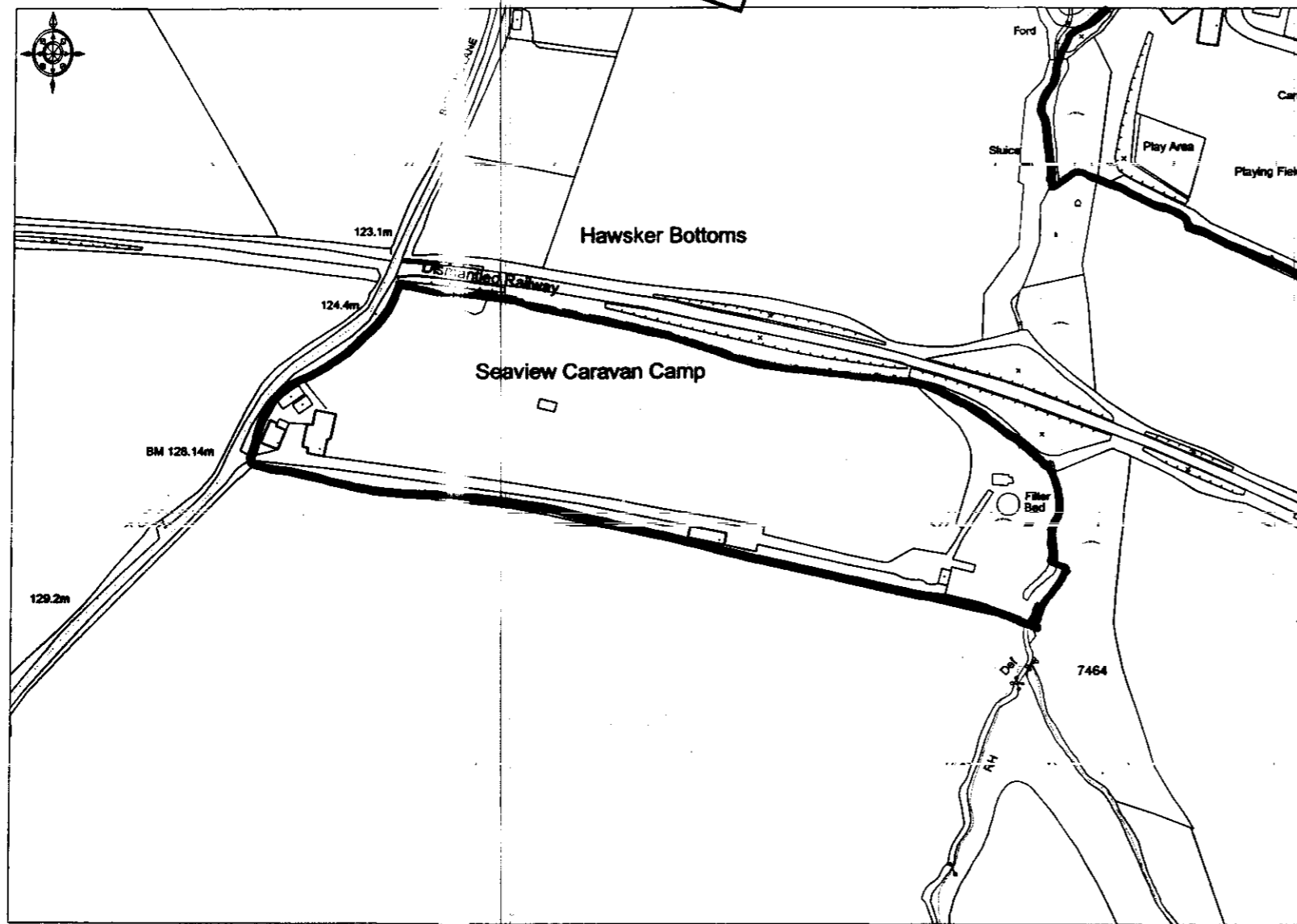

LOCATION PLAN
SCALE 1:2500

Reproduced from the Ordnance Survey
Map with permission of the Controller
Of Her Majesty's Stationary Office -
O.S. Licence No: AL 100037761

APPLICANTS

Mr & Mrs S. Martin
Northcliffe Holiday Park
High Hawsker
Whitby
North Yorkshire
YO22 4LL

PROJECT

Extension of season of use of caravan park (variation of condition)
at Sea View Caravan Park, High Hawsker, Whitby.

DETAIL

Location Plan

DRAWING NO: M04/03/01

SCALE: 1:2500

REVISIONS:

© NOVEMBER 2007

EDWARDSON ASSOCIATES

Paddock House

10 Middle Street South

Drifffield YO25 6PT

TEL: 01377 249720 FAX: 01377 259052



North York Moors National Park **PT1**
Planning Application Form

Please read the booklet
How to fill in your Planning Application
 before completing this form

09/1024

For Office Use Only 1 0 2 4 / FL ✓
 NYM/2007

Ref: _____
 Admin Ref: _____
 Date Valid: _____
 Grid Ref: NZ 93570, 07729

SECTION 1

1 Applicant: **Mr & Mrs S Martin** 2. Agent: **Edwardson Associates**
 Address: **Northcliffe Holiday Pk** Address: **Paddock House, 10 Middle Street South**
High Hawsker, Whitby **Driffield, East Yorkshire**
N Yorkshire
 Post Code: **YO22 4LL** Post Code: **YO25 6PT**
 Tel No: [REDACTED] Tel No: [REDACTED] Fax: [REDACTED]
 Contact: **Mark Southerton or Roy Edwardson**

3 Applicant's interest in the land
 Owner

SECTION 2

YOUR PROPOSAL

4 Full postal address or location of the application site
Seaview Caravan Park, Bottoms Lane, High Hawsker, Whitby
North Yorkshire, YO22 4LL

5 Applicant's interest in adjoining land
 Owners - outlined in blue on the enclosed plan

6 Brief description of proposed development
Extension to the season of use of caravan park (variation of condition)

NYMNPA
 14 DEC 2007

SECTION 3

YOUR APPLICATION

7 Type of application (please tick ONE box only)

| | |
|---|-------------------|
| <input type="checkbox"/> A. Full application including building works | Go to Question 12 |
| <input type="checkbox"/> B. Application for change of use (no building works) | Go to Question 12 |
| <input type="checkbox"/> C. Outline application | Go to Question 6 |
| <input type="checkbox"/> D. Reserved matters application | Go to Question 9 |
| <input checked="" type="checkbox"/> E. Removal or variation of condition | Go to Question 10 |
| <input type="checkbox"/> F. Renewal of temporary permission | Go to Question 11 |

8 Outline Application
 What is the area of the site? _____

Please tick those details which you wish the Planning Committee to formally consider at this stage.

| | | | | | |
|---------------------------------|---------------------------------|--|--|--------------------------------------|-------------------------------|
| <input type="checkbox"/> Siting | <input type="checkbox"/> Design | <input type="checkbox"/> External Appearance | <input type="checkbox"/> Means of access | <input type="checkbox"/> Landscaping | <input type="checkbox"/> None |
|---------------------------------|---------------------------------|--|--|--------------------------------------|-------------------------------|

Go to Question 12

CERTIFICATE A

To be used if you are the owner of the building / land

I certify that: On the 21 days before the date of the accompanying application nobody, except the applicant, was the owner of any part of the land to which this application relates.

Signed: [Redacted] Edwardson Associates (Applicant / Agent)
 * On behalf of: Mr & Mrs S Martin (Applicant)
 Date: 28 November 2007

CERTIFICATE B

To be used if you do not own any or all of the building / land

I certify that: I have / the applicant has given the requisite notice to everyone else who, on the 21 days before the date of the accompanying application, was the owner of any part of the land to which the application relates, as listed below:

Owner's name: _____
 Address at which notice served: _____
 Date on which notice was served: _____
 Signed: [Redacted] Edwardson Associates (Applicant / Agent)
 * On behalf of: _____ (Applicant)
 Date: _____

NYMNPA
 14 DEC 2007

25(ii) AGRICULTURAL HOLDINGS CERTIFICATE

Delete either A or B and complete C.

~~A. I certify that none of the land to which this application relates is, or forms part of, an agricultural holding.~~

~~B. I have/the applicant has given requisite notice to every person other than myself/himself who, 20 days before the date of the application was a tenant of any agricultural holding any part of which was comprised in the land to which this application relates.~~

~~Name of tenant: _____
 Address: _____
 Date notice was served: _____~~

C. Signed: [Redacted] Edwardson Associates (Applicant / Agent)
 * On behalf of: Mr & Mrs S Martin (Applicant)
 Date: 28 November 2007

26

I / We hereby apply for planning permission or approval of reserved matters as described in this application and the accompanying plans. I / We attach:

- The necessary plans, numbered
- Completed, dated and signed Certificate A or B as required by question 25 (i)
- Completed, dated and signed Agricultural Holdings Certificate as required by question 25 (ii)
- The fee of £ 135.00 By cheque / postal order no: _____

Signed: [Redacted] Edwardson Associates (Applicant / Agent)
 * On behalf of: Mr & Mrs S Martin (Applicant)
 Date: 28 November 2007

SECTION 4 BUSINESS, RETAIL OR OTHER COMMERCIAL USE

18 Proposed use

Please list below the plans which will accompany this application: Business Retail

Other (please specify): Caravan Park

If industrial, please describe the process: _____

Is the proposal part of a larger scheme: Yes No

19 Floor Space

Please provide the measurements of the following: Existing m² Proposed m²

| | | |
|---|-------|-------|
| Total floor space of all buildings to which this application relates: | _____ | _____ |
| Industrial floor space: | _____ | _____ |
| Office floor space: | _____ | _____ |
| Retail trading floor space: | _____ | _____ |
| Storage floor space: | _____ | _____ |
| Warehouse floor space: | _____ | _____ |
| Other: | _____ | _____ |

20 Employment

| | Industrial | Other |
|--|------------|-------|
| a) How many staff in total will be employed on the site as a result of the proposed development? | 0 | 2 |
| b) How many of the employees will be new staff? | 0 | 2 |
| c) If staff are to be transferred from other premises, how many will be affected? | 0 | 0 |

21 Car Parking

How many car parking spaces are to be provided? n/a

22 Traffic

How many vehicles will be visiting the site each day? n/a

22 Hazardous Materials

Please read Note 23 in the accompanying booklet.
 Does the proposal involve use or storage of hazardous materials? Yes No
 If YES, please state which materials: _____

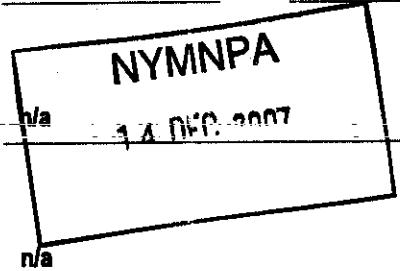

Please go back to Section 5 on page 2

Please send or deliver to:
 The North York Moors National Park
 The Old Vicarage, Bondgate
 Helmsley
 YORK YO6 5BP