

NYMNP
19 MAY 2008
Option 1
NZ8808

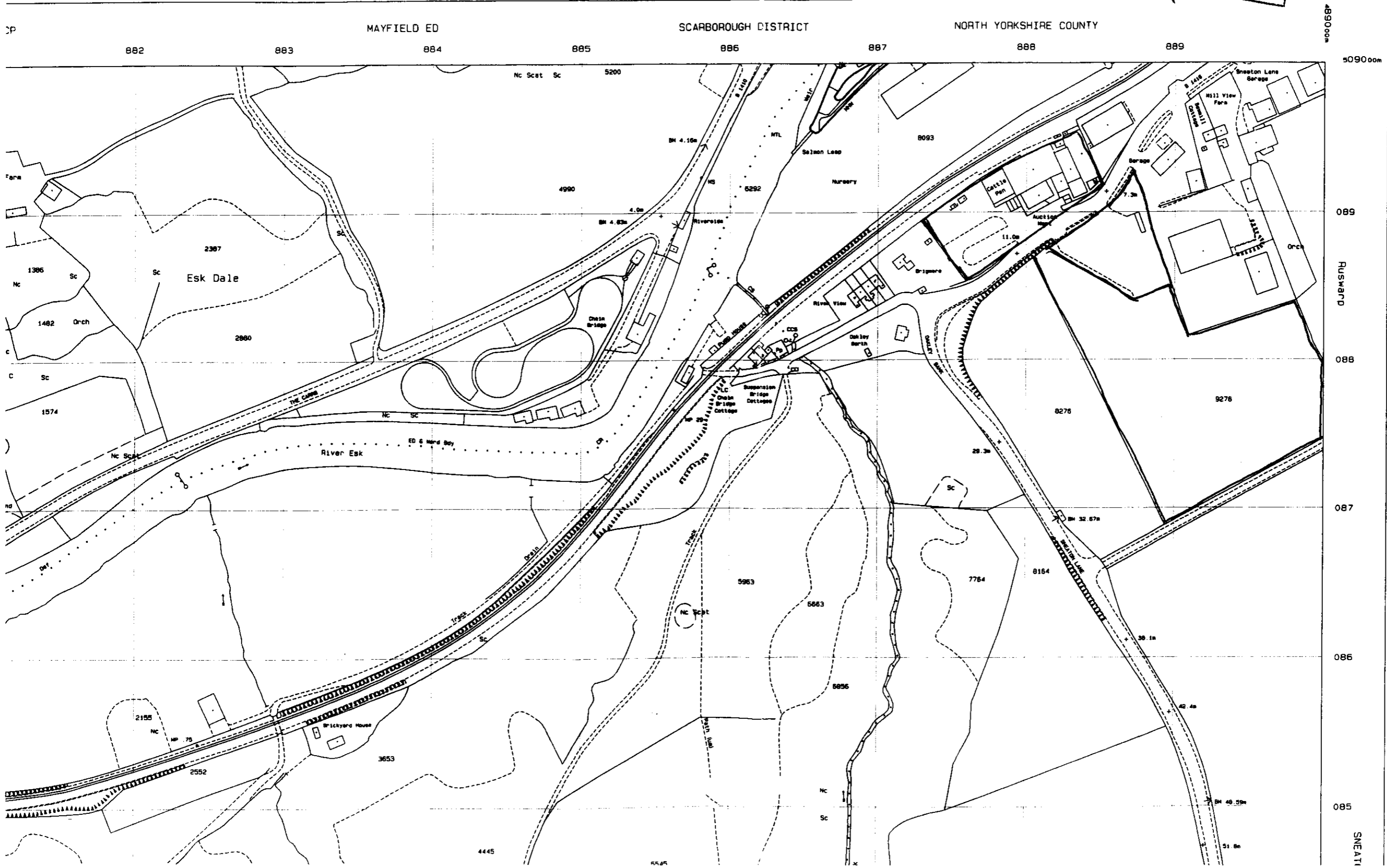

NYMNPA
19 MAY 2008

Option 1
NZ8808

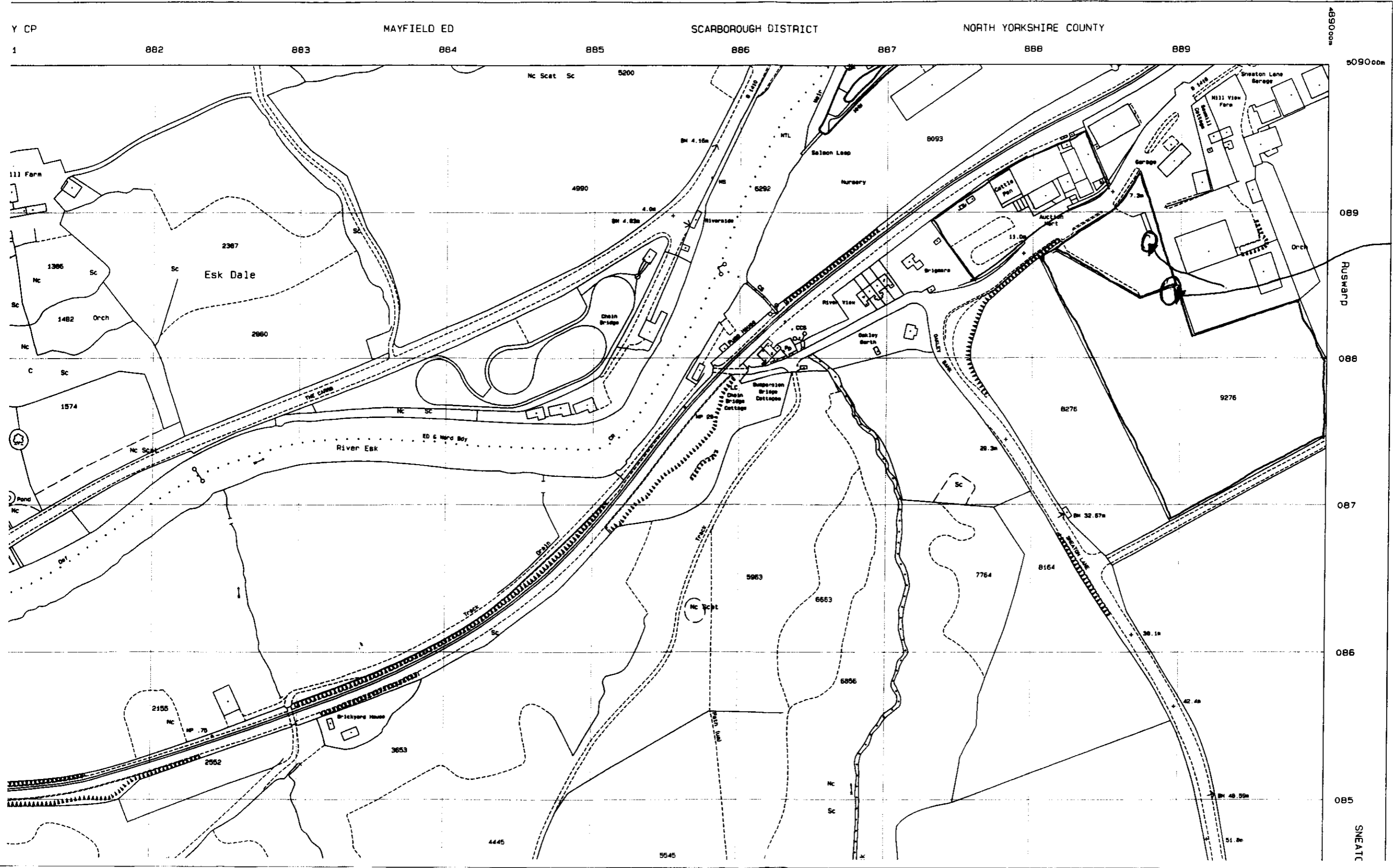

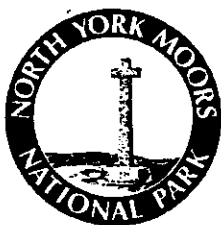

North York Moors National Park Authority
 The Old Vicarage
 Bondgate
 Helmsley
 York
 YO62 5BP

08/393
 PT1

Telephone: 01439 770657
 Email: dc@northyorkmoors-npa.gov.uk
 Website: www.moors.uk.net

Application for Planning Permission. Town and Country Planning Act 1990

Publication of planning applications on council websites

Please note that with the exception of applicant contact details and Certificates of Ownership, the information provided on the application form and in supporting documents may be published on the council's website.

If you have provided any other information as part of your application which falls within the definition of personal data under the Data Protection Act which you do not wish to be published on the council's website, please contact the council's planning department.

Please complete using block capitals and black ink.

It is important that you read the accompanying guidance notes as incorrect completion will delay the processing of your application.

1. Applicant Name and Address	2. Agent Name and Address
Title: <input type="text" value="MR."/> First name: <input type="text" value="IAN"/>	Title: <input type="text"/> First name: <input type="text"/>
Last name: <input type="text" value="MALLEY"/>	Last name: <input type="text"/>
Company (optional): <input type="text" value="RICHARDSON + SMITH"/>	Company (optional): <input type="text"/>
Unit: <input type="text"/> House number: <input type="text"/> House suffix: <input type="text"/>	Unit: <input type="text"/> House number: <input type="text"/> House suffix: <input type="text"/>
House name: <input type="text"/>	House name: <input type="text"/>
Address 1: <input type="text" value="8 VICTORIA SQ"/>	Address 1: <input type="text"/>
Address 2: <input type="text"/>	Address 2: <input type="text" value="NYMNP"/>
Address 3: <input type="text"/>	Address 3: <input type="text" value="19 MAY 2008"/>
Town: <input type="text" value="WHITBY"/>	Town: <input type="text"/>
County: <input type="text" value="NORTH YORKSHIRE"/>	County: <input type="text"/>
Country: <input type="text" value="ENGLAND"/>	Country: <input type="text"/>
Postcode: <input type="text" value="YO21 1EA"/>	Postcode: <input type="text"/>

3. Description of Proposed Works

Please describe the proposed works:

INSTALLATION OF 2x 2000 Gallons underground water tanks to supply the existing lorry wash facility.

Has building or works already been carried out or use of land already started? Yes No

If Yes, please state the date when building works or use were started (DD/MM/YYYY): (date must be pre-application submission)

Have the works been completed or change of use already occurred? Yes No

If Yes, please state when the works were completed or use occurred (DD/MM/YYYY): (date must be pre-application submission)

4. Site Address Details

Please provide the full postal address of the application site.

Unit: House number: House suffix:

House name: RUSWARD MARKET

Address 1: SNEATON LAKE

Address 2: RUSWARD

Address 3:

Town: WHITBY

County: NORTH YORKSHIRE

Postcode (optional): YO22 5HL

Description of location or a grid reference. (must be completed if postcode is not known):

Easting: Northing:

Description:

5. Pre-application Advice

Has assistance or prior advice been sought from the local authority about this application? Yes No

If Yes, please complete the following information about the advice you were given. (This will help the authority to deal with this application more efficiently).

Please tick if the full contact details are not known, and then complete as much as possible:

Officer name:

Reference:

Date (DD/MM/YYYY): (must be pre-application submission)

Details of pre-application advice received?

6. Pedestrian and Vehicle Access, Roads and Rights of Way

Is a new or altered vehicle access proposed to or from the public highway? Yes No Unknown

Is a new or altered pedestrian access proposed to or from the public highway? Yes No Unknown

Are there any new public roads to be provided within the site? Yes No Unknown

Are there any new public rights of way to be provided within or adjacent to the site? Yes No Unknown

Do the proposals require any diversions /extinguishments and/or creation of rights of way? Yes No Unknown

If you answered Yes to any of the above questions, please show details on your plans/drawings and state the reference of the plan(s)/drawings(s)

7. Waste Storage and Collection

Do the plans incorporate areas to store and aid the collection of waste? Yes No Unknown

If Yes, please provide details:

COLLECTION OF SURFACE WATER TO THE TANKS
EXISTING FACILITY ALREADY COLLECTS WASTE MATERIAL.

Have arrangements been made for the separate storage and collection of recyclable waste? Yes No Unknown

If Yes, please provide details:

8. Neighbour and Community Consultation

Have you consulted your neighbours or the local community about the proposal? Yes No

If Yes please provide details:

9. Council Employee / Member

Is the applicant or agent related to any member of staff or elected member of the Council? Yes No

If Yes, please provide details:

10. Materials

If applicable, please state what materials are to be used externally. Include type, colour and name for each material:

	Existing (where applicable)	Proposed	Not applicable	Don't Know	Drawing references if applicable
Walls			<input checked="" type="checkbox"/>	<input type="checkbox"/>	
Roof			<input checked="" type="checkbox"/>	<input type="checkbox"/>	
Windows			<input checked="" type="checkbox"/>	<input type="checkbox"/>	
Doors			<input checked="" type="checkbox"/>	<input type="checkbox"/>	
Boundary treatments (e.g. fences, walls)			<input checked="" type="checkbox"/>	<input type="checkbox"/>	
Vehicle access and hard-standing			<input checked="" type="checkbox"/>	<input type="checkbox"/>	
Lighting			<input checked="" type="checkbox"/>	<input type="checkbox"/>	
Others (please specify)			<input checked="" type="checkbox"/>	<input type="checkbox"/>	

NYMNPA
 19 MAY 2008

Are you supplying additional information on submitted plan(s)/drawing(s)/design and access statement? Yes No

If Yes, please state references for the plan(s)/drawing(s)/design and access statement:

SEE ATTACHED PLANS/DESIGN & ACCESS STATEMENT.

11. Vehicle Parking

Please provide information on the existing and proposed number of on-site parking spaces:

Type of Vehicle	Total Existing	Total proposed (including spaces retained)	Difference in spaces
Cars			
Light goods vehicles/ public carrier vehicles			
Motorcycles			
Disability spaces			
Cycle spaces			
Other (e.g. Bus)			
Other (e.g. Bus)			

Number of Vehicles using the market at any one time is impossible to answer as there are no set parking spaces - estimate would be 15/20 vehicles on quiet market and 100-150 on busy markets.

12. Foul Sewage

Please state how foul sewage is to be disposed of:

- Mains sewer Cess pit
 Septic tank Other
 Package treatment plant Unknown

Are you proposing to connect to the existing drainage system? Yes No

If Yes, please include the details of the existing system on the application drawings and state references for the plan(s)/drawing(s):

Collection Bays
Filter Bays.

13. Assessment of Flood Risk

Is the site within an area at risk of flooding? (Refer to the Environment Agency's Flood Map showing flood zones 2 and 3 and consult Environment Agency standing advice and your local planning authority requirements for information as necessary.)

Yes No

If Yes, you will need to submit a Flood Risk Assessment to consider the risk to the proposed site.

Is your proposal within 20 metres of a watercourse (e.g. river, stream or beck)? Yes No

Will the proposal increase the flood risk elsewhere? Yes No Unknown

How will surface water be disposed of?

- Sustainable drainage system Existing watercourse
 Soakaway Pond/lake
 Main sewer Unknown

14. Biodiversity and Geological Conservation

Is there a reasonable likelihood of the following being affected adversely or conserved and enhanced within the application site, or on land adjacent to or near the application site?

a) Protected and priority species:

- Yes, on the development site
 Yes, on land adjacent to or near the proposed development
 No

b) Designated sites, important habitats or other biodiversity features:

- Yes, on the development site
 Yes, on land adjacent to or near the proposed development
 No

c) Features of geological conservation importance:

- Yes, on the development site
 Yes, on land adjacent to or near the proposed development
 No

NYMNP
19 MAY 2008

15. Existing Use

Please describe the current use of the site:

Lorry Wash Facilities.

Is the site currently vacant? Yes No

If Yes, please describe the last use of the site:

When did this use end (if known)?
DD/MM/YYYY N/A
(date where known may be approximate)

Does the proposal involve any of the following:

Land which is known to be contaminated? Yes No

Land where contamination is suspected for all or part of the site? Yes No

A proposed use that would be particularly vulnerable to the presence of contamination? Yes No

If you have answered Yes to any of the above, you will need to submit an appropriate contamination assessment.

16. Trees and Hedges

Are there trees or hedges on the proposed development site? Yes No

And/or: Are there trees or hedges on land adjacent to the proposed development site that could influence the development or might be important as part of the local landscape character? Yes No

If Yes to either or both of the above, you will need to provide a full Tree Survey, with accompanying plan before your application can be determined. Your Local Planning Authority should make clear on its website what the survey should contain, in accordance with the current 'BS5837: Trees in relation to construction - Recommendations'.

17. Trade Effluent

Does the proposal involve the need to dispose of trade effluents or waste? Yes No

If Yes, please describe the nature, volume and means of disposal of trade effluents or waste

Water, animal excrement
Straw & saw-dust.
Volume - Various amount.
Collection bays.

18. Residential Units (Including Conversion)

Does your proposal include the gain, loss or change of use of residential units? Yes No
 If Yes please complete details of the changes in the tables below:

Proposed Housing							
Market Housing	Not known	Number of Bedrooms					Total
		1	2	3	4+	Unknown	
Houses	<input type="checkbox"/>						
Flats and maisonettes	<input type="checkbox"/>						
Live-work units	<input type="checkbox"/>						
Cluster flats	<input type="checkbox"/>						
Sheltered housing	<input type="checkbox"/>						
Bedsit/studios	<input type="checkbox"/>						
Unknown type	<input type="checkbox"/>						
Totals (a+b+c+d+e+f+g) =							

Existing Housing							
Market Housing	Not known	Number of Bedrooms					Total
		1	2	3	4+	Unknown	
Houses	<input type="checkbox"/>						
Flats and maisonettes	<input type="checkbox"/>						
Live-work units	<input type="checkbox"/>						
Cluster flats	<input type="checkbox"/>						
Sheltered housing	<input type="checkbox"/>						
Bedsit/studios	<input type="checkbox"/>						
Unknown type	<input type="checkbox"/>						
Totals (a+b+c+d+e+f+g) =							

Social Rented	Not known	Number of Bedrooms					Total
		1	2	3	4+	Unknown	
Houses	<input type="checkbox"/>						
Flats and maisonettes	<input type="checkbox"/>						
Live-work units	<input type="checkbox"/>						
Cluster flats	<input type="checkbox"/>						
Sheltered housing	<input type="checkbox"/>						
Bedsit/studios	<input type="checkbox"/>						
Unknown type	<input type="checkbox"/>						
Totals (a+b+c+d+e+f+g) =							

Social Rented	Not known	Number of Bedrooms					Total
		1	2	3	4+	Unknown	
Houses	<input type="checkbox"/>						
Flats and maisonettes	<input type="checkbox"/>						
Live-work units	<input type="checkbox"/>						
Cluster flats	<input type="checkbox"/>						
Sheltered housing	<input type="checkbox"/>						
Bedsit/studios	<input type="checkbox"/>						
Unknown type	<input type="checkbox"/>						
Totals (a+b+c+d+e+f+g) =							

NYM NPA
 19 MAY 2008

Intermediate	Not known	Number of Bedrooms					Total
		1	2	3	4+	Unknown	
Houses	<input type="checkbox"/>						
Flats and maisonettes	<input type="checkbox"/>						
Live-work units	<input type="checkbox"/>						
Cluster flats	<input type="checkbox"/>						
Sheltered housing	<input type="checkbox"/>						
Bedsit/studios	<input type="checkbox"/>						
Unknown type	<input type="checkbox"/>						
Totals (a+b+c+d+e+f+g) =							

Intermediate	Not known	Number of Bedrooms					Total
		1	2	3	4+	Unknown	
Houses	<input type="checkbox"/>						
Flats and maisonettes	<input type="checkbox"/>						
Live-work units	<input type="checkbox"/>						
Cluster flats	<input type="checkbox"/>						
Sheltered housing	<input type="checkbox"/>						
Bedsit/studios	<input type="checkbox"/>						
Unknown type	<input type="checkbox"/>						
Totals (a+b+c+d+e+f+g) =							

Key worker	Not known	Number of Bedrooms					Total
		1	2	3	4+	Unknown	
Houses	<input type="checkbox"/>						
Flats and maisonettes	<input type="checkbox"/>						
Live-work units	<input type="checkbox"/>						
Cluster flats	<input type="checkbox"/>						
Sheltered housing	<input type="checkbox"/>						
Bedsit/studios	<input type="checkbox"/>						
Unknown type	<input type="checkbox"/>						
Totals (a+b+c+d+e+f+g) =							

Key worker	Not known	Number of Bedrooms					Total
		1	2	3	4+	Unknown	
Houses	<input type="checkbox"/>						
Flats and maisonettes	<input type="checkbox"/>						
Live-work units	<input type="checkbox"/>						
Cluster flats	<input type="checkbox"/>						
Sheltered housing	<input type="checkbox"/>						
Bedsit/studios	<input type="checkbox"/>						
Unknown type	<input type="checkbox"/>						
Totals (a+b+c+d+e+f+g) =							

Total existing residential units (A+B+C+D) =

Total proposed residential units (E+F+G+H) =

Total net gain / loss of residential units

19. All Types of Development: Non-residential Floorspace

Does your proposal involve the loss, gain or change of use of non-residential floorspace? Yes No

If you have answered Yes to the question above please add details in the following table:

Use class/type of use	Not applicable	Existing gross internal floorspace (square metres)	Gross internal floorspace to be lost by change of use or demolition (square metres)	Total gross internal floorspace proposed (including change of use)(square metres)	Net additional gross internal floorspace following development (square metres)
A1	<input type="checkbox"/>				
Shops	<input type="checkbox"/>				
Net tradable area:	<input type="checkbox"/>				
A2	<input type="checkbox"/>				
Financial and professional services	<input type="checkbox"/>				
A3	<input type="checkbox"/>				
Restaurants and cafes	<input type="checkbox"/>				
A4	<input type="checkbox"/>				
Drinking establishments	<input type="checkbox"/>				
A5	<input type="checkbox"/>				
Hot food takeaways	<input type="checkbox"/>				
B1 (a)	<input type="checkbox"/>				
Office (other than A2)	<input type="checkbox"/>				
B1 (b)	<input type="checkbox"/>				
Research and development	<input type="checkbox"/>				
B1 (c)	<input type="checkbox"/>				
Light industrial	<input type="checkbox"/>				
B2	<input type="checkbox"/>				
General industrial	<input type="checkbox"/>				
B8	<input type="checkbox"/>				
Storage or distribution	<input type="checkbox"/>				
C1	<input type="checkbox"/>				
Hotels and halls of residence	<input type="checkbox"/>				
C2	<input type="checkbox"/>				
Residential institutions	<input type="checkbox"/>				
D1	<input type="checkbox"/>				
Non-residential institutions	<input type="checkbox"/>				
D2	<input type="checkbox"/>				
Assembly and leisure	<input type="checkbox"/>				
OTHER	<input type="checkbox"/>				
Please specify	<input type="checkbox"/>				
	<input type="checkbox"/>				
	<input type="checkbox"/>				
Total					

NYM/NPA
19 MAY 2008

In addition, for hotels, residential institutions and hostels, please additionally indicate the loss or gain of rooms

Use class	Type of use	Not applicable	Existing rooms to be lost by change of use or demolition	Total rooms proposed (including changes of use)	Net additional rooms
C1	Hotels	<input type="checkbox"/>			
C2	Residential Institutions	<input type="checkbox"/>			
Other	Hostels	<input type="checkbox"/>			

20. Employment

Please complete the following information regarding employees:

	Full-time	Part-time	Total full-time equivalent	Not known
Existing employees				
Proposed employees	N/A	N/A		

21. Hours of Opening

Please state the hours of opening for each non-residential use proposed:

Use	Monday to Friday	Saturday	Sunday and Bank Holidays	Not known
livestock	8 - 5pm	8 - 5pm		
market				

22. Site Area

Please state the site area in hectares (ha)

23. Industrial or Commercial Processes and Machinery

Please describe the activities and processes which would be carried out on the site and the end products including plant, ventilation or air conditioning. Please include the type of machinery which may be installed on site:

WASHING OUT LORRIES,
HOSE PIPES WASH WASH
OUT

Is the proposal a waste management development? Yes No

If the answer is Yes, Please complete the following table:

	Not applicable	The total capacity of the void in cubic metres, including engineering surcharge and making no allowance for cover or restoration material (or tonnes if solid waste or litres if liquid waste)	Please provide the maximum annual operational throughput of the following waste streams:
Inert landfill	<input checked="" type="checkbox"/>		
Non-hazardous landfill	<input checked="" type="checkbox"/>		
Hazardous landfill	<input checked="" type="checkbox"/>		
Energy from waste incineration	<input checked="" type="checkbox"/>		
Other incineration	<input checked="" type="checkbox"/>		
Landfill gas generation plant	<input checked="" type="checkbox"/>		
Pyrolysis/gasification	<input checked="" type="checkbox"/>		
Metal recycling site	<input checked="" type="checkbox"/>		
Transfer stations	<input checked="" type="checkbox"/>		
Material recovery/recycling facilities (MRFs)	<input checked="" type="checkbox"/>		
Household civic amenity sites	<input checked="" type="checkbox"/>		
Open windrow composting	<input checked="" type="checkbox"/>		
In-vessel composting	<input checked="" type="checkbox"/>		
Anaerobic digestion	<input checked="" type="checkbox"/>		
Any combined mechanical, biological and/or thermal treatment (MBT)	<input checked="" type="checkbox"/>		
Sewage treatment works	<input checked="" type="checkbox"/>		
Other treatment	<input checked="" type="checkbox"/>		
Recycling facilities construction, demolition and excavation waste	<input checked="" type="checkbox"/>		
Storage of waste	<input checked="" type="checkbox"/>		
Other waste management	<input checked="" type="checkbox"/>		
Other developments	<input checked="" type="checkbox"/>		

NYMNP
19 MAY 2008

Please provide the maximum annual operational throughput of the following waste streams:

Municipal	
Construction, demolition and excavation	
Commercial and industrial	
Hazardous	

If this is a landfill application you will need to provide further information before your application can be determined. Your waste planning authority should make clear what information it requires on its website.

24. Hazardous Substances

Does the proposal involve the use or storage of any of the following materials in the quantities stated below? Yes No Not applicable

If Yes, please provide the amount of each substance that is involved:

Acrylonitrile (tonnes) <input type="text"/>	Ethylene oxide (tonnes) <input type="text"/>	Phosgene (tonnes) <input type="text"/>
Ammonia (tonnes) <input type="text"/>	Hydrogen cyanide (tonnes) <input type="text"/>	Sulphur dioxide (tonnes) <input type="text"/>
Bromine (tonnes) <input type="text"/>	Liquid oxygen (tonnes) <input type="text"/>	Flour (tonnes) <input type="text"/>
Chlorine (tonnes) <input type="text"/>	Liquid petroleum gas (tonnes) <input type="text"/>	Refined white sugar (tonnes) <input type="text"/>

Other:

Other:

Amount (kilograms):

Amount (kilograms):

25. Certificates

One Certificate A, B, C, or D, must be completed, together with the Agricultural Holdings Certificate with this application form
CERTIFICATE OF OWNERSHIP - CERTIFICATE A

Town and Country Planning (General Development Procedure) Order 1995 Certificate under Article 7

I certify/The applicant certifies that on the day 21 days before the date of this application nobody except myself/ the applicant was the owner (*owner is a person with a freehold interest or leasehold interest with at least 7 years left to run*) of any part of the land or building to which the application relates.

Signed - Applicant: Or signed - Agent: Date (DD/MM/YYYY):

CERTIFICATE OF OWNERSHIP - CERTIFICATE B

Town and Country Planning (General Development Procedure) Order 1995 Certificate under Article 7

I certify/ The applicant certifies that I have/the applicant has given the requisite notice to everyone else (as listed below) who, on the day 21 days before the date of this application, was the owner (*owner is a person with a freehold interest or leasehold interest with at least 7 year left to run*) of any part of the land or building to which this application relates.

Name of Owner	Address	Date Notice Served

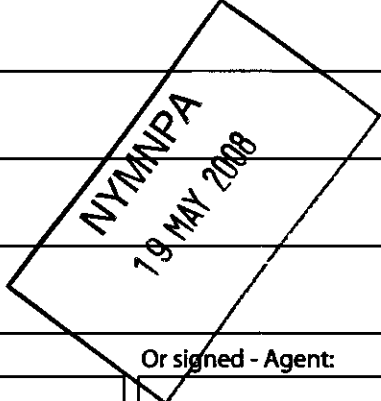

Signed - Applicant: Or signed - Agent: Date (DD/MM/YYYY):

CERTIFICATE OF OWNERSHIP - CERTIFICATE C

Town and Country Planning (General Development Procedure) Order 1995 Certificate under Article 7

I certify/ The applicant certifies that:

- Neither Certificate A or B can be issued for this application
- All reasonable steps have been taken to find out the names and addresses of the other owners (*owner is a person with a freehold interest or leasehold interest with at least 7 years left to run*) of the land or building, or of a part of it, but I have/ the applicant has been unable to do so.

The steps taken were:

Name of Owner	Address	Date Notice Served

Notice of the application has been published in the following newspaper (circulating in the area where the land is situated):

On the following date (which must not be earlier than 21 days before the date of the application):

Signed - Applicant: Or signed - Agent: Date (DD/MM/YYYY):

25. Certificates

One Certificate A, B, C, or D, must be completed, together with the Agricultural Holdings Certificate with this application form
CERTIFICATE OF OWNERSHIP - CERTIFICATE A

Town and Country Planning (General Development Procedure) Order 1995 Certificate under Article 7

I certify/The applicant certifies that on the day 21 days before the date of this application nobody except myself/ the applicant was the owner (owner is a person with a freehold interest or leasehold interest with at least 7 years left to run) of any part of the land or building to which the application relates.

Signed - Applicant: 	Or signed - Agent:	Date (DD/MM/YYYY): 9-6-08
---	--------------------	------------------------------

CERTIFICATE OF OWNERSHIP - CERTIFICATE B

Town and Country Planning (General Development Procedure) Order 1995 Certificate under Article 7

I certify/ The applicant certifies that I have/the applicant has given the requisite notice to everyone else (as listed below) who, on the day 21 days before the date of this application, was the owner (owner is a person with a freehold interest or leasehold interest with at least 7 years left to run) of any part of the land or building to which this application relates.

Name of Owner	Address	Date Notice Served

Signed - Applicant:	Or signed - Agent:	Date (DD/MM/YYYY):

CERTIFICATE OF OWNERSHIP - CERTIFICATE C

Town and Country Planning (General Development Procedure) Order 1995 Certificate under Article 7

I certify/ The applicant certifies that:

- Neither Certificate A or B can be issued for this application
- All reasonable steps have been taken to find out the names and addresses of the other owners (owner is a person with a freehold interest or leasehold interest with at least 7 years left to run) of the land or building, or of a part of it, but I have/the applicant has been unable to do so.

The steps taken were:

	NYMNPA	
	10 JUN 2008	

Name of Owner	Address	Date Notice Served

Notice of the application has been published in the following newspaper (circulating in the area where the land is situated):

On the following date (which must not be earlier than 21 days before the date of the application):

--	--

Signed - Applicant:	Or signed - Agent:	Date (DD/MM/YYYY):

25. Certificates (continued)

CERTIFICATE OF OWNERSHIP - CERTIFICATE D

Town and Country Planning (General Development Procedure) Order 1995 Certificate under Article 7

I certify/ The applicant certifies that:

- Certificate A cannot be issued for this application
- All reasonable steps have been taken to find out the names and addresses of everyone else who, on the day 21 days before the date of this application, was the owner (*owner is a person with a freehold interest or leasehold interest with at least 7 years left to run*) of any part of the land to which this application relates, but I have/ the applicant has been unable to do so.

The steps taken were:

Notice of the application has been published in the following newspaper (circulating in the area where the land is situated):

On the following date (which must not be earlier than 21 days before the date of the application):

Signed - Applicant:

Or signed - Agent:

Date (DD/MM/YYYY):

AGRICULTURAL HOLDINGS CERTIFICATE

Town and Country Planning (General Development Procedure) Order 1995 Certificate under Article 7

Agricultural Land Declaration - You Must Complete Either A or B

(A) None of the land to which the application relates is, or is part of, an agricultural holding.

Signed - Applicant:

Or signed - Agent:

Date (DD/MM/YYYY):

09-6-08

I have/ The applicant has given the requisite notice to every person other than myself/ the applicant who, on the day 21 days before the date of this application, was a tenant of an agricultural holding on all or part of the land to which this application relates, as listed below:

Name of Tenant	Address	Date Notice Served

Signed - Applicant:

Or signed - Agent:

Date (DD/MM/YYYY):

26. Planning Application Requirements - Checklist

Please read the following checklist to make sure you have sent all the information in support of your proposal. Failure to submit all information required will result in your application being deemed invalid. It will not be considered valid until all information required by the Local Planning Authority has been submitted.

- | | | | |
|--|--------------------------|---|--------------------------|
| 3 copies of a completed and dated application form: | <input type="checkbox"/> | The correct fee: | <input type="checkbox"/> |
| 3 copies of the plan which identifies the land to which the application relates drawn to an identified scale and showing the direction of North: | <input type="checkbox"/> | 3 copies of a design and access statement: | <input type="checkbox"/> |
| 3 copies of other plans and drawings or information necessary to describe the subject of the application: | <input type="checkbox"/> | 3 copies of the completed, dated Article 7 Certificate (Agricultural Holdings): | <input type="checkbox"/> |
| | | 3 copies of the completed, dated Ownership Certificate (A, B, C, or D - as applicable): | <input type="checkbox"/> |

27. Declaration

I/we hereby apply for planning permission/consent as described in this form and the accompanying plans/drawings and additional information.

Signed - Applicant:

Or signed - Agent:

Date (DD/MM/YYYY):

(date cannot be pre-application)

25. Certificates (continued)

CERTIFICATE OF OWNERSHIP - CERTIFICATE D

Town and Country Planning (General Development Procedure) Order 1995 Certificate under Article 7

I certify/ The applicant certifies that:

- Certificate A cannot be issued for this application
- All reasonable steps have been taken to find out the names and addresses of everyone else who, on the day 21 days before the date of this application, was the owner (*owner is a person with a freehold interest or leasehold interest with at least 7 years left to run*) of any part of the land to which this application relates, but I have/ the applicant has been unable to do so.

The steps taken were:

Notice of the application has been published in the following newspaper (circulating in the area where the land is situated):

On the following date (which must not be earlier than 21 days before the date of the application):

Signed - Applicant:

Or signed - Agent:

Date (DD/MM/YYYY)

16/5/08

AGRICULTURAL HOLDINGS CERTIFICATE

Town and Country Planning (General Development Procedure) Order 1995 Certificate under Article 7

Agricultural Land Declaration - You Must Complete Either A or B

(A) None of the land to which the application relates is, or is part of, an agricultural holding.

HOUSING CERT 48/501/800

Signed - Applicant:

Or signed - Agent:

Date (DD/MM/YYYY)

B) I have/ The applicant has given the requisite notice to every person other than myself/ the applicant who, on the day 21 days before the date of this application, was a tenant of an agricultural holding on all or part of the land to which this application relates, as listed below:

Name of Tenant	Address	Date Notice Served
	NYVINPA 19 MAY 2008	

Signed - Applicant:

Or signed - Agent:

Date (DD/MM/YYYY)

26. Planning Application Requirements - Checklist

Please read the following checklist to make sure you have sent all the information in support of your proposal. Failure to submit all information required will result in your application being deemed invalid. It will not be considered valid until all information required by the Local Planning Authority has been submitted.

- | | | | |
|--|-------------------------------------|---|-------------------------------------|
| 3 copies of a completed and dated application form: | <input checked="" type="checkbox"/> | The correct fee: | <input checked="" type="checkbox"/> |
| 3 copies of the plan which identifies the land to which the application relates drawn to an identified scale and showing the direction of North: | <input checked="" type="checkbox"/> | 3 copies of a design and access statement: | <input checked="" type="checkbox"/> |
| 3 copies of other plans and drawings or information necessary to describe the subject of the application: | <input checked="" type="checkbox"/> | 3 copies of the completed, dated Article 7 Certificate (Agricultural Holdings): | <input checked="" type="checkbox"/> |
| | | 3 copies of the completed, dated Ownership Certificate (A, B, C, or D - as applicable): | <input checked="" type="checkbox"/> |

27. Declaration

I/we hereby apply for planning permission/consent as described in this form and the accompanying plans/drawings and additional information.

Signed - Applicant:

Or signed - Agent:

Date (DD/MM/YYYY):

16/5/08

(date cannot be pre-applied)

28. Applicant Contact Details

Telephone numbers

Country code: National number: Extension number:

[Redacted] [Redacted] N/A

Country code: Mobile number (optional):

[Redacted] [Redacted]

Country code: Fax number (optional):

[Redacted] [Redacted]

Email address (optional):

[Redacted]

29. Agent Contact Details

Telephone numbers

Country code: National number: Extension number:

[Redacted] [Redacted] [Redacted]

Country code: Mobile number (optional):

[Redacted] [Redacted]

Country code: Fax number (optional):

[Redacted] [Redacted]

Email address (optional):

[Redacted]

30. Site Visit

Can the site be seen from a public road, public footpath, bridleway or other public land? Yes No

If the planning authority needs to make an appointment to carry out a site visit, whom should they contact? (Please select only one) Agent Applicant Other (if different from the agent/applicant's details)

If Other has been selected, please provide:

Contact name: Telephone number:

[Redacted] [Redacted]

Email address: [Redacted]

NYMNP
19 MAY 2008



Est. 1887

RICHARDSON & SMITH

Chartered Surveyors

• Auctioneers

• Valuers

• Estate Agents

Planning Department
 North York Moors National Park Authority
 The Old Vicarage
 Bondgate
 Helmsley
 York
 YO62 5BP

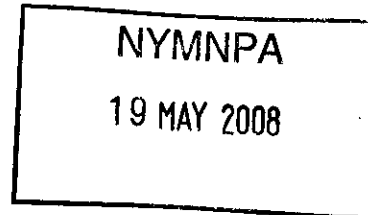

16 May 2008

Dear Sir/Madam

Re: Planning Application – Ruswarp Livestock Market

Further to the above, I am writing a brief covering letter in support of our planning application. As operators of Ruswarp Livestock Market, Richardson and Smith have recently been awarded a grant from the National Park Sustainable Development Fund (ref. Janine Morley) for the upgrade of the lorry washing facilities based at our Ruswarp premises. This upgrade is basically via the installation of 2 underground storage tanks of 2000 gallons each, which are being installed to collect the surface rain water which can then be utilised through the existing lorry wash facilities. Additionally, there will be an extra wash off point installed and some upgrading of the concrete aprons and surrounds for the existing facility. All such upgrades will merely be replacement/repairs to the concrete road aprons and breeze block sleeper walls which are at the maximum 3 blocks high.

The existing lorry wash is situated on the edge of the market adjacent to the main car park with 2 existing access points onto the highway.

In a telephone conversation with your planning department, I was informed that the installation of underground storage tanks constituted development and therefore would need to be subject to a formal planning application, but do not feel that there is a great deal to be said regarding access or design characteristics of the scheme as they will both be buried underground.

Should you require any further details please do not hesitate to contact me or else Janine Morley of the Sustainable Development Fund situated at your Helmsley office is fully aware of all aspects of this scheme as she was the officer in charge of awarding us grant aid.

Yours sincerely,



Ian K Halley FRICS

email: ia@richardsonandsmith.co.uk

www.richardsonandsmith.co.uk



8 Victoria Square, Whitby, North Yorkshire. YO21 1EA
 Tel: (01947) 602298 Fax: (01947) 820594



Partners: K.E. Halley FRICS F.A.W. R.C. Smith I.K. Halley FRICS J.E.J. Smith MRICS F.N.A.E.A.



RICHARDSON & SMITH

Chartered Surveyors

Auctioneers

Valuers

Estate Agents

Miss W Trousdale
 Planning Administration Officer
 North York Moors National Park Authority
 The Old Vicarage
 Bondgate
 Helmsley
 York
 YO62 5BP

9th June 2008

Dear Miss Trousdale

Re : Application for Installation of water tanks, Ruswarp Market
Your Ref : NYM/2008/0393/NEW

Further to your letter dated 28th May 2008. Please find below details requested to continue with our above Planning Application.

1. Please find attached two copies of the agricultural holdings certificate which have been signed and dated.
2. The scale of the location plan supplied is 1:2500.
3. The details of the tanks to be used are as follows
 - a. Capacity – 2000 gallons
 - b. Colour - Grey
 - c. Shape – cylinder
 - d. Measurements – 2 metres x 3 metres.

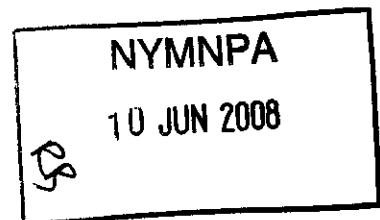

I hope that this information will now enable you to process our planning application.

Yours sincerely

 I/K Halley, FRICS