

SIDE VIEW

Larch Lat Fence Pennell.

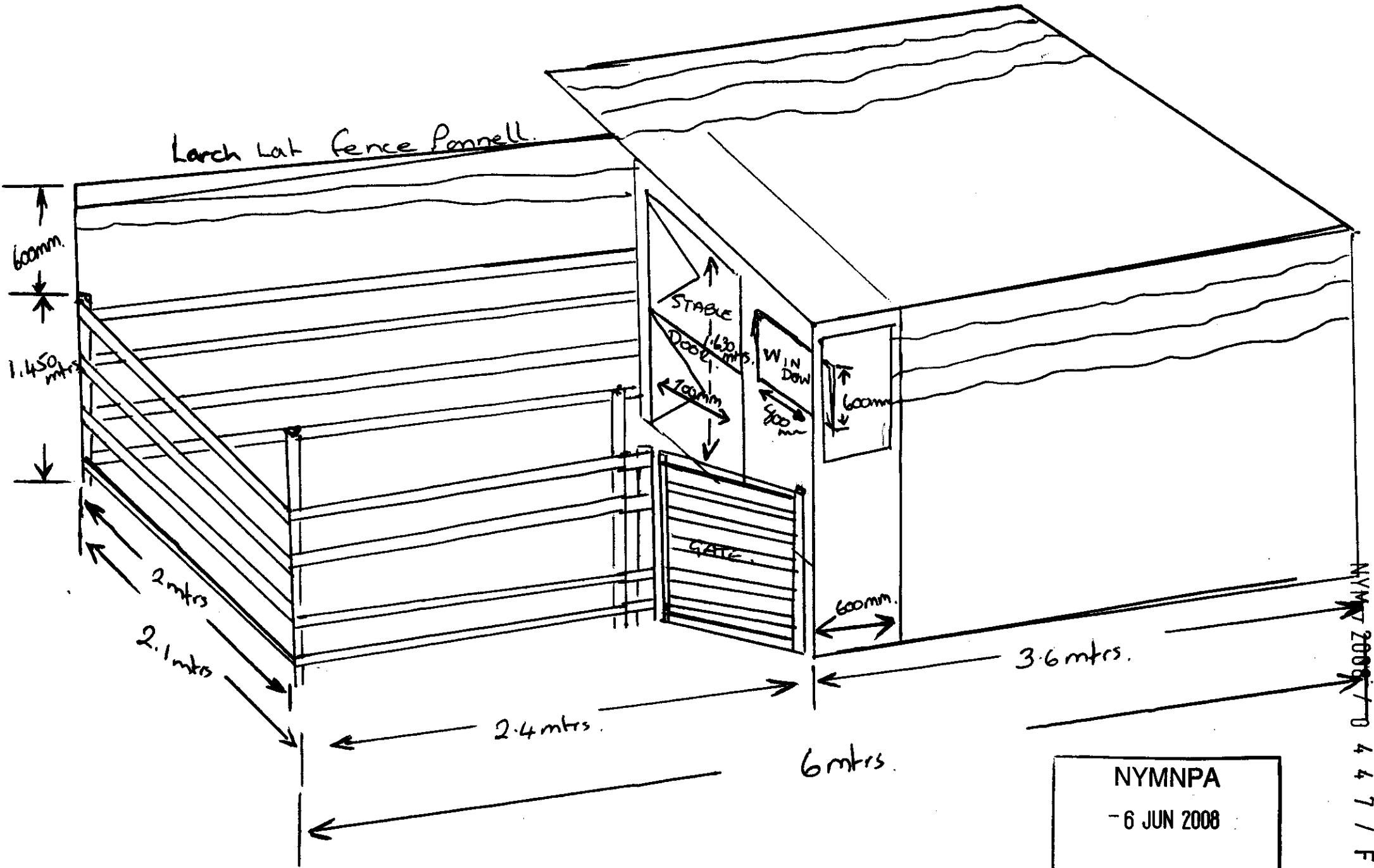

NYMNPA
- 6 JUN 2008

NYMNPA 2008/0447/FL

END VIEW

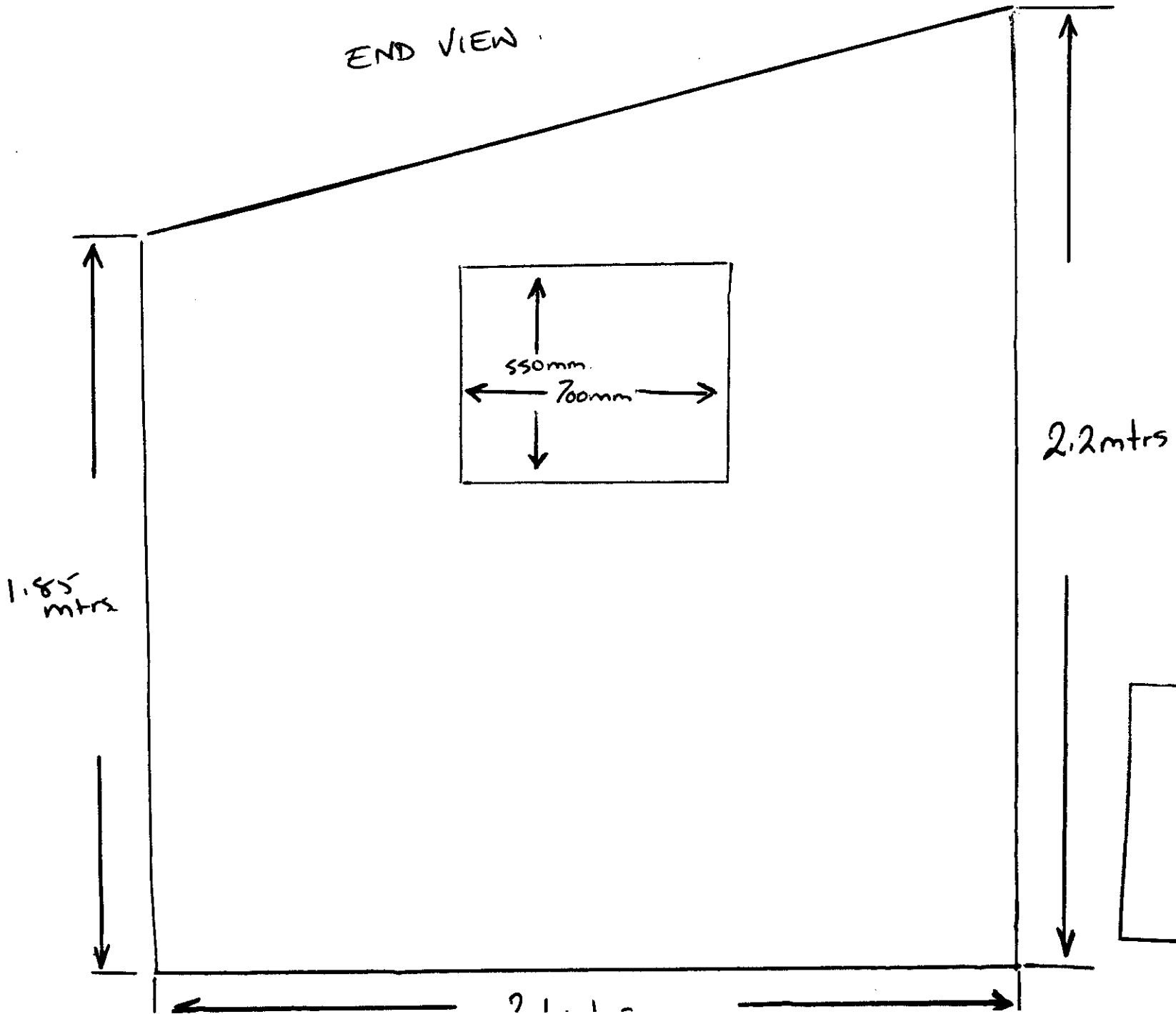

NYM/NPA
- 6 JUN 2008

NYM / 2008 / 0 4 4 7 / F L

NYM / 2008 / 0-4-7 / FL
1:2500

NYMNP
20 JUN 2008

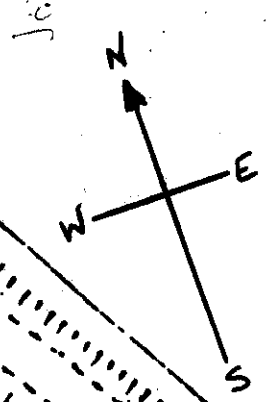

H M Coastguard
Rescue Equipment
Station

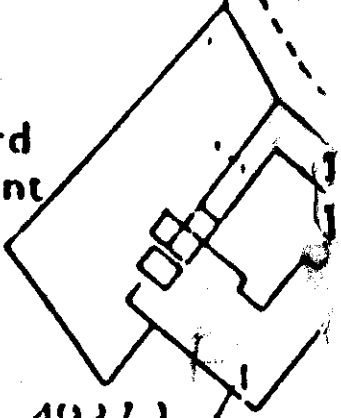

1937
11/11/11

Dismantled

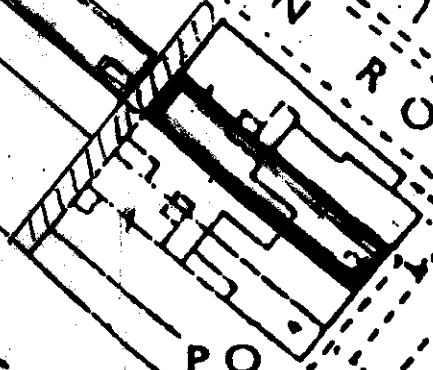

STATION SQUARE
NEW LIVER RAILWAY

3325
425ha
105

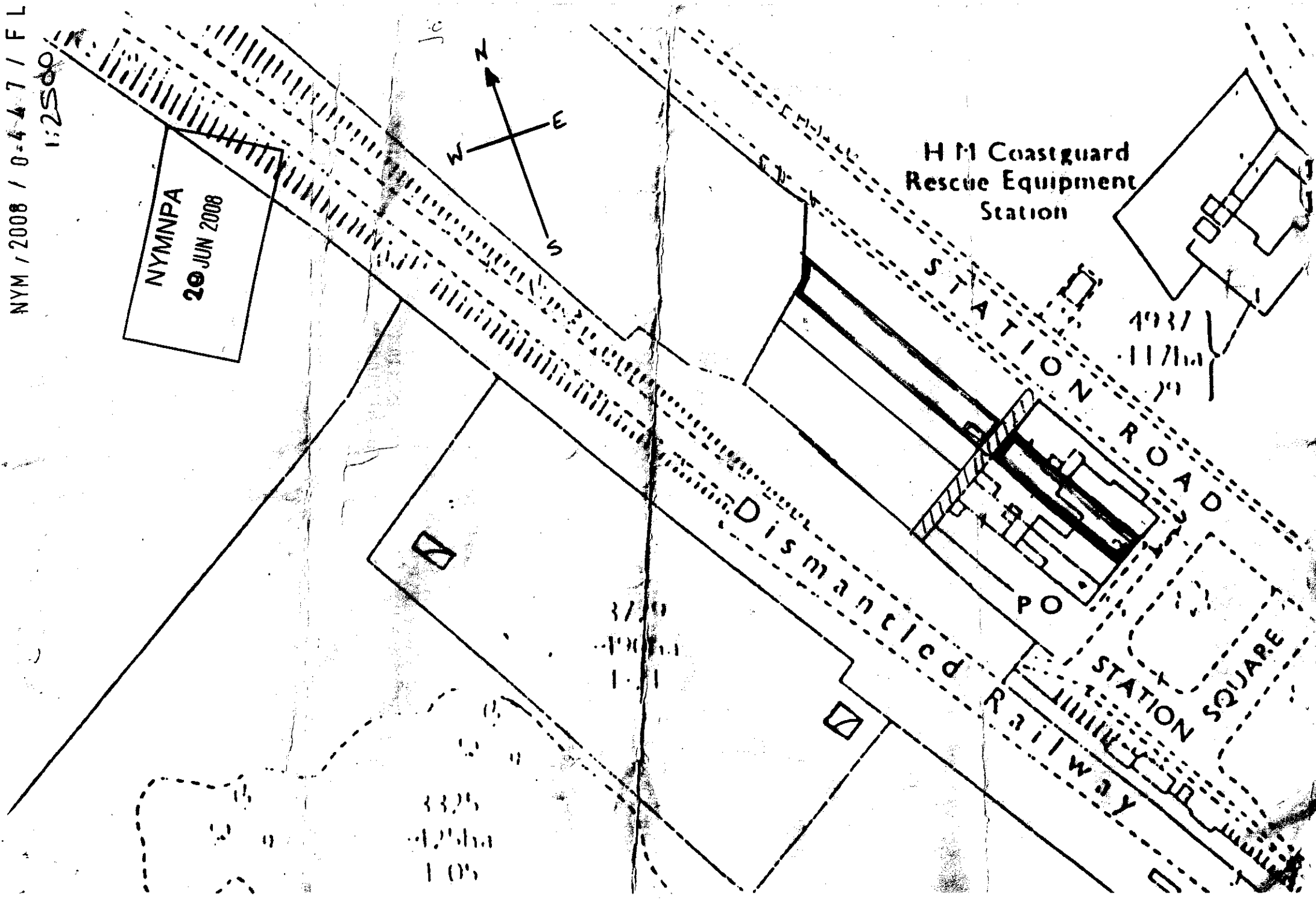

Rescue Equipment Station

2000000000

193
1171
21
RO

DISMANCLO

PO

3/20

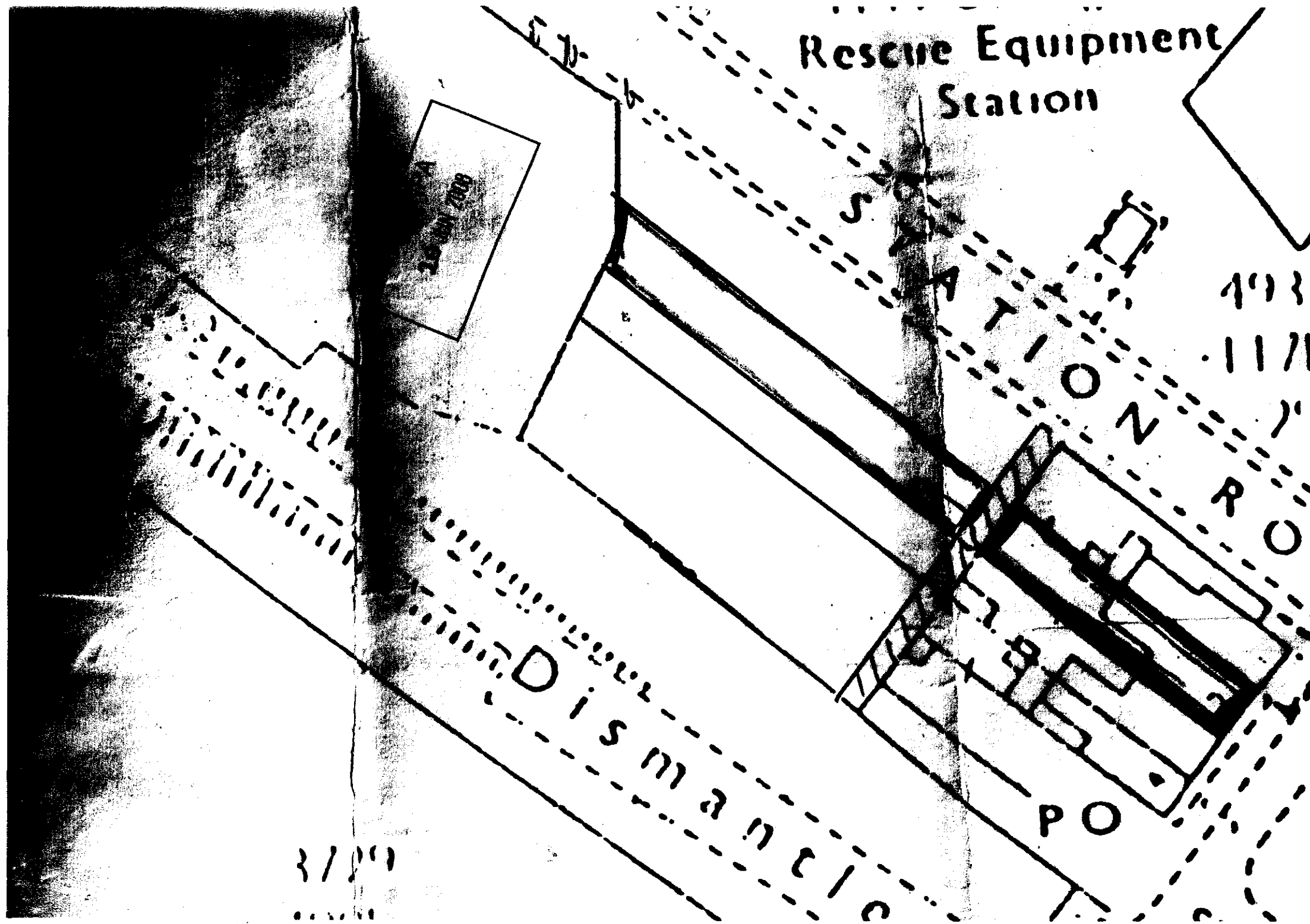



North York Moors National Park Authority
 The Old Vicarage
 Bondgate
 Helmsley
 York
 YO62 5BP

08/0447

pt. 1

Telephone: 01439 770657
 Email: dc@northyorkmoors-npa.gov.uk
 Website: www.moors.nk.net

Householder Application for Planning Permission for works or extension to a dwelling.
 Town and Country Planning Act 1990

Publication of planning applications on council websites

Please note that with the exception of applicant contact details and Certificates of Ownership, the information provided on this application form and in supporting documents may be published on the council's website.

If you have provided any other information as part of your application which falls within the definition of personal data under the Data Protection Act which you do not wish to be published on the council's website, please contact the council's planning department.

Please complete using block capitals and black ink.

It is important that you read the accompanying guidance notes as incorrect completion will delay the processing of your application.

1. Applicant Name and Address

Title: First name:

Last name:

Company (optional):

Unit: House number: House suffix:

House name:

Address 1:

Address 2:

Address 3:

Town:

County:

Country:

Postcode:

2. Agent Name and Address

Title: First name:

Last name:

Company (optional):

Unit: House number: House suffix:

House name:

Address 1:

Address 2:

Address 3:

Town:

County:

Country:

Postcode:

3. Description of Proposed Works

Please describe the proposed works:

A TIMBER SHED AND HOLDING PEN FOR 2 GOATS

NYMNPA
 - 6 JUN 2008

3. Description of Proposed Works (continued):

Has the work already been started without planning permission? Yes No

If Yes, please state when the works were started (DD/MM/YYYY):

01/05/2008

(date must be pre-application submission)

Has the work already been completed without planning permission? Yes No

If Yes, please state when the works were completed (DD/MM/YYYY):

/ /

(date must be pre-application submission)

4. Site Address Details

Please provide the full postal address of the application site.

Unit: House number: House suffix:

House name:

Address 1:

Address 2:

Address 3:

Town:

County:

Postcode (optional):

5. Pedestrian and Vehicle Access, Roads and Rights of Way

Is a new or altered vehicle access proposed to or from the public highway? Yes No

Is a new or altered pedestrian access proposed to or from the public highway? Yes No

Do the proposals require any diversions, extinguishments and/or creation of public rights of way? Yes No

If Yes to any questions, please show details on your plans or drawings and state the reference number(s) of the plan(s)/drawing(s):

/

6. Pre-application Advice

Has assistance or prior advice been sought from the local authority about this application? Yes No

If Yes, please complete the following information about the advice you were given. (This will help the authority to deal with this application more efficiently).

Please tick if the full contact details are not known, and then complete as much possible:

Officer name:

Reference:

Date (DD MM YYYY): (must be pre-application submission)

Advice given:

7. Trees and Hedges

Are there any trees or hedges on your own property or on adjoining properties which are within falling distance of your boundary? Yes No

If Yes, please mark their position on a scaled plan and state the reference number of any plans or drawings:

/

Will any trees or hedges need to be removed or pruned in order to carry out your proposal? Yes No

If Yes, please show on your plans, indicating the scale, which trees by giving them numbers e.g. T1, T2 etc. and state the reference number of any plans or drawings:

NYMNPA
- 6 JUN 2008

8. Parking

Will the proposed works affect existing car parking arrangements? Yes No

If Yes, please describe:

9. Council Employee Member

Is the applicant or agent related to any member of staff or elected member of the Council? Yes No

If Yes, please provide details:

10. Materials

If applicable, please state what materials are to be used externally. Include type, colour and name for each material:

	Existing (where applicable)	Proposed	Not applicable	Don't Know	Drawing references if applicable
Walls	Local Larch		<input type="checkbox"/>	<input type="checkbox"/>	
Roof	LOCAL LARCH		<input type="checkbox"/>	<input type="checkbox"/>	
Windows		2 Small UPVC WINDOWS. Plastic TO BE OVERLAIN WITH LARCH.	<input type="checkbox"/>	<input type="checkbox"/>	
Doors	1. TIMBER STABLE DOOR.		<input type="checkbox"/>	<input type="checkbox"/>	
Boundary treatments (e.g. fences, walls)	UNTREATED TIMBER	TO BE WOOD PRESERVED IN DARK STAIN.	<input type="checkbox"/>	<input type="checkbox"/>	
Vehicle access and hard-standing	N/A.		<input type="checkbox"/>	<input type="checkbox"/>	
Lighting	NONE.		<input type="checkbox"/>	<input type="checkbox"/>	
Others (please specify)		NYMNPA - 6 JUN 2008	<input type="checkbox"/>	<input type="checkbox"/>	

Are you supplying additional information on submitted plan(s)/drawing(s)/design and access statement? Yes No

If Yes, please state references for the plan(s)/drawing(s)/design and access statement:

11. Certificates

One Certificate A, B, C, or D, must be completed, together with the Agricultural Holdings Certificate with this application form

CERTIFICATE OF OWNERSHIP - CERTIFICATE A

Town and Country Planning (General Development Procedure) Order 1995 Certificate under Article 7

I certify/The applicant certifies that on the day 21 days before the date of this application nobody except myself/ the applicant was the owner (owner is a person with a freehold interest or leasehold interest with at least 7 years left to run) of any part of the land or building to which the application relates.

Signed - Applicant:

Or signed - Agent:

Date (DD/MM/YYYY):

[Redacted Signature]

[Redacted Signature]

02 | 06 | 08

CERTIFICATE OF OWNERSHIP - CERTIFICATE B

Town and Country Planning (General Development Procedure) Order 1995 Certificate under Article 7

I certify/ The applicant certifies that I have/the applicant has given the requisite notice to everyone else (as listed below) who, on the day 21 days before the date of this application, was the owner (owner is a person with a freehold interest or leasehold interest with at least 7 years left to run) of any part of the land or building to which this application relates.

Name of Owner	Address	Date Notice Served

Signed - Applicant:

Or signed - Agent:

Date (DD/MM/YYYY):

[Redacted Signature]

[Redacted Signature]

[Redacted Date]

CERTIFICATE OF OWNERSHIP - CERTIFICATE C

Town and Country Planning (General Development Procedure) Order 1995 Certificate under Article 7

I certify/ The applicant certifies that:

- Neither Certificate A or B can be issued for this application
- All reasonable steps have been taken to find out the names and addresses of the other owners (owner is a person with a freehold interest or leasehold interest with at least 7 years left to run) of the land or building, or of a part of it, but I have/ the applicant has been unable to do so.

The steps taken were:

[Redacted Text]

Name of Owner	Address	Date Notice Served
	<div style="border: 1px solid black; padding: 5px; width: fit-content; margin: 0 auto;"> <p>NYMNPA - 6 JUN 2008</p> </div>	

Notice of the application has been published in the following newspaper (circulating in the area where the land is situated):

On the following date (which must not be earlier than 21 days before the date of the application):

[Redacted Newspaper Name]

[Redacted Date]

Signed - Applicant:

Or signed - Agent:

Date (DD/MM/YYYY):

[Redacted Signature]

[Redacted Signature]

[Redacted Date]

11. Certificates

One Certificate A, B, C, or D, must be completed, together with the Agricultural Holdings Certificate with this application form
CERTIFICATE OF OWNERSHIP - CERTIFICATE A

Town and Country Planning (General Development Procedure) Order 1995 Certificate under Article 7

I certify/The applicant certifies that on the day 21 days before the date of this application nobody except myself/ the applicant was the owner (owner is a person with a freehold interest or leasehold interest with at least 7 years left to run) of any part of the land or building to which the application relates.

Signed - Applicant:

Or signed - Agent:

Date (DD/MM/YYYY):

CERTIFICATE OF OWNERSHIP - CERTIFICATE B

Town and Country Planning (General Development Procedure) Order 1995 Certificate under Article 7

I certify/ The applicant certifies that I have/the applicant has given the requisite notice to everyone else (as listed below) who, on the day 21 days before the date of this application, was the owner (owner is a person with a freehold interest or leasehold interest with at least 7 years left to run) of any part of the land or building to which this application relates.

Name of Owner	Address	Date Notice Served

Signed - Applicant:

Or signed - Agent:

Date (DD/MM/YYYY):

CERTIFICATE OF OWNERSHIP - CERTIFICATE C

Town and Country Planning (General Development Procedure) Order 1995 Certificate under Article 7

I certify/ The applicant certifies that:

- Neither Certificate A or B can be issued for this application
- All reasonable steps have been taken to find out the names and addresses of the other owners (owner is a person with a freehold interest or leasehold interest with at least 7 years left to run) of the land or building, or of a part of it, but I have/ the applicant has been unable to do so.

The steps taken were:

Name of Owner	Address	Date Notice Served

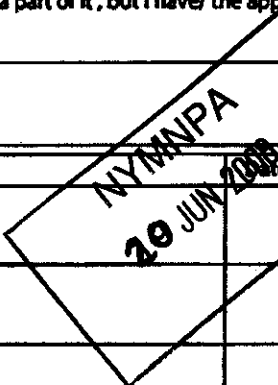

Notice of the application has been published in the following newspaper (circulating in the area where the land is situated):

On the following date (which must not be earlier than 21 days before the date of the application):

Signed - Applicant:

Or signed - Agent:

Date (DD/MM/YYYY):

08/447

11. Certificates (continued)

CERTIFICATE OF OWNERSHIP - CERTIFICATE D

Town and Country Planning (General Development Procedure) Order 1995 Certificate under Article 7

I certify/ The applicant certifies that:

- Certificate A cannot be issued for this application
- All reasonable steps have been taken to find out the names and addresses of everyone else who, on the day 21 days before the date of this application, was the owner (owner is a person with a freehold interest or leasehold interest with at least 7 years left to run) of any part of the land to which this application relates, but I have/ the applicant has been unable to do so.

The steps taken were:

Notice of the application has been published in the following newspaper (circulating in the area where the land is situated):

On the following date (which must not be earlier than 21 days before the date of the application):

Signed - Applicant:

Or signed - Agent:

Date (DD/MM/YYYY):

AGRICULTURAL HOLDINGS CERTIFICATE

Town and Country Planning (General Development Procedure) Order 1995 Certificate under Article 7

Agricultural Land Declaration - You Must Complete Either A or B

(A) None of the land to which the application relates is, or is part of, an agricultural holding.

Signed - Applicant:

Or signed - Agent:

Date (DD/MM/YYYY):

17/06/08

B) I have/ The applicant has given the requisite notice to every person other than myself/ the applicant who, on the day 21 days before the date of this application, was a tenant of an agricultural holding on all or part of the land to which this application relates, as listed below:

Name of Tenant	Address	Date Notice Served

NYMNPA

20 JUN 2008

Signed - Applicant:

Or signed - Agent:

Date (DD/MM/YYYY):

12. Planning Application Requirements - Checklist

Please read the following checklist to make sure you have sent all the information in support of your proposal. Failure to submit all information required will result in your application being deemed invalid. It will not be considered valid until all information required by the Local Planning Authority has been submitted.

- | | | |
|---|---|---|
| 3 copies of a completed and dated application form: <input type="checkbox"/> | 3 copies of a design and access statement where proposed works fall within one of the following designated areas: <input type="checkbox"/> <ul style="list-style-type: none"> • National Park • Site of special scientific interest • Conservation area • Area of outstanding natural beauty • World Heritage Site • The Broads | The correct fee: <input type="checkbox"/> |
| 3 copies of a plan which identifies the land to which the application relates drawn to an identified scale and showing the direction of North: <input type="checkbox"/> | | 3 copies of the completed, dated Article 7 Certificate (Agricultural Holdings): <input type="checkbox"/> |
| 3 copies of other plans and drawings or information necessary to describe the subject of the application: <input type="checkbox"/> | | 3 copies of the completed, dated Ownership Certificate (A, B, C or D - as applicable): <input type="checkbox"/> |

13. Declaration

I/we hereby apply for planning permission/consent as described in this form and the accompanying plans/drawings and additional information.

Signed - Applicant:

Or signed - Agent:

Date (DD/MM/YYYY):

(date cannot be pre-application)

Design Aspects for goat shed and holding pen.

whilst planning and undertaking construction of our Goat Shed and holding pen, we planned an average floor space per 2 adult animals to live comfortably including an outdoor shelter, as the animals dislike rain.

Inter floor space being 3 Metres - 2.1 metres. Outer space being 3m-2m

When choosing materials, we used matching timber (locally sourced to our other shed and fencing, which after preservation treatment, naturalizes quickly. At the adjoining boundary to our 'neighbour' at No 3 we have put a secure fence to protect her' property from damage by the goats.

Crime prevention measures (as the animals will be of high quality breed and expensive to replace - they will be ~~sep~~ separately insured) will be padlocked during the night.

Scale - Height - 2.2 metres
width - 2.1 metres
length - 6 Mts.



landscaping - Due to our already mature gardens - we scaled the Goat Shed and pen to be almost hidden by our existing planting.

Appearance Using local larch (unplanned) for a natural look - will be preserved in a dark colour ~~at~~ which naturalizes quickly

Access - No public access necessary - our own access from our back door to our own garden through a gate.

MRS V HERSON

2 STATION SQ,

RAVENSCAR

SCARBOROUGH

YO13 0LU.



DEPARTMENT FOR ENVIRONMENT, FOOD AND RURAL AFFAIRS

Animal Health

Government Buildings, Otley Road, Leeds, LS16 5PZ

Telephone: [REDACTED] Fax: [REDACTED]

BRINKA HOUSE B & B
2 STATION SQUARE
RAVENSCAR
SCARBOROUGH
YO13 0LU

Your reference:

Our reference:

Date: 12 MAY 2008

HOLDING REGISTRATION DOCUMENT

This document is to confirm that: **BRINKA HOUSE B & B**
of the above address and with a County/Parish/Holding number of: **48/185/0139**
is the registered keeper of the following herds/flocks:

<u>Herd/Flock Type</u>	<u>Herd/Flock Mark</u>	<u>Herd/Flock CPI</u>
GOATS	133431	48/185/0139/01

Please note that the CPHH listed above consists of a combination of your County, Parish, Holding Number and a Herd mark or Flock mark to identify different groupings of animals.

Please tell your Animal Health Office within one month if any of the information is incorrect or if any of the details change. If the information is correct you need take no further action.

Should you have any queries over the contents of this document, please contact

W. Kennington on Ext. *559* at the above telephone number.

PLEASE RETAIN THIS HOLDING REGISTRATION DOCUMENT FOR YOUR RECORDS

NYMNPA
- 6 JUN 2008