

Scale
1:25000

Date
FEBRUARY 2001

Reproduced from the Ordnance Survey map with the permission of the Controller of Her Majesty's Stationery Office. Crown copyright reserved.

This map is for identification purposes only and should not be relied upon for accuracy.

870
 2008
 10
 2
 F L

NYM / 2008 / 0870 / FL

7.02

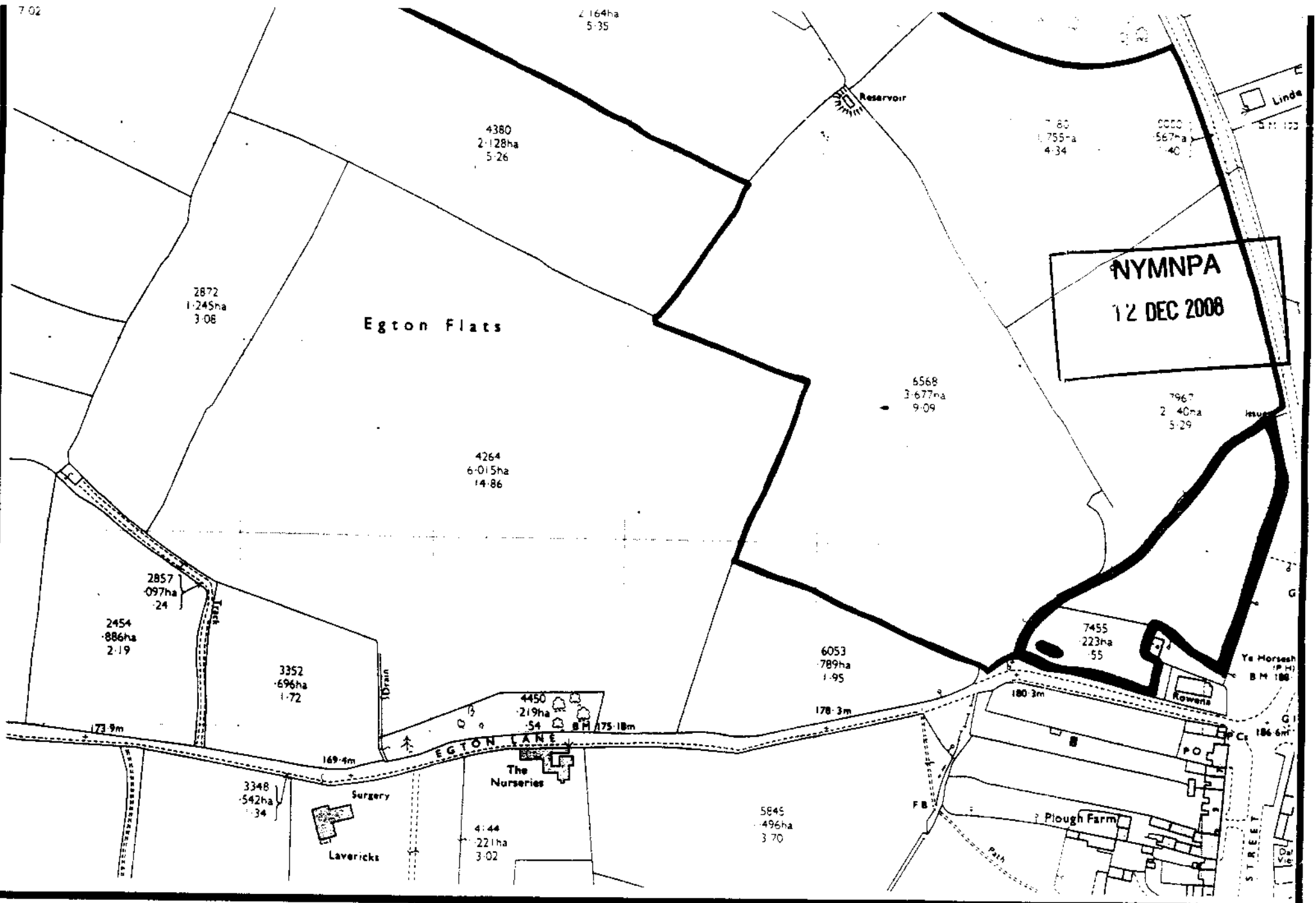

Scale
1:25000

Date
FEBRUARY 2001

NYMNPA
27 NOV 2008

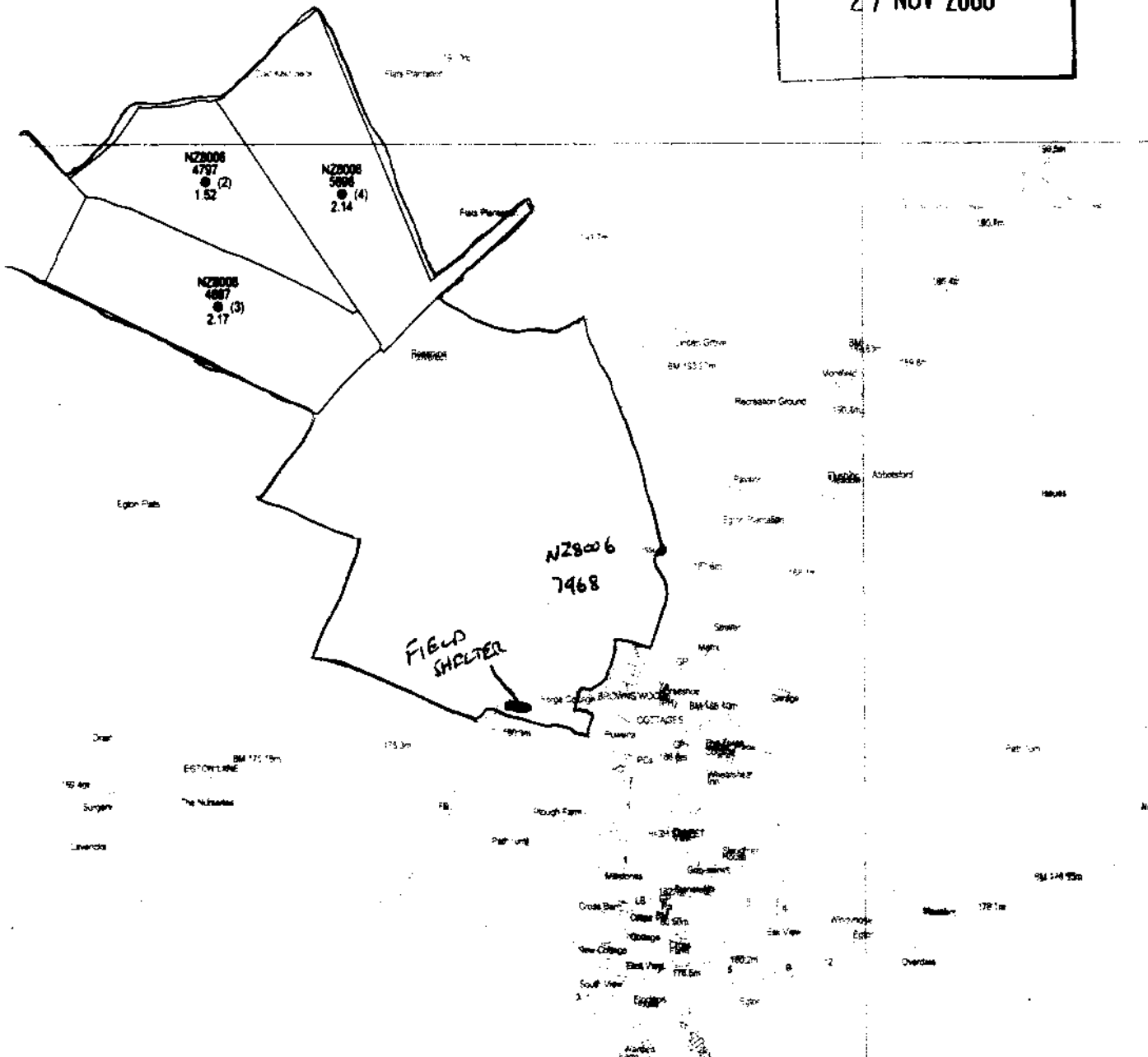

| | | | | | |
|---|--------|------|------|------|---|
| 3 | NZ8006 | 4887 | 2.17 | 2.17 | ✓ |
| 4 | NZ8006 | 5896 | 2.14 | 2.14 | ✓ |
| | | | | | |
| | | | | | |
| | | | | | |
| | | | | | |
| | | | | | |
| | | | | | |
| | | | | | |
| | | | | | |
| | | | | | |
| | | | | | |
| | | | | | |
| | | | | | |
| | | | | | |
| | | | | | |
| | | | | | |
| | | | | | |
| | | | | | |
| | | | | | |
| | | | | | |
| | | | | | |

Print Name :

Signed : Date :



Scale 1:5000

Date printed : 26/03/2005

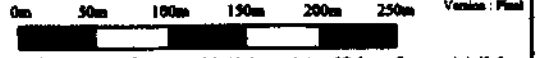

This map is reproduced from Ordnance Survey material with the permission of Ordnance Survey on behalf of the Controller of Her Majesty's Stationery Office. © Crown copyright. Unauthorised reproduction infringes Crown copyright and may lead to prosecution or civil proceedings. DEFRA License No 100016000 2005

NYM / 2008 / 0870 / FL



Grid ref N280714, 06S43

08/0810 pt.1

Telephone: 01438 770657
Email: dc@northyorkmoors-npa.gov.uk
Website: www.moors.uk.net

Application for Planning Permission.
Town and Country Planning Act 1990

Publication of planning applications on council websites

Please note that with the exception of applicant contact details and Certificates of Ownership, the information provided on this application form and in supporting documents may be published on the council's website.

If you have provided any other information as part of your application which falls within the definition of personal data under the Data Protection Act which you do not wish to be published on the council's website, please contact the council's planning department.

Please complete using block capitals and black ink.

It is important that you read the accompanying guidance notes as incorrect completion will delay the processing of your application.

1. Applicant Name and Address

Title: First name:

Last name:

Company (optional):

Unit: House number: House suffix:

House name:

Address 1:

Address 2:

Address 3:

Town:

County:

Country:

Postcode:

2. Agent Name and Address

Title: First name:

Last name:

Company (optional):

Unit: House number: House suffix:

House name:

Address 1:

Address 2:

Address 3:

Town:

County:

Country:

Postcode:

NYM NPA
27 NOV 2008

3. Description of Proposed Works

Please describe the proposed works:

CHANGE OF USE FROM TEMPORARY FIELD SHELTER TO PERMANENT STRUCTURE IN FIELD NO. NZ8006 REF. 7968 BEHIND HOUSES IN EGTON

YOUR LETTER REF 182/2008 BARRY THOMSON.

Has building or works already been carried out or use of land already started? Yes No

If Yes, please state the date when building works or use were started (DD/MM/YYYY): (date must be pre-application submission)

Have the works been completed or change of use already occurred? Yes No

If Yes, please state when the works were completed or use occurred (DD/MM/YYYY): (date must be pre-application submission)

4. Site Address Details

Please provide the full postal address of the application site.

Unit: House number: House suffix:

House name:

Address 1:

Address 2:

Address 3:

Town:

County:

Postcode (optional):

Description of location or a grid reference. (must be completed if postcode is not known):

Easting: Northing:

Description:

*FIELD BEHIND HOUSES IN ECTON.
SEE LETTER REF 182/2008.*

5. Pre-application Advice

Has assistance or prior advice been sought from the local authority about this application? Yes No

If Yes, please complete the following information about the advice you were given. (This will help the authority to deal with this application more efficiently). Please tick if the full contact details are not known, and then complete as much as possible:

Officer name: *HARRY THOMPSON*

Reference:

Date (DD/MM/YYYY): (must be pre-application submission)

Details of pre-application advice received?

SEE LETTER REF 182/2008

6. Pedestrian and Vehicle Access, Roads and Rights of Way

Is a new or altered vehicle access proposed to or from the public highway? Yes No Unknown

Is a new or altered pedestrian access proposed to or from the public highway? Yes No Unknown

Are there any new public roads to be provided within the site? Yes No Unknown

Are there any new public rights of way to be provided within or adjacent to the site? Yes No Unknown

Do the proposals require any diversions /extinguishments and/or creation of rights of way? Yes No Unknown

If you answered Yes to any of the above questions, please show details on your plans/drawings and state the reference of the plan (s)/drawings(s)

7. Waste Storage and Collection

Do the plans incorporate areas to store and aid the collection of waste? Yes No Unknown

If Yes, please provide details:

Have arrangements been made for the separate storage and collection of recyclable waste? Yes No Unknown

If Yes, please provide details:

*NYMNPA
27 NOV 2008*

8. Neighbour and Community Consultation

Have you consulted your neighbours or the local community about the proposal? Yes No

If Yes please provide details:

9. Council Employee / Member

Is the applicant or agent related to any member of staff or elected member of the Council? Yes No

If Yes, please provide details:

Materials

role, please state what materials are to be used externally. Include type, colour and name for each material:

| | Existing (where applicable) | Proposed | Not applicable | Don't Know | Drawing references if applicable |
|---|--------------------------------|----------|--------------------------|--------------------------|----------------------------------|
| Walls | WOOD | | <input type="checkbox"/> | <input type="checkbox"/> | |
| Roof | FELT | | <input type="checkbox"/> | <input type="checkbox"/> | |
| Windows | | | <input type="checkbox"/> | <input type="checkbox"/> | |
| Doors | WOOD | | <input type="checkbox"/> | <input type="checkbox"/> | |
| Boundary treatments (e.g. fences, walls) | | | <input type="checkbox"/> | <input type="checkbox"/> | |
| Vehicle access and hard-standing | | | <input type="checkbox"/> | <input type="checkbox"/> | |
| Lighting | | | <input type="checkbox"/> | <input type="checkbox"/> | |
| Others (please specify) | | | <input type="checkbox"/> | <input type="checkbox"/> | |

Are you supplying additional information on submitted plan(s)/drawing(s)/design and access statement? Yes No

If Yes, please state references for the plan(s)/drawing(s)/design and access statement:

NYM NPA
27 NOV 2008

11. Vehicle Parking

Please provide information on the existing and proposed number of on-site parking spaces:

| Type of Vehicle | Total Existing | Total proposed (including spaces retained) | Difference in spaces |
|--|----------------|--|----------------------|
| Cars | | | |
| Light goods vehicles/ public carrier vehicles | | | |
| Motorcycles | | | |
| Disability spaces | | | |
| Cycle spaces | | | |
| Other (e.g. Bus) | | | |
| Other (e.g. Bus) | | | |

NOT APPLICABLE

12. Foul Sewage

Please state how foul sewage is to be disposed of:

- Mains sewer
- Cess pit
- Septic tank
- Other
- Package treatment plant
- Unknown

Are you proposing to connect to the existing drainage system? Yes No

If Yes, please include the details of the existing system on the application drawings and state references for the plan(s)/drawing(s):

N/A.

13. Assessment of Flood Risk

Is the site within an area at risk of flooding? (Refer to the Environment Agency's Flood Map showing flood zones 2 and consult Environment Agency standing advice and your local planning authority requirements for information as necessary.)

- Yes No

If Yes, you will need to submit a Flood Risk Assessment to consider the risk to the proposed site.

Is your proposal within 20 metres of a watercourse (e.g. river, stream or beck)? Yes No

Will the proposal increase the flood risk elsewhere? Yes No Unknown

How will surface water be disposed of?

- Sustainable drainage system
- Existing watercourse
- Soakaway
- Pond/lake
- Main sewer
- Unknown

14. Biodiversity and Geological Conservation

Is there a reasonable likelihood of the following being affected adversely or conserved and enhanced within the application site, or on land adjacent to or near the application site?

a) Protected and priority species:

- Yes, on the development site
- Yes, on land adjacent to or near the proposed development
- No

b) Designated sites, important habitats or other biodiversity features:

- Yes, on the development site
- Yes, on land adjacent to or near the proposed development
- No

c) Features of geological conservation importance:

- Yes, on the development site
- Yes, on land adjacent to or near the proposed development
- No

15. Existing Use

Please describe the current use of the site:

TEMPORARY FIELD SHEDS

Is the site currently vacant? Yes No

If Yes, please describe the last use of the site:

When did this use end (if known)? DD/MM/YYYY (date where known may be approximate)

Does the proposal involve any of the following:

Land which is known to be contaminated? Yes No

Land where contamination is suspected for all or part of the site? Yes No

A proposed use that would be particularly vulnerable to the presence of contamination? Yes No

If you have answered Yes to any of the above, you will need to submit an appropriate contamination assessment.

16. Trees and Hedges

Are there trees or hedges on the proposed development site? Yes No

And/or: Are there trees or hedges on land adjacent to the proposed development site that could influence the development or might be important as part of the local landscape character? Yes No

If Yes to either or both of the above, you will need to provide a full Tree Survey, with accompanying plan before your application can be determined. Your Local Planning Authority should make clear on its website what the survey should contain, in accordance with the current 'BS5837: Trees in relation to construction - Recommendations'.

17. Trade Effluent

Does the proposal involve the need to dispose of trade effluents or waste? Yes No

If Yes, please describe the nature, volume and means of disposal of trade effluents or waste

NYMNP
27 NOV 2008

CERTIFICATE OF OWNERSHIP - CERTIFICATE D

Town and Country Planning (General Development Procedure) Order 1995 Certificate under Article 7

I/We/ The applicant certifies that:

Certificate A cannot be issued for this application

All reasonable steps have been taken to find out the names and addresses of everyone else who, on the day 21 days before the date of this application, was the owner (owner is a person with a freehold interest or leasehold interest with at least 7 years left to run) of any part of the land to which this application relates, but I have/ the applicant has been unable to do so.

The steps taken were:

Notice of the application has been published in the following newspaper (circulating in the area where the land is situated):

On the following date (which must not be earlier than 21 days before the date of the application):

Signed - Applicant:

Or signed - Agent:

Date (DD/MM/YYYY):

AGRICULTURAL HOLDINGS CERTIFICATE

Town and Country Planning (General Development Procedure) Order 1995 Certificate under Article 7

Agricultural Land Declaration - You Must Complete Either A or B

(A) None of the land to which the application relates is, or is part of, an agricultural holding.

Signed - Applicant:

Or signed - Agent:

Date (DD/MM/YYYY):

B) I have/ The applicant has given the requisite notice to every person other than myself/ the applicant who, on the day 21 days before the date of this application, was a tenant of an agricultural holding on all or part of the land to which this application relates, as listed below:

| Name of Tenant | Address | Date Notice Served |
|----------------|------------------------------|--------------------|
| S. WELFORD | BUTTERDARK FARM EGTON BRIDGE | 14-10-08 |
| | | |
| | | |
| | | |
| | | |

NYMNP
27 NOV 2008

Signed - Applicant:

Or signed - Agent:

Date (DD/MM/YYYY):

30/10/08

26. Planning Application Requirements - Checklist

Please read the following checklist to make sure you have sent all the information in support of your proposal. Failure to submit all information required will result in your application being deemed invalid. It will not be considered valid until all information required by the Local Planning Authority has been submitted.

- | | |
|--|---|
| <p>3 copies of a completed and dated application form: <input type="checkbox"/></p> <p>3 copies of the plan which identifies the land to which the application relates drawn to an identified scale and showing the direction of North: <input type="checkbox"/></p> <p>3 copies of other plans and drawings or information necessary to describe the subject of the application: <input type="checkbox"/></p> | <p>The correct fee: <input type="checkbox"/></p> <p>3 copies of a design and access statement: <input type="checkbox"/></p> <p>3 copies of the completed, dated Article 7 Certificate (Agricultural Holdings): <input type="checkbox"/></p> <p>3 copies of the completed, dated Ownership Certificate (A, B, C, or D - as applicable): <input type="checkbox"/></p> |
|--|---|

27. Declaration

I/we hereby apply for planning permission/consent as described in this form and the accompanying plans/drawings and additional information.

Signed - Applicant:

Or signed - Agent:

Date (DD/MM/YYYY):

30/10/08

(date cannot be pre-application)

DESIGN AND ACCESS STATEMENT

In May 2008 I erected a temporary field shelter in the south west corner of field NZ 8006 7968. I was intending to move the shelter around the field but after a visit from and discussion with Mr Thomson from NYMNP it was decided that the best place for the shelter was in the corner of the field away from the houses.

The building is constructed of timber with a felt roof 6m. long 3.7m. wide 2.4m. high.

Access to the building is through the existing field gate from Egton lane.

| |
|-------------------------------|
| <p>NYMNPA 27 NOV 2008</p> |
|-------------------------------|