

ALL RIGHTS RESERVED IN CHAPTER IV OF THE COPYRIGHT, DESIGNS AND PATENTS ACT 1988 HAVE BEEN GENERALLY ASSERTED.  
© 2008 BARRY DENTON ARCHITECTS

NYM/NPA  
5388  
25 FEB 2009

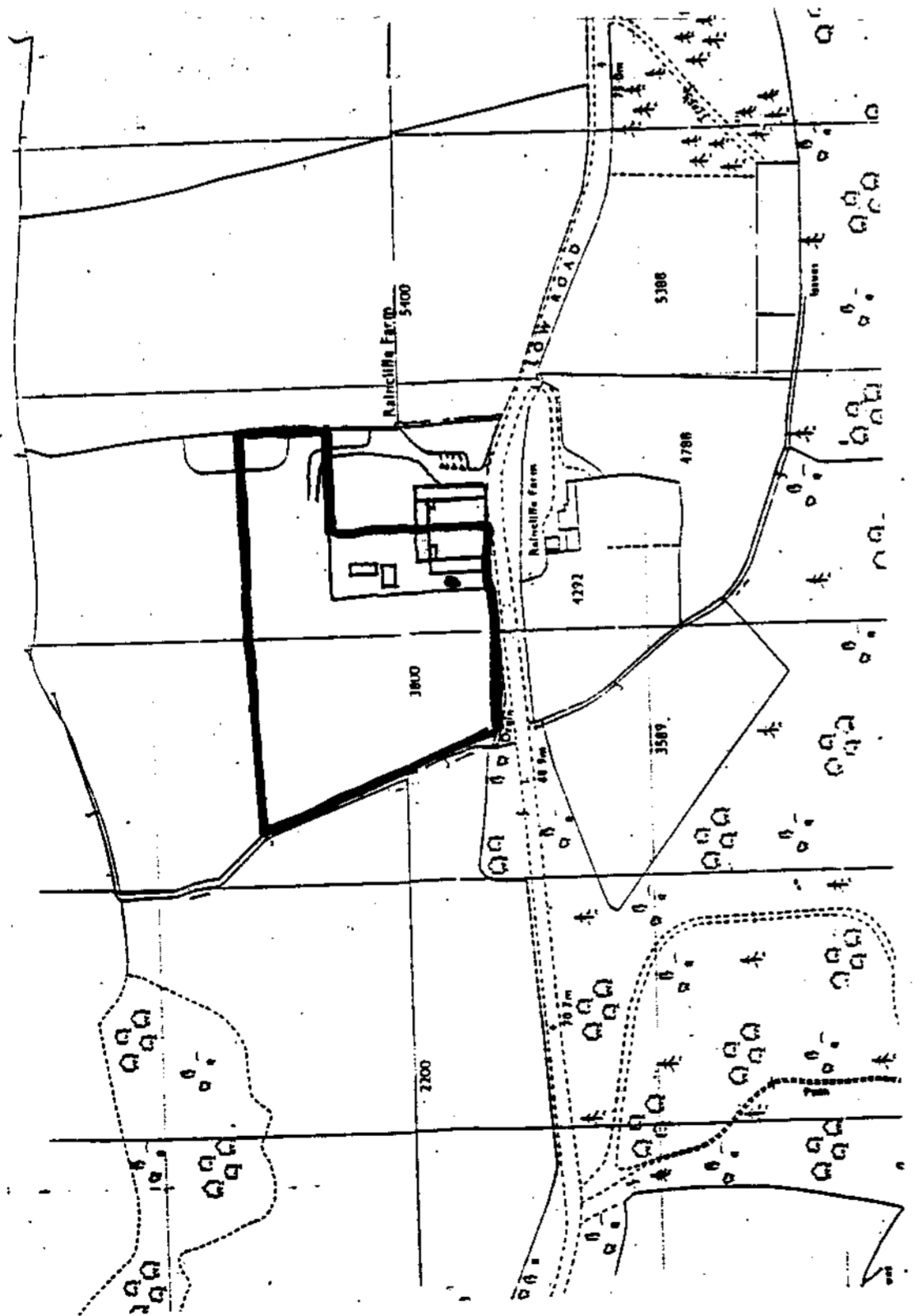
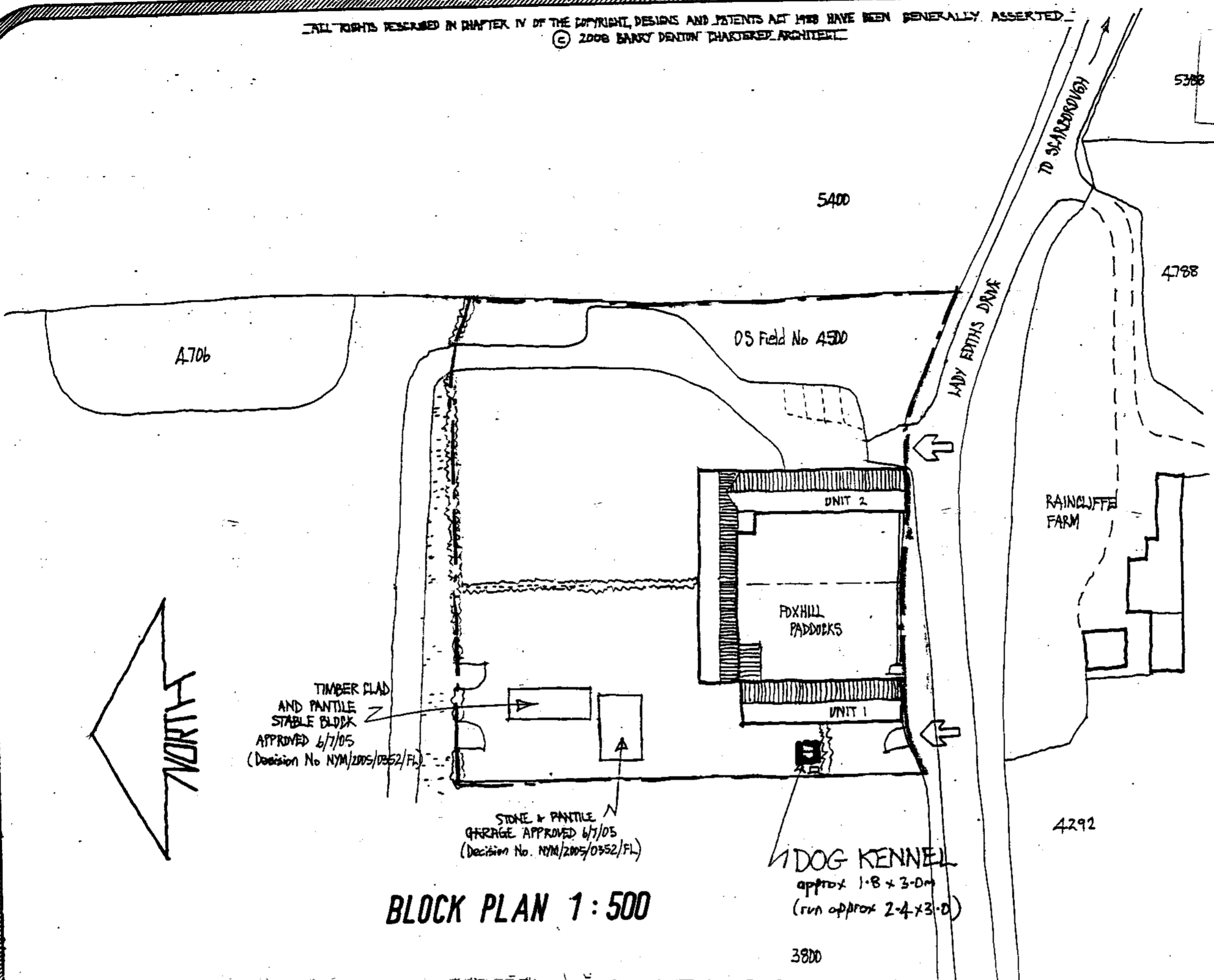

**NOTES**

DO NOT TRY TO SCALE ACCURATELY FROM THIS DRAWING IF IN DOUBT - ASK!

ALL DIMENSIONS TO BE CHECKED ON SITE PRIOR TO FINAL ESTIMATE & COMMENCEMENT OF WORK.

ANY DISCREPANCIES IN THE DRAWING OR WORKS MUST BE IMMEDIATELY BROUGHT TO THE ARCHITECTS NOTICE.

ALL WORK IS TO BE TO THE ENTIRE SATISFACTION OF THE LOCAL AUTHORITY THE SANITARY UNDERDRAINGS & IN ACCORDANCE WITH THE CURRENT BUILDING REGS.

ALL STRUCTURAL TIMBER IS TO BE STRESS GRADED.

WORKS PASSING UNDER NEW WORK TO BE ENCASED IN ABL 150 CONC.

**REVISIONS**

B = 24/2/09 - KENNEL ADDED

**EXISTING** Scale 1:500  
 Dwg No. H92C 308/4 B  
 RAINCLIFFE FARM, LADY EDITHS DRIVE - THROXENBY



KAYME COTTAGE HIGH STREET BRIMPTON BY SAUNDON N YORKS YO13 9DA TEL 0723 853288

SE 00417, 88981

PTI

Householder Application for Planning Permission for works or extension to a dwelling.  
Town and Country Planning Act 1990 09/128

Publication of planning applications on council web sites

Please note that with the exception of applicant contact details and Certificates of Ownership, the information provided on this application form and in supporting documents may be published on the council's website.

If any other information that is provided as part of the application which falls within the definition of personal data under the Data Protection Act and is not to be published on the council's website, please contact the council's planning department.

1. Applicant Name, Address and Contact Details

Title:  First name:  Surname:

Company name:

Street address:

Town/City:

County:

Country:

Postcode:

Country Code:

National Number:

Extension Number:

Telephone number:

Mobile number:

Fax number:

Email address:

Are you an agent acting on behalf of the applicant?  Yes  No

25 FEB 2009

2. Agent Name, Address and Contact Details

Title:

First Name:  Surname:

Company name:

Street address:

Town/City:

County:

Country:

Postcode:

Country Code:

National Number:

Extension Number:

Telephone number:

Mobile number:

Fax number:

Email address:

3. Description of Proposed Works

Please describe the proposed works:

Has the work already been started without planning permission?  Yes  No

If Yes, please state when the works were started:

Has the work already been completed without planning permission?  Yes  No

If Yes, please state the date when the works were completed:

**4. Site Address Details**

Full postal address of the site (including full postcode where available)

Description:

House:  Suffix:

House name: Foxhill Paddocks

Street address: Low Road

Throxenby

Town/City: Scarborough

County:

Postcode: YO12 5TD

Timber boarded Dog kennel with felt roof.

Description of location or a grid reference (must be completed if postcode is not known):

Easting:

Northing:

**5. Pedestrian and Vehicle Access, Roads and Rights of Way**

Is a new or altered vehicle access proposed to or from the public highway?  Yes  No

Is a new or altered pedestrian access proposed to or from the public highway?  Yes  No

Do the proposals require any diversions, extinguishment and/or creation of public rights of way?  Yes  No

If Yes to any questions, please show details on your plans or drawings and state their reference number(s):

**6. Pre-application Advice**

Has assistance or prior advice been sought from the local authority about this application?  Yes  No

If Yes, please complete the following information about the advice you were given (this will help the authority to deal with this application more efficiently):

Officer name

Title:  First name: Barry Surname: Thompson

Reference:

Date: 9/12/08

Details of the pre-application advice received:

WPA

25 FEB 2009

**7. Trees and Hedges**

Are there any trees or hedges on your own property or on adjoining properties which are within falling distance of your boundary?  Yes  No

If Yes, please mark their position on a scaled plan and state the reference number of any plans or drawings:

Will any trees or hedges need to be removed or pruned in order to carry out your proposal?  Yes  No

If Yes, please show on your plans, indicating the scale, which trees by giving them numbers (e.g. T1, T2 etc) and state the reference number of any plans or drawings:

**8. Parking**

Will the proposed works affect existing car parking arrangements?  Yes  No

If Yes, please describe:

**9. Council Employee / Member**

Is the applicant or agent related to any member of staff or elected member of the council?  Yes  No

If Yes, please provide details:

### 10. Site Visit

Can the site be seen from a public road, public footpath, bridleway or other public land?  Yes  No

If the planning authority needs to make an appointment to carry out a site visit, whom should they contact? (Please select only one)

The agent  The applicant  Other person

### 11. Materials

Please state what materials (including type, colour and name) are to be used externally (if applicable):

Are you supplying additional information on submitted plan(s)/drawing(s)/design and access statement?  Yes  No

If Yes, please state references for the plan(s)/drawing(s)/design and access statement:

Photo sheets H92F 209/P1 & P2 + dra no H92C 308/4B + Design Statement

### 12. Certificates (Certificate A)

#### Certificate of Ownership - Certificate A

#### Town and Country Planning (General Development Procedure) Order 1995 Certificate under Article 7

I certify/The applicant certifies that on the day 21 days before the date of this application nobody except myself/ the applicant was the owner (owner is a person with a freehold interest or leasehold interest with at least 7 years left to run) of any part of the land or building to which the application relates.

Title:  First name:  Surname:

Person role:  Declaration date:   Declaration made

### 12. Certificates (Certificate B)

#### Certificate of Ownership - Certificate B

#### Town and Country Planning (General Development Procedure) Order 1995 Certificate under Article 7

I certify/The applicant certifies that I have/the applicant has given the requisite notice to everyone else (as listed below) who, on the day 21 days before the date of this application, was the owner (owner is a person with a freehold interest or leasehold interest with at least 7 years left to run) of any part of the land or building to which this application relates.

Notice recipient:  Date notice served:

Title:  First name:  Surname:

Person role:  Declaration date:   Declaration made

### 12. Certificates (Certificate C)

#### Certificate of Ownership - Certificate C

#### Town and Country Planning (General Development Procedure) Order 1995 Certificate under Article 7

I certify/The applicant certifies that:

Neither Certificate A or B can be issued for this application

- All reasonable steps have been taken to find out the names and addresses of the other owners (owner is a person with a freehold interest or leasehold interest with at least 7 years left to run) of the land or building, or of a part of it, but I have/the applicant has been unable to do so.

The steps taken were:

- I have/the applicant has given the requisite notice to the persons specified below being persons who, on the day 21 days before the date of this application, were owners (owner is a person with a freehold interest or leasehold interest with at least 7 years left to run) of any part of the land or building to which this application relates.

Notice recipient:  Date notice served:

Notice of the application has been published in the following newspaper (circulating in the area where the land is situated):

On the following date (which must not be earlier than 21 days before the date of the application):

Title:  First name:  Surname:

Person role:  Declaration date:   Declaration made

NYMINPA  
25 FEB 2009

### 12. Certificates (Certificate D)

#### Certificate of Ownership - Certificate D

#### Town and Country Planning (General Development Procedure) Order 1995 Certificate under Article 7

I certify/the applicant certifies that:

- Certificate A cannot be issued for this application

- All reasonable steps have been taken to find out the names and addresses of everyone else who, on the day 21 days before the date of this application, was the owner (owner is a person with a freehold interest or leasehold interest with at least 7 years left to run) of any part of the land to which this application relates, but I have/the applicant has been unable to do so.

The steps taken were:

\_\_\_\_\_

Notice of the application has been published in the following newspaper (circulating in the area where the land is situated):

\_\_\_\_\_

On the following date (which must not be earlier than 21 days before the date of the application):

\_\_\_\_\_

Title: \_\_\_\_\_ First name: \_\_\_\_\_ Surname: \_\_\_\_\_

Person role: Agent Declaration date: \_\_\_\_\_  Declaration made

### 12. Certificates (Agricultural Holdings Certificate)

#### Agricultural Holding Certificate

#### Town and Country Planning (General Development Procedure) Order 1995 Certificate under Article 7

Agricultural Land Declaration - You Must Select Either A or B

(A) None of the land to which the application relates is, or is part of an agricultural holding.

(B) I have/The applicant has given the requisite notice to every person other than myself/the applicant who, on the day 21 days before the date of this application, was a tenant of an agricultural holding on all or part of the land to which this application relates, as listed below:

Notice recipient	Date notice served
_____	_____

Title: \_\_\_\_\_ First Name: B Surname: Denton

Person role: Agent Declaration date: 24/2/09  Declaration Made

### 13. Declaration

I/we hereby apply for planning permission/consent as described in this form and the accompanying plans/drawings and additional information.

Date: 24/2/09

NY 19 / 2009 / 0128 / 5  
25 FEB 2009

NYM / 2009 / 0 1 2 8 / F L

24<sup>th</sup> February, 2009

**FAO Barry Thompson**  
Planning Enforcement Officer,  
North York Moors National Park,  
The Old Vicarage,  
Bondgate,  
Helmsley, York,  
YO62 5BP

Dear Mr. Thompson,

**RE: RETROSPECTIVE PLANNING APPLICATION FOR DOG KENNEL AT  
FOXHILL PADDOCKS, LOW ROAD, THROXENBY**

Further to our telephone conversation of 9.12.08, I have now been instructed by Mr. Harrison to make the above application.

In this respect, I enclose herewith the completed forms, cheque, site layout, photographs and design statement.

I trust that this is sufficient for your needs, but if you require anything further, please do not hesitate to telephone me.

Yours sincerely,



**BARRY DENTON**

NYMNPA

25 FEB 2009



BARRY - BScHons DipArch RIBA CHARTERED ARCHITECT

BELINDA - DipSurv MRICS CHARTERED BUILDING SURVEYOR

NYM / 2009 / 0128 / FL 1

Kenel  
behind  
hedge

25 Feb 2009

SOUTH FACING ELEVATION (ie View from road)

Finber boarded  
kenel with  
felt roof



NORTH WEST FACING ELEVATION

FOXHILL PADDOCKS, THROXENBY

H92F 209/P1



BARRY - BScHons DipArch RIBA CHARTERED ARCHITECT

BELINDA - DipSurv MRICS CHARTERED BUILDING SURVEYOR

4 STATION SHOPS WESTBOROUGH SCARBOROUGH N. YORKS YO11 1TR TEL: 01723 361310 FAX: 01723 361310

EMAIL: Barry@bdenton.freemove.co.uk

NYM / 2009 / 0128 / FL



Kenel is approx  
1.8 x 3.0 m

(attached run is approx  
2.4 x 3.0 m)

NYMIPA

25 FEB 2009



FOXHILL PADDocks, THROXENBY

H92F 209/P2



BARRY - BScHons DipArch RIBA CHARTERED ARCHITECT

BELINDA - DipSurv MRICS CHARTERED BUILDING SURVEYOR