

SIDE ELEVATION

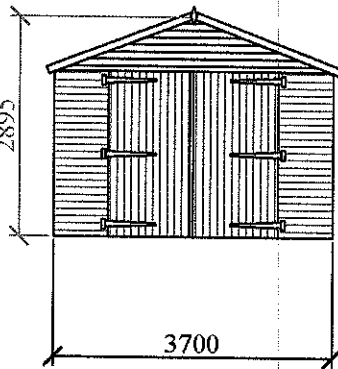

FRONT ELEVATION

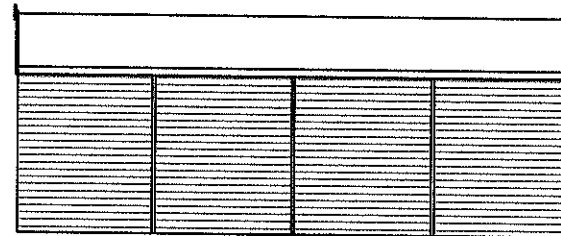

SIDE ELEVATION

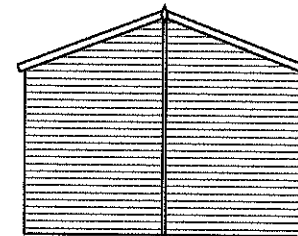

REAR ELEVATION

CONSTRUCTION DETAILS

- TIMBER CONSTRUCTION THROUGHOUT
- ALL CLADDING TO BE 13mm FINISH SHIPLAP TONGUE AND GROOVE
- TREATED IN HIGH QUALITY CUPRINOL TOTAL PRESERVATIVE
- DOORS TO BE FRAMED AND CLAD AS WALLS
- GALVANISED FITTINGS USED
- ROOF CLAD IN TONGUE AND GROOVE AND FINISHED IN GARAGE GRADE ROOFING FELT

NYMNP
17 MAR 2009

NOTES	DESCRIPTION			
	STORAGE SHED			
	NAME AND ADDRESS			
	MR ROBIN HOPPS LOW NEWBIGGIN NORTH FARM AISLABY WHITBY YU21 1TQ			
	SCALE	DATE	DRAWING NUMBER	SHEET
	1:100	26/02/09	RH001	I
				REVISION
			A	

NYM / 2009 / 0161 / FL

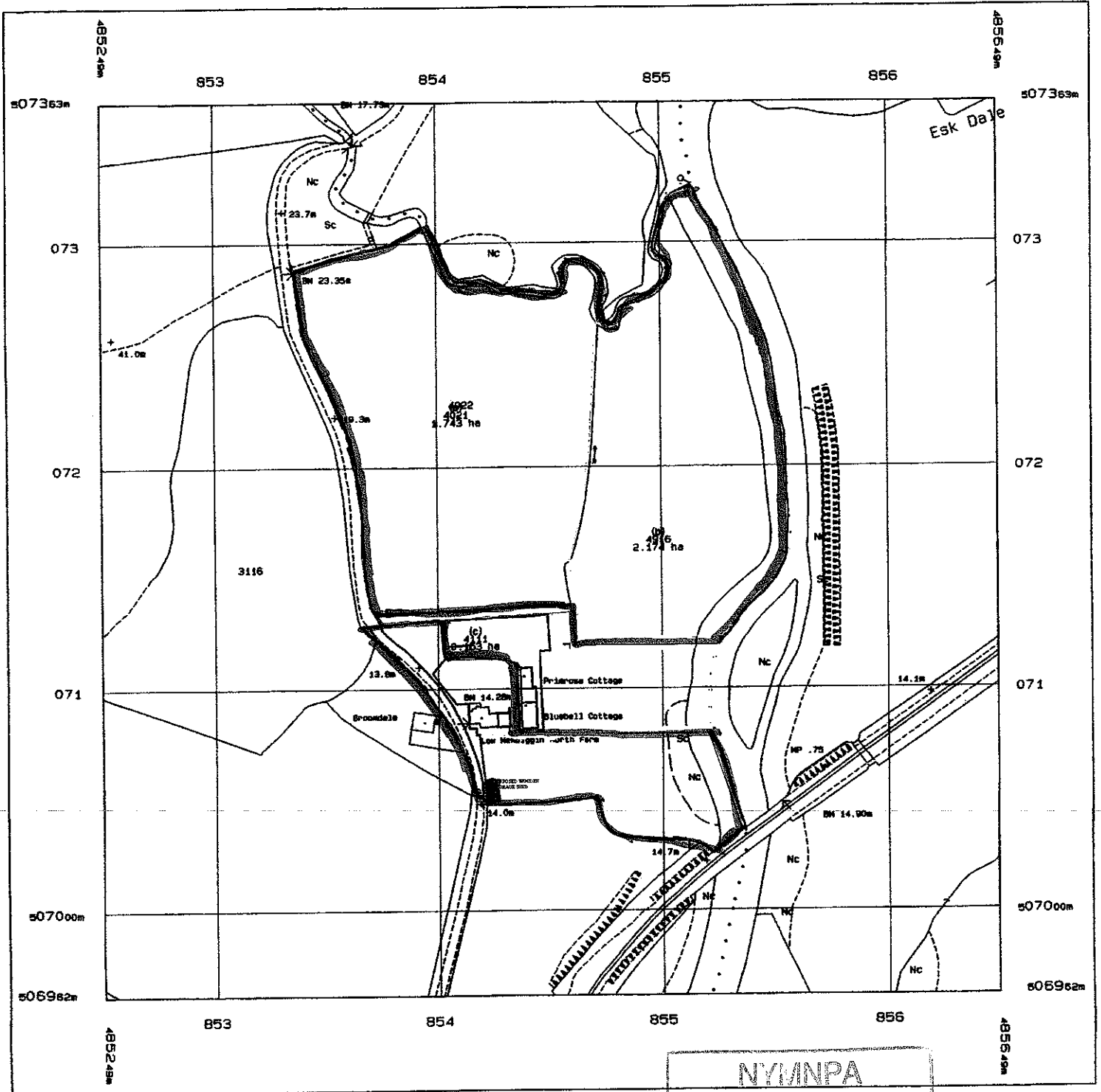

NYM/NPA
 17 MAR 2009

Produced 19 Apr 2005 from Ordnance Survey digital data and incorporating surveyed revision available at this date. © Crown Copyright 2005.

Reproduction in whole or in part is prohibited without the prior permission of Ordnance Survey.

Ordnance Survey, the OS symbol and Superplan are registered trade marks of Ordnance Survey, the national mapping agency of Great Britain.

This Superplan product does not contain all recorded map information.

Scale 1: 2500

The accompanying printout gives details of

The depiction of features on land parcels is no evidence or guarantee of ownership.

National Grid sheet reference at centre of this Superplan: NZ8507

The representation of a road, track or path is no evidence of a right of way.

Heights are given in metres above Datum.

The alignment of tunnels is approximate.

Centre Coordinates: 485449 507162
 Produced by The Ordnance Survey

BLUEBELL COTT,

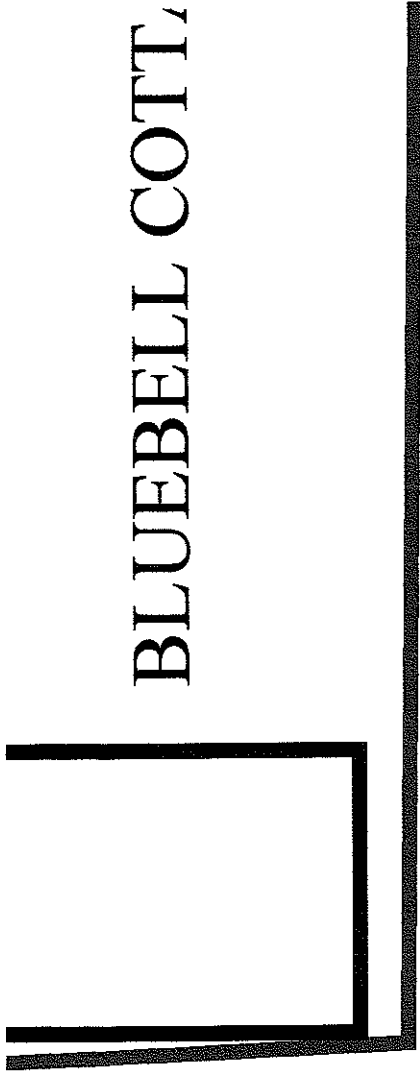

LOW NEWBIGGIN NORTH FARM

SCALE 1:200

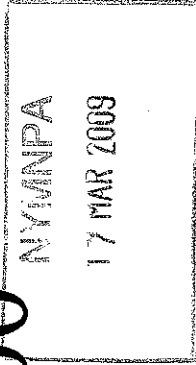

PROPOSED WOODEN
STORAGE SHED

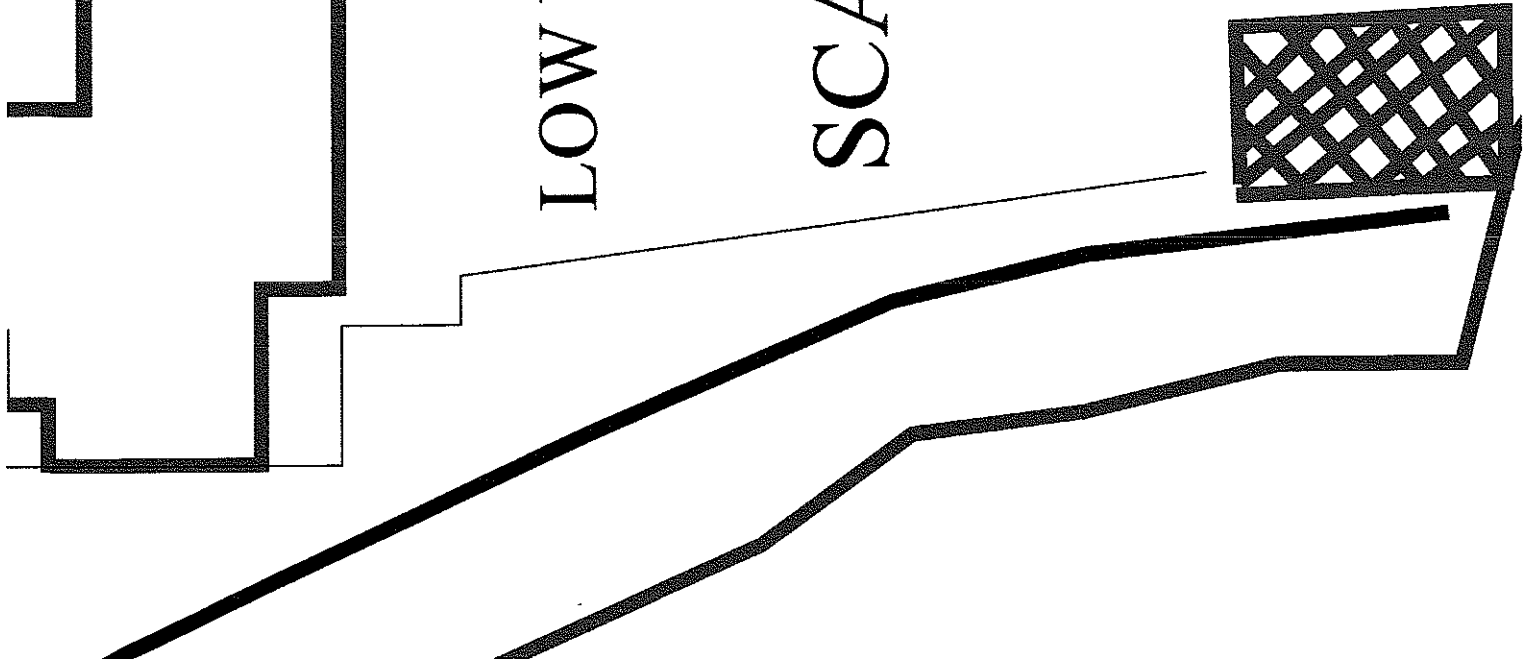
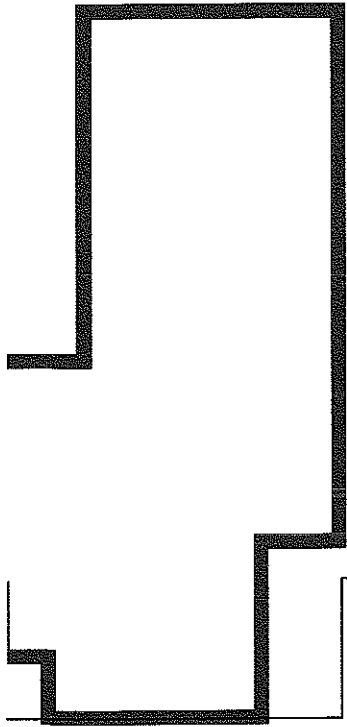
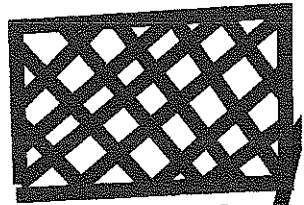



NZ 85422,07058

North York Moors National Park Authority
 The Old Vicarage
 Bondgate
 Helmsley
 York
 YO62 5BP

Telephone: 01439 770657
 Email: dc@northyorkmoors-npa.gov.uk
 Website: www.npa.gov.uk

PTT

Householder Application for Planning Permission for works or extension to a dwelling.
 Town and Country Planning Act 1990 09/101

Publication of planning applications on council websites

Please note that with the exception of applicant contact details and Certificates of Ownership, the information provided on this application form and in supporting documents may be published on the council's website.
 If you have provided any other information as part of your application which falls within the definition of personal data under the Data Protection Act which you do not wish to be published on the council's website, please contact the council's planning department.

Please complete using block capitals and black ink.
 It is important that you read the accompanying guidance notes as incorrect completion will delay the processing of your application.

1. Applicant Name and Address	2. Agent Name and Address
Title: <input type="text" value="Mr"/> First name: <input type="text" value="Robin"/> Last name: <input type="text" value="Hopps"/> Company (optional): <input type="text"/> Unit: <input type="text"/> House number: <input type="text"/> House suffix: <input type="text"/> House name: <input type="text" value="Low Biggin Farm North"/> Address 1: <input type="text" value="Aislaby"/> Address 2: <input type="text"/> Address 3: <input type="text"/> Town: <input type="text" value="Whitby"/> County: <input type="text" value="North Yorkshire"/> Country: <input type="text"/> Postcode: <input type="text" value="YO21 1TQ"/>	Title: <input type="text"/> First name: <input type="text"/> Last name: <input type="text"/> Company (optional): <input type="text"/> Unit: <input type="text"/> House number: <input type="text"/> House suffix: <input type="text"/> House name: <input type="text"/> Address 1: <input type="text"/> Address 2: <input type="text"/> Address 3: <input type="text"/> Town: <input type="text"/> County: <input type="text"/> Country: <input type="text"/> Postcode: <input type="text"/>

3. Description of Proposed Works

Please describe the proposed works:

Erection of timber storage shed

NYMNPA
 17 MAR 2009

10. Materials

if applicable, please state what materials are to be used externally. Include type, colour and name for each material:

	Existing (where applicable)	Proposed	Not applicable	Don't Know	Drawing references if applicable
Walls		Shiplap tongue and groove	<input type="checkbox"/>	<input type="checkbox"/>	
Roof		felted	<input type="checkbox"/>	<input type="checkbox"/>	
Windows		timber frame	<input type="checkbox"/>	<input type="checkbox"/>	
Doors		shiplap tongue and groove	<input type="checkbox"/>	<input type="checkbox"/>	
Boundary treatments (e.g. fences, walls)			<input type="checkbox"/>	<input type="checkbox"/>	
Vehicle access and hard-standing			<input type="checkbox"/>	<input type="checkbox"/>	
Lighting			<input type="checkbox"/>	<input type="checkbox"/>	
Others (please specify)			<input type="checkbox"/>	<input type="checkbox"/>	

Are you supplying additional information on submitted plan(s)/drawing(s)/design and access statement? Yes No

If Yes, please state references for the plan(s)/drawing(s)/design and access statement:

RH01

17 MAR 2009

11. Certificates (continued)

CERTIFICATE OF OWNERSHIP - CERTIFICATE D
 Town and Country Planning (General Development Procedure) Order 1995 Certificate under Article 7

I certify/ The applicant certifies that:

- Certificate A cannot be issued for this application
- All reasonable steps have been taken to find out the names and addresses of everyone else who, on the day 21 days before the date of this application, was the owner (owner is a person with a freehold interest or leasehold interest with at least 7 years left to run) of any part of the land to which this application relates, but I have/ the applicant has been unable to do so.

The steps taken were:

Notice of the application has been published in the following newspaper (circulating in the area where the land is situated):

On the following date (which must not be earlier than 21 days before the date of the application):

Signed - Applicant:

Or signed - Agent:

Date (DD/MM/YYYY):

AGRICULTURAL HOLDINGS CERTIFICATE
 Town and Country Planning (General Development Procedure) Order 1995 Certificate under Article 7

Agricultural Land Declaration - You Must Complete Either A or B
 (A) None of the land to which the application relates is, or is part of, an agricultural holding.

Date (DD/MM/YYYY):

Or signed - Agent:

I give notice to every person other than myself/ the applicant who, on the day 21 days before the date of this application, was the owner of an agricultural holding on all or part of the land to which this application relates,

as listed below:

Name of Tenant	Address	Date Notice Served

Signed - Applicant:

Or signed - Agent:

Date (DD/MM/YYYY):

12. Planning Application Requirements - Checklist

Please read the following checklist to make sure you have sent all the information in support of your proposal. Failure to submit all information required will result in your application being deemed invalid. It will not be considered valid until all information required by the Local Planning Authority has been submitted.

3 copies of a completed and dated application form:

3 copies of a plan which identifies the land to which the application relates drawn to an identified scale and showing the direction of North:

3 copies of other plans and drawings or information necessary to describe the subject of the application:

3 copies of a design and access statement where proposed works fall within one of the following designated areas:

- National Park
- Site of special scientific interest
- Conservation area
- Area of outstanding natural beauty
- World Heritage Site
- The Broads

The correct fee:

3 copies of the completed, dated Article 7 Certificate (Agricultural Holdings):

3 copies of the completed, dated Ownership Certificate (A, B, C or D - as applicable):

13. Declaration

I declare that I am applying for planning permission/consent as described in this form and the accompanying plans/drawings and additional information.

Signed:

Date (DD/MM/YYYY):

(date cannot be pre-application)

17 MAK 2009

14. Applicant Contact Details

Telephone numbers

Country code: Extension number:

Country code: Mobile number (optional):

Country code: Fax number (optional):

Email address (optional):

15. Agent Contact Details

Telephone numbers

Country code: National number: Extension number:

Country code: Mobile number (optional):

Country code: Fax number (optional):

Email address (optional):

16. Site Visit

Can the site be seen from a public road, public footpath, bridleway or other public land? Yes No

If the planning authority needs to make an appointment to carry out a site visit, whom should they contact? (Please select only one) Agent Applicant Other (if different from the agent/applicant's details)

If Other has been selected, please provide:

Contact name: Telephone number:

Email address:

12. Planning Application Requirements - Checklist

Please read the following checklist to make sure you have sent all the information in support of your proposal. Failure to submit all information required will result in your application being deemed invalid. It will not be considered valid until all information required by the Local Planning Authority has been submitted. The correct fee: The original and 3 copies of the following documents:

The completed and dated application form	<input checked="" type="checkbox"/>	The completed, dated Article 7 Certificate (Agricultural Holdings)	<input checked="" type="checkbox"/>	A design and access statement where proposed works fall within one of the following designated areas:	<input checked="" type="checkbox"/>
A plan which identifies the land to which the application relates drawn to an identified scale and showing the direction of north	<input checked="" type="checkbox"/>	The completed, dated Ownership Certificate (A, B, C or D - as applicable)	<input checked="" type="checkbox"/>	• National Park	
Other plans and drawings or information necessary to describe the subject of the application	<input checked="" type="checkbox"/>			• Site of special scientific interest	
				• Conservation area	
				• Area of outstanding natural beauty	
				• World Heritage Site	
				• The Broads	

NYMNPA
17 MAR 2009

VALIDATION CHECKLIST

HOUSEHOLDER APPLICATIONS
for extensions, detached outbuildings
and
other alterations to existing dwellings



Please complete the attached checklist to indicate what you have included with your application. All plans should include paper size, key dimensions and scale.

STANDARD REQUIREMENTS:

(1 original and 3 copies to be supplied unless the application is submitted electronically)

Completed application form	YES <input checked="" type="checkbox"/>	N/A <input type="checkbox"/>
Completed Certificate of Ownership, A, B, C or D as required by Article 7 of the Town and Country Planning (General Development Procedure) Order 1995.	YES <input checked="" type="checkbox"/>	N/A <input type="checkbox"/>
Agricultural Holdings Certificate as required by Article 7 of the Town and Country Planning (General Development Procedure) Order 1995	YES <input checked="" type="checkbox"/>	N/A <input type="checkbox"/>
Location Plan at a scale of 1:2500 or 1:1250 with your application site edged red and any other land in your ownership edged in blue.	YES <input checked="" type="checkbox"/>	N/A <input type="checkbox"/>
Existing site layout plans at a scale of 1:500, 1:200 or 1:100 showing the site in relation to existing buildings and site boundaries. The plan should indicate where existing features of the site are located including existing buildings (indicating proposed demolitions), trees (identifying any proposed felling), means of access and type of enclosure (wall, fence, hedges) and shall show adjacent properties/buildings.	YES <input checked="" type="checkbox"/>	N/A <input type="checkbox"/>
Proposed site layout plans at a scale of 1:500, 1:200 or 1:100	YES <input type="checkbox"/>	N/A <input checked="" type="checkbox"/>
Existing and proposed elevations to a scale of 1:50 or 1:100 Requirements dependent on position of extension eg. no front elevation required for rear extension etc.	YES <input type="checkbox"/>	N/A <input checked="" type="checkbox"/>
Existing and proposed floor plans to a scale of 1:50 or 1:100 For each floor ie, ground and first floor plans required for two storey extension	YES <input type="checkbox"/>	N/A <input checked="" type="checkbox"/>
Roof Plans to a scale of 1:50 or 1:100 If proposed development alters the existing roof	YES <input type="checkbox"/>	N/A <input checked="" type="checkbox"/>
Existing and proposed site sections and finished floor level and site levels to a scale of 1:50 or 1:100	YES <input type="checkbox"/>	N/A <input checked="" type="checkbox"/>
Design and Access Statement	YES <input checked="" type="checkbox"/>	N/A <input type="checkbox"/>
Manufacturers specification/leaflet, for proposals incorporating plant/machinery (swimming pools/wind turbines)	YES <input checked="" type="checkbox"/>	N/A <input type="checkbox"/>
Application fee Please consult our enclosed Schedule of Fees Cheques are to be made payable to NYMNPA	YES <input checked="" type="checkbox"/>	NO <input type="checkbox"/>

NYMNPA
 17 MAR 2009

25. Certificates (continued)

CERTIFICATE OF OWNERSHIP - CERTIFICATE D

Town and Country Planning (General Development Procedure) Order 1995 Certificate under Article 7

I certify/ The applicant certifies that:

- Certificate A cannot be issued for this application
- All reasonable steps have been taken to find out the names and addresses of everyone else who, on the day 21 days before the date of this application, was the owner (owner is a person with a freehold interest or leasehold interest with at least 7 years left to run) of any part of the land to which this application relates, but I have/ the applicant has been unable to do so.

NYM / 2009 / 0161 / FL

The steps taken were:

[Empty box for steps taken]

Notice of the application has been published in the following newspaper (circulating in the area where the land is situated):

[Empty box for newspaper name]

On the following date (which must not be earlier than 21 days before the date of the application):

[Empty box for date]

Signed - Applicant:

[Empty box for applicant signature]

Or signed - Agent:

[Empty box for agent signature]

Date (DD/MM/YYYY):

[Empty box for date]

AGRICULTURAL HOLDINGS CERTIFICATE

Town and Country Planning (General Development Procedure) Order 1995 Certificate under Article 7

Agricultural Land Declaration - You Must Complete Either A or B

(A) None of the land to which the application relates is, or is part of, an agricultural holding.

Or signed - Agent:

[Empty box for agent signature]

[Empty box for agent signature]

Date (DD/MM/YYYY):

1-4-09

Or I have/ the applicant has given the requisite notice to every person other than myself/ the applicant who, on the day 21 days before the date of this application, was a tenant of an agricultural holding on all or part of the land to which this application relates, as listed below:

Name of Tenant	Address	Date Notice Served

NYMNPA
6 APR 2009

Signed - Applicant:

[Empty box for applicant signature]

Or signed - Agent:

[Empty box for agent signature]

Date (DD/MM/YYYY):

[Empty box for date]

26. Planning Application Requirements - Checklist

Please read the following checklist to make sure you have sent all the information in support of your proposal. Failure to submit all information required will result in your application being deemed invalid. It will not be considered valid until all information required by the Local Planning Authority has been submitted.

3 copies of a completed and dated application form:

3 copies of the plan which identifies the land to which the application relates drawn to an identified scale and showing the direction of North:

3 copies of other plans and drawings or information necessary to describe the subject of the application:

The correct fee:

3 copies of a design and access statement:

3 copies of the completed, dated Article 7 Certificate (Agricultural Holdings):

3 copies of the completed, dated Ownership Certificate (A, B, C, or D - as applicable):

27. Declaration

I/we hereby apply for planning permission/consent as described in this form and the accompanying plans/drawings and additional information.

Signed - Applicant:

[Empty box for applicant signature]

Or signed - Agent:

[Empty box for agent signature]

Date (DD/MM/YYYY):

1-4-09 (date cannot be pre-application)

Proposed wooden storage shed at Low Newbiggin North farm Aislaby

Design and Access Statement

Physical Context

The site of Low Newbiggin Low farm is one of isolation and away from passing traffic and most walkers. The original farm building is of standard construction and design for the area.

The proposed new building is constructed from renewable resources.

Social Context

The original farm has few near neighbours and lies in a very remote location

Consultation

Full consultation has taken place with the NYMNP planning representative for the area.

Sustainability

The building is for storage and as such will have no bearing upon energy efficiency.

Design

The building will be clad in shiplap tongue and groove boarding under a felted roof.

Access

There will be no new access required for the building and it will be constructed on a level concrete base.

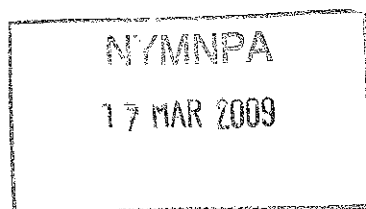



REGENCY TIMBER BUILDINGS

TEL 01948 830460

UNIT 34
PENLEY IND EST,
PENLEY, WREXHAM,
LL13 0LQ

NYM / 2009 / 0161 / F

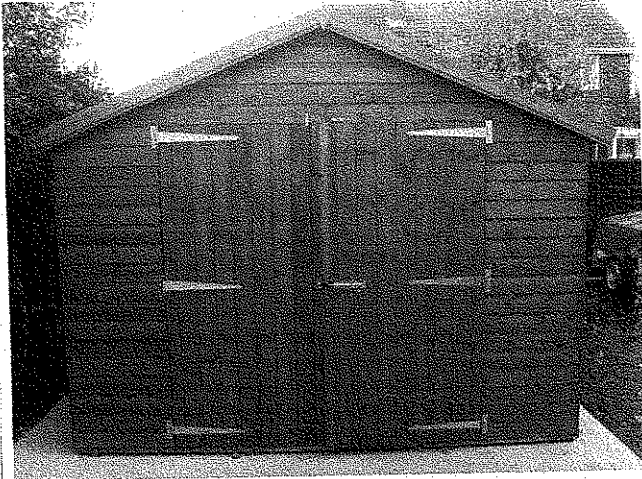

20 x 10



Trussed roof structure

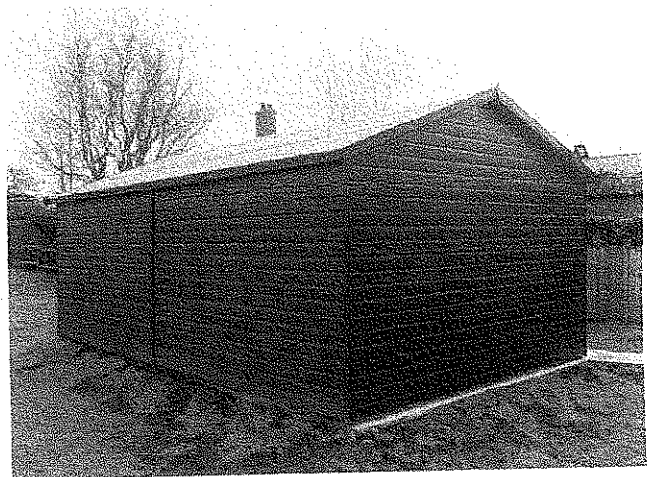

24x 12 customers own colour (varnish)



NYMNPA

17 MAR 2009