

**drawing number**  
WHI-PL00-Y0901-005

**date**  
11th MAY 2009

**notes**

1. This drawing based on a survey of 8th February 2008 carried out by Dave Jatzuk of MMB on behalf of Yorwaste Ltd and design drawings also produced by MMB.
2. All services except those shown have been omitted from this drawing for clarity.
3. Some minor portable infrastructure such as skips have been omitted from this drawing for clarity.
4. All levels are based on a nominal base level of 100mAOD.
5. Survey is to local grid, available upon request from Yorwaste Ltd.

revisions	by	date
0 Original drawing.	GO	11.5.09

**YORWASTE LTD.**  
Mount View  
Standard Way  
Northallerton  
North Yorkshire  
DL6 2YD

(c) YORWASTE LTD.  
NOT TO BE COPIED OR DETAILS DILGLED TO THIRD PARTIES EXCEPT WITH PERMISSION OF YORWASTE LTD.

**drawing title**  
WHITBY WASTE MANAGEMENT SITE  
PROPOSED CO-MINGLED RECEPTION BUILDING  
PROPOSED DRAINAGE LAYOUT

EA Ref No.	EAWML/66188
drawn by	A. Clarke
checked by	G. O'Keefe
approved by	T. Prudom

**scale**  
1:250 @ A1

**date**  
11th MAY 2009

**drawing number**  
WHI-PL00-Y0901-005

**Key**

	Site Boundary & Application Area		Existing Concrete Surfacing
	Top of Batter		Proposed Concrete Surfacing
	Bottom of Batter		Proposed Tarmac Surfacing
	Verge		Proposed Tarmac Planings
	Existing Surface Water Drainage		Proposed Stone Surfacing
	Existing Foul Drainage		Proposed Duct Pit
	Proposed Foul Drainage		Proposed Lighting Column
	Existing Gully		Existing Manhole (Various)
	Proposed Gully		Proposed Manhole
	Ex RWP		
	Proposed Rain Water Pipe (RWP)		
	Direction of Drainage Fall		

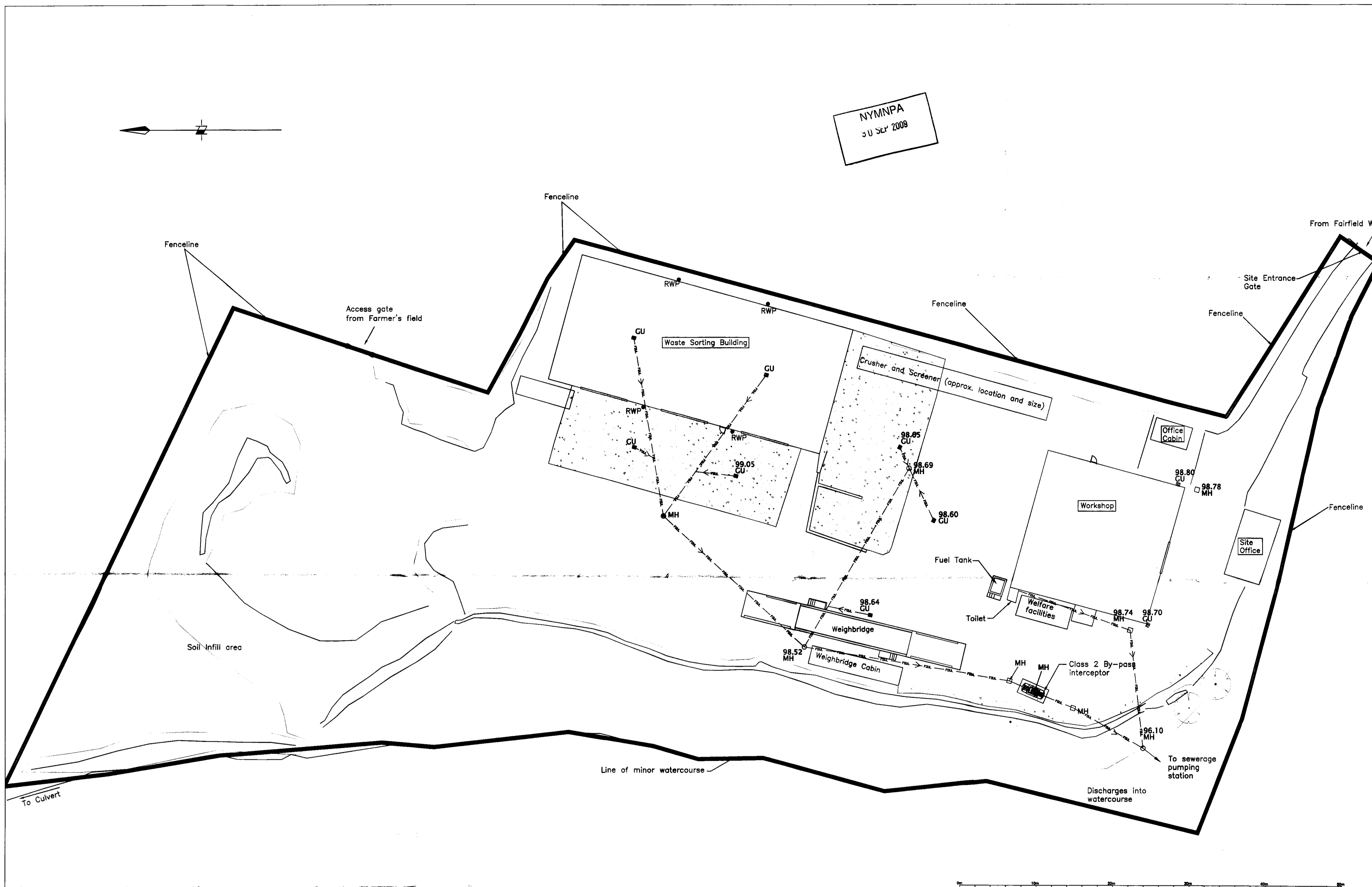

NYMNP  
30 SEP 2009

drawing number  
WHI-PL00-Y0901-004

date  
11th MAY 2009

- notes
1. This drawing based on a survey of 8th February 2008 carried out by Dave Jatzuk of MMB on behalf of Yorwaste Ltd and design drawings also produced by MMB.
  2. All services except those shown have been omitted from this drawing for clarity.
  3. Some minor portable infrastructure such as skips have been omitted from this drawing for clarity.
  4. All levels are based on a nominal base level of 100m AOD.
  5. Survey is to local grid, available on request from Yorwaste Ltd.

revisions	by	date
0 Original drawing.	GO	11.5.09

**Yorwaste**  
YORWASTE LTD.  
Mount View  
Standard Way  
Northallerton  
North Yorkshire  
DL6 2YD

(c) YORWASTE LTD.  
NOT TO BE COPIED OR DETAILS DWALIED TO THIRD PARTIES EXCEPT WITH PERMISSION OF YORWASTE LTD.

drawing title  
**WHITBY WASTE MANAGEMENT SITE  
PROPOSED WASTE SORTING BUILDING  
EXISTING DRAINAGE LAYOUT**

EA Ref No.	EAWML/66188
drawn by	A. Clarke
checked by	G. O'Keefe
approved by	T. Prudom

scales  
**1:250 @ A1**

date  
11th MAY 2009

drawing number  
WHI-PL00-Y0901-004

**Key**

	Site Boundary & Application Area
	Top of Batter
	Bottom of Batter
	Verge
	Surface Water Drainage
	Foul Drainage
	GU Gully
	RWP Rain Water Pipe (RWP)
	MH Manhole (Various)
	Concrete Surfacing

Scale = 1 : 250

NYMNPA  
30 Sep 2009

drawing number  
WHI-PL00-Y0901-002 A

date  
17th AUGUST 2009

- notes
1. This drawing based on a survey of 8th February 2008 carried out by Dave Jatzuk of MMB on behalf of Yorwaste Ltd and design drawings also produced by MMB.
  2. Some minor portable infrastructure such as skips have been omitted from this drawing for clarity.
  3. All levels are based on a nominal base level of 100mAOD.
  4. Survey is to local grid, available on request from Yorwaste Ltd.

revisions	by	date
0 Original drawing.	AC	11.5.09
A Section location added	AC	17.8.09



**YORWASTE LTD.**  
Mount View  
Standard Way  
Northalerton  
North Yorkshire  
DL6 2YD

(c) YORWASTE LTD.  
NOT TO BE COPIED OR DETAILS EMULATED TO THIRD PARTIES  
EXCEPT WITH PERMISSION OF YORWASTE LTD.

drawing title  
**WHITBY WASTE  
MANAGEMENT SITE  
PROPOSED CO-MINGLED  
RECEPTION BUILDING**

**PROPOSED LAYOUT &  
APPLICATION AREA**

EA Ref No.	EAWML/66188
drawn by	A. Clarke
checked by	G. O'Keefe
approved by	T. Prudom

scales  
1:250 @ A1

date  
17th AUGUST 2009

drawing number  
WHI-PL00-Y0901-002 A

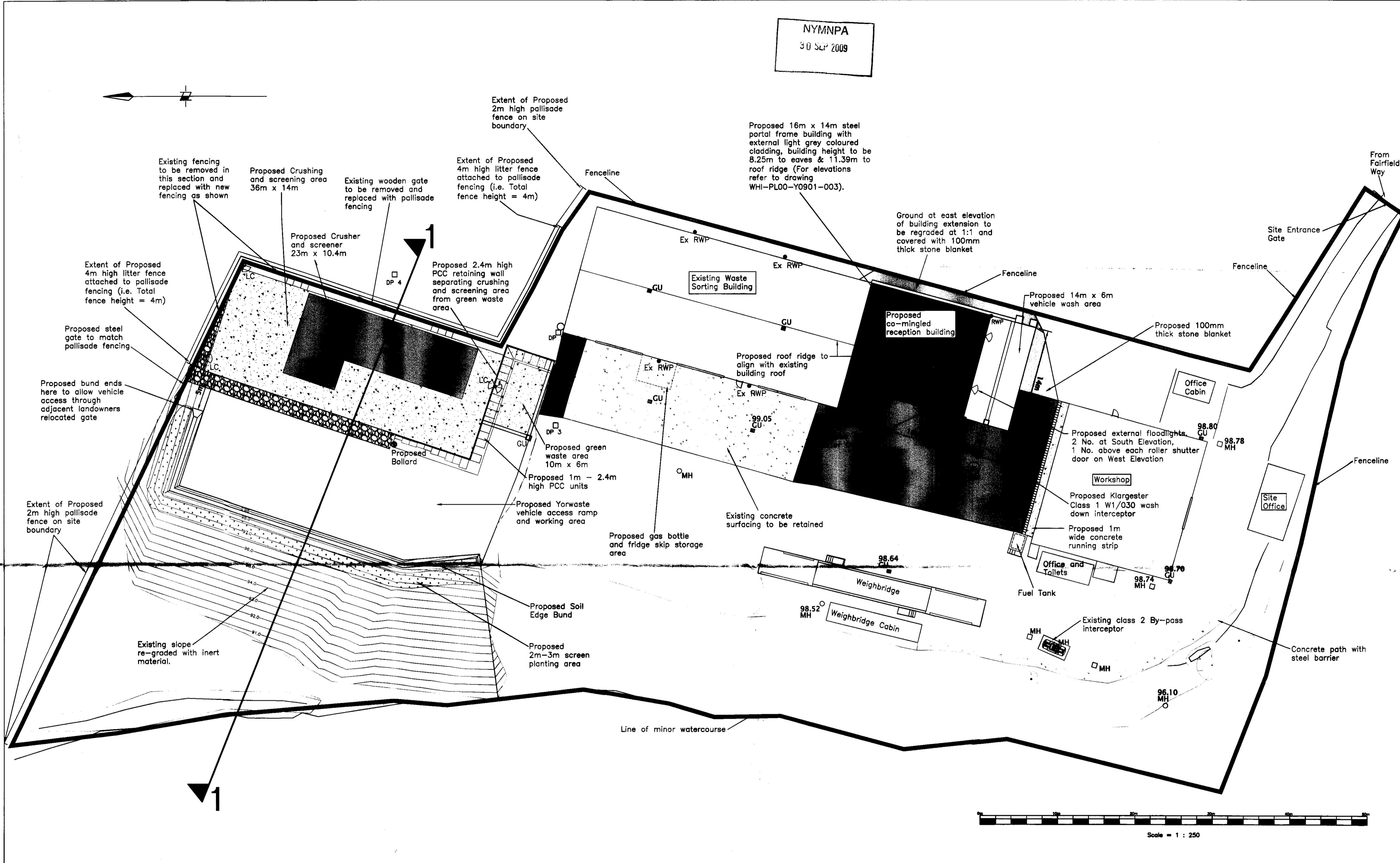

Key	
	Site Boundary & Application Area
	Top of Batter
	Bottom of Batter
	Verge
	Existing Gully
	Proposed Gully
	Existing Rain Water Pipe (RWP)
	Proposed Rain Water Pipe (RWP)
	Existing Manhole (Various)
	Proposed Manhole
	Existing Concrete Surfacing
	Proposed Concrete Surfacing
	Proposed Tarmac Surfacing
	Proposed Tarmac Planings
	Proposed Stone Surfacing
	Proposed Duct Pit
	Proposed Lighting Column

NYMNPA  
30 SEP 2009

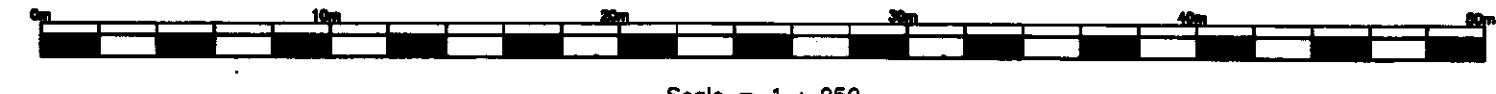
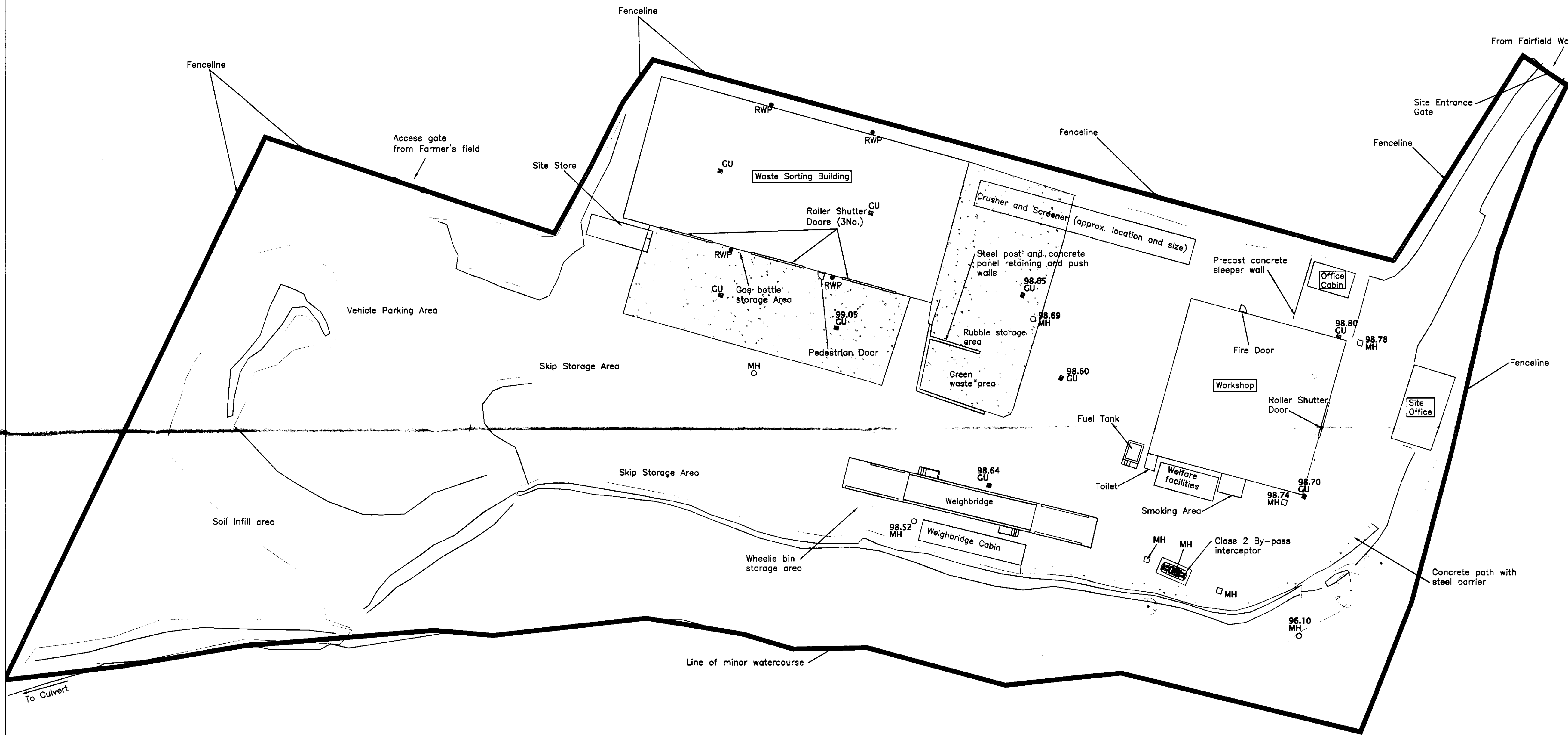

Key	
	Site Boundary & Application Area
	Top of Batter
	Bottom of Batter
	Verge
	CU
	RWP
	Manholes (Various)
	Concrete Surfacing

drawing number

WHI-PL00-Y0901-001

date

11th MAY 2009

notes

1. This drawing based on a survey of 8th February 2008 carried out by Dave Jozzuk of MMB on behalf of Yorwaste Ltd and design drawings also produced by MMB.
2. Some minor portable infrastructure such as skips have been omitted from this drawing for clarity.
3. All levels are based on a nominal base level of 100m AOD.
4. Survey is to local grid, available on request from Yorwaste Ltd.

revisions

no	description	by	date
0	Original drawing.	GO	11.5.09

**Yorwaste**  
YORWASTE LTD.  
Mount View  
Standard Way  
Northallerton  
North Yorkshire  
DL6 2YD

(c) YORWASTE LTD.  
NOT TO BE COPIED OR DETAILS DIVULGED TO THIRD PARTIES EXCEPT WITH PERMISSION OF YORWASTE LTD.

drawing title

WHITBY WASTE  
MANAGEMENT SITE

PROPOSED CO-MINGLED  
RECEPTION BUILDING

EXISTING LAYOUT &  
APPLICATION AREA

EA Ref No. EAWML/66188

drawn by A. Clarke

checked by C. O'Keefe

approved by T. Prudom

scales

1:250 @ A1

date

11th MAY 2009

drawing number

WHI-PL00-Y0901-001

NYMNPA  
 30 SEP 2009

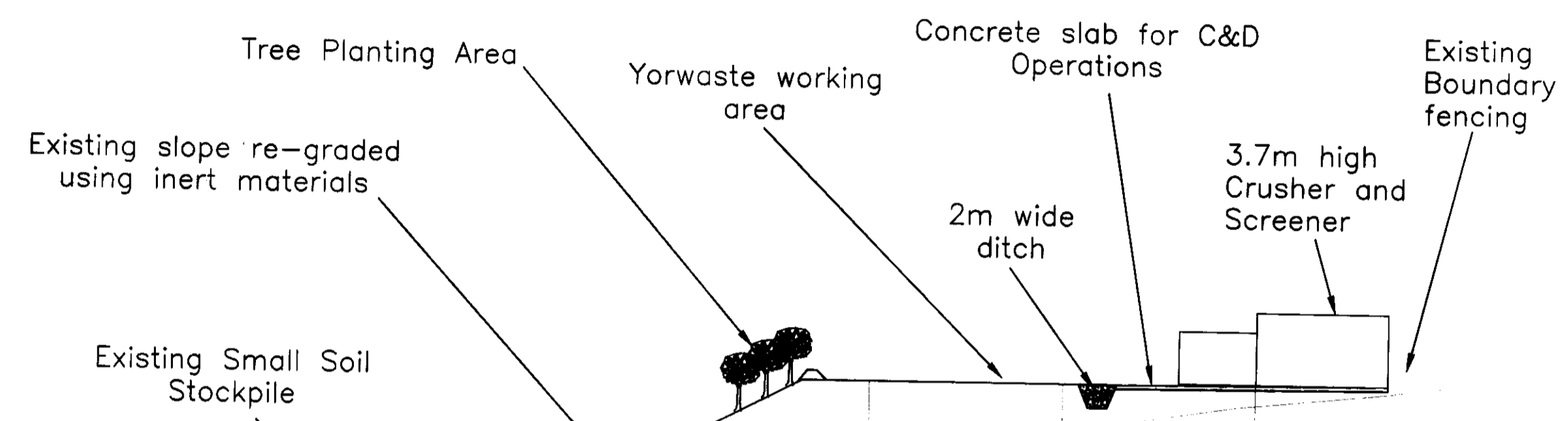

Horiz. 1:250  
 Vert. 1:250

86.00

Proposed Level		88.61	90.23	94.72	98.08	98.08	98.14	98.19	98.93
Approx. Original Level		88.61	90.23	92.03	93.89	95.62	97.10	98.19	98.93
Existing Chainage (m)	0.00	12.04	20.00	30.00	40.00	50.00	60.00	70.00	77.89

drawing number  
**WHI-PL00-Y0901-006**  
 date  
**24th AUGUST 2009**

notes  
 1. This drawing based on a survey updated by Dave Jatzuk (MMB) on 8th Feb 2008 and WHI-DE00-G2190-001 P3.  
 2. All co-ordinates & levels are based on local grid set up by Dave Jatzuk and are therefore not to OS grid or ordnance datum.  
 3. For location of cross-section refer to drawing WHI-PL00-Y0901-002A.

revisions	by	date



all drawings are the property of Yorwaste Ltd. and shall remain the property of Yorwaste Ltd.

drawing title  
**WHITBY WASTE TRANSFER STATION**  
**PROPOSED CO MINGLED RECEPTION BUILDING**  
**CROSS-SECTION**

EA Ref. no. **EA/WML/06188**  
 drawn by **A. Clarke**  
 checked by **G. O'Keefe**  
 approved by **M. [Signature]**

scales  
**AS SHOWN**

date  
**24th AUGUST 2009**  
 drawing number  
**WHI-PL00-Y0901-006**

drawing number

WHI-PL00-Y0901-003

date

11th MAY 2009

notes

- This drawing based on a survey of 8th February 2008 carried out by Dave Jatzuk of MMB on behalf of Yorwaste Ltd and design drawings also completed by MMB.

NYMMPA  
30 SEP 2009

revisions

by	date
GO	11.5.09

0 Original drawing.



**YORWASTE LTD.**  
Mount View  
Standard Way  
Northallerton  
North Yorkshire  
DL6 2YD

(c) YORWASTE LTD.  
NOT TO BE COPIED OR DETAILS DILIGED TO THIRD PARTIES EXCEPT WITH PERMISSION OF YORWASTE LTD.

drawing title

**WHITBY WASTE MANAGEMENT SITE**

**PROPOSED CO-MINGLED RECEPTION BUILDING**

**LOCATION PLANS & ELEVATIONS**

EA Ref No. EAWML/66188

drawn by A. Clarke

checked by G. O'Keefe

approved by T. Prudom

scales

As Shown

date

11th MAY 2009

drawing number

WHI-PL00-Y0901-003

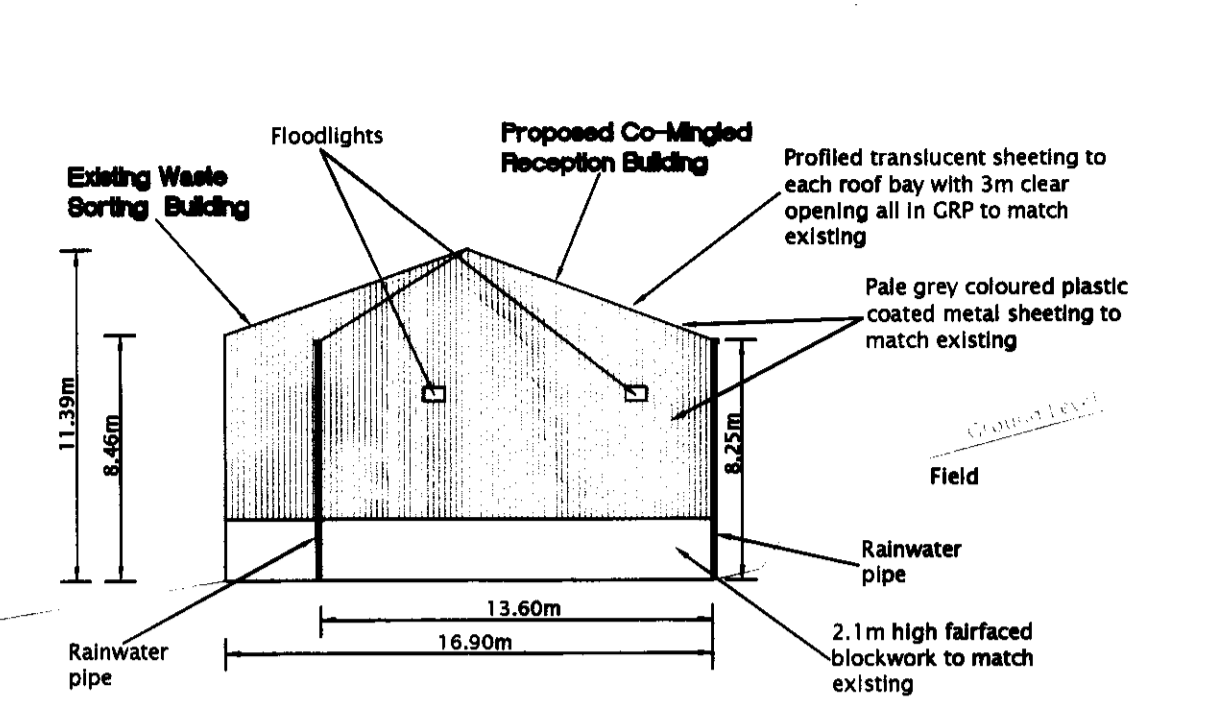

**South Elevation**  
Scale 1:250

North Elevation  
unchanged so not shown

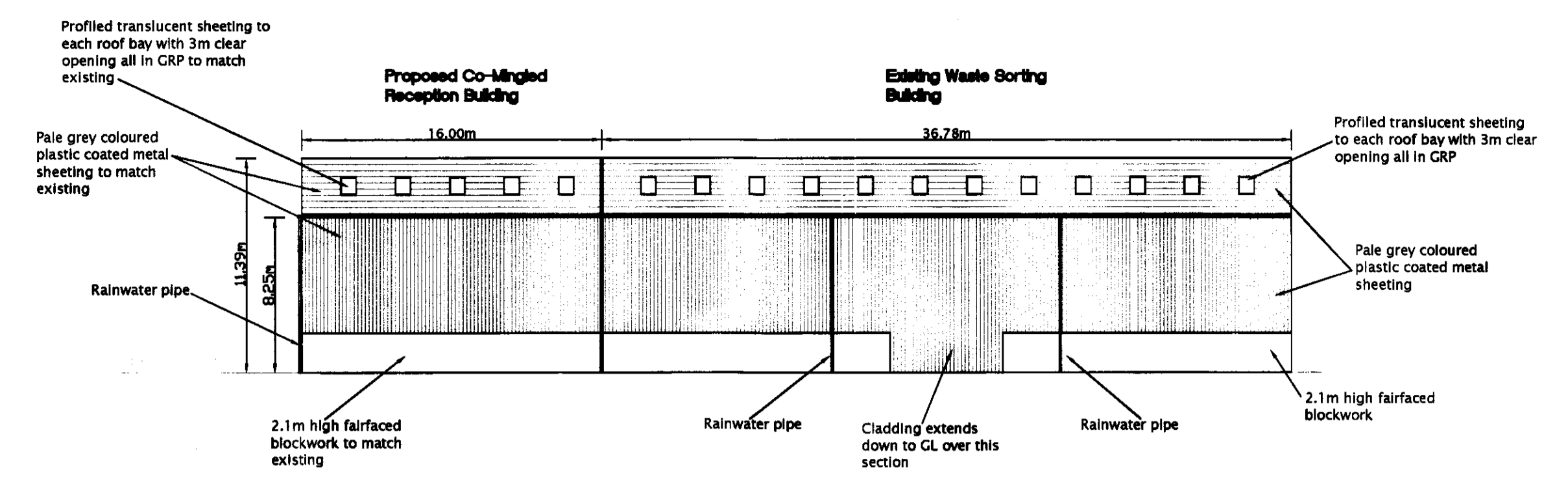

**East Elevation**  
Scale 1:250

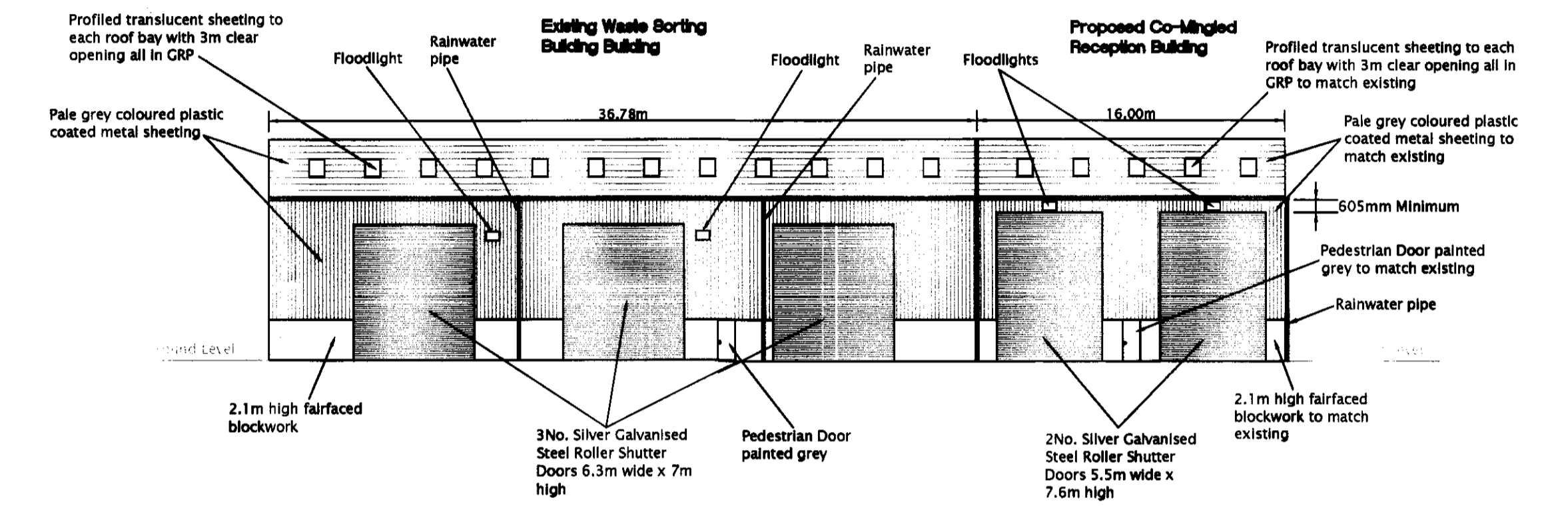

**West Elevation**  
Scale 1:250

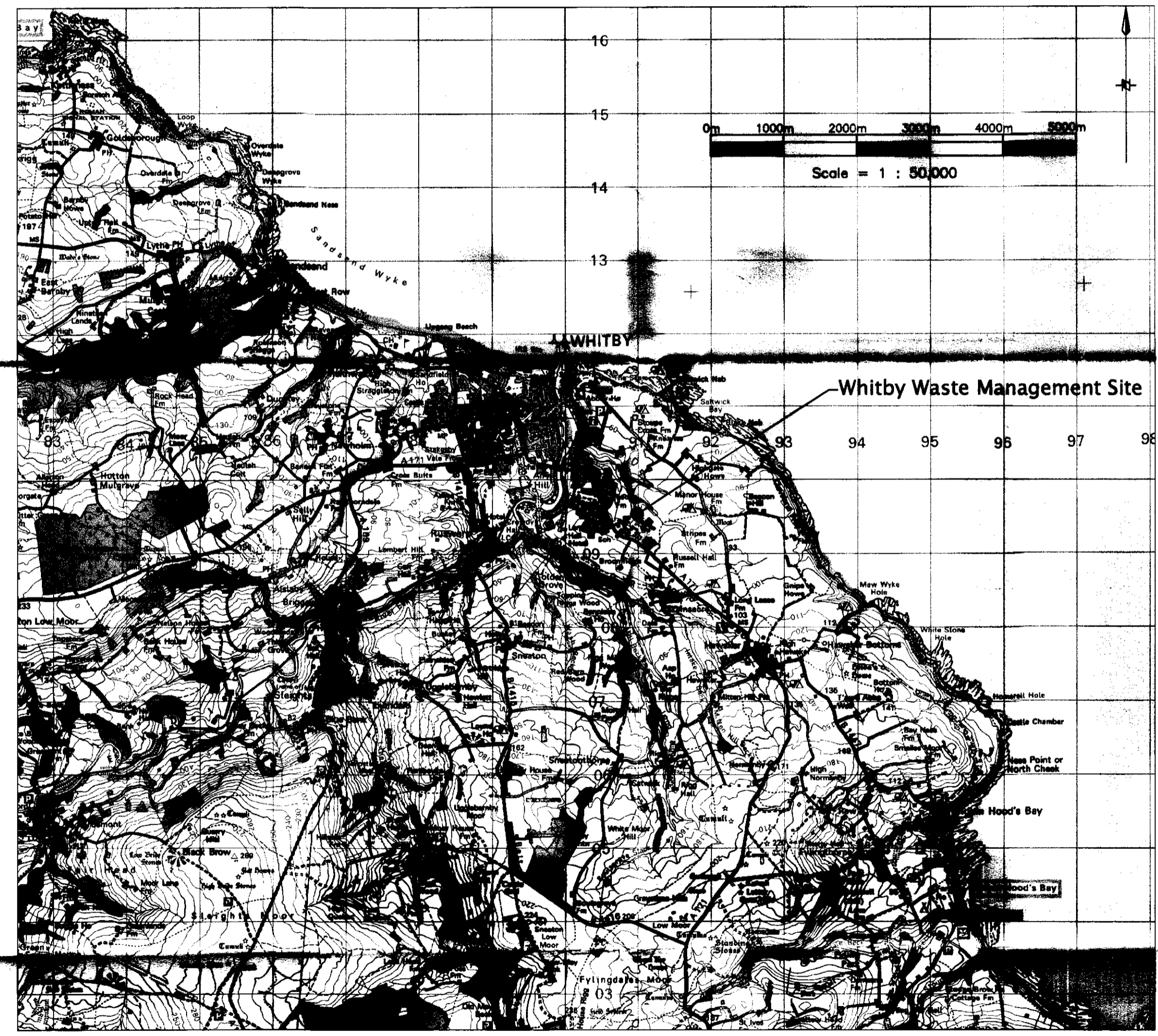

**Location Plan**  
Scale 1:50,000

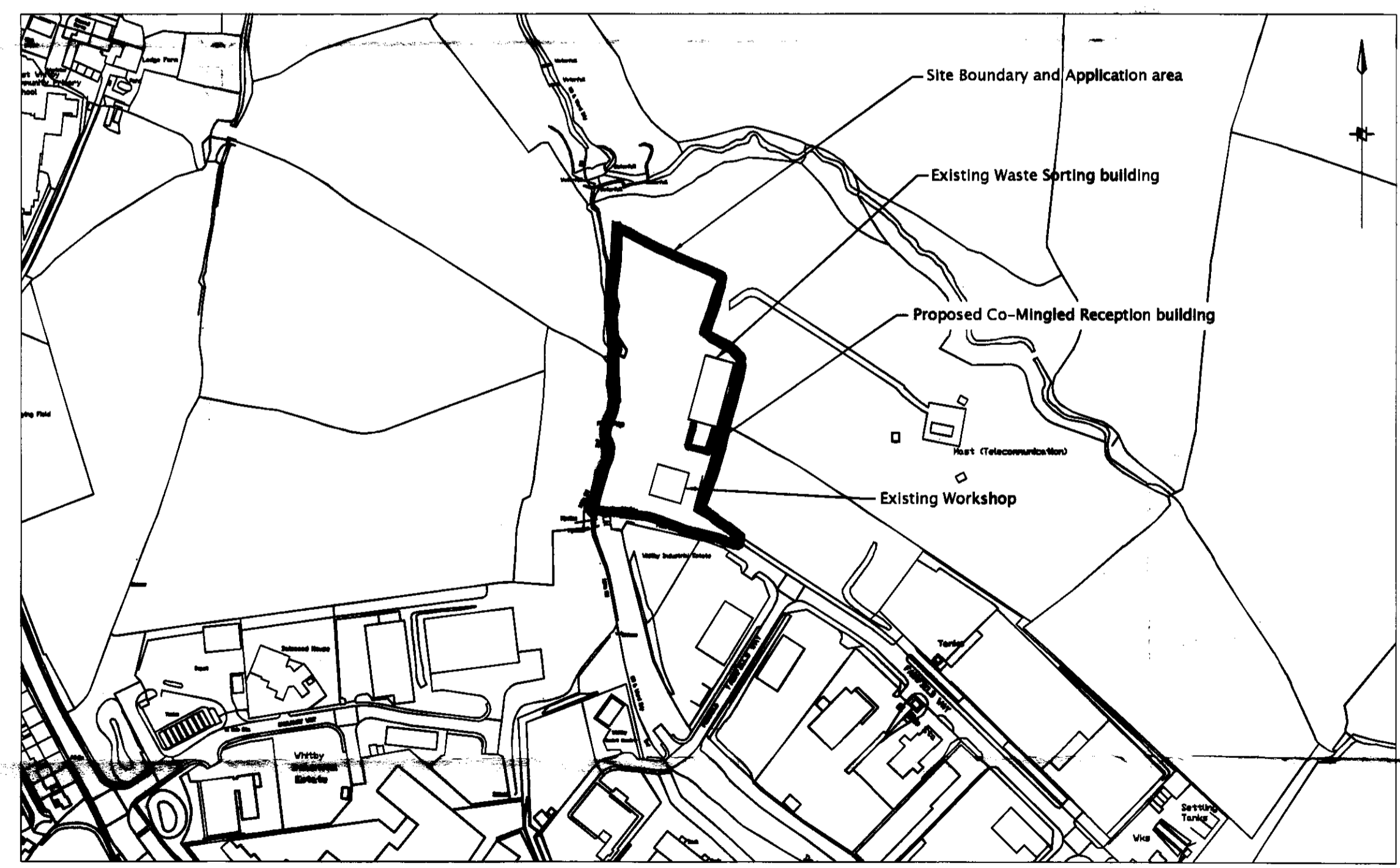

**Site Location and Application area**  
Scale 1:2,500

<b>Site Address</b> Whitby Waste Management Site Fairfield Way Whitby Business Park Whitby YO22 4PU OS Grid Ref: NZ 910 095	<b>Contact Details</b> Site Manager - Tony Prudom Site Tel: 01947 821048 Mobile: 07889 602466
---	--

N2 90925, 09513

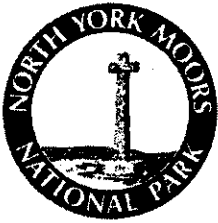

North York Moors National Park Authority  
The Old Vicarage  
Bondgate  
Helmsley  
York  
YO62 5BP

Telephone: 01439 770657  
Email: dc@northyorkmoors-npa.gov.uk  
Website: www.moors.uk.net

09/675

### Application for Planning Permission. Town and Country Planning Act 1990

**Publication of applications on planning authority websites.**

Please note that the information provided on this application form and in supporting documents may be published on the Authority's website. If you require any further clarification, please contact the Authority's planning department.

#### 1. Applicant Name, Address and Contact Details

Title:  First name:  Surname:

Company name:

Street address:

Town/City:

County:

Country:

Postcode:

Country Code:  National Number:  Extension Number:

Telephone number:

Mobile number:

Fax number:

Email address:

Are you an agent acting on behalf of the applicant?  Yes  No

NYMNP  
30 SEP 2009

#### 2. Agent Name, Address and Contact Details

Title:  First Name:  Surname:

Company name:

Street address:

Town/City:

County:

Country:

Postcode:

Country Code:  National Number:  Extension Number:

Telephone number:

Mobile number:

Fax number:

Email address:

#### 3. Description of the Proposal

Please describe the proposed development including any change of use:

EXTENSION TO THE EXISTING WASTE TRANSFER BUILDING, RELOCATION OF THE EXISTING CRUSHING AND SCREENING OPERATION, CONSTRUCTION OF A VEHICLE WASHING FACILITY AND PROVISION OF A VEHICLE ACCESS AND WORKING AREA.

Has the building, work or change of use already started?  Yes  No

**4. Site Address Details**

Full postal address of the site (including full postcode where available)

Description:

House:  Suffix:

House name:

Street address:

Town/City:

County:

Postcode:

Description of location or a grid reference (must be completed if postcode is not known):

Easting:

Northing:

**5. Pre-application Advice**

Has assistance or prior advice been sought from the local authority about this application?  Yes  No

If Yes, please complete the following information about the advice you were given (this will help the authority to deal with this application more efficiently):

Officer name:

Title:  First name:  Surname:

Reference:

Date (DD/MM/YYYY):  (Must be pre-application submission)

Details of the pre-application advice received:

**6. Pedestrian and Vehicle Access, Roads and Rights of Way**

Is a new or altered vehicle access proposed to or from the public highway?  Yes  No

Is a new or altered pedestrian access proposed to or from the public highway?  Yes  No

Are there any new public roads to be provided within the site?  Yes  No

Are there any new public rights of way to be provided within or adjacent to the site?  Yes  No

Do the proposals require any diversions/extinguishments and/or creation of rights of way?  Yes  No

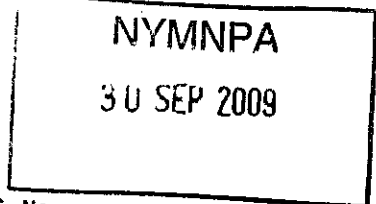

**7. Waste Storage and Collection**

Do the plans incorporate areas to store and aid the collection of waste?  Yes  No

If Yes, please provide details:

Have arrangements been made for the separate storage and collection of recyclable waste?  Yes  No

If Yes, please provide details:

**8. Neighbour and Community Consultation**

Have you consulted your neighbours or the local community about the proposal?  Yes  No

**9. Authority Employee/Member**

With respect to the Authority, I am:

- (a) a member of staff
- (b) an elected member
- (c) related to a member of staff
- (d) related to an elected member

Do any of these statements apply to you?  Yes  No

**10. Materials**

Please state what materials (including type, colour and name) are to be used externally (if applicable):



**10. Materials (continued)**

**Walls - description:**

Description of *existing* materials and finishes:

STEEL CLAD GREY IN COLOUR

Description of *proposed* materials and finishes:

STEEL CLAD GREY IN COLOUR

**Roof - description:**

Description of *existing* materials and finishes:

STEEL CLAD GREY IN COLOUR

Description of *proposed* materials and finishes:

STEEL CLAD GREY IN COLOUR

**Doors - description:**

Description of *existing* materials and finishes:

STEEL ROLLER SHUTTER DOORS

Description of *proposed* materials and finishes:

2X STEEL ROLLER SHUTTER DOORS

**Boundary treatments - description:**

Description of *existing* materials and finishes:

WOODEN FENCE

Description of *proposed* materials and finishes:

PALISADE FENCE WITH ATTACHED LITTER NETTING

**Vehicle access and hard standing - description:**

Description of *existing* materials and finishes:

COMPACTED SOIL AND RUBBLE

Description of *proposed* materials and finishes:

CONCRETE AND TARMAC PLANINGS

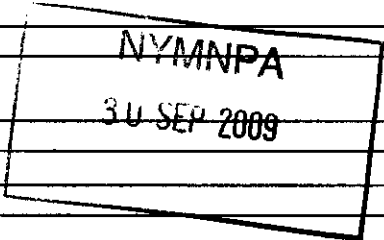

**Lighting - add description**

Description of *existing* materials and finishes:

SPOT LIGHTING

Description of *proposed* materials and finishes:

SPOT LIGHTING TO SAME CONFIGURATION AS THAT ALREADY UTILISED ON WIDER SITE

Are you supplying additional information on submitted plan(s)/drawing(s)/design and access statement?  Yes  No

If Yes, please state references for the plan(s)/drawing(s)/design and access statement:

See Planning Application Supporting Statement:

Appendix 1 - Design and Access Statement

Drawing WHI-PL00-Y0901-001 - Existing Layout and Application Area

Drawing WHI-PL00-Y0901-002A - Proposed Layout and Application Area

Drawing WHI-PL00-Y0901-003 - Location Plans and Elevations

Drawing WHI-PL00-Y0901-004 - Existing Site and Drainage Layout

Drawing WHI-PL00-Y0901-005 - Proposed Drainage Layout Drawing WHI-PL00-Y0901-006 - Proposed Site Cross Section

**11. Vehicle Parking**

Please provide information on the existing and proposed number of on-site parking spaces:

Type of vehicle	Existing number of spaces	Total proposed (including spaces retained)	Difference in spaces

**12. Foul Sewage**

Please state how foul sewage is to be disposed of:

Mains sewer  Package treatment plant  Unknown

Septic tank  Cess pit

Other

Are you proposing to connect to the existing drainage system?  Yes  No  Unknown

If Yes, please include the details of the existing system on the application drawings and state references for the plan(s)/drawing(s):

Fig 4.0 - Drawing WHI-PL00-Y0901-004 - Existing Site and Drainage Layout

Fig 5.0 - Drawing WHI-PL00-Y0901-005 - Proposed Drainage Layout

**13. Assessment of Flood Risk**

Is the site within an area at risk of flooding? (Refer to the Environment Agency's Flood Map showing flood zones 2 and 3 and consult Environment Agency standing advice and your local planning authority requirements for information as necessary.)  Yes  No

If Yes, you will need to submit an appropriate flood risk assessment to consider the risk to the proposed site.

Is your proposal within 20 metres of a watercourse (e.g. river, stream or beck)?  Yes  No

Will the proposal increase the flood risk elsewhere?  Yes  No

How will surface water be disposed of?

- Sustainable drainage system       Main sewer       Pond/lake  
 Soakaway       Existing watercourse

**14. Biodiversity and Geological Conservation**

To assist in answering the following questions refer to the guidance notes for further information on when there is a reasonable likelihood that any important biodiversity or geological conservation features may be present or nearby and whether they are likely to be affected by your proposals.

Having referred to the guidance notes, is there a reasonable likelihood of the following being affected adversely or conserved and enhanced within the application site, OR on land adjacent to or near the application site:

a) Protected and priority species

Yes, on the development site       Yes, on land adjacent to or near the proposed development       No

b) Designated sites, important habitats or other biodiversity features

Yes, on the development site       Yes, on land adjacent to or near the proposed development       No

c) Features of geological conservation importance

Yes, on the development site       Yes, on land adjacent to or near the proposed development       No

**15. Existing Use**

Please describe the current use of the site:

WASTE TRANSFER STATION

NYMNPA  
30 SEP 2009

Is the site currently vacant?  Yes  No

Does the proposal involve any of the following:

Land which is known to be contaminated?  Yes  No

Land where contamination is suspected for all or part of the site?  Yes  No

A proposed use that would be particularly vulnerable to the presence of contamination?  Yes  No

**Application advice**

If you have said Yes to any of the above, you will need to submit an appropriate contamination assessment.

**16. Trees and Hedges**

Are there trees or hedges on the proposed development site?  Yes  No

And/or: Are there trees or hedges on land adjacent to the proposed development site that could influence the development or might be important as part of the local landscape character?  Yes  No

If Yes to either or both of the above, you will need to provide a full Tree Survey with accompanying plan before your application can be determined. Your Local Planning Authority should make clear on its website what the survey should contain, in accordance with the current 'BS5837: Trees in relation to construction - Recommendations'

**17. Trade Effluent**

Does the proposal involve the need to dispose of trade effluents or waste?  Yes  No

**18. Residential Units**

Does your proposal include the gain or loss of residential units?  Yes  No

**19. All Types of Development: Non-residential Floorspace**

Does your proposal involve the loss, gain or change of use of non-residential floorspace?  Yes  No

Use class/type of use	Existing gross internal floorspace (square metres)	Gross internal floorspace to be lost by change of use or demolition (square metres)	Total gross new internal floorspace proposed (including changes of use) (square metres)	Net additional gross internal floorspace following development (square metres)

**19. All Types of Development: Non-residential Floorspace (continued)**

A1	Net Tradable Area				
A2	Financial and professional services				0.0
A3	Restaurants and cafes				0.0
A4	Drinking establishments				0.0
A5	Hot food takeaways				0.0
B1 (a)	Office (other than A2)				0.0
B1 (b)	Research and development				0.0
B1 (c)	Light industrial				0.0
B2	General industrial				0.0
B8	Storage or distribution				0.0
C1	Hotels and halls of residence				0.0
C2	Residential institutions				0.0
D1	Non-residential institutions				0.0
D2	Assembly and leisure				0.0
Other				224.0	224.0
Other					
	<b>Total</b>	<b>0.0</b>	<b>0.0</b>	<b>224.0</b>	<b>224.0</b>

NYM/NPA  
30 SEP 2009

For hotels, residential institutions and hostels, please additionally indicate the loss or gain of rooms:

Use Class	Types of use	Existing rooms to be lost by change of use or demolition	Total rooms proposed (including changes of use)	Net additional rooms
C1	Hotels	0	0	0
C2	Residential institutions	0	0	0
Other		0	0	0
Other				

**20. Employment**

If known, please complete the following information regarding employees:

	Full-time	Part-time	Equivalent number of full-time
Existing employees	15	0	15
Proposed employees	15	0	15

**21. Hours of Opening**

If known, please state the hours of opening for each non-residential use proposed:

Use	Monday to Friday		Saturday		Sunday and Bank Holidays		Not Known
	Start Time	End Time	Start Time	End Time	Start Time	End Time	
Other	07:30:00	17:30:00	07:30:00	13:00:00	07:30:00	1300 (OCCAS)	<input type="checkbox"/>

**22. Site Area**

What is the site area?  hectares

**23. Industrial or Commercial Processes and Machinery**

Please describe the activities and processes which would be carried out on the site and the end products including plant, ventilation or air conditioning. Please include the type of machinery which may be installed on site:

PROCESSES INVOLVING THE SORTING AND TRANSFER OF WASTE MATERIAL  
 INSTALLED MACHINERY AND PLANT:  
 CRUSHER  
 SCREEN  
 360 EXCAVATOR

Is the proposal for a waste management development?  Yes  No

Please complete the following table:

**23. Industrial or Commercial Processes and Machinery (continued)**

	The total capacity of the void in cubic metres, including engineering surcharge and making no allowance for cover or restoration material (or tonnes if solid waste or litres if liquid waste)	Maximum annual operational throughput in tonnes (or litres if liquid waste)
Transfer stations		46,700

Please give maximum annual operational throughput of the following waste streams:

Municipal	26,700
Construction, demolition and excavation	20,000

If this is a landfill application you will need to provide further information before your application can be determined. Your waste planning authority should make clear what information it requires on its website.

**24. Hazardous Substances**

Is any hazardous waste involved in the proposal?  Yes  No

**25. Site Visit**

Can the site be seen from a public road, public footpath, bridleway or other public land?  Yes  No

If the planning authority needs to make an appointment to carry out a site visit, whom should they contact? (Please select only one)

The agent  The applicant  Other person

**26. Certificates**

**Certificate of Ownership -**  
**Town and Country Planning (General Development Procedure) Order 1995 Certificate under Article 7**

Title: [redacted] First name: [redacted] Surname: [redacted]

Person role: Agent Declaration date: 30/09/2009  Declaration made

**26. Certificates (Agricultural Holdings Certificate)**

**Agricultural Holding Certificate**  
**Town and Country Planning (General Development Procedure) Order 1995 Certificate under Article 7**

Agricultural Land Declaration - [redacted]  
 (A) None of the land to which the application relates is, or is part of an agricultural holding.  
 (B) I have/The applicant has given the requisite notice to every person other than myself/the applicant who, on the day 21 days before the date of this application, was a tenant of an agricultural holding on all or part of the land to which this application relates, as listed below:

Title: [redacted] First Name: [redacted] Surname: [redacted]

Person role: Agent Declaration date: 30/09/2009  Declaration Made

**27. Declaration**

I/we hereby apply for planning permission/consent as described in this form and the accompanying plans/drawings and additional information.

Date 30/09/2009

NYMNPA  
 30 SEP 2009