

2011/0827 AFB6

Application for prior notification of agricultural or forestry development - proposed building.

Town and Country Planning General Permitted Development Order 1995

Schedule 2, parts 6 & 7

NYMINPA
12 DEC 2011

Publication of planning applications on council websites

Please note that with the exception of applicant contact details and Certificates of Ownership, the information provided on this application form and in supporting documents may be published on the council's website.

If you have provided any other information as part of your application which falls within the definition of personal data under the Data Protection Act which you do not wish to be published on the council's website, please contact the council's planning department.

Please complete using block capitals and black ink.
It is important that you read the accompanying guidance notes as incorrect completion will delay the processing of your application.

1. Applicant Name and Address

Title: First name:

Last name:

Company (optional):

Unit: House number: House suffix:

House name:

Address 1:

Address 2:

Address 3:

Town:

County:

Country:

Postcode:

2. Agent Name and Address

Title: First name:

Last name:

Company (optional):

Unit: House number: House suffix:

House name:

Address 1:

Address 2:

Address 3:

Town:

County:

Country:

Postcode:

3. Site Address Details

Please provide the full postal address of the application site.

Unit: House number: House suffix:

House name:

Address 1:

Address 2:

Address 3:

Town:

County:

Postcode (optional):

Description of location or a grid reference. (must be completed if postcode is not known):

Easting: Northing:

Description:

Erection of replacement covered fold yard/livestock housing building: 30m x 13.70m

4. The Proposed Building

Please indicate which of the following are involved in your proposal:

A new building An extension An alteration

Please describe the type of building:

Please state the dimensions:

Length	30.00m	metres
Height to eaves	4.50m	metres
Breadth	13.70m	metres
Height to ridge	6.80m	metres

Please describe the walls and the roof materials and colours:

Walls - Materials:	<i>Pre-cast concrete panels</i>
Walls - External colour:	<i>Grey/White</i>
Roof - Materials:	<i>Coloured Fibre cement sheets</i>
Roof - External colour:	<i>Dark Grey</i>

Has an agricultural building been constructed on this unit within the last two years? Yes No

If Yes: What is the overall ground area: metres²

What is its distance from the proposed new building: metres

Would the proposed building be used to house livestock, slurry or sewage sludge? Yes No

If Yes will the building be more than 400 metres from the nearest house excluding the farmhouse? Yes No

Would the floor area of the building exceed 465 square metres? Yes No

Has any building, works, pond, plant/machinery, or fishtank been erected within 90 metres of the proposed development within the last 2 years? Yes No

5. Agricultural and Forestry Developments

What is the area of the proposed agricultural unit? Square metres/Hectares (delete as appropriate).

What is the area of the parcel of land where the development is to be located? Please tick only one box:

1 hectare or more Less than 1 hectare but at least 0.4 hectare Less than 0.4 hectare

How long has the land on which the proposed development would be located been in use for agriculture for the purposes of a trade or business? Years: Months:

Is the proposed development reasonably necessary for the purposes of agriculture? Yes No

If Yes please explain why:

Is the proposed development designed for the purposes of agriculture? Yes No

If Yes please explain why:

Does the proposed development involve any alteration to a dwelling? Yes No

Is the proposed development more than 25 metres from a metalled part of a trunk or classified road? Yes No

Is the proposed development within 3 kilometres of an aerodrome? Yes No

What is the height of the proposed development: metres Not applicable

Would the proposed development affect an ancient monument, archaeological site or listed building or would it be within a Site of Special Scientific Interest or a local nature reserve? Yes No

If Yes please provide details:

6. Planning Application Requirements - Checklist

Please read the following checklist to make sure you have sent all the information in support of your proposal. Failure to submit all information required will result in your application being deemed invalid. It will not be considered valid until all information required by the Local Planning Authority has been submitted.

- 3 copies of a completed and dated application form: The correct fee: £70
- 3 copies of a plan which identifies the land to which the application relates drawn to an identified scale and showing the direction of North:

7. Declaration

I/we hereby apply for planning permission/consent as described in this form and the accompanying plans/drawings and additional information.

Signed - Applicant: _____ Or signed - Agent: _____

Date (DD/MM/YYYY): 5/12/2011 (date cannot be pre-application)

on behalf of R. Lawson

8. Applicant Contact Details

Telephone numbers

Country code:	National number:	Extension number:
<input type="text"/>	<input type="text"/>	<input type="text"/>
Country code:	Mobile number (optional):	
<input type="text"/>	<input type="text"/>	
Country code:	Fax number (optional):	
<input type="text"/>	<input type="text"/>	
Email address (optional):		
<input type="text"/>		

9. Agent Contact Details

Telephone numbers

Country code:	National number:	Extension number:
<input type="text"/>	<input type="text"/>	<input type="text"/>
Country code:	Mobile number (optional):	
<input type="text"/>	<input type="text"/>	
Country code:	Fax number (optional):	
<input type="text"/>	<input type="text"/>	
Email address (optional):		
<input type="text"/>		

10. Site Visit

Can the site be seen from a public road, public footpath, bridleway or other public land? Yes No

If the planning authority needs to make an appointment to carry out a site visit, whom should they contact? (Please select only one) Agent Applicant Other (if different from the agent/applicant's details)

If Other has been selected, please provide:

Contact name: PHIL FISHER Telephone number: _____

Email address: _____

NYMNP
12 DEC 2011

VALIDATION CHECKLIST

PRIOR NOTIFICATION OF PROPOSED AGRICULTURAL DEVELOPMENT – buildings, roads, excavation/deposit of waste material from farm, fish tank

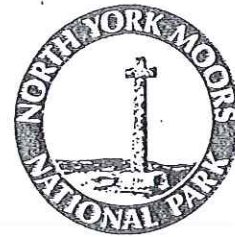

Please complete the attached checklist to indicate what you have included with your application. All plans should include paper size, key dimensions and scale.

The following information will be required:

Completed application form or written description of the proposed development and materials to be used.

YES N/A

*4 copies
inc original*

Location plan indicating the site – preferably a 1:2500 or 1:1250 Ordnance survey plan – site outlined in red

YES N/A

4 copies

Application fee

YES NO

£70

Some or all of the following information may also be required:

Supporting Planning Statement

YES N/A

Existing and proposed elevations to a scale of 1:50 or 1:100

YES N/A

Existing and proposed floor plans to a scale of 1:50 or 1:100

YES N/A

Proposed site layout plans at a scale of 1:500, 1:200 or 1:100 site layout plan

YES N/A

4 copies

Existing site layout plans at a scale of 1:500, 1:200 or 1:100

YES N/A

Existing and proposed site sections and finished floor and site levels

YES N/A

Photographs/photomontages

YES N/A

Supporting Agricultural Information

YES N/A

4 copies



PWF/LAB

AF66

5th December, 2011.

North York Moors National Parks,
Planning Department,
The Old Vicarage,
Bondgate,
HELMSLEY,
North Yorkshire,
YO62 5BP.

Dear Sirs,

**RE. PROPOSED REPLACEMENT COVERED FOLD YARD AREA
R. LAWSON, MOUNT MISERY FARM, TROUTSDALE, HACKNESS**



I am enclosing the relevant Planning Notification Forms, location plans and detailed drawings showing proposals to replace the collapsed roof over the existing Fold Yard area, and to extend this so that the covered area incorporates the Silage Clamp and outside feed area. The existing roof area collapsed last Winter under the weight of the snow.

The proposed new covered area will give a much better and larger area for both the suckler cow herd and also lambing area (when required). Luckily, last Spring was warm and sunny, hence no indoor lambing was necessary.

As well as the Notification Forms and plans (4 copies of each), a cheque for the relevant Planning Fee of £70 is also enclosed, together with 4 copies of the supporting Agricultural Information Form and Supporting Statement.

I trust that all of the enclosed information is adequate. Should there be any further information required, or points which require clarification, please do not hesitate to contact me.

Yours faithfully,

P. W. Fisher
Cundalls.

Encs.

15 Market Place, Malton,
North Yorkshire, YO17 7LP

40 Burgate, Pickering,
North Yorkshire, YO18 7AU

Website: www.cundalls.co.uk

CUNDALLS (YORKSHIRE) LTD trading as CUNDALLS • REGISTERED IN ENGLAND AND WALES COMPANY NUMBER 7330895
REGISTERED OFFICE: 12-13 ALMA SQUARE, SCARBOROUGH, NORTH YORKSHIRE

VAT REG NO. 995 5060 83



RICS

Supporting Agricultural Information

Applicants are encouraged to complete the tables below as this will enable us to speed up the processing of the notification. The purpose of this form is to provide basic information on the farm system to help assess the need and appropriateness of agricultural building within the National Park.

LIVESTOCK NUMBERS	Average number throughout the year	Notes
Dairy Cows	—	—
Suckler cows/heifers over 24 months	20	
Followers (6-24 months)	20	Calves & Heifers Cattle
Breeding Ewes/tups	1 TUP 50 EWES	} BWS Flock + LAMB'S SOLD OCT/NOV
Hoggs	80 LAMBS	
Other Livestock (ie horses)	—	—

LAND	Area (hectares)	Notes
Size of holding	31.00	
Available grazing land	25.00	Rem. Grassland
Arable land	6.0	
Moorland	—	
Grazing land on short term tenancy	—	

The above will help us determine the stocking density on the farm.



1st Main Existing Agricultural Buildings	Approximate Dimensions (in metres)	Existing usage/notice
(A) TRADITIONAL STABLE BARN	26m x 12m	GENERAL STORAGE
(B) CATTLE HOUSING BUILDING	18m x 8m	SUCKLER COWS & FOLLOWS
(C) COVERED FOLD YARD ADJACENT TO (B)	18m x 13.70m	SUCKLER COWS & FOLLOWS + LAMBING AREA
(D) SILAGE CLAMP ADJACENT TO FOLD YARD	26m x 12m	FEEDING AREA AND OVERFLOW CATTLE HOUSING WHEN EMPTYING

NYMNPA
12 DEC 2011

ANY OTHER RELEVANT INFORMATION

Covered fold yard area (C) collapsed under weight of snow winter 2010/11. Proposals also for new covered area to include both covered yard (C) and silage clamp area (D). This will provide much larger area & reduce potential run off from silage clamp.

PROPOSED COVERED FOLD YARD

MOUNT MISERY FARM, TROUTSDALE, HACKNESS

PLAN VIEW

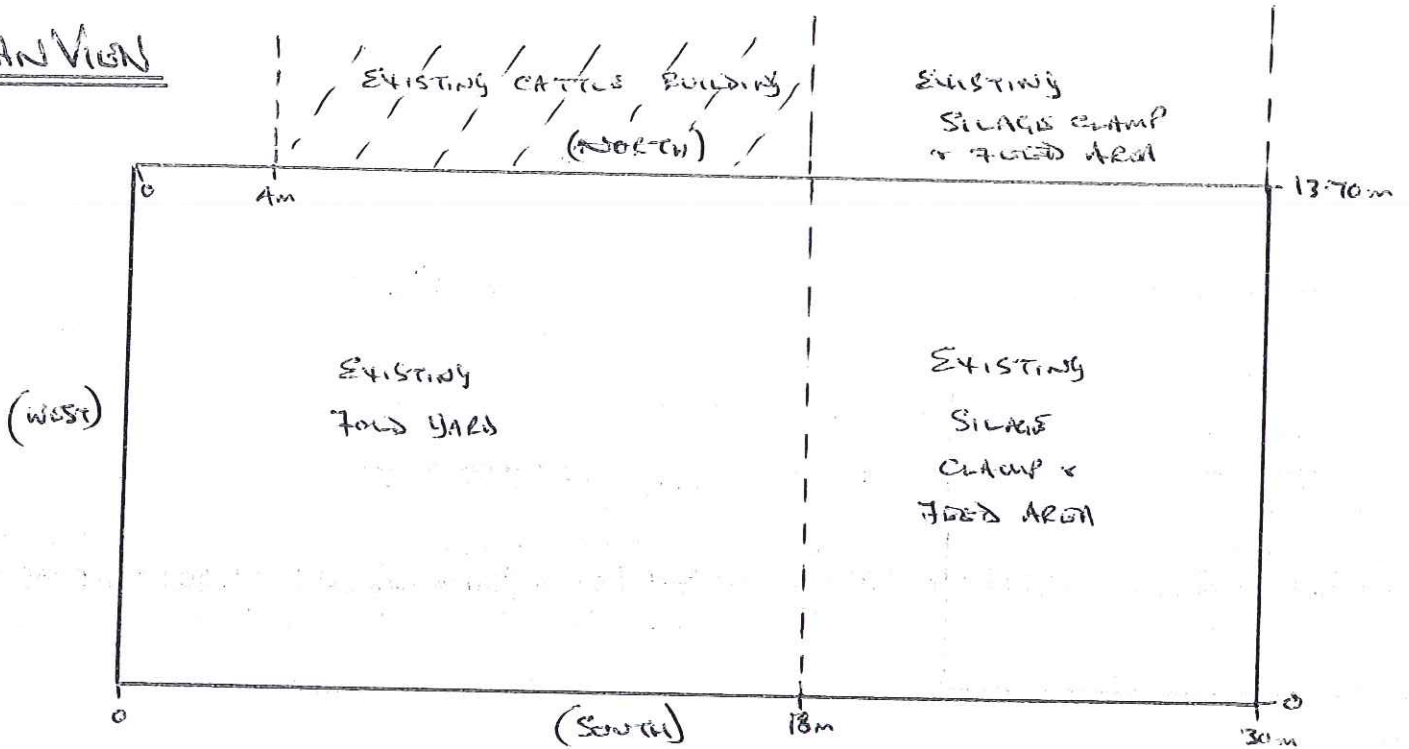

NORTH ELEVATION

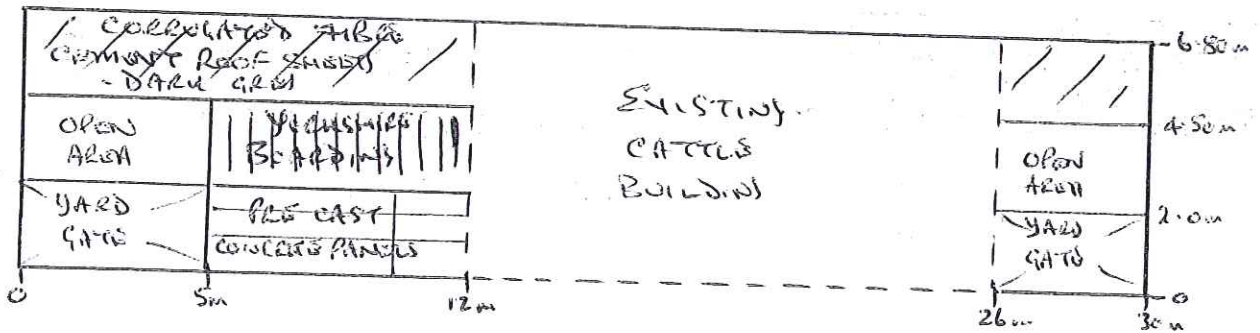

SOUTH ELEVATION

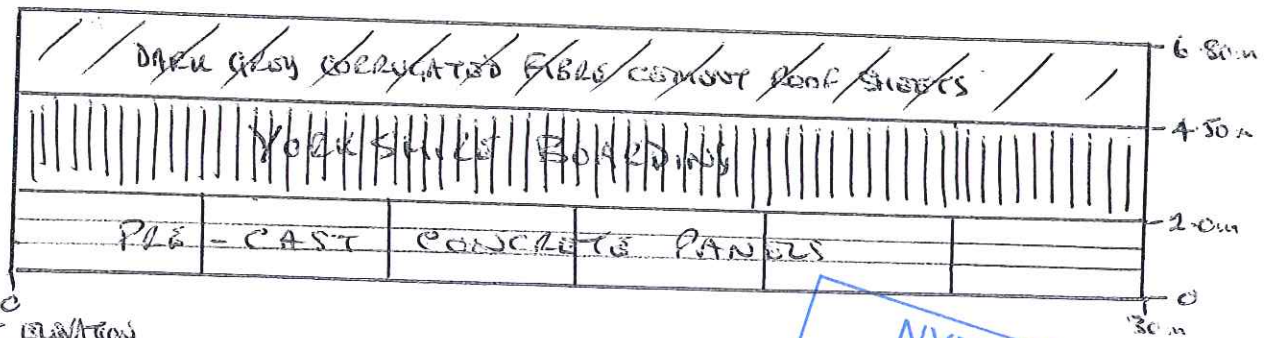

EAST/WEST ELEVATION



NYMNP
12 DEC 2011

SCALE: 1 in 200

Proposed Covered Yard Area @ Mount Misery Farm, Treveltha Dale, Hackness

For R. LAWSON

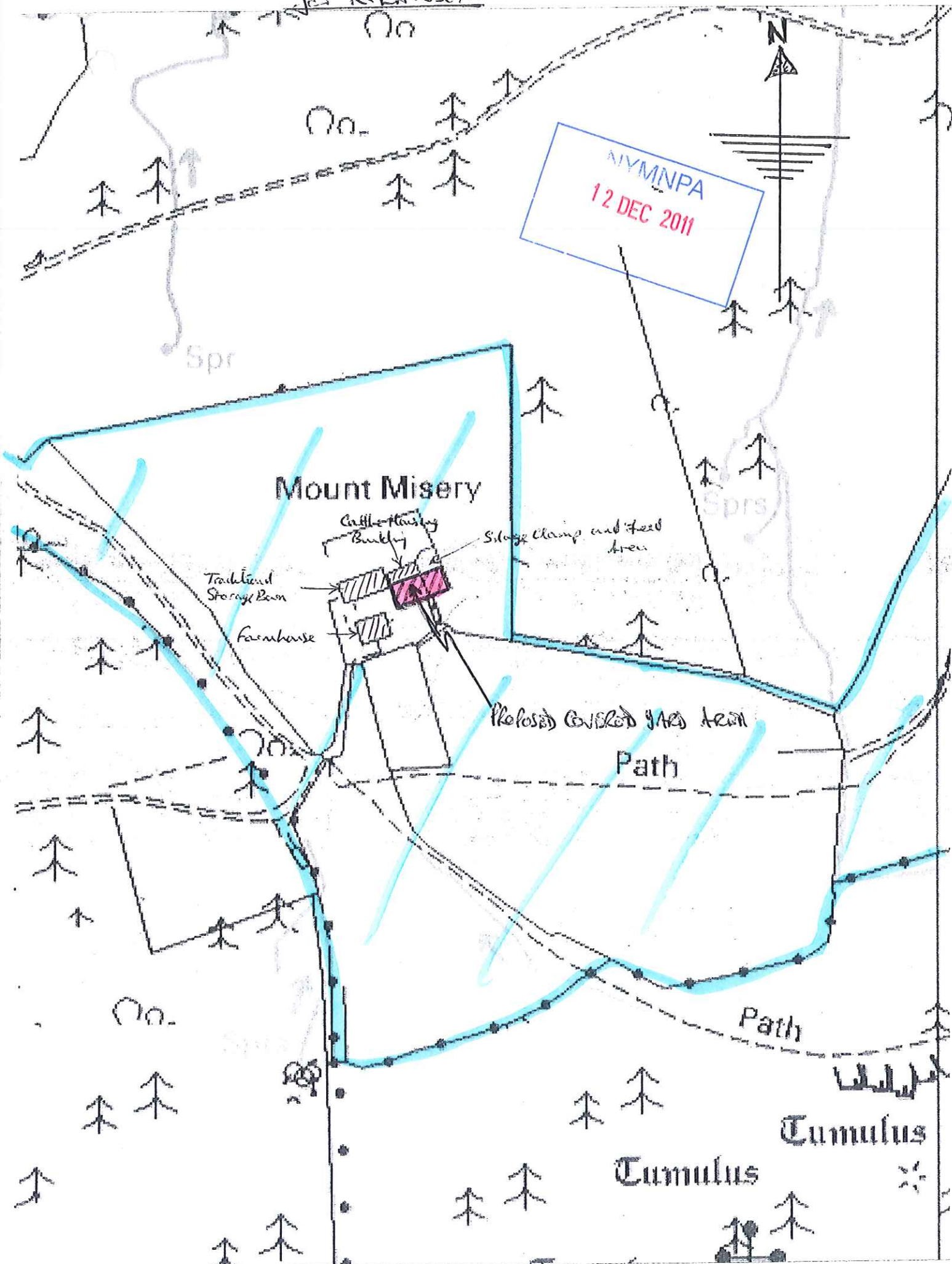

REPLACEMENT COVERED FOLD YARD**AT****MOUNT MISERY FARM, TROUTSDALE, HACKNESS****FOR****MR. R. LAWSON****AGRICULTURAL SUPPORTING STATEMENT**

During the Winter of 2010/2011, the roof of the covered Fold Yard area collapsed under the weight of the snow. This drastically reduced the housing area for the suckler cow herd on the Farm, and caused serious problems for several weeks during extremely cold Winter conditions.

The proposals involve constructing a replacement structure covering the whole of the Fold Yard area, and extending approximately 12 Metres further to the East so as to cover in a large proportion of the outside Silage Clamp and Cattle feed area. The new structure will take the form of a Portal Frame Building, and will incorporate traditional modern features such as concrete retaining panels, Yorkshire Boarding as well as dark grey corrugated fibre cement roof sheeting. The new structure will also be immediately adjacent to the small Cattle housing building on the North side of the existing Fold Yard.

The new structure is considered essential to provide a high standard of cattle housing on the Farm, and also to accommodate the ewe flock when indoor lambing is necessary during bad weather conditions. By covering the majority of the external Silage Clamp and feed area, this will also reduce any potential pollution problems.

P. W. F. Fisher
Cundalls.

