

ADDITIONAL AMENDMENTS

- Amended layout of buildings/outside areas - *western most cabin to avoid PROW.*
- Additional background information
- Amended design
- Revised access arrangements - *Surface Material.*
- Change of description of proposed development - as indicated on the previous page
- Change in site boundaries
- Other (as specified below) - *additional planting.*

Wendy Trousdale

From: Ian Pick [mailto:ianpick.co.uk]
Sent: 07 April 2011 10:07
To: Planning
Subject: NYM/2011/0038/FL - Ebberston Common Farm
Attachments: block plan rev a-A1.pdf

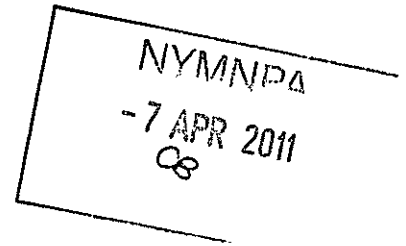

FAO Helen Webster,

I refer to the above application and to our conversation on Tuesday 5th April.

With regard to the issue of the footpath, as far as we can see with the OS plan, the footpath route possibly clipped the corner of the western most cabin. We have moved this cabin slightly so that it does not obstruct the footpath.

In terms of the impact on the landscape of the access road, we would like to amend the construction materials of the access and parking area to 'grasscrete', which is a concrete mesh which the grass can grow through. From a distance, this just looks like grass.

In terms of the possible visual impact of cabins within the landscape. These are well obscured by the existing woodland within which they are sited. The woodland is thin in places and possible views are available from the highway to the west. We are therefore proposing some additional planting as shown on the attached plan. These include two areas of understory planting within the woodland (number 1 & 2), and an area of new planting to the south of the woodland (number 3). The existing woodland provides immediate screening, and the proposed additional planting will provide strengthening to the existing screening.

Regards

Ian Pick

Scanned by MailDefender - managed email security from intY - www.maildefender.net

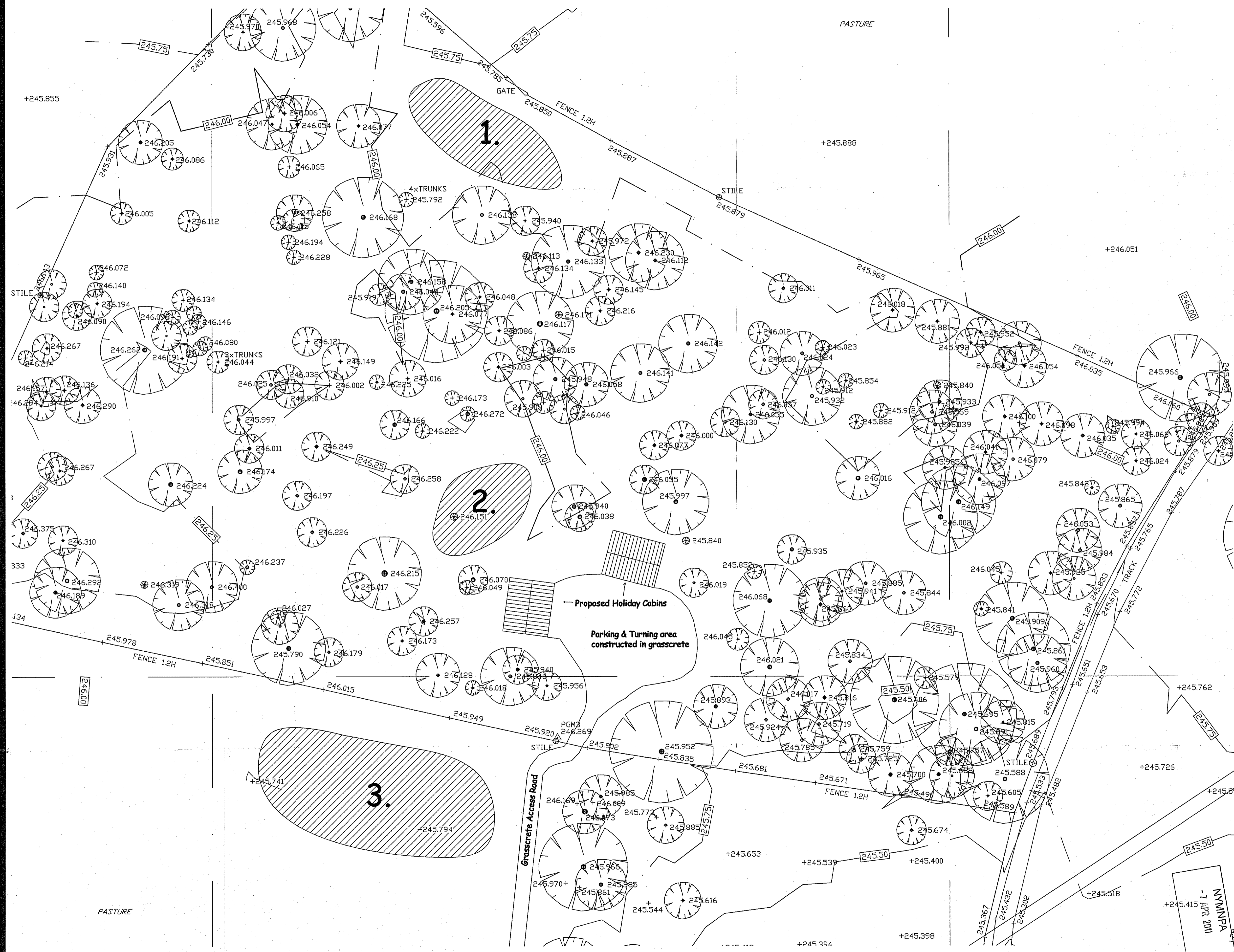

AMENDED
Notes



Ian Pick BSc (Hons) MRICS
Llewellyn House
Middle Street
Kilham
Driffield
East Yorkshire
YO25 4RL
Tel/Fax (01262) 421807
Mobile 07702814950

CLIENT
Mark Hammond
Eberstone Common Farm
Eberstone
Scarborough
YO13 0LW

JOB TITLE
Proposed Holiday Cabins

DWG. TITLE
Block Plan REV A

SCALE
1=250

DRN
SH

DATE	ALTERATION	REV
-/-		

DWG. NUMBER	DATE	REV
IP/MH/02A	April 11	A

NMMNPA
 1 APR 2011